

NO. OF COPIES RECEIVED	6
DISTRIBUTION	
SANTA FE	1
FILE	1
U.S.G.S.	2
LAND OFFICE	1
OPERATOR	1

RECEIVED
NEW MEXICO OIL CONSERVATION COMMISSION
JUN 23 1972
O. C. C.
ARTESIA, OFFICE

30-015-20687
Form C-101
Revised 1-1-65

5A. Indicate Type of Lease	
STATE <input checked="" type="checkbox"/>	FEE <input type="checkbox"/>
5. State Oil & Gas Lease No. B-2130	

APPLICATION FOR PERMIT TO DRILL, DEEPEN, OR PLUG BACK

1a. Type of Work b. Type of Well OIL WELL <input checked="" type="checkbox"/> GAS WELL <input type="checkbox"/> OTHER <input type="checkbox"/> DRILL <input checked="" type="checkbox"/> DEEPEN <input type="checkbox"/> PLUG BACK <input type="checkbox"/> SINGLE ZONE <input type="checkbox"/> MULTIPLE ZONE <input type="checkbox"/>		7. Unit Agreement Name
2. Name of Operator Texas American Oil Corporation		8. Farm or Lease Name Randel State
3. Address of Operator 1012 Midland Savings Building, Midland, Texas 79701		9. Well No. 5
4. Location of Well UNIT LETTER <u>H</u> LOCATED <u>1980</u> FEET FROM THE <u>North</u> LINE AND <u>660</u> FEET FROM THE <u>East</u> LINE OF SEC. <u>16</u> TWP. <u>17S</u> RGE. <u>30E</u> NMPM		10. Field and Pool, or Wildcat Grayburg Jackson ^x
		12. County Eddy
19. Proposed Depth 3950		19A. Formation G-SA
20. Rotary or C.T. Rotary		
21. Elevations (Show whether DF, RT, etc.) 3688 GR	21A. Kind & Status Plug. Bond J. S. Ward & Son	21B. Drilling Contractor Hondo Drilling
		22. Approx. Date Work will start July 7, 1972

23.

PROPOSED CASING AND CEMENT PROGRAM

SIZE OF HOLE	SIZE OF CASING	WEIGHT PER FOOT	SETTING DEPTH	SACKS OF CEMENT	EST. TOP
11"	8-5/8"	20#	525	100	Circ.
7-7/8"	4-1/2"	9.50#	3950	600	1800

APPROVAL VALID
FOR 90 DAYS UNLESS
DRILLING COMMENCED,
EXPIRES 9-26-72

IN ABOVE SPACE DESCRIBE PROPOSED PROGRAM: IF PROPOSAL IS TO DEEPEN OR PLUG BACK, GIVE DATA ON PRESENT PRODUCTIVE ZONE AND PROPOSED NEW PRODUCTIVE ZONE. GIVE BLOWOUT PREVENTER PROGRAM, IF ANY.

I hereby certify that the information above is true and complete to the best of my knowledge and belief.

Signed J. S. Ward Title Engineer Date June 21, 1972
(This space for State Use)

APPROVED BY W. A. Gressett TITLE OIL AND GAS INSPECTOR DATE JUN 26 1972
CONDITIONS OF APPROVAL, IF ANY:

NEW MEXICO OIL CONSERVATION COMMISSION
WELL LOCATION AND ACREAGE DEDICATION PLAT

RECEIVED

Form C-102
 Supersedes C-128
 Effective 1-1-65

All distances must be from the outer boundaries of the Section.

Operator Texas American Oil Corporation			Lease Section 15		O. C. C. OFFICE ARTESIA		Well No. 5
Unit Letter 1	Section 15	Township 17 South	Range 30 East	County El Paso			
Actual Footage Location of Well: 1980 feet from the North line and 660 feet from the East line							
Ground Level Elev: 3689	Producing Formation G-SH		Pool Grayburg Jackson		Dedicated Acreage: 40 Acres		

1. Outline the acreage dedicated to the subject well by colored pencil or hatchure marks on the plat below.
2. If more than one lease is dedicated to the well, outline each and identify the ownership thereof (both as to working interest and royalty).
3. If more than one lease of different ownership is dedicated to the well, have the interests of all owners been consolidated by communitization, unitization, force-pooling, etc?

☐ Yes ☐ No If answer is "yes," type of consolidation _____

If answer is "no," list the owners and tract descriptions which have actually been consolidated. (Use reverse side of this form if necessary.) _____

No allowable will be assigned to the well until all interests have been consolidated (by communitization, unitization, forced-pooling, or otherwise) or until a non-standard unit, eliminating such interests, has been approved by the Commission.

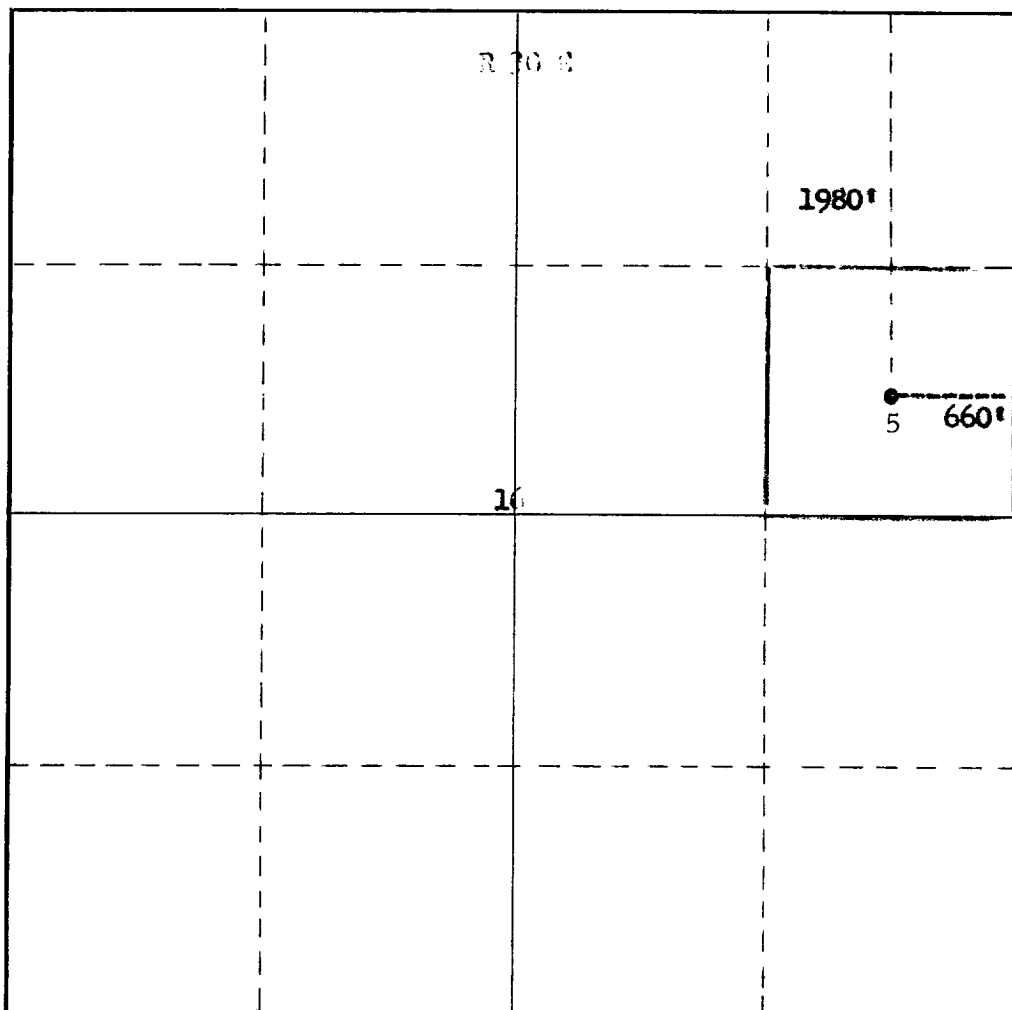

CERTIFICATION

I hereby certify that the information contained herein is true and complete to the best of my knowledge and belief.

Name
N. T. Emanuel
 Position
Engineer
 Company
Texas American Oil Corp.
 Date
June 21, 1972

I hereby certify that the well location shown on this plat was plotted from field notes of accurate measurement made or under my supervision and that the same is true and correct to the best of my knowledge and belief.

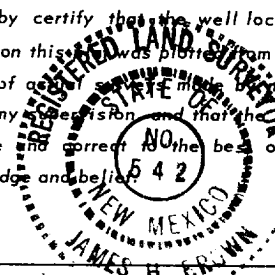

Date Surveyed
November 30, 1972
 Registered Professional Engineer
 and/or Land Surveyor

Certificate No. _____

James H. Brown

T
17
S