

NEW MEXICO OIL CONSERVATION COMMISSION
WELL LOCATION AND ACREAGE DEDICATION PLAT

Form C-102
Supersedes C-128
Effective 10-68

All distances must be from the outer boundaries of the Section

Operator Amoco Production Company			Lease Empire South Deep Unit		Well # 7
Unit Letter O	Section 30	Township 17 South	Range 29 East	County Eddy	
Actual Well Location of Well: 2310 feet from the East line and 760 feet from the South line					
Ground Level Elev. 3636.7	Producing Formation WOLFECAMP		Pool SOUTH EMPIRE-WOLFECAMP	Dedicated Acreage: 80 Acres	

1. Outline the acreage dedicated to the subject well by colored pencil or hatchure marks on the plat below.
2. If more than one lease is dedicated to the well, outline each and identify the ownership thereof (both as to working interest and royalty).
3. If more than one lease of different ownership is dedicated to the well, have the interests of all owners been consolidated by communitization, unitization, force-pooling, etc?

☐ Yes ☐ No If answer is "yes," type of consolidation _____

RECEIVED

OCT 15 1975

O. E. E.

ARTEBIA, OFFICE

If answer is "no," list the owners and tract descriptions which have actually been consolidated. (Use reverse side of this form if necessary.) _____

No allowable will be assigned to the well until all interests have been consolidated (by communitization, unitization, forced-pooling, or otherwise) or until a non-standard unit, eliminating such interests, has been approved by the Commission.

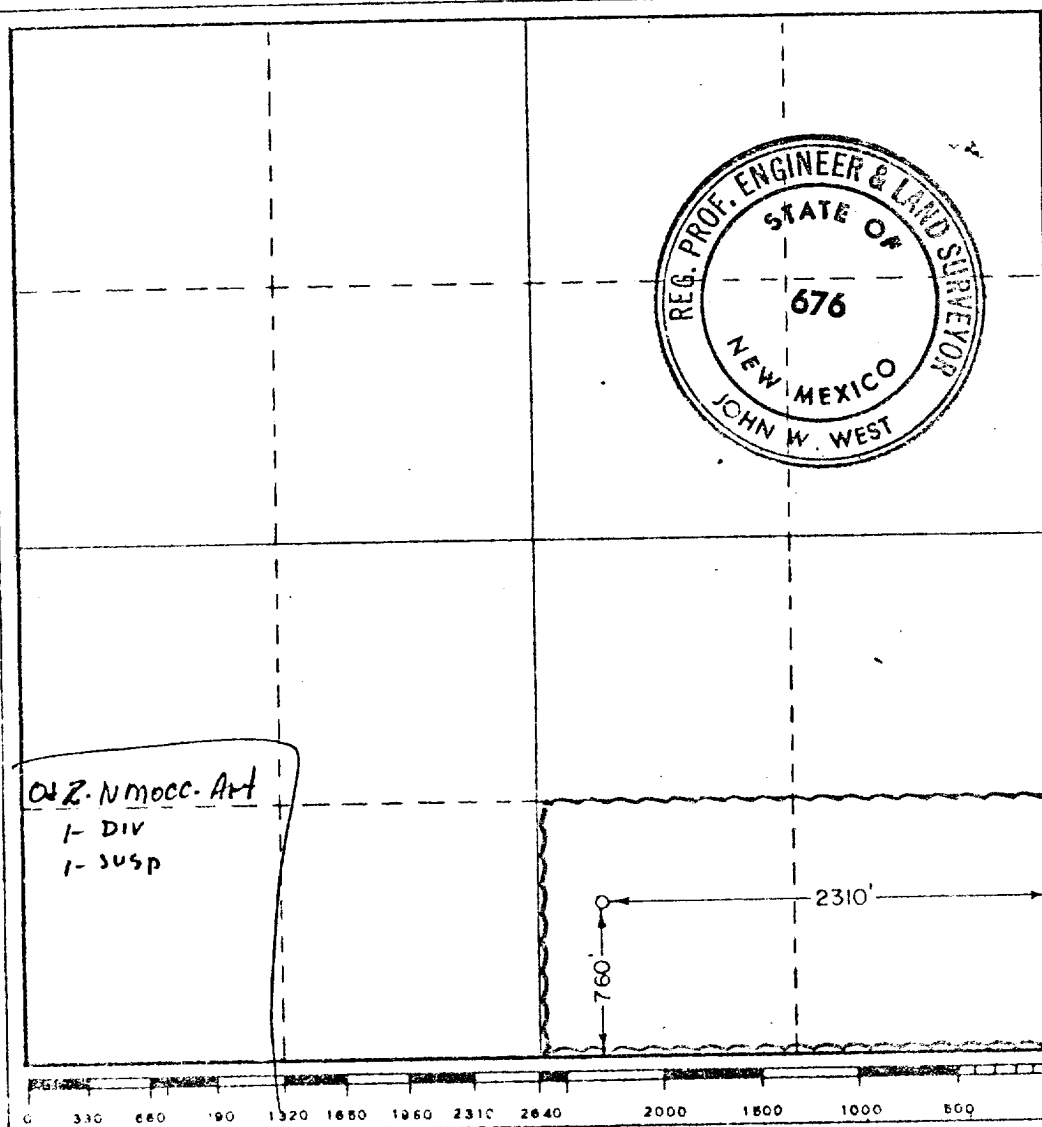

CERTIFICATION

I hereby certify that the information contained herein is true and complete to the best of my knowledge and belief.

Name *Ray R. Yorkum*
SIGNATURE
ADMINISTRATIVE ASSISTANT

Company
AMOCO PRODUCTION COMPANY

Date
10-13-75

I hereby certify that the well location shown on this plat was plotted from field notes of actual surveys made by me or under my supervision, and that the same is true and correct to the best of my knowledge and belief.

Date Surveyed
April 29, 1975

Registered Professional Engineer and/or Land Surveyor

John W. West
Certificate No. **676**