

N. M. C. C. COPY  
UNITED STATES COPY  
DEPARTMENT OF THE INTERIOR  
GEOLOGICAL SURVEYSUBMIT IN TRIPLICATE\*  
(Other instructions on  
reverse side)Form approved.  
Budget Bureau No. 42-R1425.

30-015-24610

## APPLICATION FOR PERMIT TO DRILL, DEEPEN, OR PLUG BACK

## 1a. TYPE OF WORK

DRILL ☒DEEPEN ☐PLUG BACK ☐

## b. TYPE OF WELL

OIL  
WELL ☒GAS  
WELL ☐OTHER ☐SINGLE  
ZONE ☒MULTIPLE  
ZONE ☐

## 2. NAME OF OPERATOR

General American Oil Company of Texas

## 3. ADDRESS OF OPERATOR

P. O. Box 416 Loco Hills, New Mexico 88255

## 4. LOCATION OF WELL (Report location clearly and in accordance with any State requirements.)\*

At surface

660' FWL and 990' FWL Sec. 27, T-17S, R-30E

At proposed prod. zone

## 14. DISTANCE IN MILES AND DIRECTION FROM NEAREST TOWN OR POST OFFICE\*

1-1/2 miles east of Loco Hills, New Mexico

## 15. DISTANCE FROM PROPOSED\*

LOCATION TO NEAREST

PROPERTY OR LEASE LINE, FT.

(Also to nearest drlg. unit line, if any)

660'

## 18. DISTANCE FROM PROPOSED LOCATION\*

TO NEAREST WELL, DRILLING, COMPLETED,

OR APPLIED FOR, ON THIS LEASE, FT.

990'

## 16. NO. OF ACRES IN LEASE

600

## 19. PROPOSED DEPTH

3275'

## 17. NO. OF ACRES ASSIGNED

TO THIS WELL

40

## 20. ROTARY OR CABLE TOOLS

Rotary

## 21. ELEVATIONS (Show whether DF, RT, GR, etc.)

3636 G.L.

## 22. APPROX. DATE WORK WILL START\*

8/1/75

## 23.

## PROPOSED CASING AND CEMENTING PROGRAM

SIZE OF HOLE	SIZE OF CASING	WEIGHT PER FOOT	SETTING DEPTH	QUANTITY OF CEMENT
	8-5/8"	23#	510'	100 Sacks
	4-1/2"	9.5#	3275'	350 Sacks

We propose to drill this well to 3275' to test the Premier Sand. If the Premier Sand is not commercial we will plug back to the Seven Rivers Zone.

Producing zone will be acidized or Sand fraced.

Mud Program: Water and native mud will be used and approximately 200' from bottom we will mud up to clean the hole to log.

A 10" 3000# Blowout preventor will be used in drill this well.

RECEIVED

AUG 20 1975

IN ABOVE SPACE DESCRIBE PROPOSED PROGRAM: If proposal is to deepen or plug back, give data on present productive zone and proposed new productive zone. If proposal is to drill or deepen directionally, give pertinent data on subsurface locations and measured and true vertical depths. Give blowout preventer program, if any.

24.

SIGNED

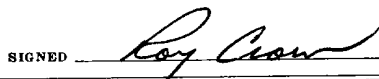

TITLE District Superintendent

DATE July 3, 1975

(This space for Federal or State office use)

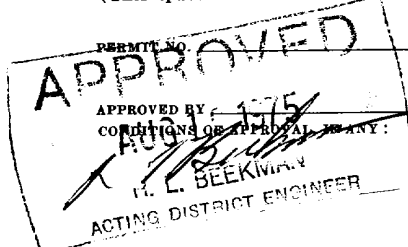

APPROVAL DATE  
THIS APPROVAL IS RESCINDED IF OPERATIONS  
ARE NOT COMMENCED WITHIN 3 MONTHS.  
EXPIRES NOV 19 1975  
Instructions On Reverse Side

RECEIVED  
JUL 8 1975  
U.S. GEOLOGICAL SURVEY  
ARTESIA, NEW MEXICO

## Instructions

**General:** This form is designed for submitting proposals to perform certain well operations, as indicated, on all types of lands and leases for appropriate action by either a Federal or a State agency, or both, pursuant to applicable Federal and/or State laws and regulations. Any necessary special instructions concerning the use of this form and the number of copies to be submitted, particularly with regard to local, area, or regional procedures and practices, either are shown below or will be issued by, or may be obtained from, the local Federal and/or State office.

**Item 1:** If the proposal is to drill to the same reservoir at a different subsurface location or to a new reservoir, use this form with appropriate notations. Consult applicable State or Federal regulations concerning subsequent work proposals or reports on the well.

**Item 4:** If there are no applicable State requirements, locations on Federal or Indian land should be described in accordance with Federal requirements. Consult local State or Federal office for specific instructions.

**Item 14:** Needed only when location of well cannot readily be found by road from the land or lease description. A plat, or plats, separate or on this reverse side, showing the roads to, and the surveyed location of, the well, and any other required information, should be furnished when required by Federal or State agency offices.

**Items 15 and 18:** If well is to be, or has been directionally drilled, give distances for subsurface location of hole in any present or objective production zone.

**Item 22:** Consult applicable Federal or State regulations, or appropriate officials, concerning approval of the proposal before operations are started.

**N. M. O. C. COPY**  
**NEW MEXICO OIL CONSERVATION COMMISSION**  
**WELL LOCATION AND ACREAGE DEDICATION PLAT**

Form C-102  
Supersedes C-128  
Effective 1-1-65

All distances must be from the outer boundaries of the Section

General American Oil Company			Lease <b>Arnold D</b>		Well No. <b>10</b>
D	27	17 South	30 East	County <b>Eddy</b>	
Acreage: 660 feet from the North line and 990 feet from the West line					
Dedicated Acreage: <b>3636.2</b>		Premier Sand		Dedicated Acreage: <b>40</b> Acres	
Grayburg-Jackson					

1. Outline the acreage dedicated to the subject well by colored pencil or hatchure marks on the plat below.
2. If more than one lease is dedicated to the well, outline each and identify the ownership thereof (both as to working interest and royalty)
3. If more than one lease of different ownership is dedicated to the well, have the interests of all owners been consolidated by communitization, unitization, force-pooling, etc?

Yes ☐ No ☐ If answer is "yes," type of consolidation \_\_\_\_\_

If answer is "no," list the owners and tract descriptions which have actually been consolidated (Use reverse side of this form if necessary.) \_\_\_\_\_

No allowable will be assigned to the well until all interests have been consolidated (by communitization, forced-pooling, or otherwise) or until a non-standard unit, eliminating such interests, has been approved by the Commission.

**RECEIVED**  
**JUL 8 1975**  
**U.S. GEOLOGICAL SURVEY**  
**ARTESIA, NEW MEXICO**

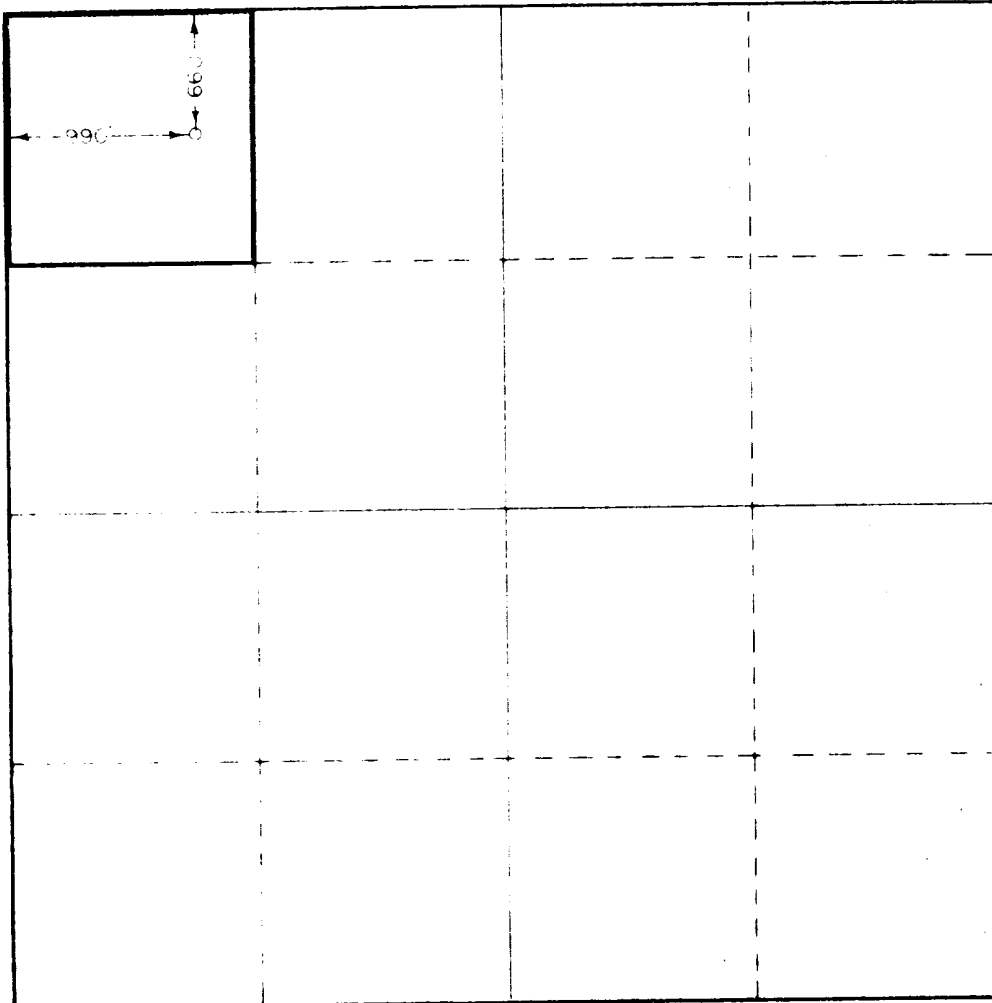

**CERTIFICATION**

I hereby certify that the information contained herein is true and complete to the best of my knowledge and belief.

Name  
**Roy Crow**

Position  
**District Superintendent**

Company  
**General American Oil Co.**

Date  
**July 7, 1975**

I hereby certify that the well location shown on this plat was plotted from field notes of actual surveys made by me or under my supervision, and that the same is true and correct to the best of my knowledge and belief.

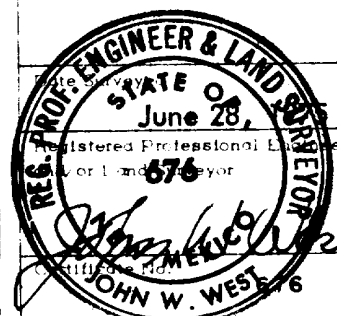

# N. M. O. C. C. COPY

## SURFACE USE CHECK LIST

GENERAL AMERICAN PROPOSED ARNOLD "D" NO. 10

Section 27, Township 17-S, Range 30-E

Eddy County, New Mexico

1. Existing main roads are shown on Exhibits "A" and "B".
2. Planned access road will require about 600' of new road that is 12 feet wide. The road will be surfaced with caliche as well as possibly 1500' of presently existing road. Proposed new road is shown on Exhibit "B".
3. The location of existing wells is shown on Exhibit "B" for a radius of one mile around the proposed well.
4. All lateral roads to the well locations for a radius of one mile around the proposed well are shown on Exhibit "B".
5. Existing flowlines are shown on Exhibit "B". The production from this well will be carried to an existing tank battery in the south portion of Section 27-17S-30E. New flowline will be laid along the 600' of road to be constructed.
6. Water supply to drill this well will be furnished through a plastic line to be laid on top of the ground from a waterflood plant in the south portion of Section 27-17S-30E. Location of the water line is shown on Exhibit "B".
7. Waste Disposal pit will be deep enough to handle waste and will be covered with 2 feet of top soil.
8. No camps are planned.
9. No airstrips will be constructed.
10. Location and layout including position of the rig, mud tanks, reserve pits, pipe racks, etc. are shown on Exhibit "C".
11. All pits used for drilling will be leveled back to their natural contours after they have dried.
12. The general topography around the well site is basically flat with sand dunes. The vegetation is mesquite, shennery, weeds and a little grass.

RECEIVED  
JUL 18 1975  
U. S. GEOLOGICAL SURVEY  
ARTESIA, NEW MEXICO

EXHIBIT "C"

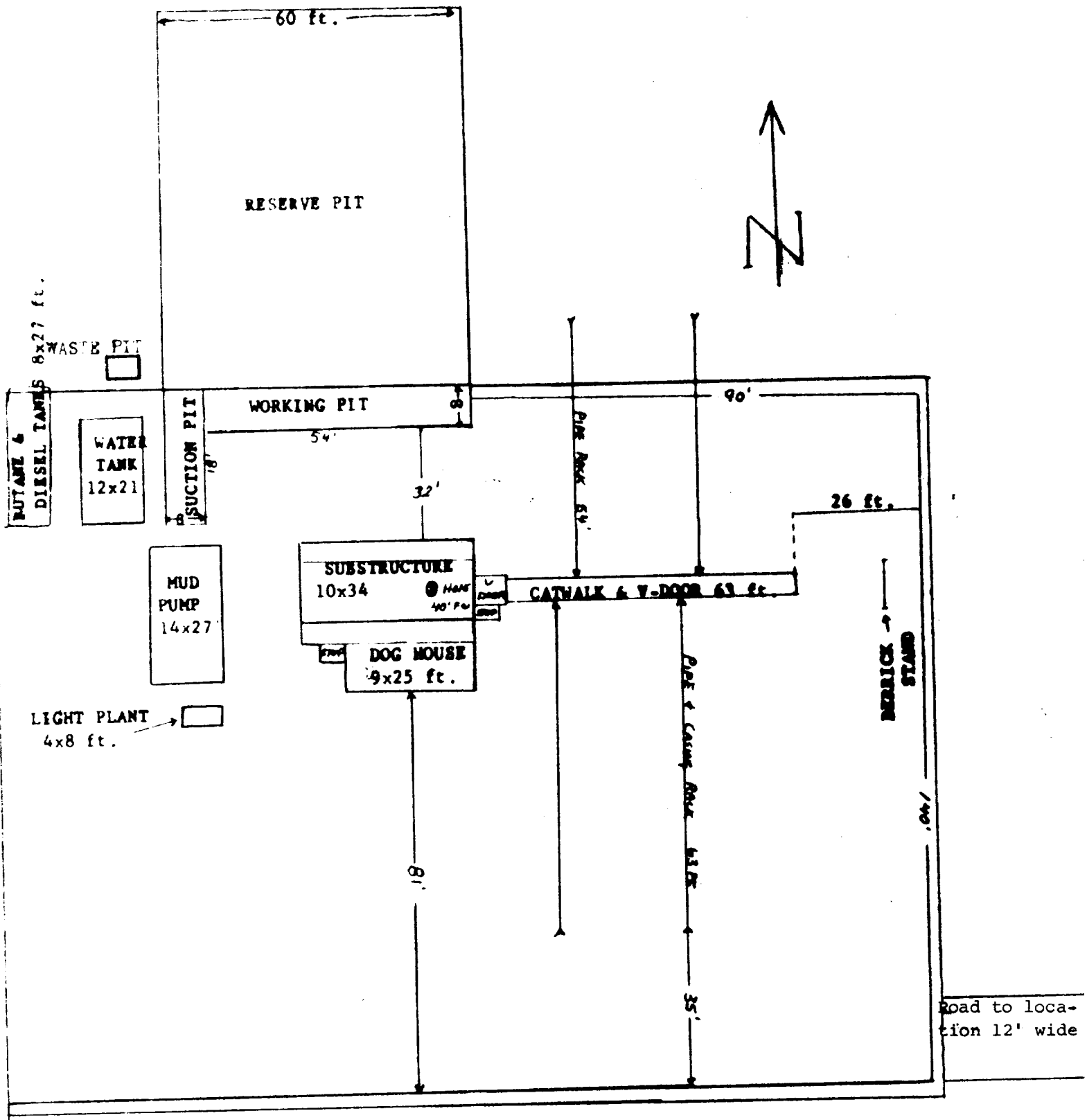
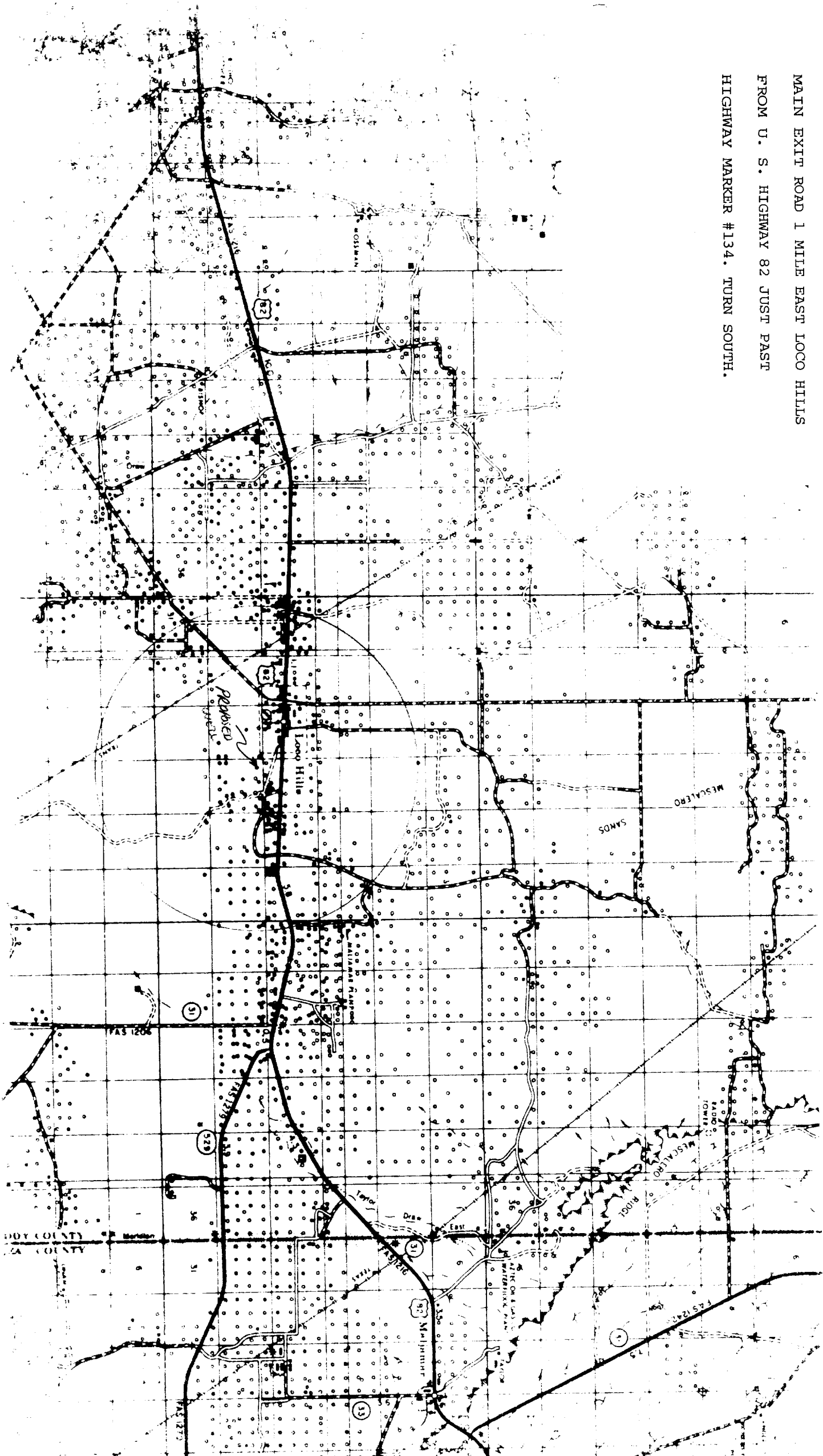

EXHIBIT "A"

MAIN EXIT ROAD 1 MILE EAST LOCO HILLS  
FROM U. S. HIGHWAY 82 JUST PAST  
HIGHWAY MARKER #134. TURN SOUTH.

Scale 1 inch = 2 Miles  
0 1 2 3 4  
STATUTE MILES



U. S. HIGHWAY 82

Highway Marker #134  
1 Mile East Loco Hills

McIntyre D LC Q29342 (d)

FRANKLIN

McIntyre I

LC Q29342 (i)

GEN. AMER

Beeson A

LC Q28936(a)

GENERAL AMERICAN

Maddren A LC Q53259 (a)

GEN AMER

Beeson A

LC Q28936 (a)

Dexter LC Q29020 (g)

FRANKLIN, ASTON & FAIR

Brigham LC Q28992 (i)

GENERAL AMERICAN

PROPOSED WELL

Federal E

LC Q28992 (b)

AMBASSADOR

Federal E

Sargent

LC Q28992 (b)

Arnold D NM 0467934 - 27  
GENERAL AMERICAN

LC Q59376

AMBASSADOR

Federal D

LC Q28992 (a)

EXHIBIT "B"

GENERAL AMERICAN OIL COMPANY

PROPOSED AMERICAN "D" #1  
SECTION 25-17N-30E  
EDDY COUNTY, NEW MEXICO

- EXISTING OIL WELLS
- EXISTING ROADS
- U.S. HIGHWAY 82
- EXISTING FLOWLINES
- PROPOSED ROADS APPROX. 12" WIDE
- PROPOSED FLOWLINE 12" WIDE
- steel on top of ground
- WATER SUPPLY FOR DEVELOPMENT
- SUGGESTED ROUTE TO LOCATIONS

Arnold D NM 0467934 - 27  
GENERAL AMERICAN

Maddren A LC Q53259 (a)

