

PHONE (505) 623-6601

HEYCO



HARVEY E. YATES COMPANY, INC.

PETROLEUM PRODUCERS

SUITE 1000 SECURITY NATIONAL BANK BUILDING

ROSWELL, NEW MEXICO 88201

January 12, 1977

In Reply
Refer To:

Mr. W. A. Gressett
State of New Mexico
Oil Conservation Commission
Post Office Drawer DD
Artesia, New Mexico 88210

Re: Empire South Deep Unit #13
Sec. 30, T-17S, R-29E
Eddy County, New Mexico

Dear Mr. Gressett:

Please find enclosed an amended application to drill for above captioned well. The previous application to drill which was submitted and approved incorrectly located the well at 1980' FWL & 660' FSL. The correct location of the well is 1597.2' from the west line and 660' from the south line. Section 30 is short on the west end and even though the location is centered in the SE/SW, the distance from the location to the west line of Sec. 30 is 1597.2' rather than 1980'. We are now applying for an unorthodox location for this well.

Very truly yours,

Fred G. Yates

RECEIVED

JAN 13 1977

**O. C. C.
ARTESIA, OFFICE**

FGY:amp
Enclosures

NEW MEXICO OIL CONSERVATION COMMISSION
WELL LOCATION AND ACREAGE DEDICATION PLAT

Form C-102
Supersedes C-128
Effective 1-1-65

All distances must be from the outer boundaries of the Section.

Operator Harvey E. Yates Company, Inc.			Lease Empire South Deep Unit		Well No. 13
Unit Letter N	Section 30	Township 17 S	Range 29 E	County Eddy	
Actual Footage Location of Well: 1597.2 feet from the west line and 660 feet from the south line					
Ground Level Elev. 3646.0	Producing Formation Morrow	Pool Empire Morrow-South, Gas	Dedicated Acreage: 296.57 Acres		

1. Outline the acreage dedicated to the subject well by colored pencil or hachure marks on the plat below.
2. If more than one lease is dedicated to the well, outline each and identify the ownership thereof (both as to working interest and royalty).
3. If more than one lease of different ownership is dedicated to the well, have the interests of all owners been consolidated by communitization, unitization, force-pooling, etc?

☒ Yes ☐ No If answer is "yes," type of consolidation Unitization

If answer is "no," list the owners and tract descriptions which have actually been consolidated. (Use reverse side of this form if necessary.)

No allowable will be assigned to the well until all interests have been consolidated (by communitization, unitization, forced-pooling, or otherwise) or until a non-standard unit, eliminating such interests, has been approved by the Commission.

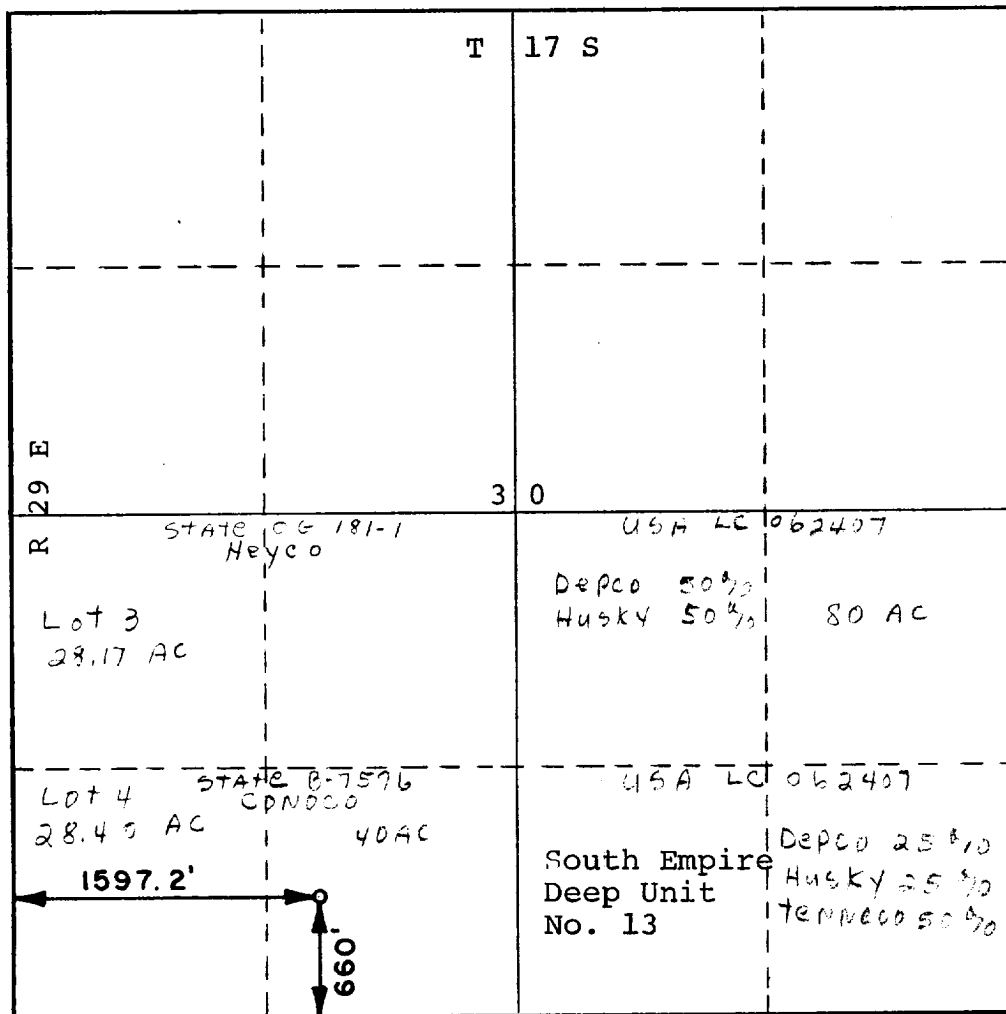

CERTIFICATION

I hereby certify that the information contained herein is true and complete to the best of my knowledge and belief.

Name
Position
Vice President
Company
Harvey E. Yates Co., Inc.
Date
January 12, 1977

I hereby certify that the well location shown on this plat was plotted from field notes of actual surveys made by me or under my supervision, and that the same is true and correct to the best of my knowledge and belief.

Date Surveyed
12/1/76
Registered Professional Engineer and/or Land Surveyor

Thomas J. Mann

Certificate No.

277 N.M.