

NO. OF COPIES RECEIVED	6
DISTRIBUTION	
SANTA FE	/
FILE	/
U.S.G.S.	2
LAND OFFICE	/
OPERATOR	/

NEW MEXICO OIL CONSERVATION COMMISSION

RECEIVED

30-015-22154  
Form C-101  
Revised 1-1-65

MAY 11 1977

O. C. C.  
ARTESIA, OFFICE

5A. Indicate Type of Lease
STATE <input checked="" type="checkbox"/> FEE <input type="checkbox"/>
5. State Oil & Gas Lease No.
B-8095

APPLICATION FOR PERMIT TO DRILL, DEEPEN, OR PLUG BACK

1a. Type of Work	DRILL <input checked="" type="checkbox"/> DEEPEN <input type="checkbox"/> PLUG BACK <input type="checkbox"/>
b. Type of Well	OIL WELL <input checked="" type="checkbox"/> GAS WELL <input type="checkbox"/> OTHER <input type="checkbox"/> SINGLE ZONE <input checked="" type="checkbox"/> MULTIPLE ZONE <input type="checkbox"/>
2. Name of Operator	Texas American Oil Corporation
3. Address of Operator	1012 Midland Savings Building - Midland, Texas 79701
4. Location of Well	UNIT LETTER E LOCATED 1850 FEET FROM THE N LINE AND 1315 FEET FROM THE W LINE OF SEC. 16 TWP. 17S RGE. 30E HMPM
19. Proposed Depth	2110
19A. Formation	Queen
20. Rotary or C.T.	Rotary
21. Elevations (Show whether DF, RT, etc.)	3690' RT
21A. Kind & Status Plug. Bond	J.S. Ward & Son
21B. Drilling Contractor	LaRue & Muncy
22. Approx. Date Work will start	May 10, 1977

7. Unit Agreement Name	-
8. Farm or Lease Name	Etz "C" State
9. Well No.	27
10. Field and Pool, or Wildcat	Grayburg Jackson
12. County	Eddy

23. PROPOSED CASING AND CEMENT PROGRAM

SIZE OF HOLE	SIZE OF CASING	WEIGHT PER FOOT	SETTING DEPTH	SACKS OF CEMENT	EST. TOP
15"	10-3/4"	40.5#	500'	200	CIRC
8-3/4"	7"	20#	2060'	400	CIRC

APPROVAL VALID  
FOR 90 DAYS UNLESS  
DRILLING COMMENCED,  
EXPIRES 8-9-77

IN ABOVE SPACE DESCRIBE PROPOSED PROGRAM; IF PROPOSAL IS TO DEEPEN OR PLUG BACK, GIVE DATA ON PRESENT PRODUCTIVE ZONE AND PROPOSED NEW PRODUCTIVE ZONE, GIVE BLOWOUT PREVENTER PROGRAM, IF ANY.

I hereby certify that the information above is true and complete to the best of my knowledge and belief.

Signed Way D. Martin Title Engineer Date May 9, 1977

Initial approval (This space for State Use)  
5-9-77

APPROVED BY W.A. Gressett TITLE SUPERVISOR, DISTRICT H DATE MAY 13 1977

CONDITIONS OF APPROVAL, IF ANY:

NSK must be approved prior to Producing

**NEW MEXICO OIL CONSERVATION COMMISSION**  
**WELL LOCATION AND ACREAGE DEDICATION AT**

Form C-102  
 Supersedes C-128  
 Effective 1-1-65

All distances must be from the outer boundaries of the Section.

Operator <b>TEXAS AMERICAN OIL CORPORATION</b>		Lease <b>ETZ State "C" Lease</b>		Well No. <b>27</b>
Unit Letter <b>"E"</b>	Section <b>16</b>	Township <b>17 South</b>	Range <b>30 East</b>	County <b>Eddy</b>
Actual Footage Location of Well: <b>1850</b> feet from the <b>North</b> line and <b>1315</b> feet from the <b>West</b> line				
Ground Level Elev. <b>3679.0</b>	Producing Formation <b>Queen</b>	Pool <b>Grayburg Jackson</b>	Dedicated Acreage: <b>40</b> Acres	

1. Outline the acreage dedicated to the subject well by colored pencil or hatchure marks on the plat below.
2. If more than one lease is dedicated to the well, outline each and identify the ownership thereof (both as to working interest and royalty).
3. If more than one lease of different ownership is dedicated to the well, have the interests of all owners been consolidated by communitization, unitization, force-pooling, etc?

☐ Yes    ☐ No    If answer is "yes," type of consolidation \_\_\_\_\_

If answer is "no," list the owners and tract descriptions which have actually been consolidated. (Use reverse side of this form if necessary.) \_\_\_\_\_

No allowable will be assigned to the well until all interests have been consolidated (by communitization, unitization, forced-pooling, or otherwise) or until a non-standard unit, eliminating such interests, has been approved by the Commission.

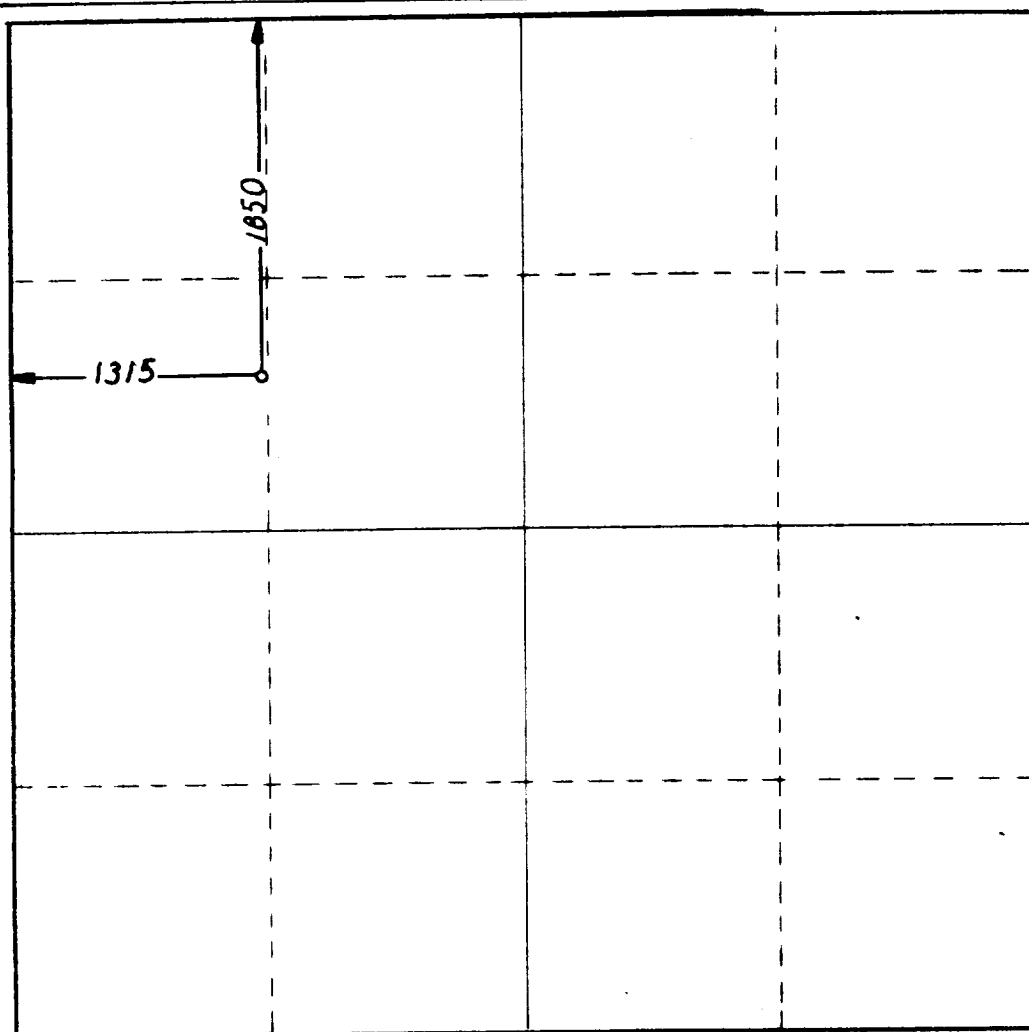

**CERTIFICATION**

I hereby certify that the information contained herein is true and complete to the best of my knowledge and belief.

*Ray J. Martin*  
 Name

Engineer

Position

Texas American Oil Corp

Company

May 10, 1977

Date

I hereby certify that the well location shown on this plat was plotted from field notes of actual surveys made by me or under my supervision, and that the same is true and correct to the best of my knowledge and belief.

Date Surveyed

*W. S. HERSHEL*

Registered Professional Engineer  
 and/or Land Surveyor

*W. S. HERSHEL*

Certificate No.

3640

TEXAS AMERICAN OIL CORPORATION



300 WEST WALL, SUITE 1012 MIDLAND, TEXAS 79701 915-683-4811

May 9, 1977

Mr. Jim Kapteina  
New Mexico Oil Conservation Commission  
Box 2088  
Santa Fe, New Mexico 87501

RE: Revised Application for Non-Standard Location  
B-8095 - Etz "C" State, Well No. 27  
Grayburg Jackson Field  
Eddy County, New Mexico

Dear Sir:

Application is made to infill drill a producing well in a revised non-standard location, in a wholly owned Queen formation waterflood project on the Etz "C" State lease. This location is required to produce secondary reserves that will otherwise be unrecovered. An adjustment in the exact location was necessary to obtain necessary clearance from a buried gas line in the area. A revised Form C-101 and Form C-102 showing the correct location are attached and copies are being transmitted to Mr. W.A. Gresset for his approval.

Yours very truly,

*Troy G. Martin*  
Troy G. Martin  
Engineer

RECEIVED

MAY 11 1977

O. C. C.  
ARTESIA, OFFICE

Attachments

cc: Mr. Bill Gresset  
Drawer DD  
Artesia, New Mexico 88210

RECEIVED

TEXAS AMERICAN OIL CORPORATION



MAY 9 1977

300 WEST WALL, SUITE 1012 MIDLAND, TEXAS 79701 915-683-4811

May 6, 1977

O. C. C.  
ARTESIA, OFFICE

Mr. J. E. Kapteina  
New Mexico Oil Conservation Commission  
Box 2088  
Santa Fe, NM 87501

RE: Application for Non-Standard Location  
B-8095 - Etz "C" State, Well No. 27  
Grayburg Jackson Field  
Eddy County, New Mexico

Dear Sir:

Application is made to infill drill a producing well in a nonstandard location in a wholly owned Queen formation waterflood project on the Etz "C" State lease. This well will also replace Etz "C" State, Well No. 17, located in this 40 acre proration unit which will be squeezed off in the Queen section and produced only from the Grayburg zone. The proposed location is required to produce secondary reserves that will otherwise be unrecovered.

Attached is a Form C-101 and C-102 along with a waterflood front plat showing the four surrounding injection wells and the trapped oil bank that will be recovered from Well No. 27. All offsetting 40 acre proration units are owned and operated by Texas American Oil Corporation. Also, attached is a Form C-101 to plug back Well No. 17, from the Queen formation and produce from the Grayburg formation.

Yours very truly,

*Troy G. Martin*

Troy G. Martin  
Engineer

Attachments

cc: Mr. W.A. Gresset  
Drawer DD  
Artesia, New Mexico 88210

NE MEXICO OIL CONSERVATION COMMISSIC  
WELL LOCATION AND ACREAGE DEDICATION PLAT

Form C-102  
Supersedes C-128  
Effective 1-1-65

All distances must be from the outer boundaries of the Section.

Operator <b>Texas American Oil Corporation</b>			Lease <b>Etz "C" State</b>		Well No. <b>27</b>
Unit Letter <b>E</b>	Section <b>16</b>	Township <b>17S</b>	Range <b>30E</b>	County <b>Eddy</b>	
Actual Footage Location of Well: <b>1850'</b> feet from the <b>North</b> line and <b>1275'</b> feet from the <b>West</b> line					
Ground Level Elev: <b>3680'</b>	Producing Formation <b>Queen</b>	Pool <b>Grayburg Jackson</b>		Dedicated Acreage: <b>40</b> Acres	

1. Outline the acreage dedicated to the subject well by colored pencil or hachure marks on the plat below.
2. If more than one lease is dedicated to the well, outline each and identify the ownership thereof (both as to working interest and royalty).
3. If more than one lease of different ownership is dedicated to the well, have the interests of all owners been consolidated by communitization, unitization, force-pooling, etc?

☐ Yes ☐ No If answer is "yes," type of consolidation \_\_\_\_\_

If answer is "no," list the owners and tract descriptions which have actually been consolidated. (Use reverse side of this form if necessary.) \_\_\_\_\_

No allowable will be assigned to the well until all interests have been consolidated (by communitization, unitization, forced-pooling, or otherwise) or until a non-standard unit, eliminating such interests, has been approved by the Commission.

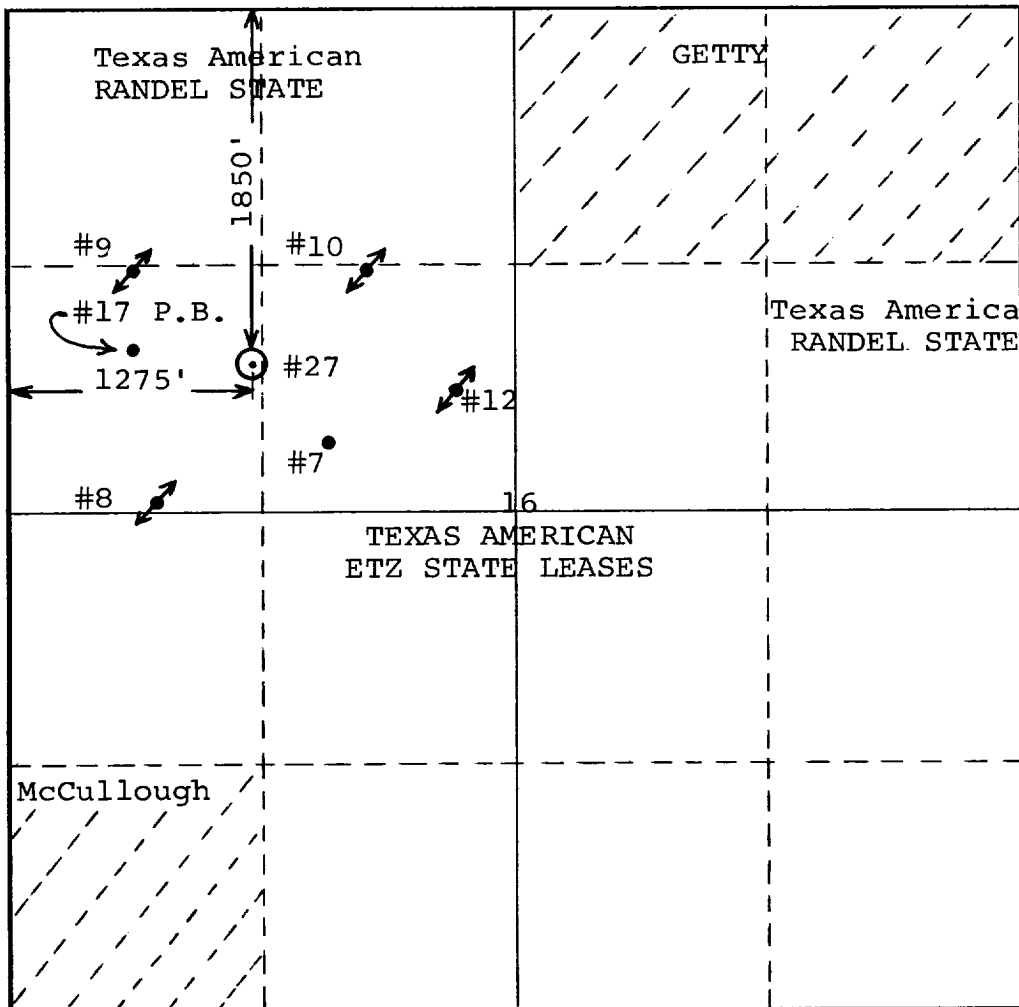

CERTIFICATION

I hereby certify that the information contained herein is true and complete to the best of my knowledge and belief.

*Gray A. Martin*

Name  
**Engineer**  
Position  
**Texas American Oil Corp.**  
Company  
**May 6, 1977**  
Date

I hereby certify that the well location shown on this plat was plotted from field notes of actual surveys made by me or under my supervision, and that the same is true and correct to the best of my knowledge and belief.

Date Surveyed

Registered Professional Engineer and/or Land Surveyor

Certificate No.