

UNITED STATES
DEPARTMENT OF THE INTERIOR

GEOLOGICAL SURVEY

APPLICATION FOR PERMIT TO DRILL, DEEPEN, OR PLUG BACK

1a. TYPE OF WORK

DRILL ☒DEEPEN ☐PLUG BACK ☐

b. TYPE OF WELL

OIL
WELL ☐GAS
WELL ☒SINGLE
ZONE ☒MULTIPLE
ZONE ☐

2. NAME OF OPERATOR

Anadarko Production Company

JUN 13 1977

3. ADDRESS OF OPERATOR

P. O. Box 67, Loco Hills, New Mexico 88205 C. C.

4. LOCATION OF WELL (Report location clearly and in accordance with any State requirements.)

At surface

1990' FNL & 1970' FEL Sec. 29, T-17S, R-30E
Eddy County, New Mexico

At proposed prod. zone Same

14. DISTANCE IN MILES AND DIRECTION FROM NEAREST TOWN OR POST OFFICE*

3/4 mile Southwest of Loco Hills Townsite

15. DISTANCE FROM PROPOSED*

LOCATION TO NEAREST

PROPERTY OR LEASE LINE, FT.

(Also to nearest drlg. unit line, if any)

670'

16. NO. OF ACRES IN LEASE

320

17. NO. OF ACRES ASSIGNED
TO THIS WELL

320

18. DISTANCE FROM PROPOSED LOCATION*

TO NEAREST WELL, DRILLING, COMPLETED,
OR APPLIED FOR, ON THIS LEASE, FT.

None

19. PROPOSED DEPTH

11,400'

20. ROTARY OR CABLE TOOLS

Rotary

21. ELEVATIONS (Show whether DF, RT, GR, etc.)

3609 GL

22. APPROX. DATE WORK WILL START*

June, 1977

23.

PROPOSED CASING AND CEMENTING PROGRAM

SIZE OF HOLE	SIZE OF CASING	WEIGHT PER FOOT	SETTING DEPTH	QUANTITY OF CEMENT
17 1/2"	13 3/8"	48#	400'	500 sacks
12 1/4"	9 5/8"	36#	3,500'	1000 sacks
7 7/8"	4 1/2"	11.6# & 13.5#	11,400'	900 sacks

1. Rig up rotary tools.
 2. Drill approximately 400', set and cement 13 3/8" casing; install 2 M - 13 3/8" Rd double ram hydraulic blowout preventor.
 3. Drill to approximately 3,500', run Open Hole logs, set and cement 9 5/8" casing with 1000 sacks to cover Fren-Seven Rivers Zone. Remove 2M blowout preventor and install 5 M - 9 5/8" SRRA double ram hydraulic blowout preventor.
 4. Drill to approximately 11,400', run Open Hole logs and possibly one or more drill stem tests, set and cement 4 1/2" casing with 900 sacks to cover any production zones encountered. 11,000' of 4 1/2" casing will be 11.6# with 400' of 13.5# on top.
 5. Perforate Morrow or Atoka gas zones, treat zones if necessary.
 6. Equip for production.
 7. Place well on production.
- Gas sales not led back*

IN ABOVE SPACE DESCRIBE PROPOSED PROGRAM: If proposal is to deepen or plug back, give data on present productive zone and proposed new productive zone. If proposal is to drill or deepen directionally, give pertinent data on subsurface locations and measured and true vertical depths. Give blowout preventer program, if any.

24.

Original Signed by

SIGNED Jerry L. Buckles

TITLE

Area Supervisor

DATE

March 2, 1977

(This space for Federal or State office use)

PERMIT NO.

APPROVAL DATE

APPROVED

CONDITIONS OF APPROVAL, IF ANY:

JUN 10 1977

R. L. MEARMAN
ACTING DISTRICT ENGINEERTHIS APPROVAL IS RESCINDED IF OPERATIONS
ARE NOT COMMENCED WITHIN 3 MONTHS.
EXPIRES SEP 10 1977

*See Instructions On Reverse Side

Instructions

General: This form is designed for submitting proposals to perform certain well operations, as indicated, on all types of lands and leases for appropriate action by either a Federal or a State agency, or both, pursuant to applicable Federal and/or State laws and regulations. Any necessary special instructions concerning the use of this form and the number of copies to be submitted, particularly with regard to local, area, or regional procedures and practices, either are shown below or will be issued by, or may be obtained from, the local Federal and/or State office.

Item 1: If the proposal is to redrill to the same reservoir at a different subsurface location or to a new reservoir, use this form with appropriate notations. Consult applicable State or Federal regulations concerning subsequent work proposals or reports on the well.

Item 4: If there are no applicable State requirements, locations on Federal or Indian land should be described in accordance with Federal requirements. Consult local State or Federal office for specific instructions.

Item 14: Needed only when location of well cannot readily be found by road from the land or lease description. A plat, or plats, separate or on this reverse side, showing the roads to, and the surveyed location of, the well, and any other required information, should be furnished when required by Federal or State agency offices.

Items 15 and 18: If well is to be, or has been directionally drilled, give distances for subsurface location of hole in any present or objective production zone.

Item 22: Consult applicable Federal or State regulations, or appropriate officials, concerning approval of the proposal before operations are started.

**NEW MEXICO OIL CONSERVATION COMMISSION
WELL LOCATION AND ACREAGE DEDICATION PLAT**

Form C-102
Supersedes C-128
Effective 1-1-65

All distances must be from the outer boundaries of the Section.

Operator ANADARKO PRODUCTION CO.			Lease LOCO HILLS FEDERAL COM. - 2		Well No. 19
Unit Letter "G"	Section 29	Township 17 South	Range 30 East	County EDDY	
Actual Footage Location of Well: 1990 feet from the NORTH line and 1970 feet from the EAST line					
Ground Level Elev. 3609	Producing Formation Atoka-Morrow		Pool S. Loco Hills Morrow	Dedicated Acreage: 320 Acres	

1. Outline the acreage dedicated to the subject well by colored pencil or hachure marks on the plat below.
2. If more than one lease is dedicated to the well, outline each and identify the ownership thereof (both as to working interest and royalty).
3. If more than one lease of different ownership is dedicated to the well, have the interests of all owners been consolidated by communitization, unitization, force-pooling, etc?

☒ Yes ☐ No If answer is "yes," type of consolidation Communitization

If answer is "no," list the owners and tract descriptions which have actually been consolidated. (Use reverse side of this form if necessary.) _____

No allowable will be assigned to the well until all interests have been consolidated (by communitization, unitization, forced-pooling, or otherwise) or until a non-standard unit, eliminating such interests, has been approved by the Commission.

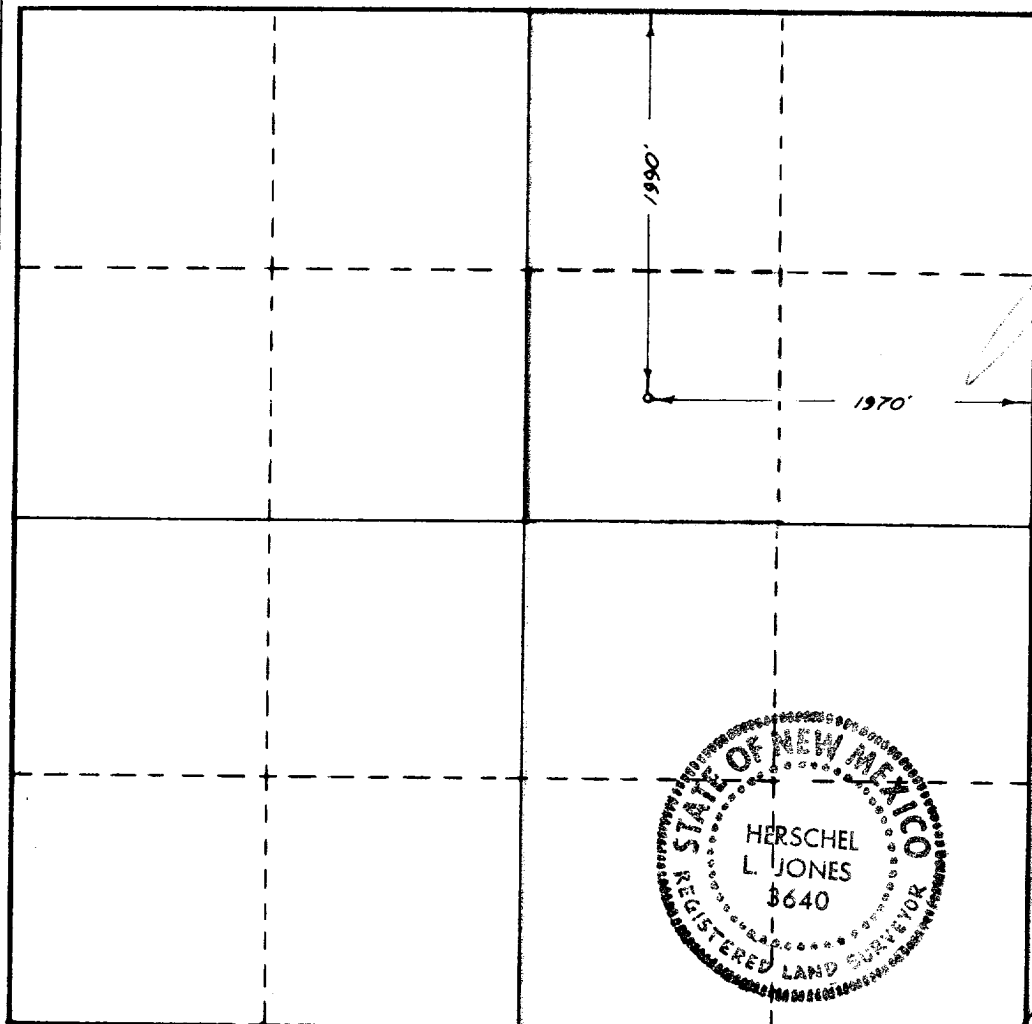

CERTIFICATION

I hereby certify that the information contained herein is true and complete to the best of my knowledge and belief.

Name

James E. Ancker
Area Supervisor

Position

Anadarko Production Co.

Company

March 2, 1977

Date

I hereby certify that the well location shown on this plat was plotted from field notes of actual surveys made by me or under my supervision, and that the same is true and correct to the best of my knowledge and belief.

Date Surveyed

2/24/77

Registered Professional Engineer and/or Land Surveyor

Certificate No.

3640

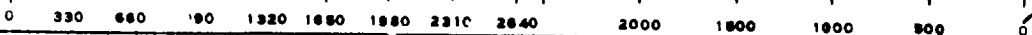

10/10/10

10/10/10

10/10/10

10/10/10



GENERAL OFFICE
P. O. BOX 9317
FORT WORTH, TEXAS 76107

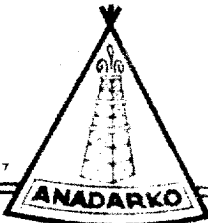

ANADARKO PRODUCTION COMPANY

1014 W. AVENUE K
AREA CODE 505 396-4018

LOVINGTON, NEW MEXICO 88260
CABLE ADDRESS: ANDARK

P. O. Box 67
Loco Hills, New Mexico 88255
February 23, 1977

United States Geological Survey
P. O. Drawer U
Artesia, New Mexico 88210

Gentlemen:

Following is the "Surface Use and Operation Plan" for the drilling of the Anadarko Production Company Loco Hills Federal "Communitization" Well No. 1 located 1990' FNL and 1970' FEL of Section 29, Township 17 South, Range 30 East, Eddy County, New Mexico. This well is planned for gas production.

1. Existing Roads - A map is attached showing the hard surfaced county road (black), which bisects Section 29 of Township 17-S, Range 30-E.

Other caliche or sandy lease roads are shown small black lines.

The existing road (orange) leading to Franklin, Aston and Fair's Fed. EX Well No. 1 will be utilized. Our well will be located 14 feet Southeast of the EX #1.

2. Planned Access Roads - Only existing roads will be utilized.

3. Location of Existing Wells - The enclosed map indicates all existing wells in the area, both active and plugged and abandoned. At this time there are no exploratory wells being drilled within a two mile radius.

4. Location of Tank Batteries, Production Facilities, and Production Gathering and Service Lines - If production is established, all production facilities will be constructed on drill site and will consist of the following: Two 500 bbl. condensate sales tanks, separator, heater-treater and a 210 bbl. produced water storage tank. These facilities are shown on an attached plat.

RECEIVED

MAR 14 1977

U.S. GEOLOGICAL SURVEY
ARTESIA, NEW MEXICO

5. Location and Type of Water Supply - Fresh water to be used at drilling site will be furnished by Double Eagle Water Co. (City of Carlsbad). The Double Eagle Water Line is indicated by a red line on enclosed map.

Brine water (if used) will be brought to location by truck from Potash Mine Area. All transportation of brine water by truck will be on hard surfaced roads maintained by State Highway Department and Eddy County.

6. Source of Construction Materials - An existing caliche pit is indicated by light green area of enclosed map. This pit is located in SE $\frac{1}{4}$ of SW $\frac{1}{4}$ of Section 21. An existing caliche road will be used to truck the caliche to the hard surfaced county road and then to the location.

This pit was used by Anadarko approximately five months ago to build an offset location for our Loco Hills Federal Comm. Well No. 1.

7. Methods for Handling Waste Disposal - Enclosed drill site plat indicates location of drilling pits, reserve pit and a rubbish pit. The reserve pit will be lined with a plastic water-proof material. After a sufficient time has passed to allow drilling fluids to dry, all pits will be closed and leveled. A rubbish pit adjacent to drill site will be sufficiently deep to contain all rubbish when covered and leveled. This proposed well is anticipated to be a gas producer, therefore, we do not expect to recover any oil during tests. All water produced during tests will be transferred by truck to Anadarko's Water Injection Station at our Premier Federal L & M Waterflood Project in adjoining Section 31.

8. Ancillary Facilities - There are no camps or airstrips planned.

9. Well Site Layout - Well site has been staked and is indicated by purple area on enclosed map. A plat of drilling site is also enclosed. Drilling Site is an old abandoned caliche pad and well. The old well name and number is Franklin, Aston and Fair's Federal EX Well No. 1. This abandoned location will need to be expanded to approximately twice its original size in order to accommodate the larger rig needed to drill this 11,400' well. The immediate area surrounding this abandoned location is a sandy area covered by sparse native vegetation and is very flat.

Before and After Cross-section is shown below:

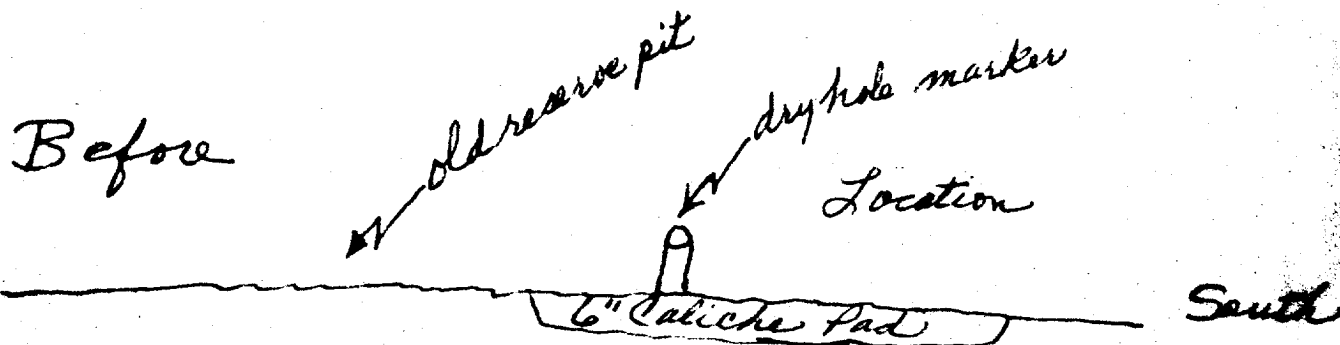

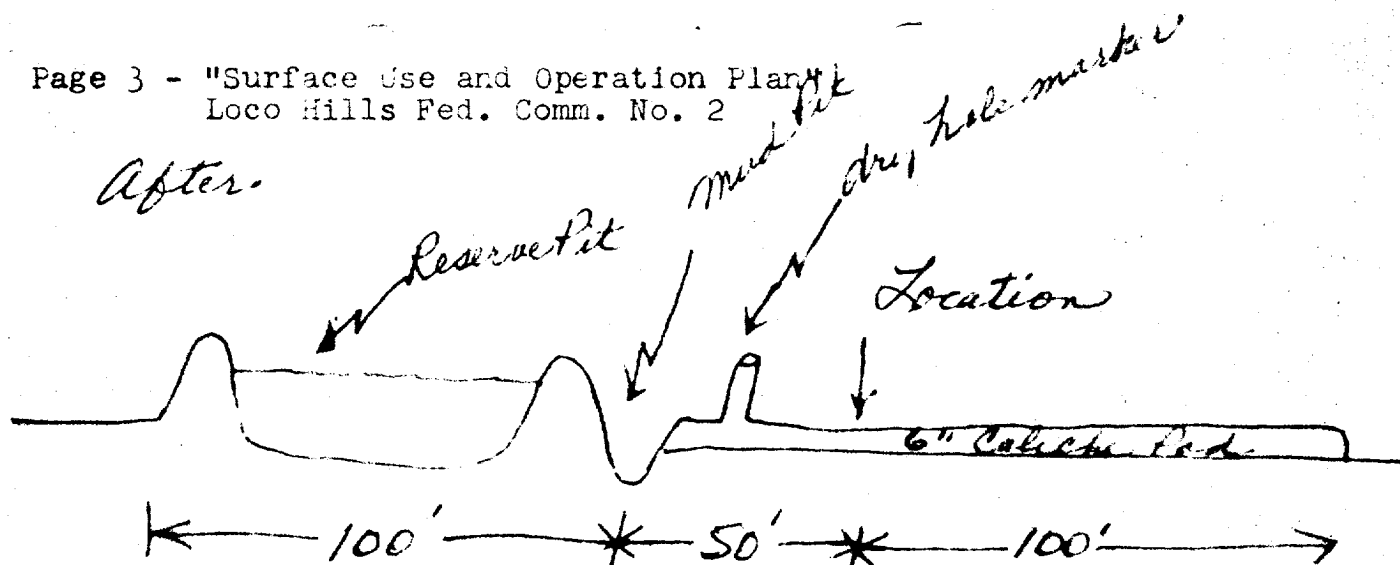

10. Plans for Restoration of Surface

Commercial Well

Reshaped Topography - The area of mud pits, reserve pit and trash pit will be leveled as they were prior to construction.

Waste Disposal - Waste will be buried upon completion of drilling operations. All future trash will be carried away by individuals who generate same.

Caliche Pad - Caliche pad will remain intact until well is abandoned.

Road - This 90' of caliche road will remain intact until well is abandoned.

Timetable - Each pay zone is expected to have an estimated life of seven years. The number of pay zones should vary from none to as many as four.

Plugged and Abandoned Well

Reshaped Topography - The original topography was predominantly flat. Anadarko will level this location.

Waste Disposal - Waste will be buried.

Caliche Pad - The pad will be ripped up and mixed with the sand.

Road - The road will be ripped up and mixed with the sand.

Flora - Sparse grass and weeds should quickly reclaim this disturbed area.

Timetable - Within 60 days of abandonment Anadarko will complete their restoration efforts.

11. Other Information

Topography - Flat

Soil Characteristics - Unconsolidated sand

Geologic Features - Sandy desert

Flora - Sparse grass and weeds

Fauna - Rabbits, rats, birds and snakes

Other Surface Use Activity - Leased grazing land

Surface Ownership - Federal land

Water Wells - None

Lakes, Streams & Ponds - None

Gullies - None

Dwellings - None

Other Facilities - None

Archaeological Sites - None

Historical Sites - None

Cultural Sites - None

12. Operator's Representative - Jerry E. Buckles
Anadarko Production Company
Area Supervisor

Office Phone- 505-677-2411
Home Phone - 505-396-4036

13. Certification - I hereby certify that I, or persons under my direct supervision, have inspected the proposed drillsite and access route; that I am familiar with the conditions which presently exist; that the statements made in this plan are, to the best of my knowledge, true and correct; and, that the work associated with the operations proposed herein will be performed by Sweatt Construction Company and it's contractors and sub-contractors in conformity with this plan and the terms and conditions under which it is approved.

February 23, 1977

Name and Title

, Area Supervisor

Franklin

At Rich

Franklin

Franklin

Franklin

*Hard Surface
County Road*

Hedco

6

3428

6875

2

Brigham

McIntyre "B"

McIntyre "E" U.S. "McIntyre" A

"McIntyre" A

Aston - Fair
Franklin

Franklin

Anadarko

3440

So. Union

Aston - Fair
Franklin

3476

*Northco Hills
Federal Comm #2*

*Electrical
High line poles*

Beepart

Fed. EX

29

Federal "K"

General American

Anadarko

Benson "F"

Federal "T"

Federal "S"

Cites

Gen Amer

Newmont

Gulf

Anad

Mc Kean

Collins

"LOCO HILLS"

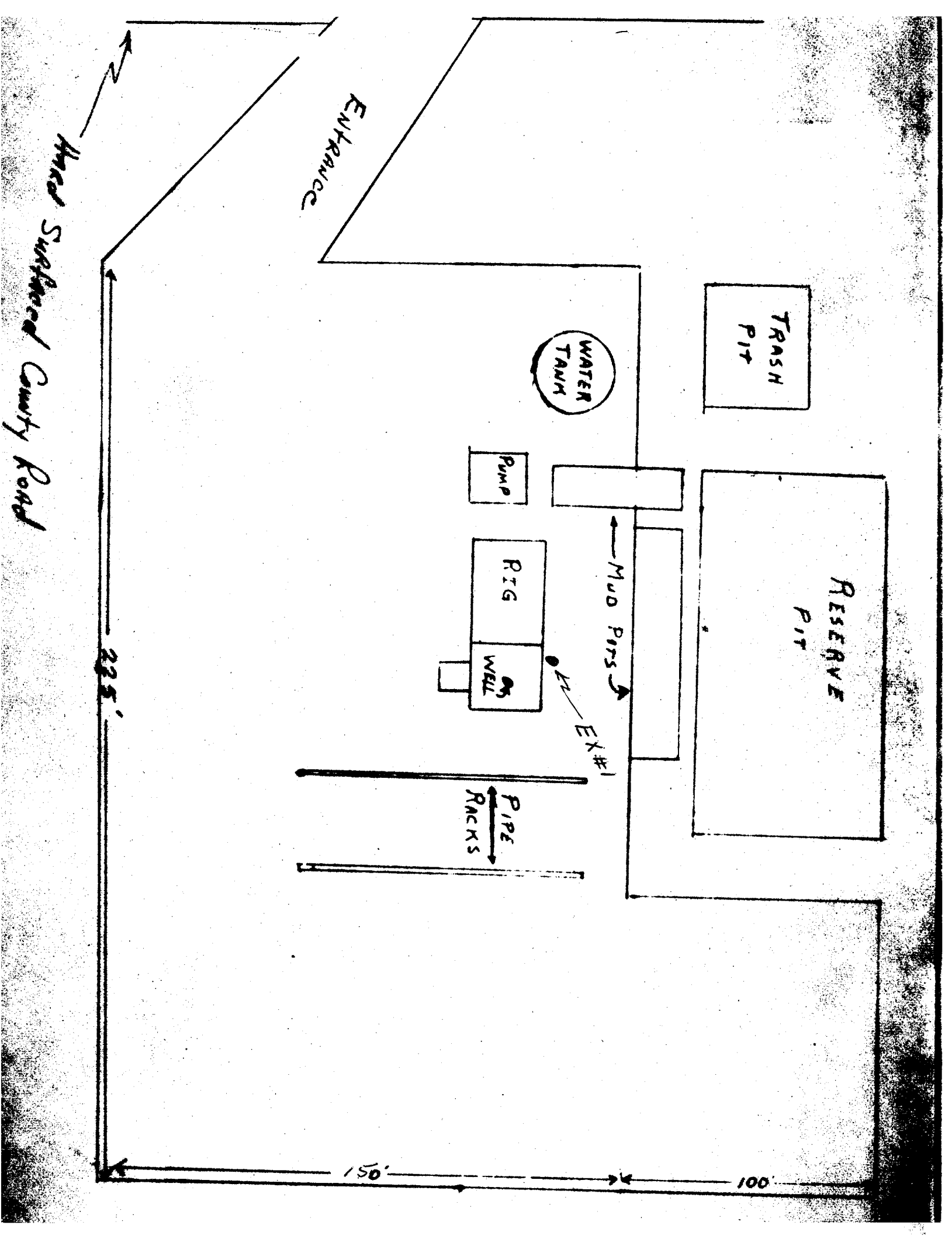

GENERAL OFFICE
P. O. BOX 9317
FORT WORTH, TEXAS 76107



ANADARKO PRODUCTION COMPANY

1014 W. AVENUE K
AREA CODE 505 396-4018

LOVINGTON, NEW MEXICO 88260
CABLE ADDRESS ANDARK

Proposed Production Facilities

No. 1- Loco Hills FEDERAL Comm. ~~AE~~ 2"

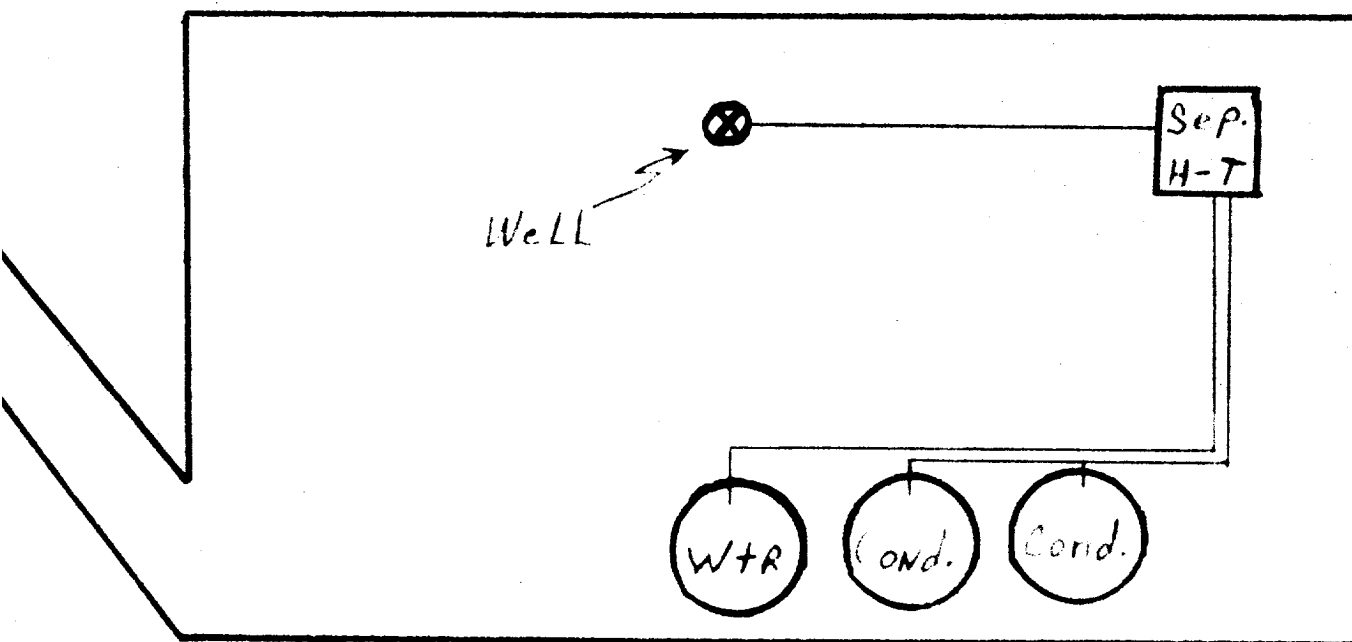

S. M. O. E. E. CO.

ANADARKO PRODUCTION COMPANY

GENERAL OFFICE
P. O. BOX 9317
FORT WORTH, TEXAS 76107

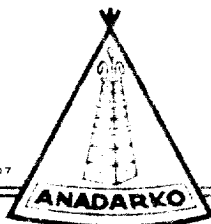

1014 W. AVENUE K
AREA CODE 505 396-4018

LOVINGTON, NEW MEXICO 88260
CABLE ADDRESS: ANDARK

P. O. Box 67
Loco Hills, New Mexico 88255
March 16, 1977

United States Geological Survey
P. O. Drawer U
Artesia, New Mexico 88210

The following amendment applies to the recent "Surface Use and Operation Plan", Item No. 9 - Well Site Layout, filed regarding the Loco Hills Federal Comm. 2, Well No. 1 located 1990' FNL & 1970' FEL of Sec. 29, Township 17 South, Range 30 East, Eddy County, New Mexico

The pipeline shown as orange on the attached wellsite plat will require us to construct a long narrow reserve pit extending almost the full length (200') of the location.

9. Well Site Layout - Same Location

RECEIVED

MAR 17 1977

U.S. GEOLOGICAL SURVEY
ARTESIA, NEW MEXICO

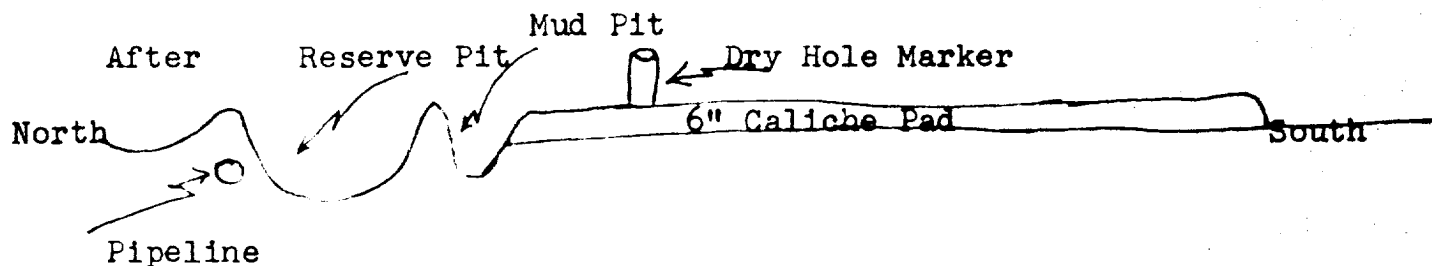
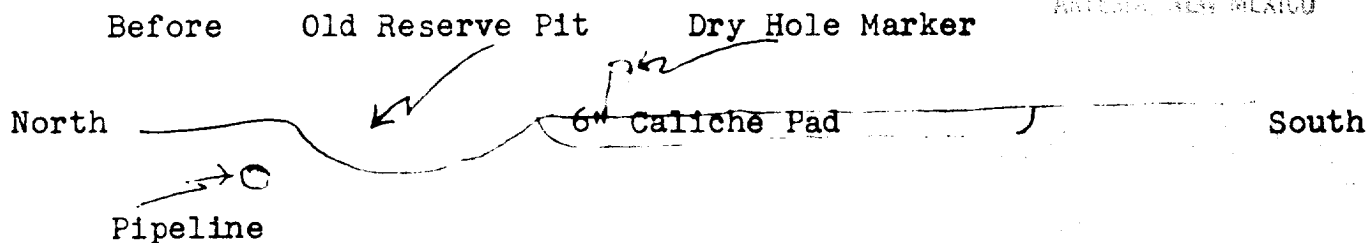

Pipeline

↑ North

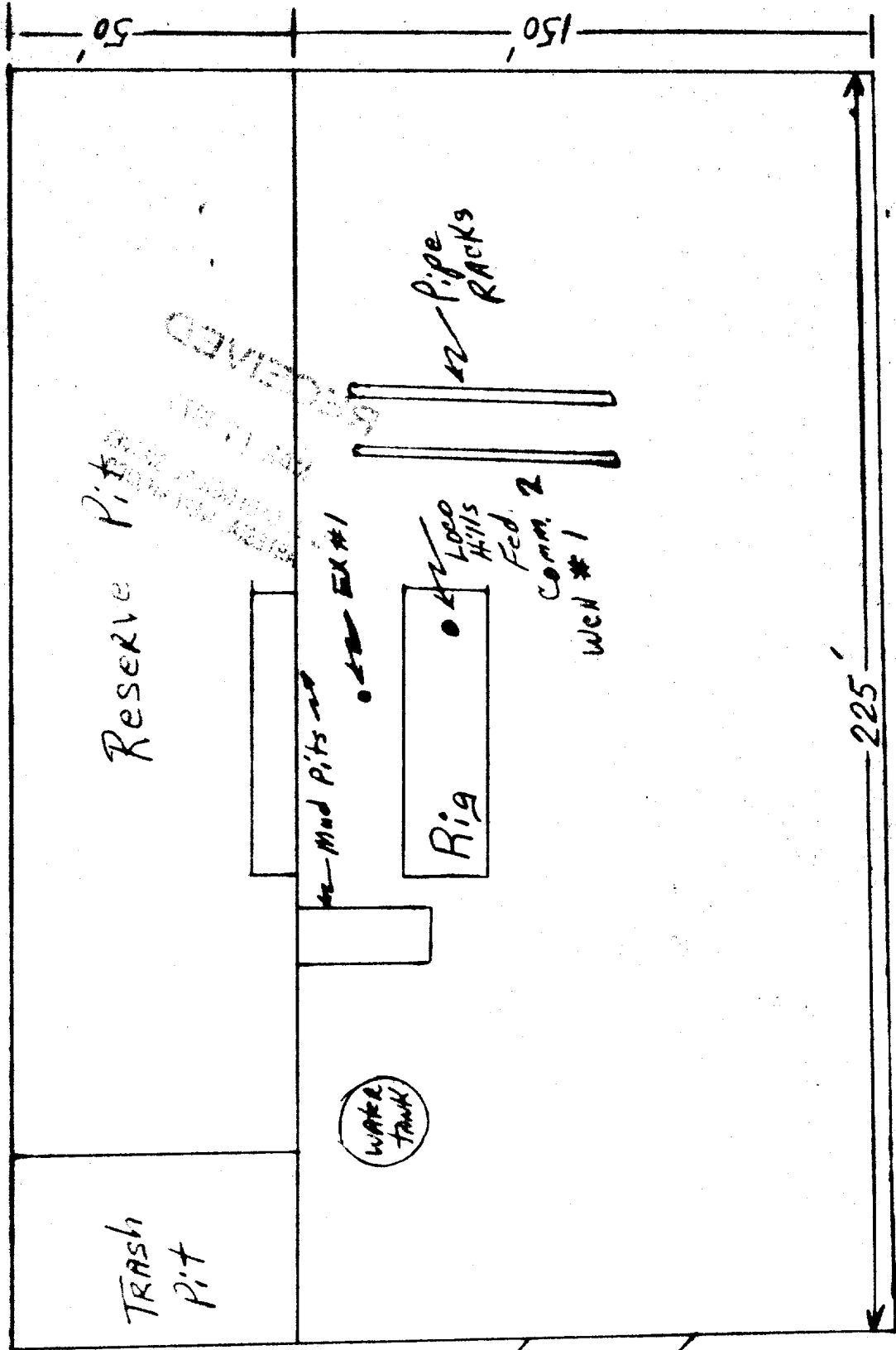

Revised Well Site Layout - Necessary because of the orange Pipeline shown Above.

RECEIVED

RECEIVED
MAR 17 1977

U.S. GEOLOGICAL SURVEY
ARTESIA, NEW MEXICO