

NMOCC COPY

SUBMIT IN TRIPLICATE*
(Other Inst: 105 00
reverse side)copy to DF
Form approved.
Budget Bureau No. 42-R1425.UNITED STATES
DEPARTMENT OF THE INTERIOR
GEOLOGICAL SURVEY

30-015-22382

APPLICATION FOR PERMIT TO DRILL, DEEPEN, OR PLUG BACK

1a. TYPE OF WORK

DRILL ☒DEEPEN ☐DECPUG BACK ☐

b. TYPE OF WELL

OIL
WELL ☐GAS
WELL ☒

OTHER

2. NAME OF OPERATOR

General American Oil Company of Texas

3. ADDRESS OF OPERATOR

P. O. Box 128, Loco Hills, New Mexico 88255

4. LOCATION OF WELL (Report location clearly and in accordance with any State requirements.)*

At surface

1980' FNL and 760' FEL of Section 30, T. 17-S, R. 30-E.

At proposed prod. zone

14. DISTANCE IN MILES AND DIRECTION FROM NEAREST TOWN OR POST OFFICE*

1 1/2 Miles West of Loco Hills

10. DISTANCE FROM PROPOSED*

LOCATION TO NEAREST
PROPERTY OR LEASE LINE, FT.
(Also to nearest drilg. unit line, if any)

760'

18. DISTANCE FROM PROPOSED LOCATION*

TO NEAREST WELL, DRILLING, COMPLETED,
OR APPLIED FOR, ON THIS LEASE, FT.

100'

21. ELEVATIONS (Show whether DF, RT, GR, etc.)

3586.4 GR

23.

PROPOSED CASING AND CEMENTING PROGRAM

SIZE OF HOLE	SIZE OF CASING	WEIGHT PER FOOT	SETTING DEPTH	QUANTITY OF CEMENT
15"	11 3/4"		500'	Circulate
11"	8 5/8"		3500'	750 sacks
7 7/8"	5 1/2"		11550'	350 sacks

We propose to drill this well to 11,550' and complete in the Morrow Formation.

All zones indicating porosity will be acidized or sand fraced.

Interval	Type Mud	Wt.	Visc.	W. L.
Mud Program: 0 - 500'	Fresh Water	8.4 - 8.6	30 - 32	NC
500' - 3,500'	Salt Water	8.8 - 9.0	28 - 30	NC
3,500' - 8,000'	Fresh Water	8.4 - 8.6	28 - 30	NC
8,000' - 10,000'	KCL Fluid	8.6 - 9.3	30 - 36	10 - 15 cc
10,000' - 11,550'	KCL & Drispac	9.1 - 9.5	33 - 36	4 - 6 cc

Blowout Preventer diagram attached.

Gas Sales not dedicated!

IN ABOVE SPACE DESCRIBE PROPOSED PROGRAM: If proposal is to deepen or plug back, give data on present productive zone and proposed new productive zone. If proposal is to drill or deepen directionally, give pertinent data on subsurface locations and measured and true vertical depths. Give blowout preventer program, if any.

24.

SIGNED

Randall Hawkins

TITLE Asst Field Superintendent

DATE December 2, 1977

(This space for Federal or State office use)

PERMIT NO.

APPROVAL DATE

DEC 20 1977

APPROVED BY

Joe D. Lara

TITLE ACTING DISTRICT ENGINEER

DATE DEC 20 1977

CONDITIONS OF APPROVAL, IF ANY:

THIS APPROVAL IS RESCINDED IF OPERATIONS
ARE NOT COMMENCED WITHIN 3 MONTHS.

EXPIRES MAR 20 1978

*See Instructions On Reverse Side

N. MEXICO OIL CONSERVATION COMMISS
WELL LOCATION AND ACREAGE DEDICATION PLAT

Form C-102
Supersedes C-128
Effective 1-1-65

All distances must be from the outer boundaries of the Section

Operator General American Oil Co. of Texas			Lease Grayburg Deep Unit		Well No. 8
Tract Letter H	Section 30	Township 17 South	Range 30 East	County Eddy	
Actual Footage Location of Well: <div style="display: flex; justify-content: space-between;"> 1980 feet from the North line and 760 feet from the East line </div>					
Ground Level Elev. 3586.4	Producing Formation Morrow	Pool Loco Hills Morrow		Dedicated Acreage: 320 Acres	

1. Outline the acreage dedicated to the subject well by colored pencil or hard pencil on the plat below.
2. If more than one lease is dedicated to the well, outline each and identify the ownership thereof (both as to working interest and royalty).
3. If more than one lease of different ownership is dedicated to the well, have the interests of all owners been consolidated by communitization, unitization, force-pooling, etc?

RECEIVED
DEC 6 1977
U.S. GEOLOGICAL SURVEY
ARTESIA, NEW MEXICO

☐ Yes ☐ No If answer is "yes," type of consolidation _____

If answer is "no," list the owners and tract descriptions which have actually been consolidated. (Use reverse side of this form if necessary.) _____

No allowable will be assigned to the well until all interests have been consolidated (by communitization, unitization, forced-pooling, or otherwise) or until a non-standard unit, eliminating such interests, has been approved by the Commission.

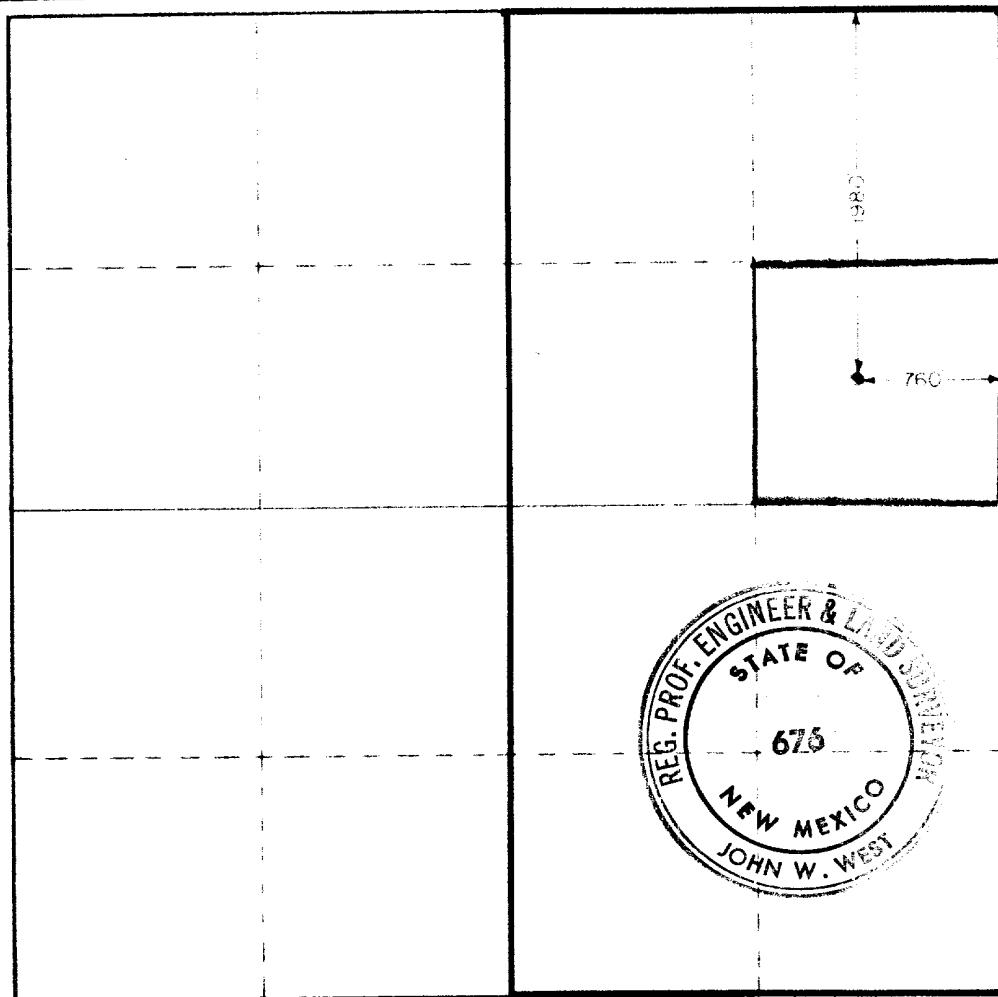

CERTIFICATION

I hereby certify that the information contained herein is true and complete to the best of my knowledge and belief.

Lendell Hawkins
Name

Lendell Hawkins

Position

Asst. Field Superintendent

Company

General American Oil Co. of Texas

Date

December 2, 1977

I hereby certify that the well location shown on this plat was plotted from field notes of actual surveys made by me or under my supervision, and that the same is true and correct to the best of my knowledge and belief.

Date Surveyed

Nov. 23, 1977

Registered Professional Engineer and Land Surveyor

John W. West

Certificate No.

676

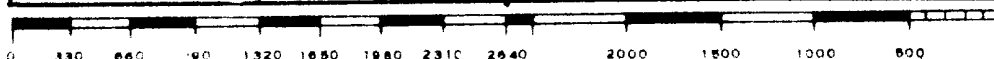

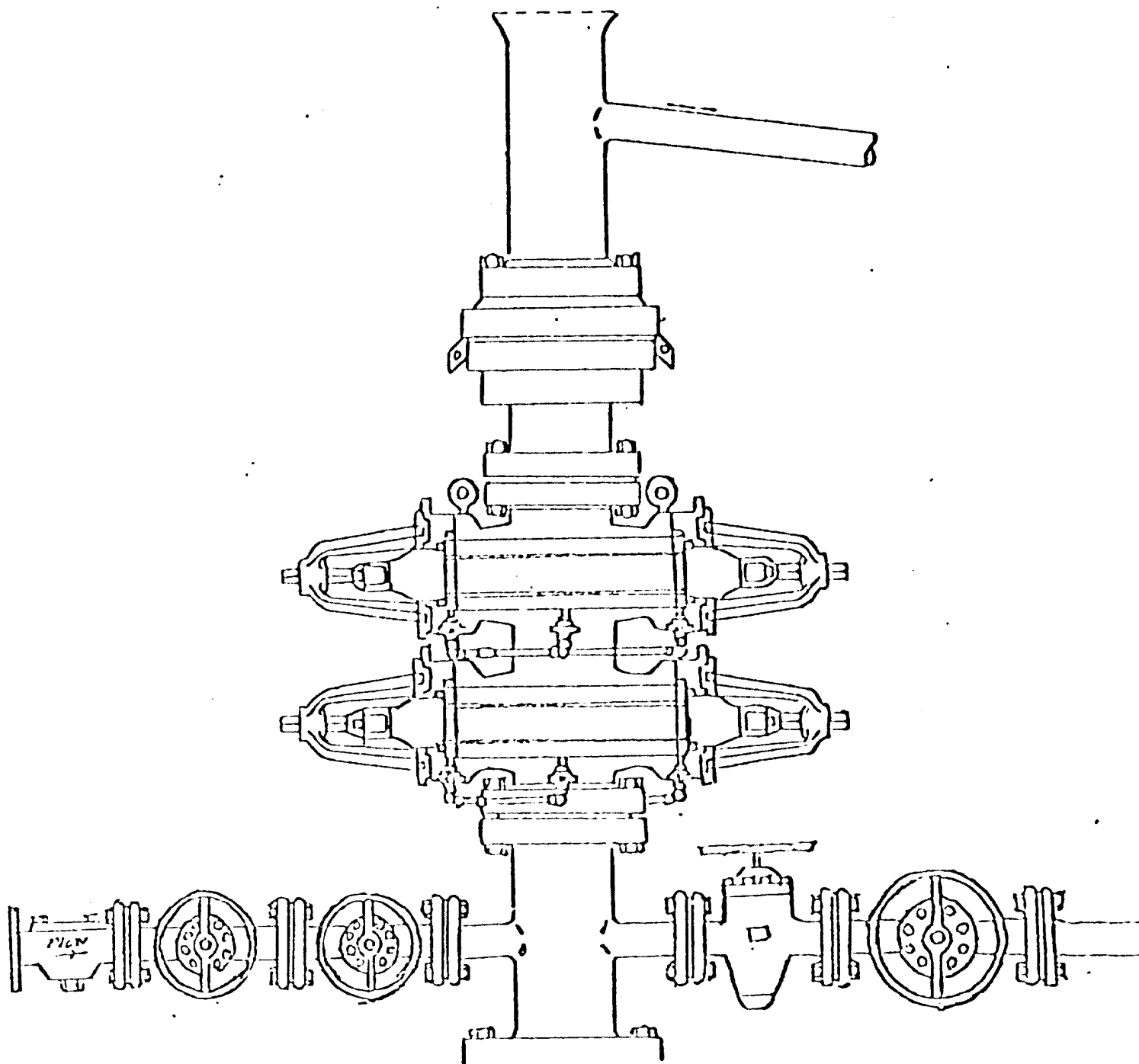

BLOWOUT PREVENTERS

ONE SHAFFER LWS HYDRAULIC DOUBLE 10" x 1500
SERIES. ONE SHAFFER SPHERICAL 10" x 1500 SERIES,
CHOKE MANIFOLD 4" x 1500 SERIES FLANGED
CONNECTIONS. PAYNE 4 VALVE ACCUMULATOR CLOSING
UNIT.

SURFACE USE PLAN
GENERAL AMERICAN OIL COMPANY OF TEXAS, WELL: GRAYBURG DEEP UNIT #1
LEASE: LC-028793-c EDDY COUNTY, NEW MEXICO

RECEIVED
DEC 6 1977
U.S. GEOLOGICAL SURVEY
ARTESIA, NEW MEXICO

The subject well is located approximately 24 miles East of Mexico on the South side of Highway U.S. 82. The following is a discussion of pertinent information concerning possible effect, which the proposed drilling of the well may have on the environment of the well and road sites and surrounding acreage. A copy will be posted on the derrick floor so that all contractors and sub-contractors will be aware of all items of this plan.

1. AERIAL ROAD MAP - Exhibit "A" is portion of the Artesia Quadrangle Map #106 and Maljamar Quadrangle Map #107 showing well site in relation to U.S. Highway 82. Access road, which is shown on Exhibit "B" exits the highway about 24 miles East of Artesia, New Mexico.
2. LOCATION OF EXISTING WELLS - The location of existing wells in the immediate area of the proposed well is shown on Exhibit "B".
3. PROPOSED WELL MAT AND IMMEDIATE AREA - Refer to Exhibit "C" for direction orientation and road access.
 - a. MAT SIZE - 200' x 275'.
 - b. SURFACED - Will be topped with 6" of caliche, bladed, watered and compacted. Caliche to be purchased from B.L.M. by dirt contractor.
 - c. RESERVE PIT - 120' x 165'.
 - d. CUT & FILL - Location is basically flat except for small sand dunes. No fill will be needed except existing sand dunes leveled and topped with caliche.
 - e. DRILL SITE LAYOUT - Exhibit "C" shows the location and layout including position of the Rig, Mud Tanks, Reserve Pits, Pipe Racks, etc. The Rig will be erected with the V-Door to the North.
 - f. SETTING AND ENVIRONMENT
 - (1) Terrain - Low rolling sand hills.
 - (2) Soil - Sandy Soil.
 - (3) Vegetation - Sparse vegetation, being mostly mesquite, shennery, weeds and other semi-desert plants with some grass.
 - (4) Surface Use - Grazing.
 - (5) Other - Drillsite - which is in sandy semi-arid desert county, is in a low environmental risk area. The total effect of drilling and producing this and other wells in this area would be very minimal.
 - g. DISTANCES TO:
 - (1) Ponds and Streams - There are no surface waters within 3/4 mile.
 - (2) Water Wells - There are no water wells within 1/2 mile.
 - (3) Residences and Building - There are no residences or buildings within 1/2 mile.
 - (4) Arroyos, Canyons, Hills, etc. - Outside of small sand dunes there are no surface features.
 - h. WELL SIGN - Sign identifying and locating proposed well will be maintained at the drill site commencing with the spudding of the well.
 - i. OPEN PITS - All pits containing mud or other liquids will be guarded.

4. ROADS

- a. EXISTING ROADS - All existing roads within the immediate area of well site are shown on Exhibit "B".
- b. PLANNED ROADS - No new roads will be constructed. Existing roads will be used.
- c. FENCES, GATES AND CATTLE GUARDS - Will be maintained as General American already operates several hundred wells in the immediate area.

5. TANK BATTERY - If production is encountered Tank Battery will be constructed on location.

6. LEASE - PIPELINES

- a. EXISTING - All existing pipelines are shown on Exhibit "B".
- b. PLANNED - If production is encountered, flowline will consist of approximate 100' from well to tank battery on location.

7. WASTE DISPOSAL - Barrel trash containers will be in accessible locations within the drill site area during the drilling and completion operations. A waste disposal pit will be deep enough to handle waste and will be covered with a minimum of 2 feet of top soil. See Exhibit "C" for pit location. If well is productive, maintenance waste will be placed in special trash cans and hauled away periodically. Any produced water will be disposed of through the currently existing S.W.D. system.

8. WATER SUPPLY - Water supply to drill this well will be furnished through a steel line already laid through the drilling area.

- a. Location of the water line is shown on Exhibit "B".

9. ARCHAEOLOGICAL RESOURCES - None were observed.

10. RESTORATION OF SURFACE - If well is productive, pits will be backfilled and leveled as soon as practical. Upon final abandonment of well, well site will be leveled and cleaned, with land returned as near as possible to original condition.

11. OPERATOR'S REPRESENTATIVE - Field personnel who can be contacted concerning compliance of this surface use plan are as follows:

DRILLING AND PRODUCTION

Lendell Hawkins
P. O. Box 128
Loco Hills, New Mexico 88255
Office Phone: 505 677-2481
Home Phone: 505 677-2277

OR

Fred Starkey
P. O. Box 128
Loco Hills, New Mexico 88255
Office Phone: 505 677-2481
Home Phone: 505 746-9397

12. CERTIFICATION

I hereby certify that I, or persons under my direct supervision, have inspected the proposed drill site and access route; that I am familiar with the conditions as they actually exist; that the statements made in this plan are, to the best of my knowledge, true and correct; and that the proposed work performed by General American Oil Company and its Contractors and Sub-Contractors will conform to this plan.

December 2, 1977
DATE

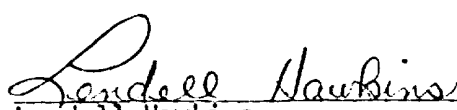
Lendell Hawkins
Assistant Field Superintendent

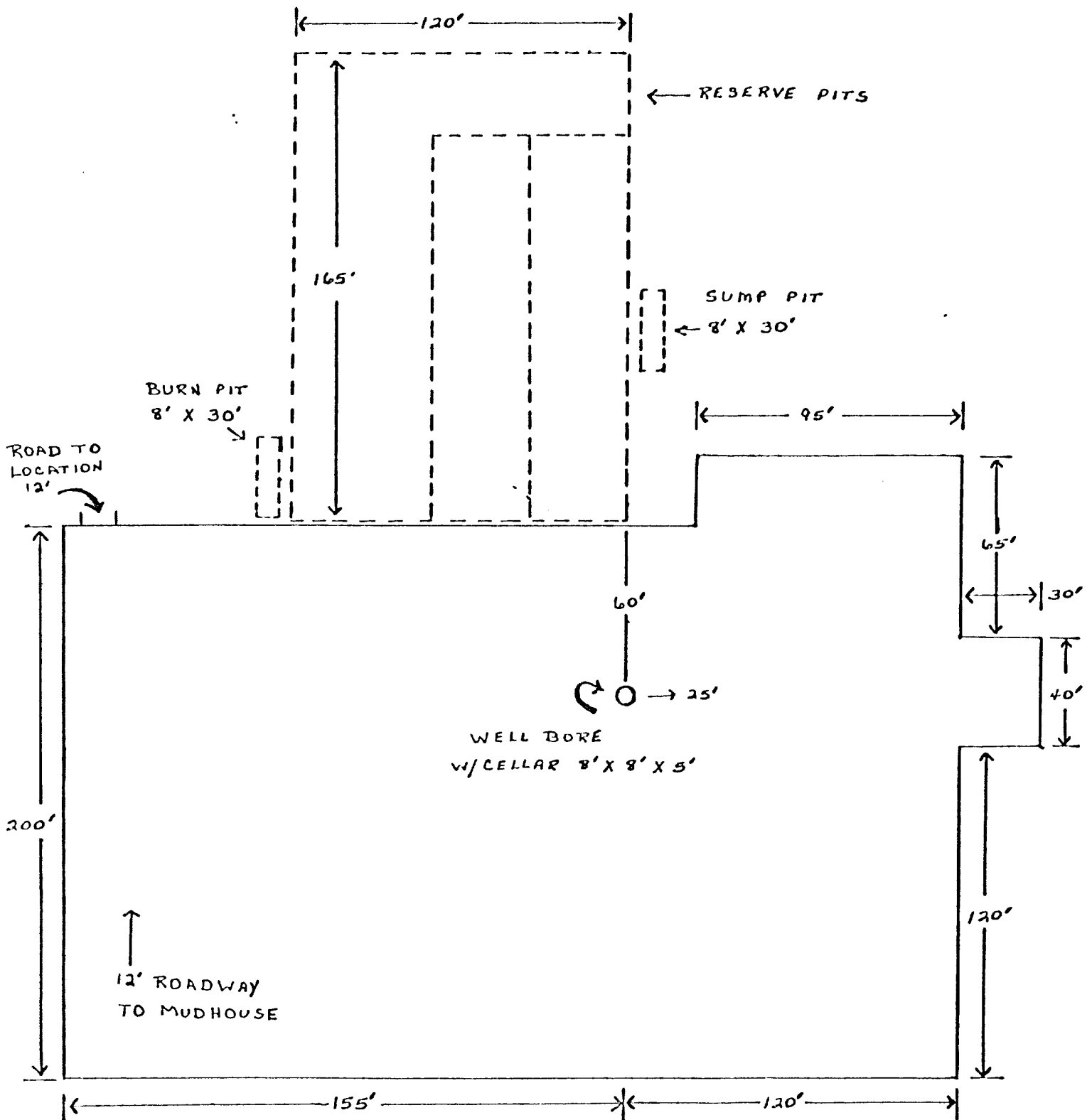

SCALE: 1 inch = 50 feet

EXHIBIT 'C'

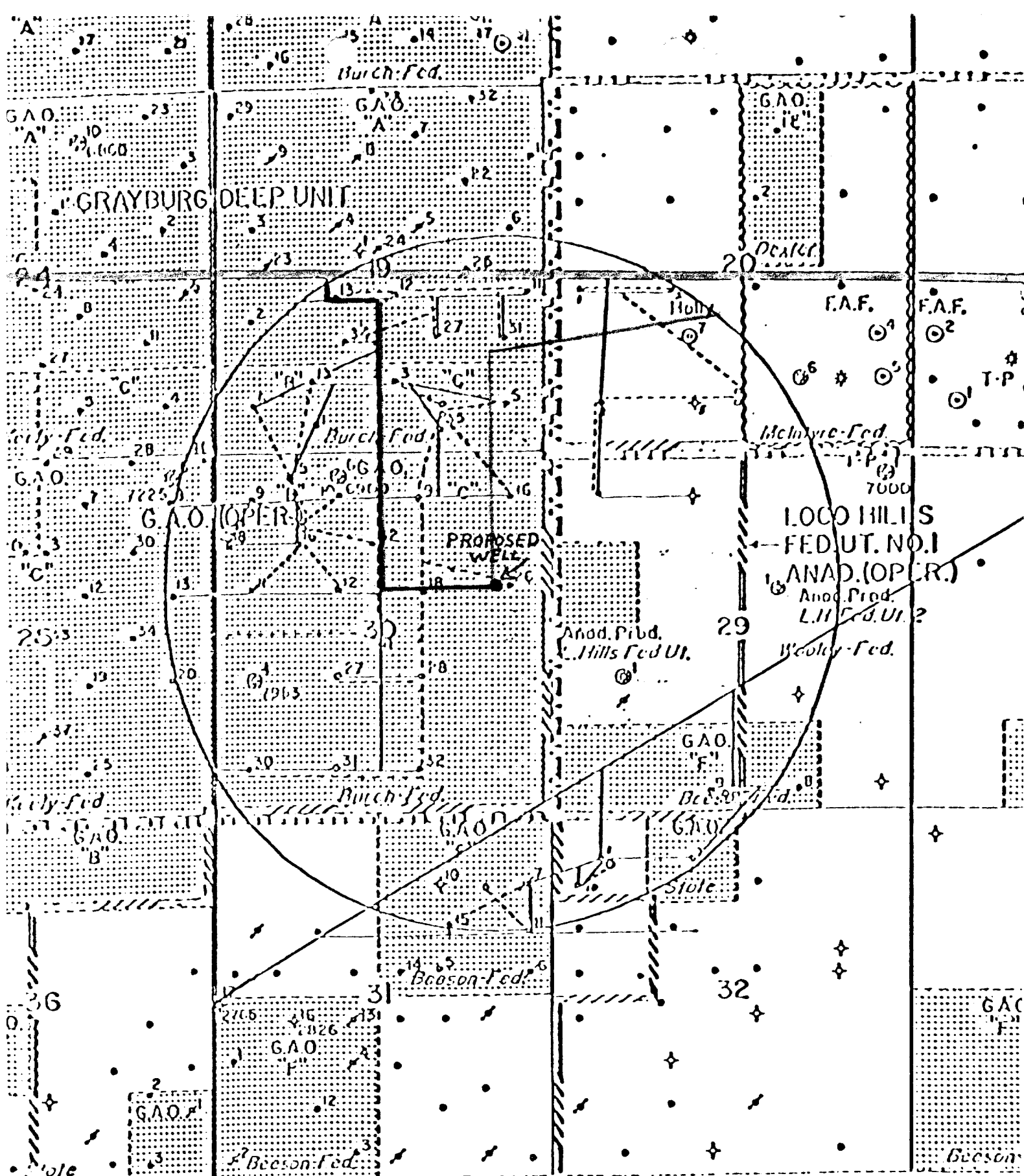

EXHIBIT "B"

GENERAL AMERICAN OIL COMPANY OF TEXAS

GRAYBURG DEEP UNIT #8 (SECTION 30-TOWNSHIP 17 SOUTH - RANGE 30 EAST.)

- OIL WELL
- ⊙ INJECTION WELL
- EXISTING ROADS
- PROPOSED FLOWLINES (TANK BATTERY WILL BE CONSTRUCTED ON LOCATION).
- NEW PROPOSED ROADS. (NOTE: THIS LOCATION IS JUST OFF ROADSIDE AND NO NEW ROAD WILL BE CONSTRUCTED).
- WATER SUPPLY LINE
- U. S. HI-WAY 82
- SUGGESTED ROUTE TO LOCATION IS APPX. 24 MILES EAST OF ARTESIA, NEW MEXICO TO THE GENERAL AMERICAN OIL CAMP ON SIDE OF ROAD (SOUTH) OF U. S. HI-WAY 82. TURN INTO CAMP AND GO OUT EAST CATTLE GUARD AND TURN SOUTH AND CONTINUE SOUTH FOR APPX. 3/4 MILE AND TURN EAST FOR 1/4 MILE TO LOCATION.
- EXISTING FLOWLINES

N

SCALE: 1"=2000'