

UNITED STATES
DEPARTMENT OF THE INTERIOR
GEOLOGICAL SURVEY

APPLICATION FOR PERMIT TO DRILL, DEEPEN, OR PLUG BACK

1a. TYPE OF WORK

DRILL ☒DEEPEN ☐PLUG BACK ☐

b. TYPE OF WELL

OIL
WELL ☒GAS
WELL ☐OTHER ☐

RECEIVED

SINGLE
ZONE ☒MULTIPLE
ZONE ☐

2. NAME OF OPERATOR

Southland Royalty Company ✓

FEB 08 1983

3. ADDRESS OF OPERATOR

21 Desta Drive, Midland, Texas 79701 O. C. D.

4. LOCATION OF WELL (Report location clearly and in accordance with a well log.)

At surface

2615' FEL & 1345' FSL, Sec. 34, T-17-S, R-29-E

At proposed prod. zone

14. DISTANCE IN MILES AND DIRECTION FROM NEAREST TOWN OR POST OFFICE*

6 miles SW of Loco Hills N.M.

15. DISTANCE FROM PROPOSED*

LOCATION TO NEAREST
PROPERTY OR LEASE LINE, FT.
(Also to nearest drlg. unit line, if any)

1345'

16. NO. OF ACRES IN LEASE

160

17. NO. OF ACRES ASSIGNED

TO THIS WELL
40

18. DISTANCE FROM PROPOSED LOCATION*

TO NEAREST WELL, DRILLING, COMPLETED,
OR APPLIED FOR, ON THIS LEASE, FT.

990'

19. PROPOSED DEPTH

3300'

20. ROTARY OR CABLE TOOLS

Rotary

21. ELEVATIONS (Show whether DF, RT, GR, etc.)

3506.9' GR

22. APPROX. DATE WORK WILL START*

February 15, 1983

23.

PROPOSED CASING AND CEMENTING PROGRAM

SIZE OF HOLE	SIZE OF CASING	WEIGHT PER FOOT	SETTING DEPTH	QUANTITY OF CEMENT
12 1/2"	8 5/8"	24#	350'	400 sx. (Circulate)
7 7/8"	5 1/2"	15.5#	3300'	800 sx. (Circulate)

Drill 12 1/2" hole to 350'. Set 8 5/8" csg @ 350'. Circulate cement. Drill 7 7/8" hole to 3300'. Set 5 1/2" csg @ 3300'. Cement w/800 sx. cmt. Perf & stimulate Grayburg and San Andres for production.

MUD PROGRAM: 0-275' spud mud; 275-3300' 10# Brine wtr; at TD sweep hole & condition w/9.8# brine gel. VIS 34-38.

BOP PROGRAM: BOP to be tested after setting 8 5/8" csg.

IN ABOVE SPACE DESCRIBE PROPOSED PROGRAM: If proposal is to deepen or plug back, give data on present productive zone and proposed new productive zone. If proposal is to drill or deepen directionally, give pertinent data on subsurface locations and measured and true vertical depths. Give blowout preventer program, if any.

24.

SIGNED F. M. Robinson TITLE District Operations Engineer DATE 1-5-83

(This space for Federal or State office use)

PERMIT NO. _____

APPROVAL DATE _____

APPROVED BY _____

TITLE _____

DATE _____

CONDITIONS OF APPROVAL, IF ANY: _____

APPROVED

FEB 4 1983

JAMES A. GILLHAM
DISTRICT SUPERVISOR

See Instructions On Reverse Side

RECEIVED
FEB 18 1983
OIL & GAS
MINERALS MGMT. SERVICE
ROSWELL, NEW MEXICO
Postcard ID
New for
API
2-18-83

N MEXICO OIL CONSERVATION COMMISS
WELL LOCATION AND ACREAGE DEDICATION PLAT

Form C-102
 Supersedes C-128
 Effective 1-1-65

All distances must be from the outer boundaries of the Section

Operator Southland Royalty Company			Lease F. M. Robinson "B" Tract 1		Well No. 2
Section J	Section 34	Township 17 S	Range 29 E	County Eddy	
2615 feet from the East line and 1345 feet from the South line					
Producing Formation Q, SR, GB, SA		Pool Grayburg-Jackson		Dedicated Acreage 40 Acres	

1. Outline the acreage dedicated to the subject well by colored pencil or hatchure marks on the plat below.
2. If more than one lease is dedicated to the well, outline each and identify the ownership thereof (both as to working interest and royalty).
3. If more than one lease of different ownership is dedicated to the well, have the interests of all owners been consolidated by communitization, unitization, force-pooling, etc?

☐ Yes ☐ No If answer is "yes," type of consolidation _____

If answer is "no," list the owners and tract descriptions which have actually been consolidated (Use reverse side of this form if necessary.) _____

No allowable will be assigned to the well until all interests have been consolidated (by communitization, unitization, forced-pooling, or otherwise) or until a non-standard unit, eliminating such interests, has been approved by the Commission.

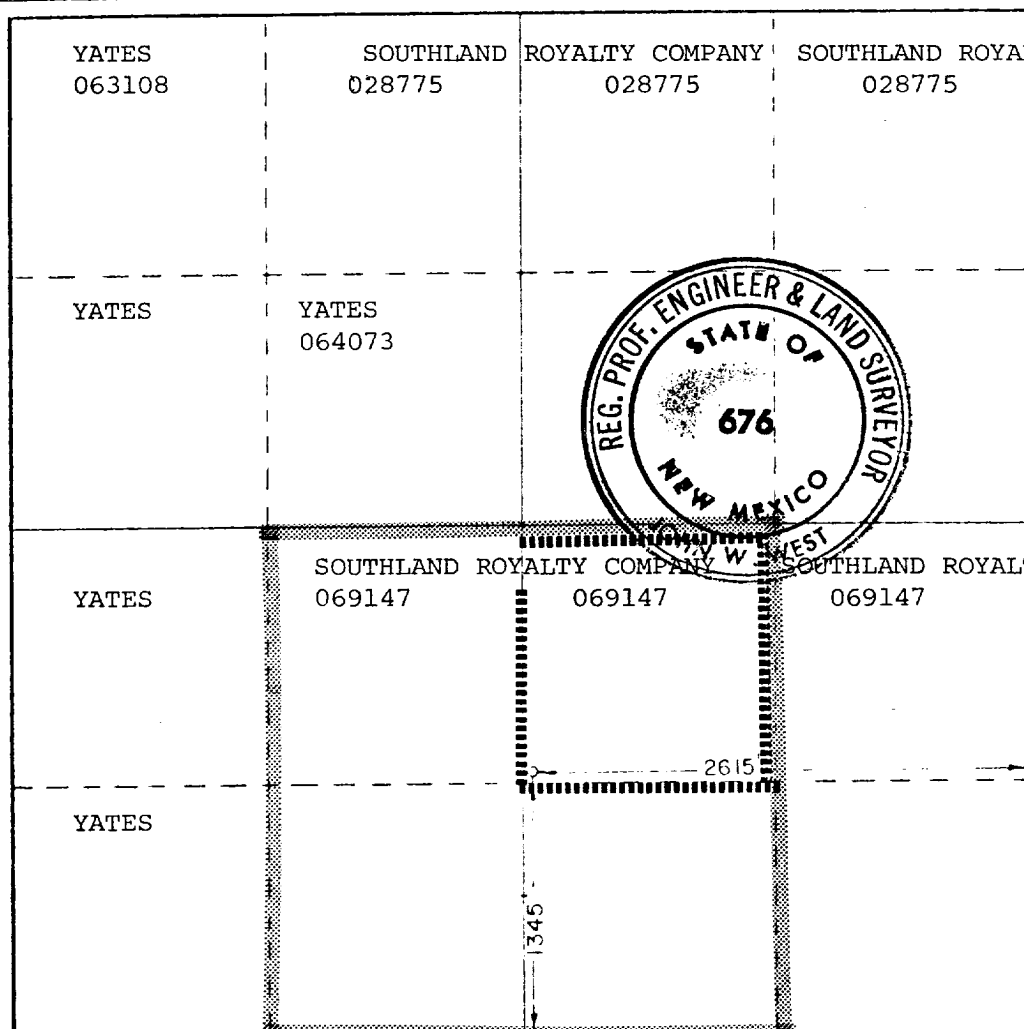

CERTIFICATION

I hereby certify that the information contained herein is true and complete to the best of my knowledge and belief.

F. N. Rad

F. N. Rad

District Operations Engineer

Southland Royalty Company

1-5-83

I hereby certify that the well location shown on this plat was plotted from field notes of actual surveys made by me or under my supervision, and that the same is true and correct to the best of my knowledge and belief.

Date Surveyed

12/22/82

Registered Professional Engineer and Land Surveyor

John W. West

Certificate No.
JOHN W. WEST NO. 676

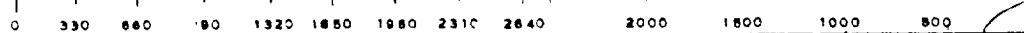

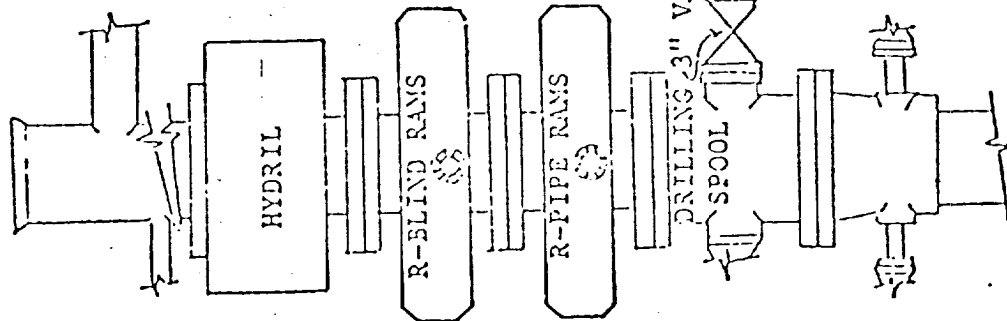

BLOW OUT PREVENTION EQUIPMENT
 10" 900s ALL FLANGED CONNECTIONS
 3,000# WORKING PRESSURE - 6,000# TEST

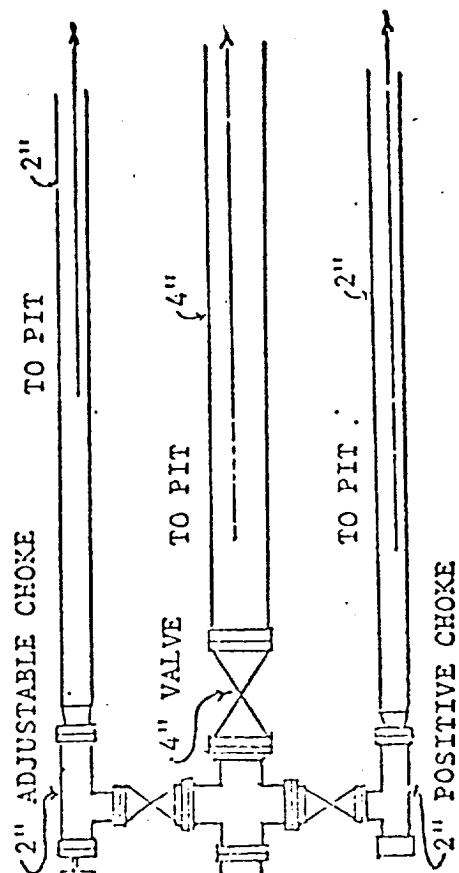

ATTACHMENT TO FORM C-101

SOUTHLAND ROYALTY COMPANY

F. M. Robinson "B" Tr. 1 #2
2615' FEL & 1345' FSL
Section 34, T-17-S, R-29-E
Eddy County, New Mexico
LC-069147

To supplement USGS Form 9-331C "Application to Drill" the following additional information is submitted concerning questions on Page 5 of NTL-6:

1. See Form 9-331C.
2. See Form 9-331C.
3. The geological name of surface formation is: Ochoa
4. See Form 9-331C.
5. See Form 9-331C.
6. The estimated tops of important geological markers are:

B/Salt	870'
Yates	1061'
Queen	2033'
Grayburg	2466'
San Andres	2916'
Jackson	3130'

7. The estimated depths at which anticipated water, oil, gas and mineral bearing strata are as follows:

Grayburg	2466'
San Andres	2916'

8. See Form 9-331C. All casing will be new.
9. See Form 9-331C for depths of strings. Cement volumes and additions as follows:
 - A. 8 5/8" casing: Cement w/400 sx Class "C" w/2% CaCl.
 - B. 5 1/2" casing: Cement w/600 sx Lite wt cement w/8# salt, 5# Gilsonite & 1/4# Celloflake and 200 sx Class "C" w/2% CaCl w/3% salt and 1% CF-10.
10. The pressure control diagram is attached to Form 9-331C. The following additional information is as follows:

The BOP will be tested before drilling below surface pipe and before drilling thru anticipated oil or gas formation.

Testing procedure: Test 8 5/8" casing - pressure to 1000 psi for 30 minutes before drilling below 8 5/8".

11. See Form 9-331C.
12.
 - A. DST Program - None
 - B. Cores - None
 - C. Mud Logging - None
 - D. Wire Line Logs:

Compensated Neutron/Compensated Density/ GR/Caliper/BH Volume	275-3300' (OH)
Dual Laterolog/RXO/GR	275-3300'

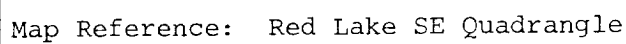



STATE OF NEW MEXICO
ENERGY AND MINERALS DEPARTMENT
OIL CONSERVATION DIVISION
ARTESIA DISTRICT OFFICE

February 9, 1983

TONEY ANAYA
GOVERNOR

P.O. DRAWER 00
ARTESIA, NEW MEX. CO 88210
(505) 748-1293

Southland Royalty Company
21 Desta Drive
Midland, Texas 79701

Re: F. M. Robinson "B" Tr. 1
#2-J-34-17-29
Grayburg Jackson (Q,SR,SA,GB)

Gentlemen:

We are in receipt of MMS Form 9-331 C, Permit to Drill, on the above captioned well.

However, before an allowable can be assigned to this well, you will have to apply for a Non-Standard Location approval from our Santa Fe office.

If we can be of assistance, please call.

Sincerely,

Leslie A. Clements
Leslie A. Clements
Supervisor, District II

LAC:fc