

RECEIVED

JUL 05 1983

O. C. D.

ARTESIA, OFFICE

NO. OF COPIES RECEIVED	
DISTRIBUTION	
SANTA FE	<input checked="" type="checkbox"/>
FILE	<input checked="" type="checkbox"/>
U.S.G.S.	<input checked="" type="checkbox"/>
LAND OFFICE	<input checked="" type="checkbox"/>
OPERATOR	<input checked="" type="checkbox"/>

5A. Indicate Type of Lease
STATE ☒ FEDERAL ☐
6. State Oil & Gas Lease No.
E-4200

APPLICATION FOR PERMIT TO DRILL, DEEPEN, OR PLUG BACK

1. Type of Work

2. Type of Well DRILL ☒ DEEPEN ☐ PLUG BACK ☐

3. GIL WELL ☒ GAS WELL ☐ OTHER ☐ SINGLE ZONE ☐ MULTIPLE ZONE ☐

4. Name of Operator

Marbob Energy Corporation ✓

5. Address of Operator

P.O. Drawer 217, Artesia, N.M. 88210

6. Location of Well

ONLY LETTER N LOCATED 990 FEET FROM THE South

1650 FEET FROM THE West LINE OF SEC. 15 TWP. 17S RGE. 29E

7. Unit Agreement Name

8. Farm or Lease Name

Continental State

9. Well No.

3

10. Field and Pool, or Wildcat SA

Grbg Jackson SR-Qn-Grbg

11. County

Eddy

12. Proposed Depth 1300' 13A. Formation Seven Rivers 13. Nature of C.T. C.T.

14. Existing Well in Same Field, Pool, or Unit 15. Kind of Existing Well 16. Drilling Contractor 17. Approx. Date Work will start

3558.4' GR

Statewide active

Jenkins Brothers

7/5/83

PROPOSED CASING AND CEMENT PROGRAM

SIZE OF HOLE	SIZE OF CASING	WEIGHT PER FOOT	SETTING DEPTH	SACKS OF CEMENT	EST. TOP
12"	10"	32.75#	150'	None	
8"	7"	20#	450'	160	Circulate
6 1/4"	4 1/2"	15.50#	1300'	125	

We propose to drill a 12" hole to 150', run 10" casing, mud up, reduce hole to 8", drill to 450', run 450' of 7" casing, pull 10", cement 7", reduce hole to 6 1/4" drill to 1300', run 4 1/2" casing and cement.

Posted and
J.D. 1-15-83
Book

APPROVAL VALID FOR 180 DAYS
PERMIT EXPIRES 1-8-84
UNLESS DRILLING UNDERWAY

ABOVE SPACE DESCRIBE PROPOSED PROGRAM IF PROPOSAL IS TO DEEPEN OR PLUG BACK, GIVE DATA ON PRESENT PRODUCTIVE ZONE AND PROPOSED NEW PRODUCTIVE ZONE. GIVE BLOWOUT PREVENTER PROGRAM, IF ANY.

I hereby certify that the information above is true and complete to the best of my knowledge and belief.

Signature Title Date 6/30/83

(This space for State Use)

PROVED BY Mike Welton TITLE OIL AND GAS INSPECTOR DATE JUL 08 1983

CONDITIONS OF APPROVAL, IF ANY:

**NEW MEXICO OIL CONSERVATION COMMISSION
WELL LOCATION AND ACREAGE DEDICATION PLAT**

Form C-102
Superseded C-128
Effective 1-1-65

All distances must be from the outer boundaries of the Section

Operator Marbob Energy Corporation			Lease Continental State		Well No. 3
Section Letter N	Section 15	Township 17 South	Range 29 East	County Eddy County	
General Portage Location of Well: 990 feet from the South line and 1650 feet from the West line					
Ground Level Elev. 3558.4'	Producing Formation Seven Rivers		Pool Grbg Jackson SR-Qn-Grbg-SA		Dedicated Acreage: 40 Acres

1. Outline the acreage dedicated to the subject well by colored pencil or hatchure marks on the plat below.
2. If more than one lease is dedicated to the well, outline each and identify the ownership thereof (both as to working interest and royalty).
3. If more than one lease of different ownership is dedicated to the well, have the interests of all owners been consolidated by communitization, unitization, force-pooling, etc?

☐ Yes ☐ No If answer is "yes," type of consolidation _____

If answer is "no," list the owners and tract descriptions which have actually been consolidated. (Use reverse side of this form if necessary.) _____

No allowable will be assigned to the well until all interests have been consolidated (by communitization, unitization, forced-pooling, or otherwise) or until a non-standard unit, eliminating such interests, has been approved by the Commission.

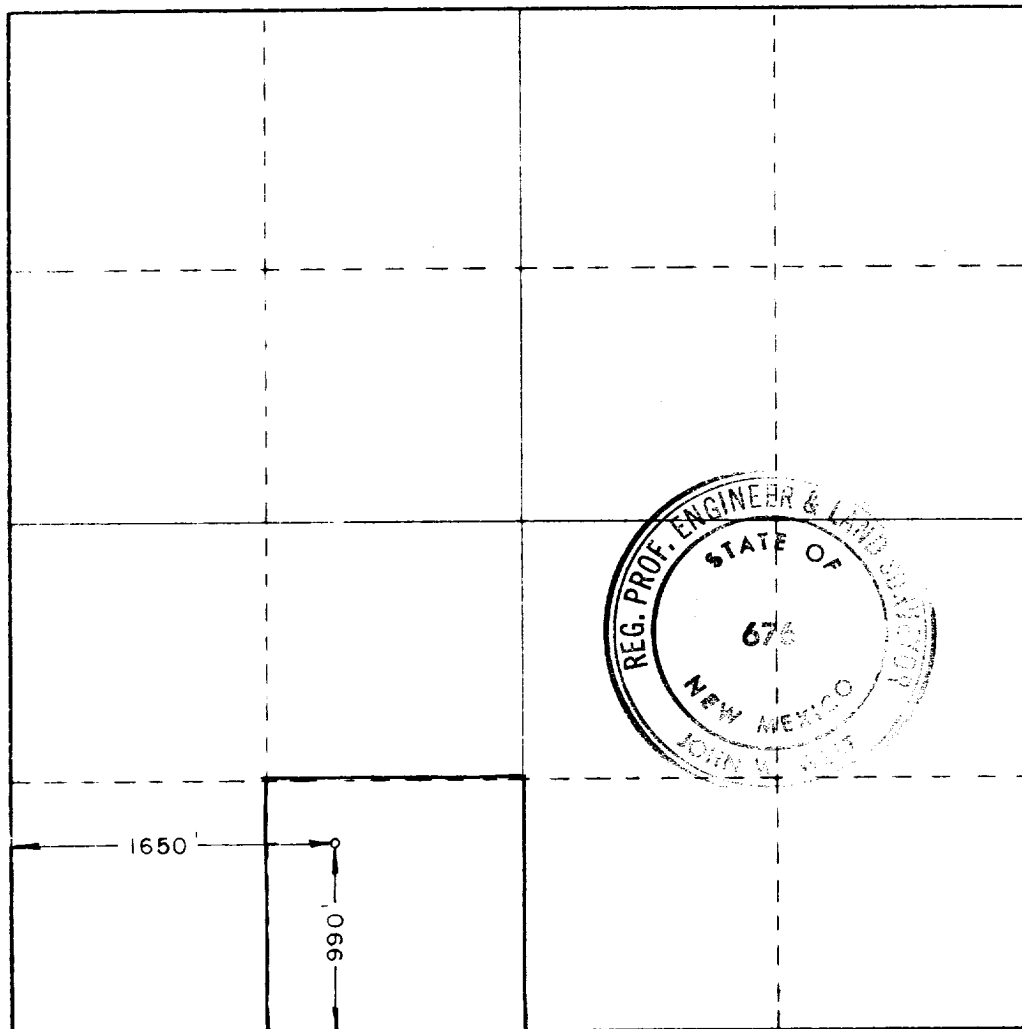

CERTIFICATION

I hereby certify that the information contained herein is true and complete to the best of my knowledge and belief.

Carolyn Orris

Name

Carolyn Orris

Position

Production Clerk

For my

Marbob Energy Corporation

Date

6/30/83

I hereby certify that the well location shown on this plat was plotted from field notes of actual surveys made by me or under my supervision, and that the same is true and correct to the best of my knowledge and belief.

Date Surveyed

June 29, 1983

Registered Professional Engineer
and/or Land Surveyor

John W. West

Certificate No. **JOHN W. WEST,**

676

RONALD J. EIDSON,

3239

330 660 990 1320 1650 1980 2310 2640 2000 1800 1000 800 0