

NO. OF COPIES RECEIVED	
DISTRIBUTION	
SANTA FE	<input checked="" type="checkbox"/>
FILE	<input checked="" type="checkbox"/>
U.S.G.S.	<input checked="" type="checkbox"/>
LAND OFFICE	<input checked="" type="checkbox"/>
OPERATOR	<input checked="" type="checkbox"/>

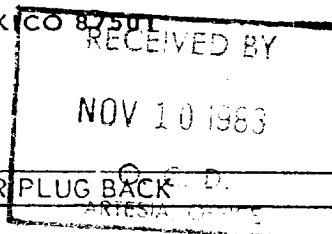

5A. Indicate Type of Lease  
STATE ☒ REC ☐  
5. State Oil & Gas Lease No.

## APPLICATION FOR PERMIT TO DRILL, DEEPEN, OR PLUG BACK

1a. Type of Work DRILL <input checked="" type="checkbox"/> DEEPEN <input type="checkbox"/> PLUG BACK <input type="checkbox"/>		7. Unit Agreement Name
b. Type of Well OIL WELL <input checked="" type="checkbox"/> GAS WELL <input type="checkbox"/> OTHER <input type="checkbox"/> SINGLE ZONE <input type="checkbox"/> MULTIPLE ZONE <input type="checkbox"/>		8. Farm or Lease Name Cave State
2. Name of Operator Diamondback Petroleum Inc. ✓		9. Well No. 1
3. Address of Operator P.O. Box 2938 Ruidoso, N.M. 88345		10. Field and Pool, or Wildcat Cave - G. H. - 2H
4. Location of Well UNIT LETTER <u>D</u> LOCATED <u>330</u> FEET FROM THE <u>North</u> LINE AND <u>330</u> FEET FROM THE <u>West</u> LINE OF SEC. <u>4</u> TWP. <u>17S</u> RGE. <u>29E</u> NMPM		12. County Eddy
19. Proposed Depth 2550		19A. Formation San Andres
20. Rotary or C.T. Rotary		
21. Elevations (Show whether DF, RT, etc.) 3602.2 GL	21A. Kind & Status Plug. Bond Blanket	21B. Drilling Contractor Unknown
22. Approx. Date Work will start ASAP		

23.

## PROPOSED CASING AND CEMENT PROGRAM

SIZE OF HOLE	SIZE OF CASING	WEIGHT PER FOOT	SETTING DEPTH	SACKS OF CEMENT	EST. TOP
12 1/2	8 5/8"	24#	350	75 sxs	Circulated
7 7/8	5 1/2"	15.5#	2550	250 sxs	Base of Salt

Spud well with fresh water and native mud, drill to 350 feet set 8 5/8" CSNG.

Drill out W/ 7 7/8" bit and brine water to 2400 feet, mud up with Salt gel to 2550.

BOP to be installed on 8 5/8" CSNG

Noted as per  
30-015-24672  
11-15-83

APPROVAL VALID FOR 180 DAYS  
PERMIT EXPIRES 5-10-84  
UNLESS DRILLING UNDERWAY

IN ABOVE SPACE DESCRIBE PROPOSED PROGRAM; IF PROPOSAL IS TO DEEPEN OR PLUG BACK, GIVE DATA ON PRESENT PRODUCTIVE ZONE AND PROPOSED NEW PRODUCTIVE ZONE; GIVE SLOUGH PREVENTER PROGRAM, IF ANY.

I hereby certify that the information above is true and complete to the best of my knowledge and belief.

Signed [Signature] Title Consultant Date 11/10/83

(This space for State Use)

APPROVED BY [Signature] TITLE OIL AND GAS INSPECTOR DATE NOV 10 1983

CONDITIONS OF APPROVAL, IF ANY:

NEW MEXICO OIL CONSERVATION COMMISSION  
WELL LOCATION AND ACREAGE DEDICATION PLAT

Form C-102  
Supersedes C-128  
Effective 1-1-65

All distances must be from the outer boundaries of the Section.

Operator <b>DIAMOND BACK PETROLEUM, INC.</b>			Lease <b>CAVE STATE</b>		Well No. <b>1</b>
Grid Letter <b>D</b>	Section <b>4</b>	Township <b>17 SOUTH</b>	Range <b>29 EAST</b>	County <b>EDDY</b>	
Actual Footage Location of Well:					
<b>330</b> feet from the <b>NORTH</b> line and		<b>330</b> feet from the <b>WEST</b> line			
Ground Level Elev. <b>3602.2</b>	Producing Formation <b>GRAYBURG - SAN ANDRES</b>		Pool <b>CAVE - G - 2A</b>	Dedicated Acreage: <b>40</b> Acres	

1. Outline the acreage dedicated to the subject well by colored pencil or hatchure marks on the plat below.
2. If more than one lease is dedicated to the well, outline each and identify the ownership thereof (both as to working interest and royalty).
3. If more than one lease of different ownership is dedicated to the well, have the interests of all owners been consolidated by communitization, unitization, force-pooling, etc?

☐ Yes ☐ No If answer is "yes," type of consolidation \_\_\_\_\_

If answer is "no," list the owners and tract descriptions which have actually been consolidated. (Use reverse side of this form if necessary.) \_\_\_\_\_

No allowable will be assigned to the well until all interests have been consolidated (by communitization, unitization, forced-pooling, or otherwise) or until a non-standard unit, eliminating such interests, has been approved by the Commission.

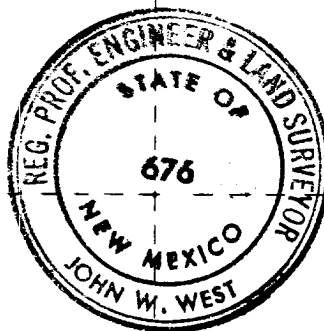
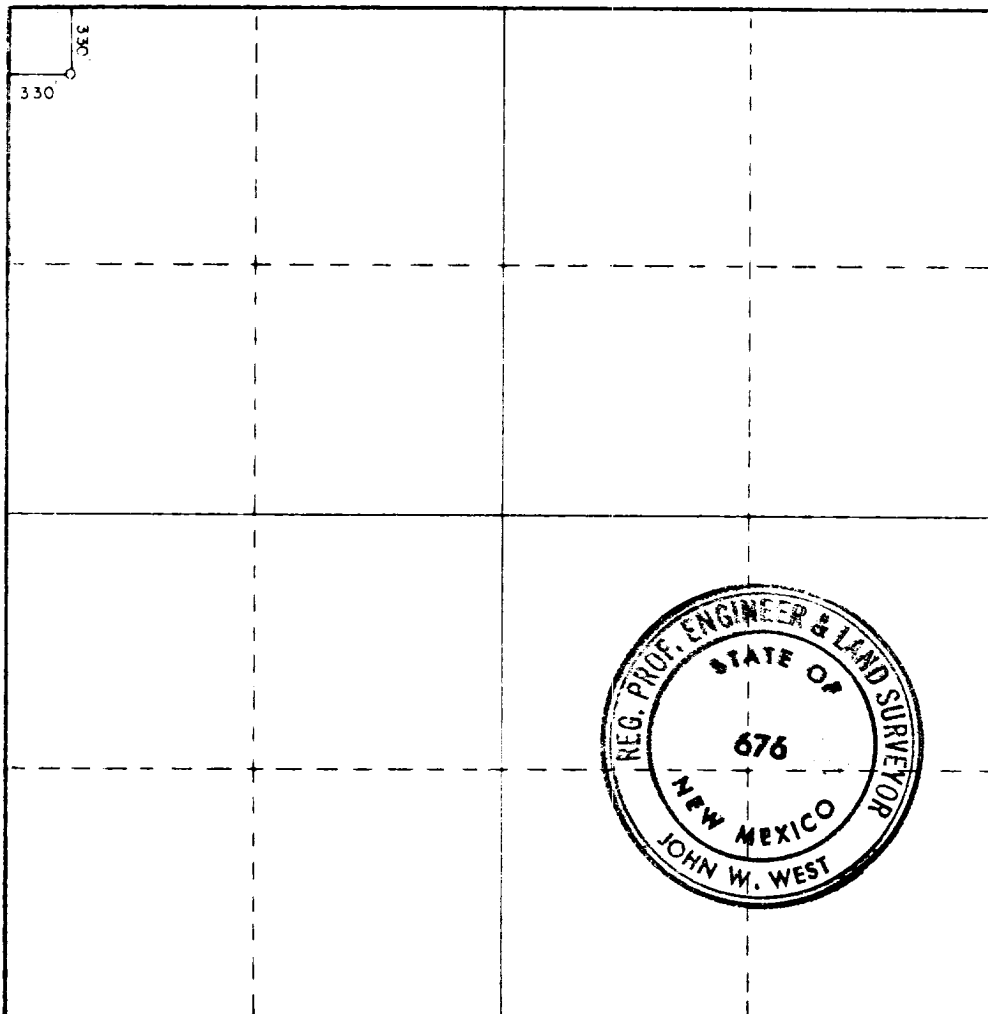

CERTIFICATION

I hereby certify that the information contained herein is true and complete to the best of my knowledge and belief.

Name  
**RANDALL L. HARRIS**  
Position  
**Geologist**  
Company  
**DIAMOND BACK PET.**  
Date  
**11/10/83**

I hereby certify that the well location shown on this plat was plotted from field notes of actual surveys made by me or under my supervision, and that the same is true and correct to the best of my knowledge and belief.

Date Surveyed  
**NOVEMBER 8, 1983**

Registered Professional Engineer and/or Land Surveyor

**John W. West**

Certificate No. **JOHN W. WEST, 676**  
**RONALD J. EIDSON, 3239**

330 660 990 1320 1650 1980 2310 2640 2000 1500 1000 500 0