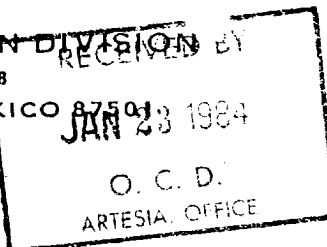

30-015-24759

STATE OF NEW MEXICO  
ENERGY AND MINERALS DEPARTMENTOIL CONSERVATION DIVISION  
P. O. BOX 2088  
SANTA FE, NEW MEXICO 87501Form C-101  
Revised 10-1-78

NO. OF COPIES RECEIVED	
DISTRIBUTION	
SANTA FE	✓
FILE	✓
U.S.G.S.	✓
LAND OFFICE	✓
OPERATOR	✓

 5A. Indicate Type of Lease  
 STATE ☒ FEE ☐  
 5. State Oil & Gas Lease No.

## APPLICATION FOR PERMIT TO DRILL, DEEPEN, OR PLUG BACK

1a. Type of Work

DRILL ☒DEEPEN ☐PLUG BACK ☐

b. Type of Well

OIL WELL ☒GAS WELL ☐

OTHER

SINGLE ZONE ☐MULTIPLE ZONE ☐

2. Name of Operator

J.E.M. Resources

3. Address of Operator

P.O. Box 2938 Ruidoso, N.M. 88345

4. Location of Well

UNIT LETTER 0 LOCATED 330 FEET FROM THE South LINE

AND

2310 FEET FROM THE East LINE OF SEC. 4 TWP. 17S RGE. 29E NMPM

7. Unit Agreement Name

8. Farm or Lease Name

Diamond State

9. Well No.

1

10. Field and Pool, or Wildcat

Cave - 6-5F

12. County

Eddy

19. Proposed Depth

2500

19A. Formation

San Andres

20. Rotary or C.T.

Rotary

21. Elevations (Show whether DF, RT, etc.)

3576 GR

21A. Kind &amp; Status Plug. Bond

Blanket

21B. Drilling Contractor

Rhym

22. Approx. Date Work will start

ASAP

23.

## PROPOSED CASING AND CEMENT PROGRAM

SIZE OF HOLE	SIZE OF CASING	WEIGHT PER FOOT	SETTING DEPTH	SACKS OF CEMENT	EST. TOP
12 1/2"	8 5/8	24#	350±	480	Circulated
7 7/8	5 1/2	15.5#	2500	1000	Circulated

## Mud Program:

Fresh water and spud mud surface to 350 ft.  
 Brine water w/gel 350 to TD  
 BOP will be installed on 8 5/8" csng.

Postel APG  
 10-1-27-84  
 1-28-84

APPROVAL VALID FOR 180 DAYS  
 PERMIT EXPIRES 7-25-84  
 UNLESS DRILLING UNDERWAY

ABOVE SPACE DESCRIBE PROPOSED PROGRAM; IF PROPOSAL IS TO DEEPEN OR PLUG BACK, GIVE DATA ON PRESENT PRODUCTIVE ZONE AND PROPOSED NEW PRODUCTIVE ZONE. GIVE BLOWOUT PREVENTER PROGRAM, IF ANY.

hereby certify that the information above is true and complete to the best of my knowledge and belief.

Signed

Title Geologist

Date

1-24-84

(This space for State Use)

APPROVED BY

M. L. Williams

TITLE

OIL AND GAS INSPECTOR

DATE

JAN 25 1984

CONDITIONS OF APPROVAL, IF ANY:

## OIL CONSERVATION DIVISION

STATE OF NEW MEXICO  
ENERGY AND MINERALS DEPARTMENTP. O. BOX 2088  
SANTA FE, NEW MEXICO 87501Form C-102  
Revised 10-1-78

All distances must be from the outer boundaries of the Section.

Operator J E M Resources, Inc.		Lease Diamond State		Well No. 1
Unit Letter O	Section 4	Township 17- South	Range 29 East	County Eddy
Actual Footage Location of Well:				
330 feet from the South line and		2310 feet from the East line		
Ground Level Elev. 3576 MSL	Producing Formation GB-SA	Pool CAVE - G - 5H	Dedicated Acreage: 40 Acres	

- Outline the acreage dedicated to the subject well by colored pencil or hachure marks on the plat below.
- If more than one lease is dedicated to the well, outline each and identify the ownership thereof (both as to working interest and royalty).
- If more than one lease of different ownership is dedicated to the well, have the interests of all owners been consolidated by communitization, unitization, force-pooling, etc?

☐ Yes ☐ No If answer is "yes," type of consolidation \_\_\_\_\_

If answer is "no," list the owners and tract descriptions which have actually been consolidated. (Use reverse side of this form if necessary.) \_\_\_\_\_

No allowable will be assigned to the well until all interests have been consolidated (by communitization, unitization, forced-pooling, or otherwise) or until a non-standard unit, eliminating such interests, has been approved by the Division.

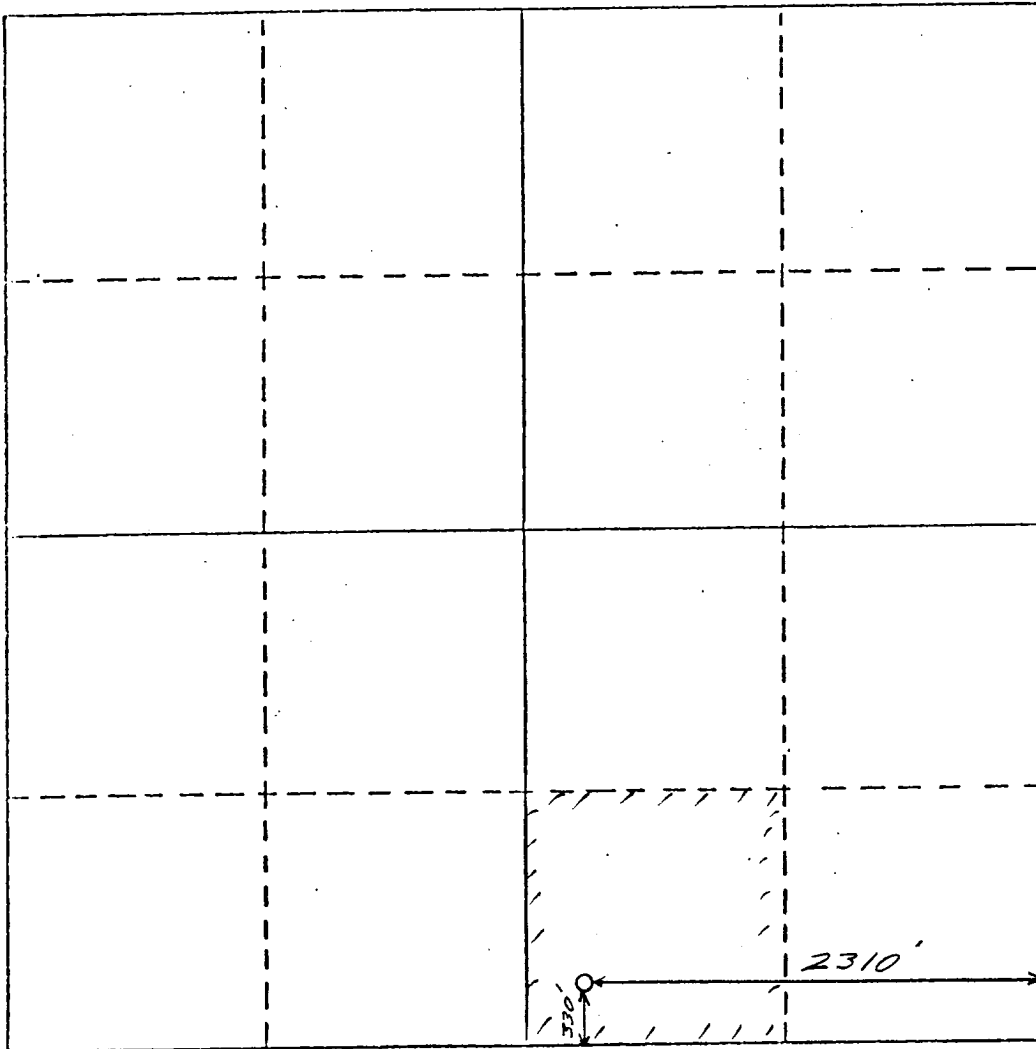

## CERTIFICATION

I hereby certify that the information contained herein is true and complete to the best of my knowledge and belief.

Name  
RANDALL L. HARRIS

Position  
GEOLOGIST

Company  
J. E. M. Resources

Date  
1/23/84

I hereby certify that the well location shown on this plat was plotted from field notes of actual surveys made by me or under my supervision, and that the same is true and correct to the best of my knowledge and belief.

January 21, 1984 PAT  
Date Surveyed

P. R. Patton

Registered Professional Engineer  
and/or Land Surveyor

8112

Certificate No.