

30-015-24803

NO. OF COPIES RECEIVED	
DISTRIBUTION	
SANTA FE	<input checked="" type="checkbox"/>
FILE	<input checked="" type="checkbox"/>
U.S.G.S.	<input checked="" type="checkbox"/>
LAND OFFICE	<input checked="" type="checkbox"/>
OPERATOR	<input checked="" type="checkbox"/>

NEW MEXICO OIL CONSERVATION COMMISSION

Form C-101
Revised 1-1-65

RECEIVED BY

JAN 31 1984

5A. Indicate Type of Lease

STATE ☒ FEE ☐

5. State Oil & Gas Lease No.

B - 2130

APPLICATION FOR PERMIT TO DRILL, DEEPEN, OR PLUG BACK

1a. Type of Work		DRILL <input checked="" type="checkbox"/> DEEPEN <input type="checkbox"/> PLUG BACK <input type="checkbox"/>	
b. Type of Well		OIL WELL <input checked="" type="checkbox"/> GAS WELL <input type="checkbox"/> OTHER <input type="checkbox"/>	
2. Name of Operator		Anadarko Production Company	
3. Address of Operator		P. O. Drawer 130, Artesia, New Mexico 88210	
4. Location of Well		UNIT LETTER <u>L</u> LOCATED <u>2630</u> FEET FROM THE <u>South</u> LINE AND <u>1200</u> FEET FROM THE <u>West</u> LINE OF SEC. <u>2</u> T. <u>17S</u> R. <u>30E</u> N. <u>MPM</u>	
5. Unit Agreement Name		Burnham Grayburg San Andres Unit	
6. Farm or Lease Name		Tract No. 5	
7. Well No.		3	
8. Field and Pool, or Wildcat		Square Lake-Grayburg-SA	
9. County		Eddy	
10. Proposed Depth		3250'	
11. Formation		Grayburg	
12. Rotary or C.T.		Rotary	
13. Elevations (Show whether D.F., R.F., etc.)		3768.2' GL	
14. Kind & Status Plug. Bond		Blanket	
15. Drilling Contractor		W E K Drilling Co.	
16. Approx. Date Work will start		March 14, 1984	

PROPOSED CASING AND CEMENT PROGRAM

SIZE OF HOLE	SIZE OF CASING	WEIGHT PER FOOT	SETTING DEPTH	SACKS OF CEMENT	EST. TOP
12-1/4"	8-5/8"	24.0#	500'	Approx. 250	Circulated
7-7/8"	5-1/2"	15.5#	3250'	Approx. 500	Circulated

1. Rig up rotary tool.
2. Drill 12-1/4" hole to approx. 500'; set & circulate or readymix cement to surface on 8-5/8" casing. Install & test Series 900 Double Ram Hydraulic Blowout Preventor.
3. Drill 7-7/8" hole to T D (approx. 3250'); run Open Hole Logs.
4. Set & circulate cement on 5-1/2" casing from T D to surface.
5. Perforate, acidize and fracture treat.
6. Run 2-3/8" tubing, rods and bottomhole pump; install pumping equipment and place well on production.

Note: This is an unorthodox location; a hearing has been scheduled in Santa Fe February 29, 1984 for approval of this location.

APPROVED FOR 180 DAYS
9-14-84
UNDERWAY

IN ABOVE SPACE DESCRIBE PROPOSED PROGRAM; IF PROPOSED IS TO DEEPEN OR PLUG BACK, GIVE DATA ON PRESENT PRODUCTIVE ZONE AND PROPOSED NEW PRODUCTIVE ZONE. GIVE BLOWOUT PREVENTER PROGRAM, IF ANY.

I hereby certify that the information above is true and complete to the best of my knowledge and belief.

Signed Truman D. Jones Title Field Foreman Date January 30, 1984
(This space for State Use)

APPROVED BY Mike Walker TITLE OIL AND GAS INSPECTOR DATE MAR 14 1984
CONDITIONS OF APPROVAL, IF ANY:

Post to P-3
P-1-12-7-8-84
3-16-84

**NEW MEXICO OIL CONSERVATION COMMISSION
WELL LOCATION AND ACREAGE DEDICATION PLAT**

Form C-102
Supersedes C-128
Effective 1-1-65

All distances must be from the outer boundaries of the Section.

Operator ANADARKO PRODUCTION COMPANY			Lease Burnham Tract #5		Well No. 3
Unit Letter L	Section 2	Township 17 South	Range 30 East	County Eddy	
Actual Footage Location of Well: 2630 feet from the South line and 1200 feet from the West line					
Ground Level Elev. 3768.2	Producing Formation Grayburg		Pool Square Lake-Grayburg San Andres		Dedicated Acreage: 40 Acres

1. Outline the acreage dedicated to the subject well by colored pencil or hatchure marks on the plat below.
2. If more than one lease is dedicated to the well, outline each and identify the ownership thereof (both as to working interest and royalty).
3. If more than one lease of different ownership is dedicated to the well, have the interests of all owners been consolidated by communitization, unitization, force-pooling, etc?

☐ Yes ☐ No If answer is "yes," type of consolidation _____

If answer is "no," list the owners and tract descriptions which have actually been consolidated. (Use reverse side of this form if necessary.) _____

No allowable will be assigned to the well until all interests have been consolidated (by communitization, unitization, forced-pooling, or otherwise) or until a non-standard unit, eliminating such interests, has been approved by the Commission.

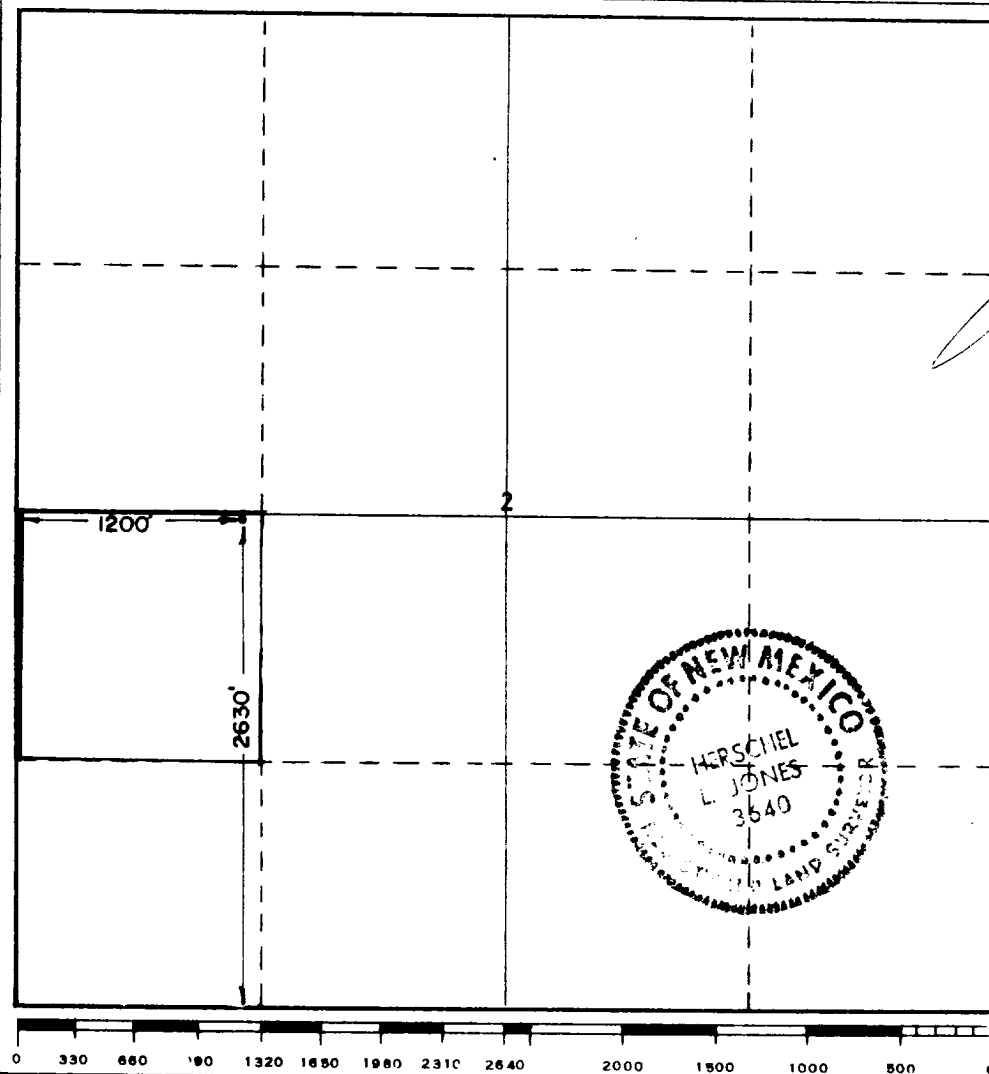

CERTIFICATION

I hereby certify that the information contained herein is true and complete to the best of my knowledge and belief.

Name
Jerry E. Buckles
Position
Area Supervisor
Company
Anadarko Production Company

Date
January 30, 1984

I hereby certify that the well location shown on this plat was plotted from field notes of actual surveys made by me or under my supervision, and that the same is true and correct to the best of my knowledge and belief.

Date Surveyed

1/26/84

Registered Professional Engineer and/or Land Surveyor

Certificate No.

3640