

STATE OF NEW MEXICO
ENERGY AND MINERALS DEPARTMENT

OIL CONSERVATION DIVISION

P. O. BOX 2088
SANTA FE, NEW MEXICO 87501Form C-101
Revised 10-1-78

NO. OF COPIES RECEIVED	
DISTRIBUTION	
SANTA FE	
FILE	
U.S.G.S.	
LAND OFFICE	
OPERATOR	

5A. Indicate Type of Lease
STATE <input checked="" type="checkbox"/> FEE <input type="checkbox"/>
5. State Oil & Gas Lease No.
B-10714

APPLICATION FOR PERMIT TO DRILL, DEEPEN, OR PLUG BACK

1a. Type of Work		7. Unit Agreement Name	
b. Type of Well DRILL <input checked="" type="checkbox"/> DEEPEN <input type="checkbox"/> PLUG BACK <input type="checkbox"/> OIL WELL <input checked="" type="checkbox"/> GAS WELL <input type="checkbox"/> OTHER <input type="checkbox"/> SINGLE ZONE <input checked="" type="checkbox"/> MULTIPLE ZONE <input type="checkbox"/>		8. Farm or Lease Name G.J. West Coop Unit	
2. Name of Operator Marbob Energy Corporation ✓		9. Well No. 63	
3. Address of Operator P.O. Drawer 217, Artesia, N.M. 88210		10. Field and Pool, or Wildcat Grbg Jackson SR Qn G SA	
4. Location of Well UNIT LETTER <u>M</u> LOCATED <u>330</u> FEET FROM THE <u>South</u> LINE AND <u>330</u> FEET FROM THE <u>West</u> LINE OF SEC. <u>22</u> TWP. <u>17S</u> RGE. <u>29E</u> NMPM		12. County Eddy	
19. Proposed Depth 3500'		19A. Formation San Andres	20. Rotary or C.T. Rotary
21. Elevations (Show whether DE, RT, etc.) 3543.2' GR	21A. Kind & Status Plug. Bond Statewide active	21B. Drilling Contractor Larue Drilling Co.	22. Approx. Date Work will start 11/19/84

23.

PROPOSED CASING AND CEMENT PROGRAM

SIZE OF HOLE	SIZE OF CASING	WEIGHT PER FOOT	SETTING DEPTH	SACKS OF CEMENT	EST. TOP
12 1/4"	8 5/8"	24#	350'	Sufficient to circulate	
7 7/8"	5 1/2"	15.50#	3500'	450 sax, to base of salt	

We propose to drill to 350', run 8 5/8" casing and cement, drill on to test the San Andres zone, run 5 1/2" casing and put on production.

APPROVAL VALID FOR 180 DAYS
PERMIT EXPIRES 5-13-85
UNLESS DRILLING UNDERWAY

IN ABOVE SPACE DESCRIBE PROPOSED PROGRAM; IF PROPOSAL IS TO DEEPEN OR PLUG BACK, GIVE DATA ON PRESENT PRODUCTIVE ZONE AND PROPOSED NEW PRODUCTIVE ZONE. GIVE BLOWOUT PREVENTER PROGRAM, IF ANY.

I hereby certify that the information above is true and complete to the best of my knowledge and belief.

Signed Carolyn Purcella Title Production Clerk Date 11/9/84

(This space for State Use)

Original Signed By
Mike Williams
Oil & Gas Inspector

DATE

NOV 14 1984

APPROVED BY

CONDITIONS OF APPROVAL, IF ANY:

N. MEXICO OIL CONSERVATION COMMISS
WELL LOCATION AND ACREAGE DEDICATION PLAT

Form C-102
Supersedes C-128
Effective 1-1-65

All distances must be from the outer boundaries of the Section.

Operator MARBOB ENERGY CORP.		Lease G-J WEST COOP UNIT		Well No. 63
Unit Letter M	Section 22	Township 17S	Range 29E	County EDDY
Actual Footage Location of Well: 330 feet from the SOUTH line and 330 feet from the WEST line				
Ground Level Elev. 3543.2	Producing Formation San Andres	Pool Grbg Jackson SR Qn Grbg SA	Dedicated Acreage: 40 Acres	

1. Outline the acreage dedicated to the subject well by colored pencil or hachure marks on the plat below.
2. If more than one lease is dedicated to the well, outline each and identify the ownership thereof (both as to working interest and royalty).
3. If more than one lease of different ownership is dedicated to the well, have the interests of all owners been consolidated by communitization, unitization, force-pooling, etc?

☐ Yes ☐ No If answer is "yes," type of consolidation _____

If answer is "no," list the owners and tract descriptions which have actually been consolidated. (Use reverse side of this form if necessary.) _____

No allowable will be assigned to the well until all interests have been consolidated (by communitization, unitization, forced-pooling, or otherwise) or until a non-standard unit, eliminating such interests, has been approved by the Commission.

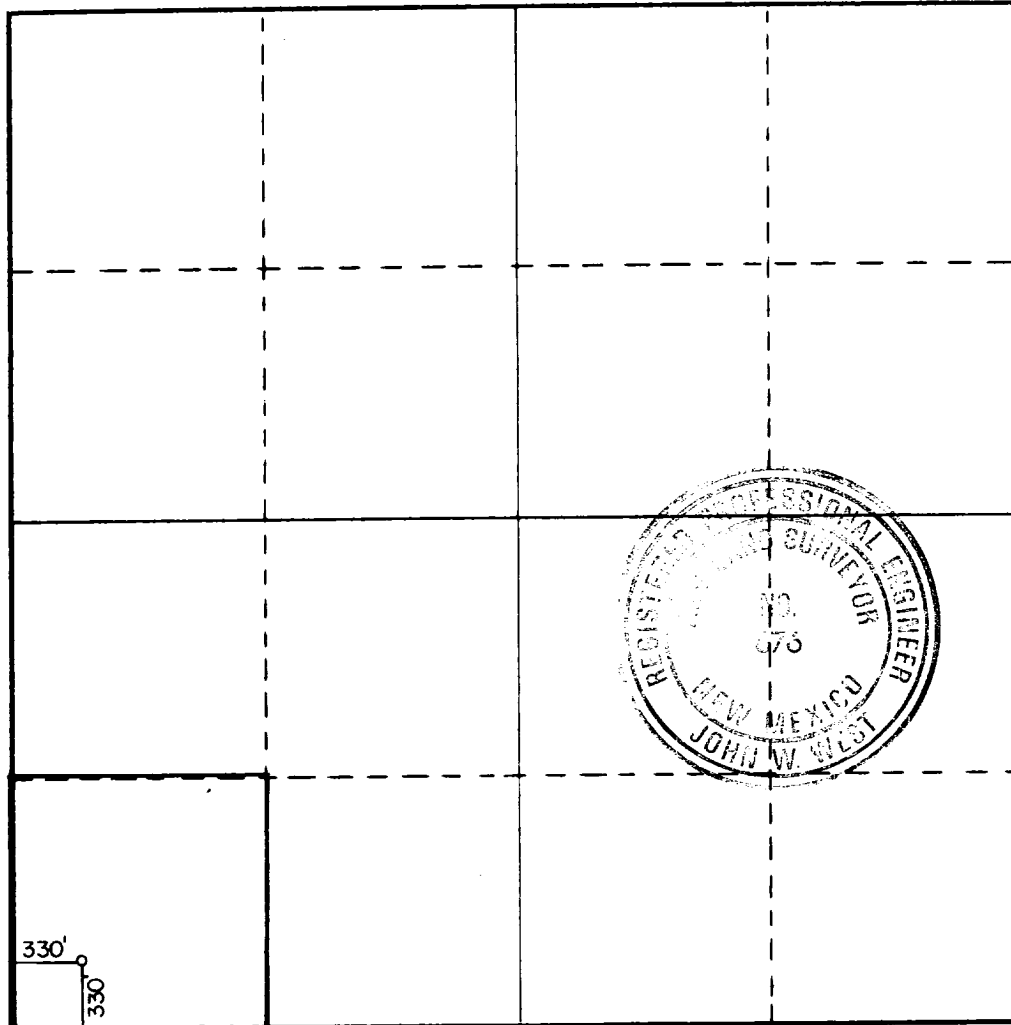

CERTIFICATION

I hereby certify that the information contained herein is true and complete to the best of my knowledge and belief.

Carolyn Purcella
Name

Carolyn Purcella

Position

Production Clerk

Company

Marbob Energy Corporation

Date

11/9/84

I hereby certify that the well location shown on this plat was plotted from field notes of actual surveys made by me or under my supervision, and that the same is true and correct to the best of my knowledge and belief.

Date Surveyed

10/24/84

Registered Professional Engineer and/or Land Surveyor

John W. West
Certificate No. JOHN W. WEST, 676

RONALD J. EIDSON, 3239