

UNITED STATES
DEPARTMENT OF THE INTERIOR
GEOLOGICAL SURVEYSUBMIT IN TRIPLICATE*
(Other instructions on re-
verse side)Form approved.
Budget Bureau No. 42-R1424.

5. LEASE DESIGNATION AND SERIAL NO.

NM-0467930

6. IF INDIAN, ALLOTTEE OR TRIBE NAME

7. UNIT AGREEMENT NAME

8. FARM OR LEASE NAME

Dale H. Parke "A" Tr. 1

9. WELL NO.

9

10. FIELD AND POOL, OR WILDCAT

Grayburg-Jackson (SR,Q,G,SF)

11. SEC., T., R., M., OR BLE. AND
SURVEY OR AREA

Sec. 22, T-17-S, R-30-E

12. COUNTY OR PARISH 13. STATE

Eddy

N.M.

SUNDRY NOTICES AND REPORTS ON WELLS

(Do not use this form for proposals to drill or to deepen or plug back to a different reservoir.
Use "APPLICATION FOR PERMIT" for RE-PROPOSED BY1. OIL WELL ☒ GAS WELL ☐ OTHER ☐

2. NAME OF OPERATOR

Southland Royalty Company ✓

3. ADDRESS OF OPERATOR

21 Desta Drive, Midland, Texas 79705

4. LOCATION OF WELL (Report location clearly and in accordance with any State requirements.*
See also space 17 below.)
At surface

990' FNL & 2310' FWL, Sec. 22, T-17-S, R-30-E

14. PERMIT NO.

15. ELEVATIONS (Show whether DF, RT, CR, etc.)

3676.5' GR

16. Check Appropriate Box To Indicate Nature of Notice, Report, or Other Data

NOTICE OF INTENTION TO:

TEST WATER SHUT-OFF ☐FRACTURE TREAT ☐SHOOT OR ACIDIZE ☐REPAIR WELL ☐(Other) ☐PULL OR ALTER CASING ☐MULTIPLE COMPLETION ☐ABANDON* ☐CHANGE PLANS ☐

SUBSEQUENT REPORT OF:

WATER SHUT-OFF ☐FRACTURE TREATMENT ☐SHOOTING OR ACIDIZING ☐(Other) ☐REPAIRING WELL ☐ALTERING CASING ☐ABANDONMENT* ☐Set 8 5/8" Surface Csg. ☒(Note: Report results of multiple completion on Well
Completion or Recompletion Report and Log form.)

17. DESCRIBE PROPOSED OR COMPLETED OPERATIONS (Clearly state all pertinent details, and give pertinent dates, including estimated date of starting any proposed work. If well is directionally drilled, give subsurface locations and measured and true vertical depths for all markers and zones pertinent to this work.)*

Spudded 12 1/4" hole @ 2:00 PM 1-15-85. Set 8 5/8" 14# csg @ 452'. Cmt'd w/100
sx C1 "C" Thick Set & 250 sx C1 "C". PD @ 10:30 PM. Circ 5 sxs. WOC 18 hrs.
Tested csg to 1000# with pump and held OK.

18. I hereby certify that the foregoing is true and correct

SIGNED

Daniel Roberts

TITLE

Operations Engineer

DATE

1/17/85

(This space for Federal or State office use)

APPROVED BY RECORDED FOR RECORD
CONDITIONS OF APPROVAL, IF ANY:

TITLE

DATE

JAN 30 1985

*See Instructions on Reverse Side

30-015-25128

UNITED STATES
DEPARTMENT OF THE INTERIOR
GEOLOGICAL SURVEY

APPLICATION FOR PERMIT TO DRILL, DEEPEN, OR PLUG BACK

1A. TYPE OF WORK DRILL <input checked="" type="checkbox"/> DEEPEN <input type="checkbox"/> PLUG BACK <input type="checkbox"/>		RECEIVED BY DEC 10 1984 O. C. D. ARTESIA, OFFICE	
1B. TYPE OF WELL OIL WELL <input checked="" type="checkbox"/> GAS WELL <input type="checkbox"/> OTHER <input type="checkbox"/>		SINGLE ZONE <input type="checkbox"/> MULTIPLE ZONE <input type="checkbox"/>	
2. NAME OF OPERATOR Southland Royalty Company			
3. ADDRESS OF OPERATOR 21 Desta Drive, Midland, Texas 79705			
4. LOCATION OF WELL (Report location clearly and in accordance with any State requirements.) At surface 990' FNL & 2310' FWL, Sec. 22, T-17-S, R-30-E At proposed prod. zone			
14. DISTANCE IN MILES AND DIRECTION FROM NEAREST TOWN OR POST OFFICE 1/2 mile northeast of Loco Hills			
15. DISTANCE FROM PROPOSED LOCATION TO NEAREST PROPERTY OR LEASE LINE, FT. (Also to nearest drlg. unit line, if any)		16. NO. OF ACRES IN LEASE	
990'		280	
18. DISTANCE FROM PROPOSED LOCATION TO NEAREST WELL, DRILLING, COMPLETED, OR APPLIED FOR, ON THIS LEASE, FT.		19. PROPOSED DEPTH	
700'		3600'	
21. ELEVATIONS (Show whether DF, RT, GR, etc.)		17. NO. OF ACRES ASSIGNED TO THIS WELL	
3676.5' GR		40	
23. PROPOSED CASING AND CEMENTING PROGRAM		20. ROTARY OR CABLE TOOLS	
per telecon w/ Danell Roberts 11/26/84		Rotary	
22. APPROX. DATE WORK WILL START		12-15-84	
SIZE OF HOLE	SIZE OF CASING	WEIGHT PER FOOT	SETTING DEPTH
12 1/4"	8 5/8"	24#	450'
7 7/8"	5 1/2"	15.5#	3600'
QUANTITY OF CEMENT		350 sx (Circ.)	
Dependent on Wtr flows (Circ.)			

Drill 12 1/4" hole to 450'. Set 8 5/8" csg @ 450'. Circ cmt. Drl 7 7/8" hole to 3600'. Set 5 1/2" csg @ 3600'. Cmt w/sufficient volume to bring cmt above the base of the surface csg. Estimated TOC @ 200'. Perf & stimulate Grayburg & San Andres for production.

MUD PROGRAM: 0-450' Spud mud; 450-2650' Brine wtr; 2650-TD Brine gel & starch.

MW 9.6-9.8, VIS 36, FL 10 cc thru San Andres.

BOP PROGRAM: BOP to be tested after setting 8 5/8" csg by Yellow Jacket, Inc.

IN ABOVE SPACE DESCRIBE PROPOSED PROGRAM: If proposal is to deepen or plug back, give data on present productive zone and proposed new productive zone. If proposal is to drill or deepen directionally, give pertinent data on subsurface locations and measured and true vertical depths. Give blowout preventer program, if any.

24.

SIGNED

Danell Roberts

TITLE

Operations Engineer

DATE

11/19/84

(This space for Federal or State office use)

PERMIT NO.

APPROVAL DATE

APPROVED BY

Dan W. Wood

TITLE

Asst. Dir.

DATE

12-7-84

CONDITIONS OF APPROVAL, IF ANY:

*See Instructions On Reverse Side

APPROVAL SUBJECT TO
GENERAL REQUIREMENTS AND
SPECIAL STIPULATIONS
ATTACHED

**N MEXICO OIL CONSERVATION COMMISSION
WELL LOCATION AND ACREAGE DEDICATION PLAT**

Form C-102
Supersedes C-128
Effective 1-1-65

All distances must be from the outer boundaries of the Section

Lessor SOUTHLAND ROYALTY CO.			Lease DALE H. PARKE "A" TRACT 1		Well No. 9
Well Letter C	Section 22	Township 17S	Range 30E	County EDDY	
Actual Footage Location of Well: <div style="display: flex; justify-content: space-between;"> (990) feet from the NORTH line and 2310 feet from the WEST line </div>					
Ground Level Elev. 3676.5	Producing Formation Grayburg-San Andres	Pool Grayburg-Jackson		Dedicated Acreage: 40 Acres	

1. Outline the acreage dedicated to the subject well by colored pencil or hatchure marks on the plat below.
2. If more than one lease is dedicated to the well, outline each and identify the ownership thereof (both as to working interest and royalty).
3. If more than one lease of different ownership is dedicated to the well, have the interests of all owners been consolidated by communitization, unitization, force-pooling, etc?

☐ Yes ☒ No If answer is "yes," type of consolidation _____

If answer is "no," list the owners and tract descriptions which have actually been consolidated. (Use reverse side of this form if necessary.) _____

No allowable will be assigned to the well until all interests have been consolidated (by communitization, unitization, forced-pooling, or otherwise) or until a non-standard unit, eliminating such interests, has been approved by the Commission.

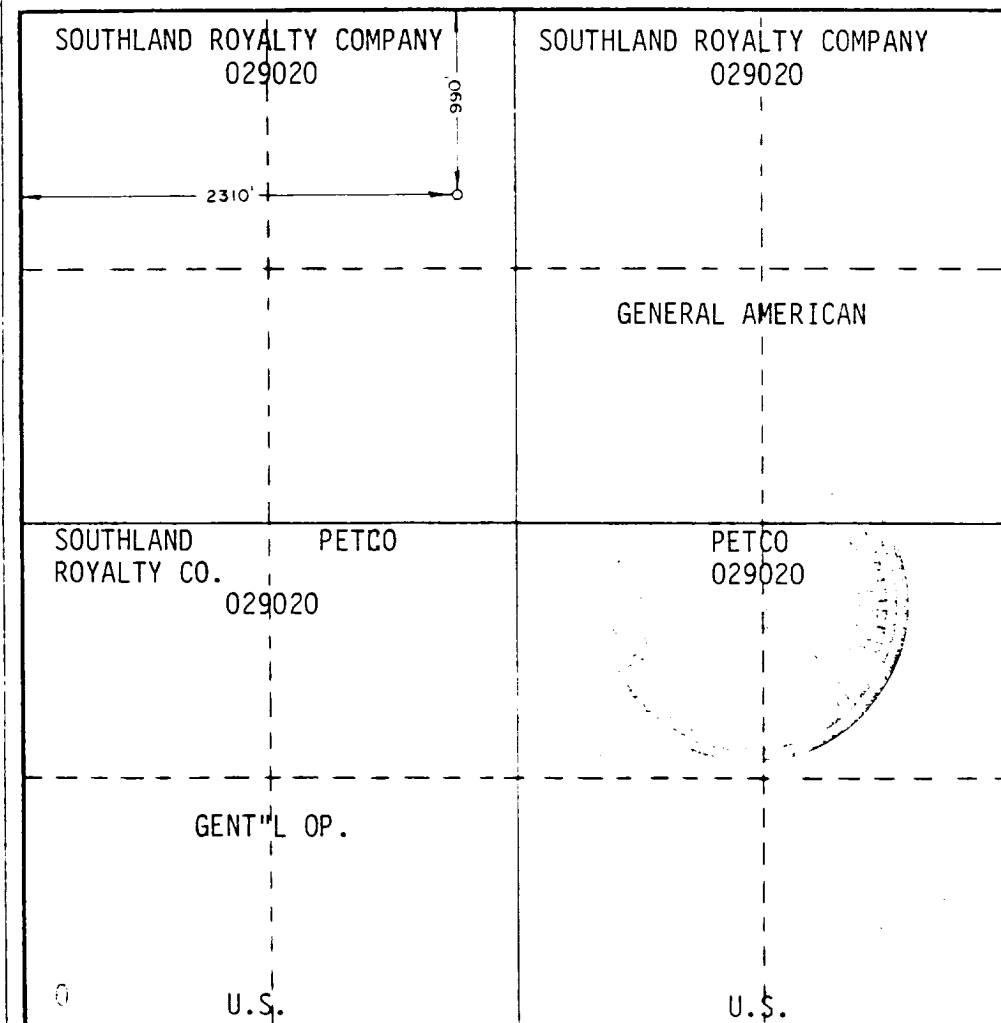

CERTIFICATION

I hereby certify that the information contained herein is true and complete to the best of my knowledge and belief.

Darrell Roberts

Name
Darrell Roberts
Position
Operations Engineer
Company
Southland Royalty Company

Date
11-19-84

I hereby certify that the well location shown on this plat was plotted from field notes of actual surveys made by me or under my supervision, and that the same is true and correct to the best of my knowledge and belief.

Date Surveyed
11/2/84

Registered Professional Engineer
and/or Land Surveyor

John W. West

Certificate No. **JOHN W. WEST, 676**
RONALD J. EIDSON, 3239

0 330 660 990 1320 1650 1980 2310 2640 2000 1600 1200 800 0

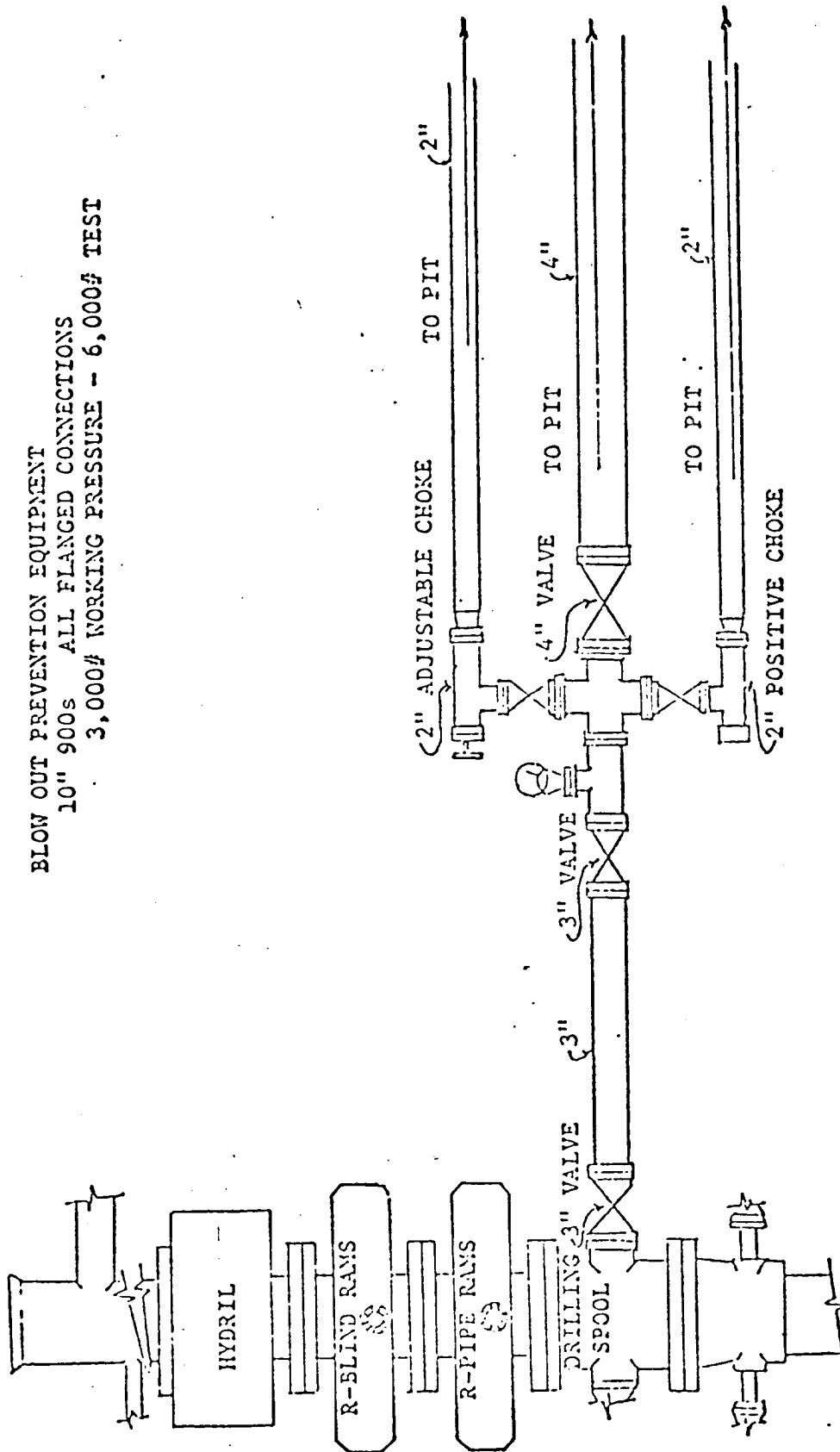

BLOW OUT PREVENTION EQUIPMENT
 10" 900s ALL FLANGED CONNECTIONS
 3,000# WORKING PRESSURE - 6,000# TEST

SOUTHLAND ROYALTY COMPANY

Dale H. Parke "A" Tr. 1 No. 9
990' FNL & 2310' FWL
Sec. 22, T-17-S, R-30-E
Eddy County, New Mexico
LC-029020

To supplement USGS Form 9-331C "Application to Drill the following additional information is submitted concerning questions on Page 5 of NTL-6:

1. See Form 9-331C.
2. See Form 9-331C.
3. The geological name of surface formation is: Quaternary Alluvium
4. See Form 9-331C.
5. See Form 9-331C.
6. The estimated tops of important geological markers are:

Salt	540'	Grayburg	2632'
B/Salt	1100'	Premier	2928'
Seven Rivers	1655'	San Andres	2980'
Queen	2215'	Jackson	3300'

7. The estimated depths at which anticipated water, oil gas and mineral bearing strata are as follows:

Grayburg	2632' (Oil)
San Andres	2980' (Oil)

8. See Form 9-331C. All casing will be new.
9. See Form 9-331C for depths of strings. Cement volumes and additions as follows:
 - a. 8 5/8" csg: Cement w/350 sxs Cl "C" w/2% CaCl. Circ to surf.
 - b. 5 1/2" csg: Cement w/700 sx Class "H" 50-50 Poz A, 18# salt, 6# gilsonite & 1/4# flocele/sx & 400 sx Cl "H". Top of cmt anticipated at 200'.

A caliper log will be run prior to setting 8 5/8" & 5 1/2" csg to determine exact cement volumes required.

10. The pressure control diagram is attached to Form 9-331C. The following additional information is as follows:

8 5/8" casing installation: 10"-3M BOP stack to be installed and tested by Yellow Jacket, Inc. to 3,000 psi before drilling the 8 5/8" casing shoe. The BOP stack to consist of an annular BOP, blind ram BOP and one pipe ram BOP.

11. See Form 9-331C.

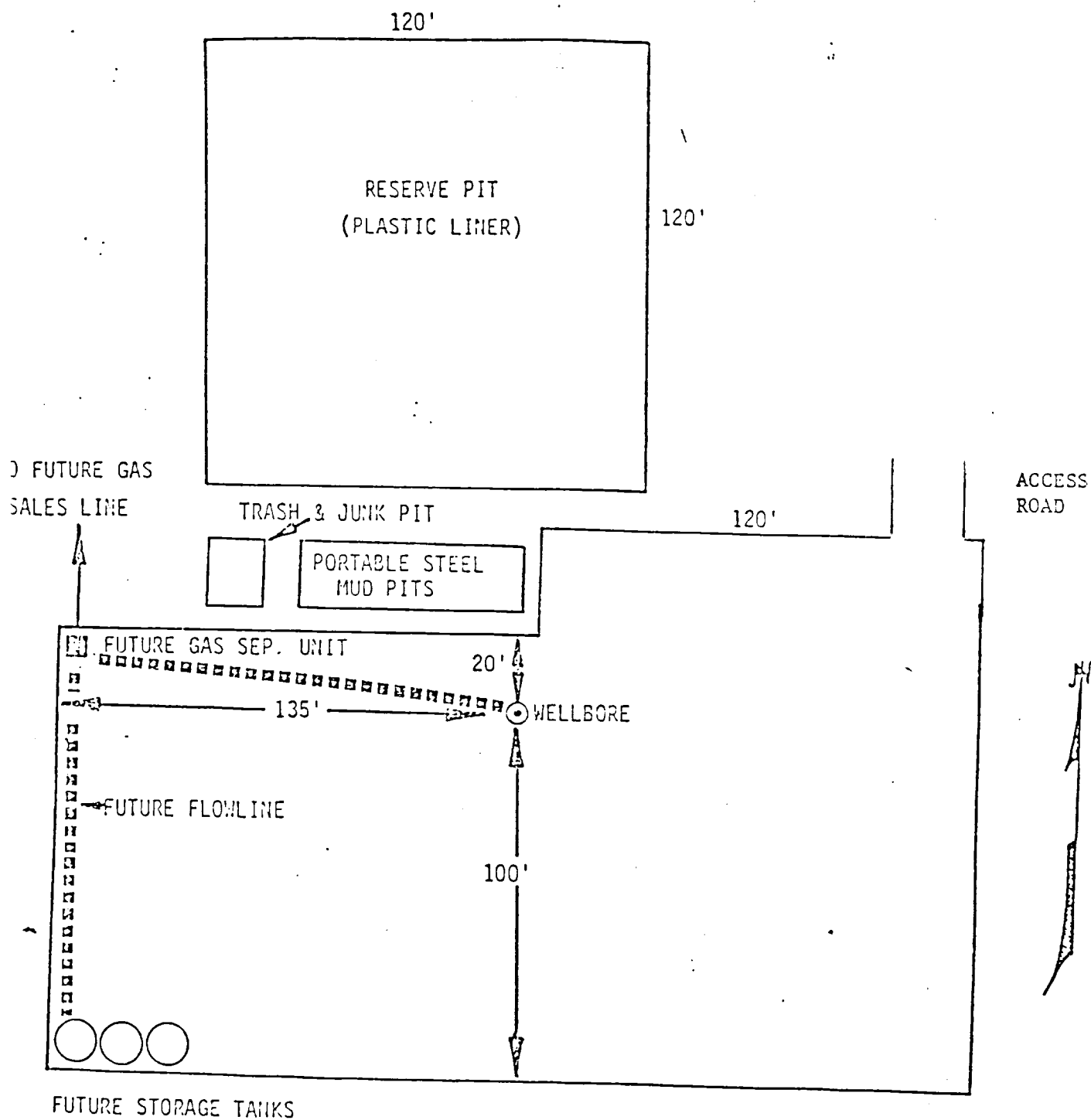

EXHIBIT "C"



Southland Royalty Company

21 DESTA DRIVE, MIDLAND, TEXAS 79705

Dale H. Parke "A" Tr. 1 No. 9
 990' FNL & 2310' FWL
 Sec. 22, T-17-S, R-30-E
 Eddy County, New Mexico
 LC-029020

Scale 1" = 40'