

UNITED STATES
DEPARTMENT OF THE INTERIOR
BUREAU OF LAND MANAGEMENT

APPLICATION FOR PERMIT TO DRILL, DEEPEN, OR PLUG BACK

1a. TYPE OF WORK

DRILL ☒

DEEPEN ☐

PLUG BACK ☐

b. TYPE OF WELL

OIL
WELL ☒

GAS
WELL ☐

OTHER

SINGLE
ZONE ☒

MULTIPLE
ZONE ☐

2. NAME OF OPERATOR ARCO Oil and Gas Company
Division of Atlantic Richfield Company

3. ADDRESS OF OPERATOR

P. O. Box 1710, Hobbs, New Mexico 88240

4. LOCATION OF WELL (Report location clearly and in accordance with any State requirements) C. D.

At surface 1980' FNL & 1700' FWL (Unit letter F)

At proposed prod. zone

as above

14. DISTANCE IN MILES AND DIRECTION FROM NEAREST TOWN OR POST OFFICE*

28.0 mi East of Artesia, N.M. on U.S. Hwy 82, 1.3 mi north on
County Rd 221, 0.9 mi NE on existing caliche road

10. DISTANCE FROM PROPOSED*

LOCATION TO NEAREST
PROPERTY OR LEASE LINE, FT.
(Also to nearest drlg. unit line, if any) 1700' West

16. NO. OF ACRES IN LEASE

606.92

17. NO. OF ACRES ASSIGNED

40

18. DISTANCE FROM PROPOSED LOCATION*
TO NEAREST WELL, DRILLING, COMPLETED,
OR APPLIED FOR, ON THIS LEASE, FT.

19. PROPOSED DEPTH

3600'

20. ROTARY OR CABLE TOOLS

Rotary

21. ELEVATIONS (Show whether DF, RT, GR, etc.)

3718.5' GR 3717

22. APPROX. DATE WORK WILL START*

October 25, 1985

23.

PROPOSED CASING AND CEMENTING PROGRAM

SIZE OF HOLE	SIZE OF CASING	WEIGHT PER FOOT	SETTING DEPTH	QUANTITY OF CEMENT
26"	20"	Cond. Pipe	30'	3 yds Redi-mix
17½"	13-3/8"	54.5# K-55	500'	500 sx, Circ.
12½"	8-5/8"	24# K-55	1500'	600 sx, Circ.
7-7/8"	5½"	15.5# K-55	3550'	1000 sx, Circ.

Propose to drill a development well and test the producing capabilities of the Grayburg San Andres.

BOP program attached.

IN ABOVE SPACE DESCRIBE PROPOSED PROGRAM: If proposal is to deepen or plug back, give data on present productive zone and proposed new productive zone. If proposal is to drill or deepen directionally, give pertinent data on subsurface locations and measured and true vertical depths. Give blowout preventer program, if any.

24.

SIGNED

J. L. Keel

TITLE

Engrg Tech Spec.

DATE 9/16/85

(This space for Federal or State office use)

PERMIT NO.

APPROVAL DATE

APPROVED BY

TITLE

DATE

4-30-85

CONDITIONS OF APPROVAL, IF ANY:

APPROVAL SUBJECT TO
GENERAL REQUIREMENTS AND
SPECIAL STIPULATIONS

*See Instructions On Reverse Side

Title 18 U.S.C. Section 1001, makes it a crime for any person knowingly and willfully to make to any department or agency of the United States any false, fictitious or fraudulent statements or representations as to any matter within its jurisdiction.

MEXICO OIL CONSERVATION COMMISSION
WELL LOCATION AND ACREAGE DEDICATION PLAT

Form C-102
Supersedes C-128
Effective 1-1-65

All distances must be from the outer boundaries of the Section

Operator ARCO OIL & GAS COMPANY Division of Atlantic Richfield Company			Lease J. L. KEEL "A"		Well No. 16
Unit Letter F	Section 7	Township 17 SOUTH	Range 31 EAST	County EDDY	
Actual Footage Location of Well: 2080 feet from the NORTH line and 1700 feet from the WEST line					
Ground Level Elev. 3717.0'	Producing Formation Queen Grayburg SA		Pool Grayburg Jackson		Dedicated Acreage: 40 Acres

- Outline the acreage dedicated to the subject well by colored pencil or hachure marks on the plat below.
- If more than one lease is dedicated to the well, outline each and identify the ownership thereof (both as to working interest and royalty).
- If more than one lease of different ownership is dedicated to the well, have the interests of all owners been consolidated by communitization, unitization, force-pooling, etc?

☐ Yes ☐ No If answer is "yes," type of consolidation _____

If answer is "no," list the owners and tract descriptions which have actually been consolidated (Use reverse side of this form if necessary.) _____

No allowable will be assigned to the well until all interests have been consolidated (by communitization, unitization, forced-pooling, or otherwise) or until a non-standard unit, eliminating such interests, has been approved by the Commission.

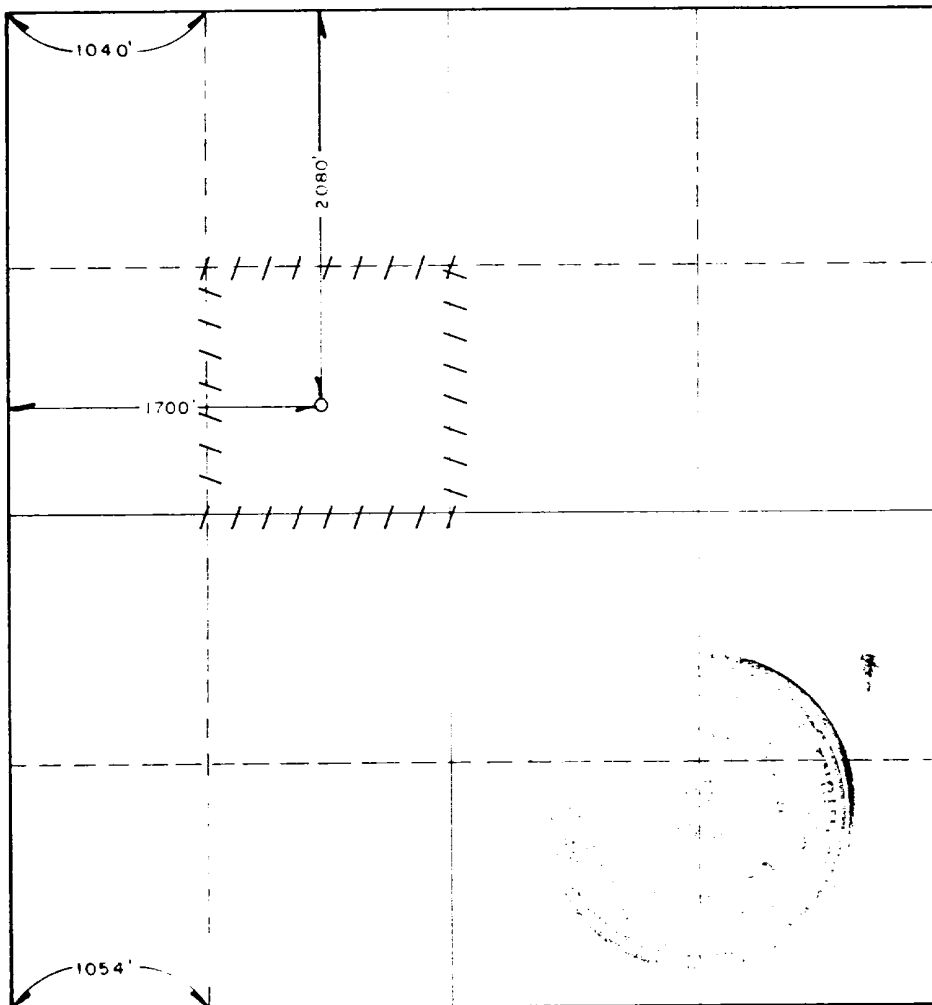

CERTIFICATION

I hereby certify that the information contained herein is true and complete to the best of my knowledge and belief

[Signature]
Engrg Tech Spec

Company ARCO Oil and Gas Co.
Div of Atlantic Richfield Co

Date
9/25/85

I hereby certify that the well location shown on this plat was plotted from field notes of actual surveys made by me or under my supervision, and that the same is true and correct to the best of my knowledge and belief.

Date Surveyed
SEPTEMBER 20, 1985

Registered Professional Engineer
and Land Surveyor

[Signature]
Certificate No. JOHN W. WEST 876

Ronald J. Eidson 3239

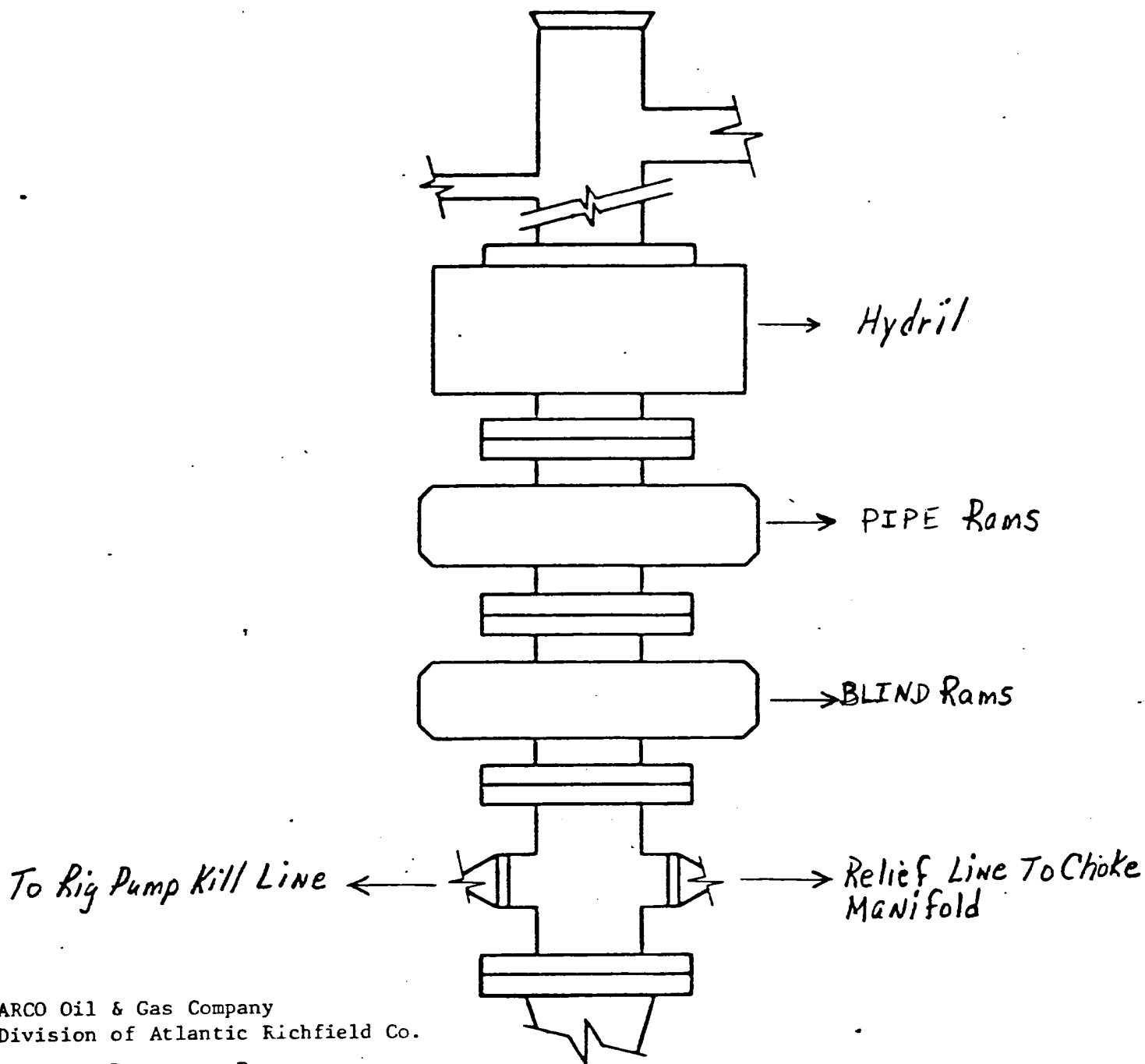

ARCO Oil & Gas Company
 Division of Atlantic Richfield Co.
 Blow Out Preventer Program

Lease Name: J. L. Keel "A"

Well No: 16

Location: 1980' FNL & 1700' FWL
Sec 7-17S-31E, Eddy County

BOP to be tested when installed on well and will be maintained in good working condition during drilling. All wellhead fittings to be of sufficient pressure to operate in a safe manner.

To supplement USGS Form 3160-3 " Application for Permit to Drill, Deepen or Plugback", the following additional information is submitted to comply with USGS Order NTL-6.

Operator: ARCO Oil and Gas Company - Division of Atlantic Richfield Company

Lease & Well No: J. L. Keel "A" #16

Location: Unit Letter "F"

Section 7-17S-31E

Eddy County, New Mexico

Lease, New Mexico LC 029435(a)

Development well ☒ Exploratory well ☐

1. See Well Location and Acreage Dedication Plat Form C-102.
2. See Form 3160-3 for elevation above sea level of unprepared location.
3. The geologic name of the surface formation is:
Permian Artesian Group
4. The type of drilling tools and associated equipment to be utilized will be: Rotary
5. The proposed drilling depth will be 3600'.
6. The estimated tops of important geologic markers are:

Anhydrite	1350'	Queen	2400'
Yates	1500'	Grayburg	2850'
Seven Rivers	1800'	San Andres	3150'
7. The estimated depths at which anticipated water, oil, gas or other mineral bearing formations are expected to be encountered are:

Fresh Water (Ground Basin)	250'
Oil and Gas (Grayburg)	2850'
Oil and Gas (San Andres)	3150'
8. The proposed casing program including the size, grade and weight-per-foot of each string has been indicated on Form 3160-3. All strings of casing will be: New ☒ Used ☐.
9. See Form 3160-3 for amount of cement.

LITTLE LUCKY LAKE

R30E

R31E

R31E W. ANDERSON
RANCH

W. MESA

HENS HAW

BUNKER HILL

SQUARE LAKE

Proposed Location
Proposed RoadCounty
Road 221

U.S. Highway 82

CEDAR
LAKE

PEAKS





-  Paved Highway
-  Existing Access Roads
-  Proposed New Road - approx 1125' long x 12' wide
-  Proposed Drillsite Location

EXHIBIT "A"

ARCO OIL AND GAS COMPANY
Well no. 16, J. L. Keel "A"
1980' FNL & 1700' FWL
Section 7-17S-31E
Eddy County, New Mexico

Scale: 1" = 8000'

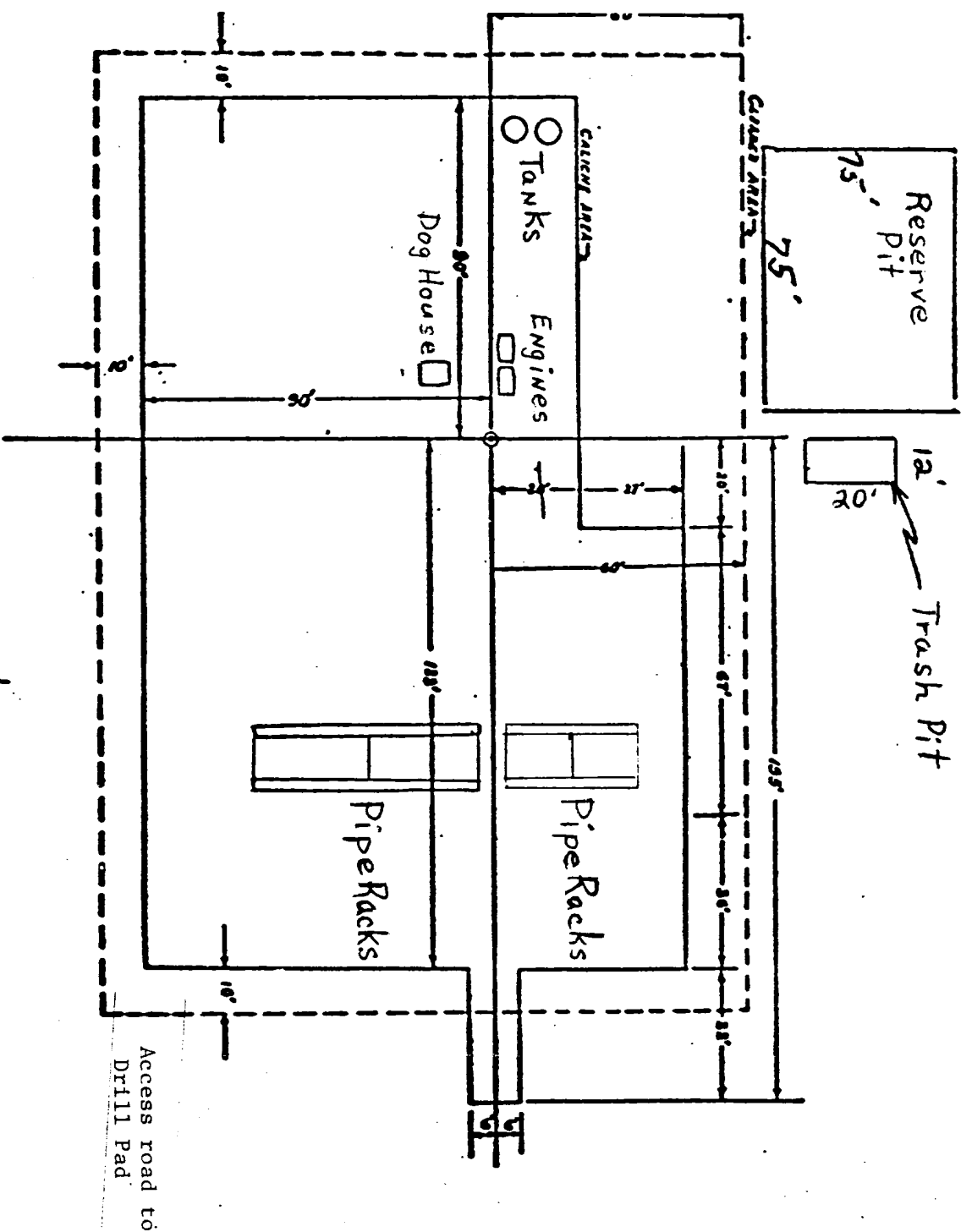

SPECIFICATIONS—

- [illegible]

[illegible]