

NEW MEXICO OIL CONSERVATION COMMISSION
WELL LOCATION AND ACREAGE DEDICATION PLAT

RECEIVED SEP 24 1985
Form C-102
Supersedes C-128
Effective 1-1-85

All distances must be from the outer boundaries of the Section.

Operator SIETE OIL AND GAS CORP.			Lease Falcon Federal			Well No. 1		
Unit Letter E	Section 5	Township 17 South		Range 30 East	County Eddy			
Actual Footage Location of Well: 1980 feet from the North line and 330 feet from the West line								
Ground Level Elev. 3696.	Producing Formation San Andres			Pool Square Lake Grayburg/San Andres		Dedicated Acreage: 40 Acres		

1. Outline the acreage dedicated to the subject well by colored pencil or hatchure marks on the plat below.
2. If more than one lease is dedicated to the well, outline each and identify the ownership thereof (both as to working interest and royalty).
3. If more than one lease of different ownership is dedicated to the well, have the interests of all owners been consolidated by communitization, unitization, force-pooling, etc?

☐ Yes ☐ No If answer is "yes," type of consolidation _____

If answer is "no," list the owners and tract descriptions which have actually been consolidated. (Use reverse side of this form if necessary.) _____

No allowable will be assigned to the well until all interests have been consolidated (by communitization, unitization, forced-pooling, or otherwise) or until a non-standard unit, eliminating such interests, has been approved by the Commission.

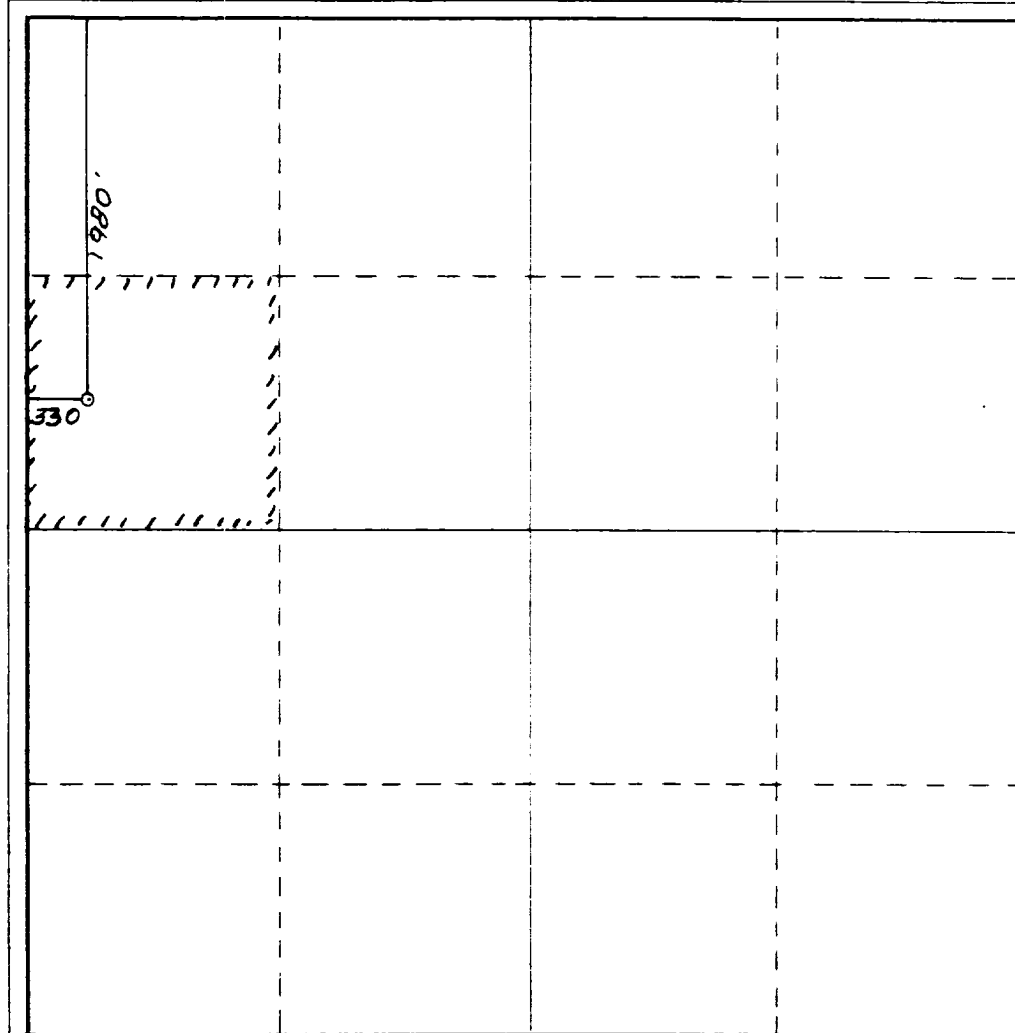

CERTIFICATION

I hereby certify that the information contained herein is true and complete to the best of my knowledge and belief.

Name
Billy G. Underwood, Jr.

Position
President

Company
Siete Oil and Gas Corporation

Date

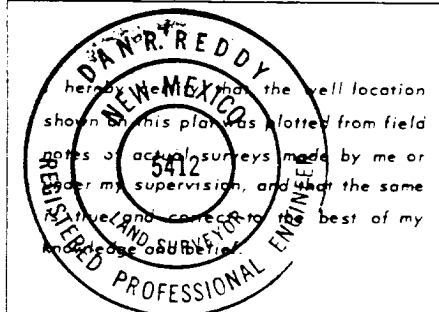

Date Surveyed
September 20, 1985

Registered Professional Engineer
and/or Land Surveyor

Certificate No.
5412

NM PE&LS NO. 5412

0 330 660 990 1320 1650 1980 2310 2640 2000 1500 1000 500