

UNITED STATES
DEPARTMENT OF THE INTERIOR
BUREAU OF LAND MANAGEMENT

SUBMIT IN LICATION

(Other instructions on reverse side)

88210

30-015-25446
Form approved.
Budget Bureau No. 1004-0136
Expires August 31, 1985

APPLICATION FOR PERMIT TO DRILL, DEEPEN, OR PLUG BACK

1. TYPE OF WORK

DRILL ☒

DEEPEN ☐

PLUG BACK ☐

2. TYPE OF WELL

OIL WELL ☒

GAS WELL ☐

OTHER

3. NAME OF OPERATOR

ARCO Oil and Gas Company

Division of Atlantic Richfield Company

4. ADDRESS OF OPERATOR

P. O. Box 1710, Hobbs, New Mexico 88249

5. LOCATION OF WELL (Report location clearly and in accordance with any State requirements)

860' FNL & 860' FEL (Unit Letter A)

At proposed prod. zone

6. DISTANCE IN MILES AND DIRECTION FROM NEAREST TOWN OR POST OFFICE*

7.6 miles northeast of Loco Hills, N. M.

7. DISTANCE FROM PROPOSED*

LOCATION TO NEAREST PROPERTY OR LEASE LINE, FT.

(Also to nearest drlg. unit line, if any) North & East

660'

8. NO. OF ACRES IN LEASE

1920

9. DISTANCE FROM PROPOSED LOCATION*

TO NEAREST WELL, DRILLING, COMPLETED, OR APPLIED FOR, ON THIS LEASE, FT.

10. PROPOSED DEPTH

3550'

11. ELEVATIONS (Show whether DF, RT, GR, etc.)

3768.7'

12.

PROPOSED CASING AND CEMENTING PROGRAM

SIZE OF HOLE	SIZE OF CASING	WEIGHT PER FOOT	SETTING DEPTH	QUANTITY OF CEMENT
26"	20" OD	Cond Pipe	30'	3 yds Redi mix
17-1/2"	13-3/8" OD	54.5# K-55	450'	470 sx Circ
12-1/4"	8-5/8" OD	24# K-55	1515'	900 sx Circ
7-7/8"	5-1/2" OD	15.5# K-55	3550'	920 sx Circ

Propose to drill a development well and test the producing capabilities of the Grayburg Jackson zones.

Blowout Preventer Program attached

IN ABOVE SPACE DESCRIBE PROPOSED PROGRAM: If proposal is to deepen or plug back, give data on present productive zone and proposed new productive zone. If proposal is to drill or deepen directionally, give pertinent data on subsurface locations and measured and true vertical depths. Give blowout preventer program, if any.

24.

SIGNED

D. W. McDaniel

TITLE Dist. Drlg. Supv.

DATE 10-10-85

(This space for Federal or State office use)

PERMIT NO.

APPROVAL DATE

APPROVED BY

Don Ward

TITLE

DATE

10-22-85

CONDITIONS OF APPROVAL, IF ANY:

APPROVAL SUBJECT TO
GENERAL REQUIREMENTS AND
SPECIAL STIPULATIONS

*See Instructions On Reverse Side

N MEXICO OIL CONSERVATION COMMISS 4
WELL LOCATION AND ACREAGE DEDICATION PLAT

Form C-122
Supersedes C-128
Effective 1-1-65

All distances must be from the outer boundaries of the Section

Lessee ARCO OIL & GAS COMPANY Div. of Atlantic Richfield Company			Lease J. L. KEEL "B"			Well No. 32		
Section A	Section 6	Township 17 SOUTH	Range 31 EAST	County EDDY				
Actual Surface Location of Well: 860 feet from the NORTH line and 860 feet from the EAST line								
Ground Level Elev. 707.7'		Producing Formation Queen Grayburg SA		Pool Grayburg Jackson			Estimated Acreage 40 Acres	

1. Outline the acreage dedicated to the subject well by colored pencil or hatchure marks on the plat below.
2. If more than one lease is dedicated to the well, outline each and identify the ownership thereof (both as to working interest and royalty).
3. If more than one lease of different ownership is dedicated to the well, have the interests of all owners been consolidated by communitization, unitization, force-pooling, etc?

☐ Yes ☐ No If answer is "yes," type of consolidation _____

If answer is "no," list the owners and tract descriptions which have actually been consolidated. (Use reverse side of this form if necessary.) _____

No allowable will be assigned to the well until all interests have been consolidated (by communitization, unitization, forced-pooling, or otherwise) or until a non-standard unit, eliminating such interests, has been approved by the Commission.

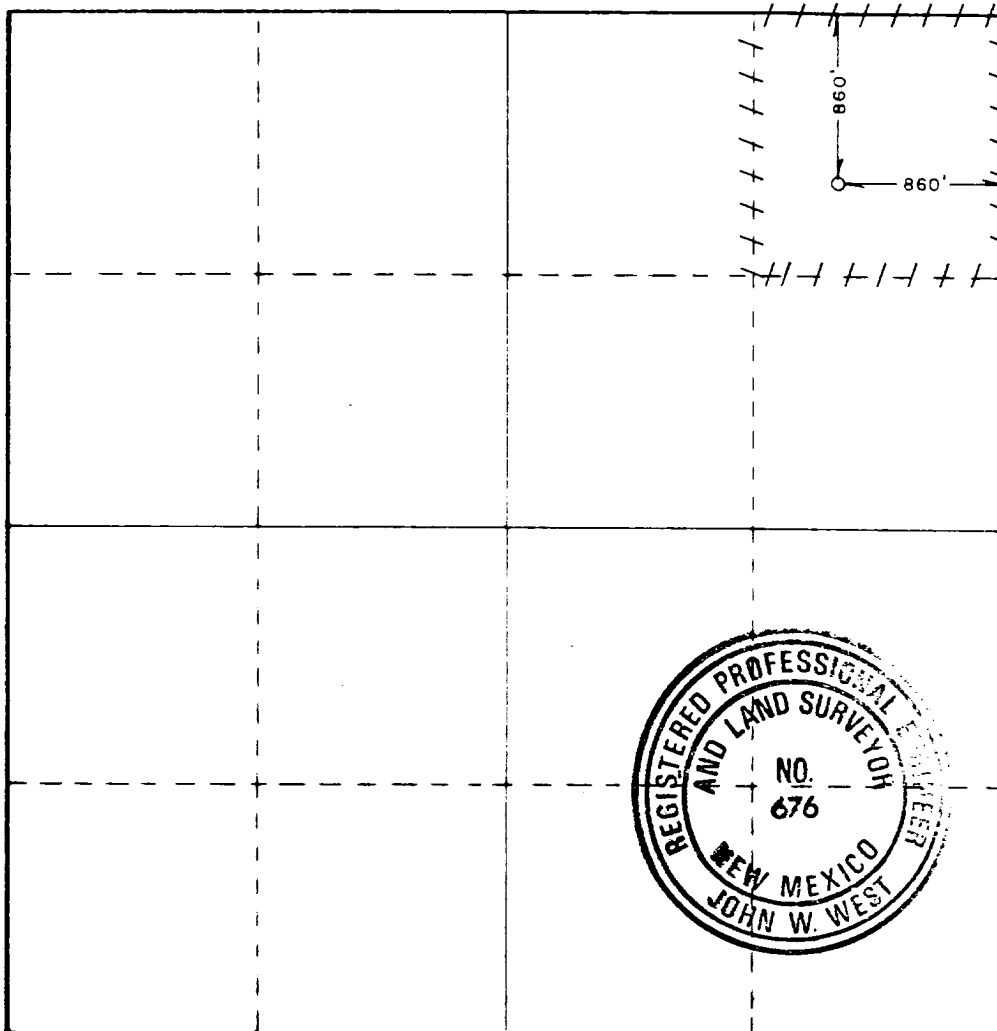

CERTIFICATION

I hereby certify that the information contained herein is true and complete to the best of my knowledge and belief.

Name
John W. West
Position
Dist Drlg. Supt.
Company
ARCO Oil and Gas Company
Div of Atlantic Richfield Co.

Date
10/11/85

I hereby certify that the well location shown on this plat was plotted from field notes of actual surveys made by me or under my supervision, and that the same is true and correct to the best of my knowledge and belief.

Date Surveyed
OCTOBER 8, 1985

Registered Professional Engineer
and/or Land Surveyor

Certificate No. JOHN W. WEST, 676
RONALD J. EIDSON, 3239

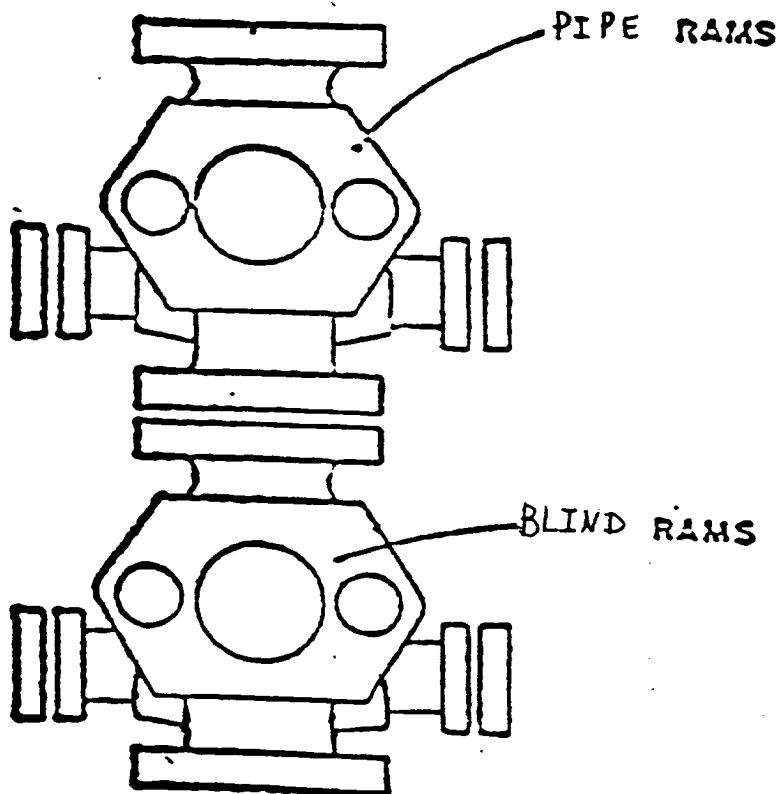

ARCO Oil & Gas Company

Division of Atlantic Richfield Company

Blow Out Preventer Program

Lease Name J. L. Keel "B"

Well No. 33

Location Sec 6-17S-31E
Eddy County, N M

BOP to be tested when installed on well and will be maintained in good working condition during drilling. All wellhead fittings to be of sufficient pressure to operate in a safe manner.

To supplement USGS Form 3160-3 " Application for Permit to Drill, Deepen or Plugback", the following additional information is submitted to comply with USGS Order NTL-6.

Operator: ARCO Oil and Gas Company - Division of Atlantic Richfield Company

Lease & Well No: J. L. Keel "B" #33

Location: Unit Letter A

Section 6-T17S-31E,

Eddy County, New Mexico

Lease, New Mexico LC-029435-B

Development well X Exploratory well

1. See Well Location and Acreage Dedication Plat Form C-102.
2. See Form 3160-3 for elevation above sea level of unprepared location.
3. The geologic name of the surface formation is: Permian Artesian Group
4. The type of drilling tools and associated equipment to be utilized will be: Rotary
5. The proposed drilling depth will be 3550' .
6. The estimated tops of important geologic markers are:

Top of Salt	500'	Seven Rivers	1800'	San Andres	3150'
Base of Salt	1400'	Queen	2400'		
Yates	1500'	Grayburg	2850'		
7. The estimated depths at which anticipated water, oil, gas or other mineral bearing formations are expected to be encountered are:

Fresh water	(Ground Basin)	250'
Queen		2450'
Oil & Gas	Grayburg	2850'
Oil & Gas	San Andres	3150'
8. The proposed casing program including the size, grade and weight-per-foot of each string has been indicated on Form 3160-3. All strings of casing will be: New X Used .
9. See Form 3160-3 for amount of cement.

CHAVIS COUNTY

R27E EDDY COUNTY R28E

R28E R29E

- ☒ Paved Highway
- ☐ Existing Area
- ☒ Proposed New
- ☒ Proposed Dr1

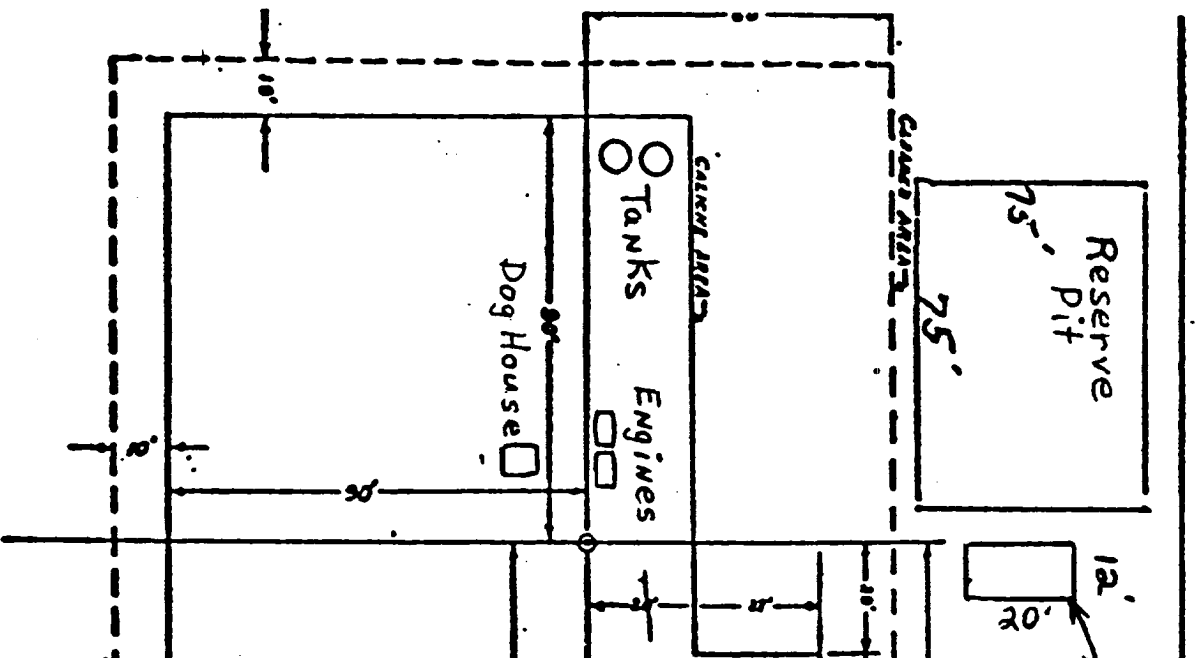

Exhibit "D"

RIG LAYOUT

ARCO Oil and Gas Company - Division of Atlantic Richfield

J. L. Keel "B" #33

860' FNL & 860' FEL Section 6-17S-31E

Eddy County, New Mexico