

STATE OF NEW MEXICO  
ENERGY AND MINERALS DEPARTMENT

NO. OF COPIES RECEIVED	
DISTRIBUTION	
SANTA FE	<input checked="" type="checkbox"/>
FILE	<input checked="" type="checkbox"/>
U.S.G.S.	<input checked="" type="checkbox"/>
LAND OFFICE	<input checked="" type="checkbox"/>
OPERATOR	<input checked="" type="checkbox"/>

OIL CONSERVATION DIVISION  
RECEIVED BY  
NOV 4 1985  
SANTA FE, NEW MEXICO 87501  
O. C. D.  
ARTESIA, OFFICE

Form C-101 30-015-25458  
Revised 10-1-78

5A. Indicate Type of Lease  
STATE ☒ FEE ☐  
5. State Oil & Gas Lease No.  
B-514

APPLICATION FOR PERMIT TO DRILL, DEEPEN, OR PLUG BACK

1a. Type of Work DRILL <input checked="" type="checkbox"/> DEEPEN <input type="checkbox"/> PLUG BACK <input type="checkbox"/>				7. Unit Agreement Name	
b. Type of Well OIL WELL <input checked="" type="checkbox"/> GAS WELL <input type="checkbox"/> OTHER <input type="checkbox"/> SINGLE ZONE <input checked="" type="checkbox"/> MULTIPLE ZONE <input type="checkbox"/>				8. Name or Lease Name G-J West Coop Unit	
2. Name of Operator Marbob Energy Corporation				9. Well No. 77	
3. Address of Operator P.O. Drawer 217, Artesia, N.M. 88210				10. Field and Pool, or Wildcat Grbg Jackson SR Q G SA	
4. Location of Well UNIT LETTER <u>O</u> LOCATED <u>330</u> FEET FROM THE <u>South</u> LINE AND <u>2310</u> FEET FROM THE <u>East</u> LINE OF SEC. <u>28</u> TWP. <u>17S</u> RGE. <u>29E</u> NMPM				12. County Eddy	
19. Proposed Depth 5000'		19A. Formation San Andres		20. Rotary or C.T. Rotary	
21. Elevations (Show whether DP, RT, etc.) 3561' GR		21A. Kind & Status Plug. Bond Statewide active		22. Approx. Date Work will start 11/8/85	

23.

PROPOSED CASING AND CEMENT PROGRAM

SIZE OF HOLE	SIZE OF CASING	WEIGHT PER FOOT	SETTING DEPTH	SACKS OF CEMENT	EST. TOF
12 1/4"	8 5/8"	24#	350'	Sufficient to circulate	
7 7/8"	5 1/2"	15.50#	5000'	650 sax, to base of salt	

We propose to drill to 350', run 8 5/8" casing and cement; drill on to test the San Andres zone; run 5 1/2" casing, cement and put on production.

APPROVAL VALID FOR 180 DAYS  
PERMIT EXPIRES 5-5-86  
UNLESS DRILLING UNDERWAY

IN ABOVE SPACE DESCRIBE PROPOSED PROGRAM; IF PROPOSAL IS TO DEEPEN OR PLUG BACK, GIVE DATA ON PRESENT PRODUCTIVE ZONE AND PROPOSED NEW PRODUCTIVE ZONE. GIVE BLOWOUT PREVENTER PROGRAM, IF ANY.

I hereby certify that the information above is true and complete to the best of my knowledge and belief.

Signed Carey J. Insella Title Production Clerk Date 11/4/85

(This space for State Use)

Original Signed By  
Mike Williams  
Oil & Gas Inspector

NOV 5 1985

APPROVED BY \_\_\_\_\_ DATE \_\_\_\_\_

CONDITIONS OF APPROVAL, IF ANY:



I MEXICO OIL CONSERVATION COMMISS'  
WELL LOCATION AND ACREAGE DEDICATION PLAT

Form C-102  
Supersedes C-128  
Effective 1-1-65

All distances must be from the outer boundaries of the Section

Operator <b>MARBOB ENERGY CORP.</b>		Lease <b>G. J. WEST COOP UNIT</b>		Well No. <b>77</b>
Unit Letter <b>0</b>	Section <b>28</b>	Township <b>17 SOUTH</b>	Range <b>29 EAST</b>	County <b>EDDY</b>
Actual Footage Location of Well: <b>330</b> feet from the <b>SOUTH</b> line and <b>2310</b> feet from the <b>EAST</b> line				
Ground Level Elev. <b>3561.0'</b>	Producing Formation <b>San Andres</b>		Pool <b>Grbg Jackson SR Qn Grbg SA</b>	Dedicated Acreage: <b>40</b> Acres

1. Outline the acreage dedicated to the subject well by colored pencil or hachure marks on the plat below.
2. If more than one lease is dedicated to the well, outline each and identify the ownership thereof (both as to working interest and royalty).
3. If more than one lease of different ownership is dedicated to the well, have the interests of all owners been consolidated by communitization, unitization, force-pooling, etc?

☐ Yes ☐ No If answer is "yes," type of consolidation \_\_\_\_\_

If answer is "no," list the owners and tract descriptions which have actually been consolidated. (Use reverse side of this form if necessary.) \_\_\_\_\_

No allowable will be assigned to the well until all interests have been consolidated (by communitization, unitization, forced-pooling, or otherwise) or until a non-standard unit, eliminating such interests, has been approved by the Commission.

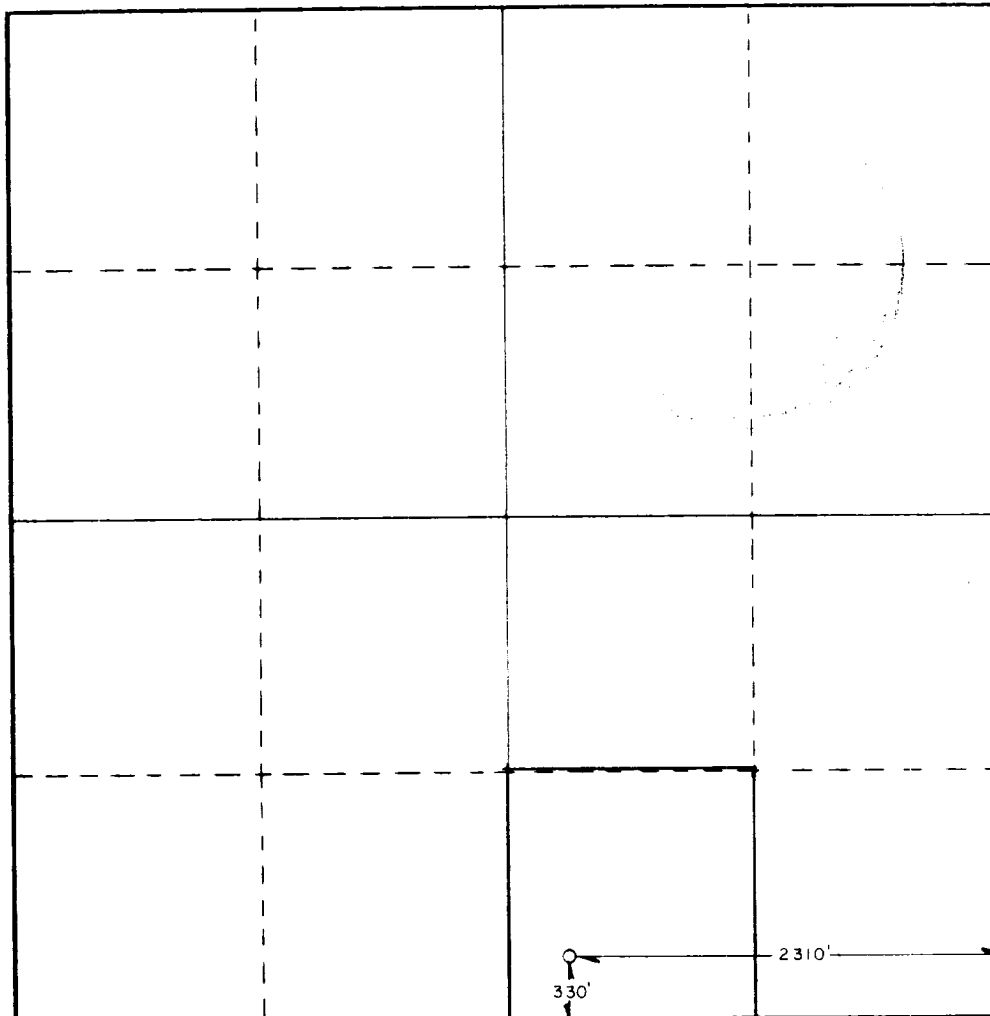

**CERTIFICATION**

I hereby certify that the information contained herein is true and complete to the best of my knowledge and belief.

*Carolyn Purcella*

Name

**Carolyn Purcella**

Position

**Production Clerk**

Company

**Marbob Energy Corporation**

Date

**11/4/85**

I hereby certify that the well location shown on this plat was plotted from field notes of actual surveys made by me or under my supervision, and that the same is true and correct to the best of my knowledge and belief.

Date Surveyed

**OCTOBER 28, 1985**

Registered Professional Engineer  
and/or Land Surveyor

*John W. West*

Certificate No. **JOHN W. WEST,**

**676**

**RONALD J. EIDSON,**

**3239**