

UNITED STATES  
DEPARTMENT OF THE INTERIOR  
GEOLOGICAL SURVEY

SUBMIT TRIPLICATE\*  
(Other instructions on  
reverse side)

Form approved.  
Budget Bureau No. 42-R1425.

30-015-25517

APPLICATION FOR PERMIT TO DRILL, DEEPEN, OR PLUG BACK

1a. TYPE OF WORK  
DRILL ☒ DEEPEN ☐ PLUG BACK ☐

b. TYPE OF WELL  
OIL WELL ☒ GAS WELL ☐ OTHER ☐ SINGLE ZONE ☒ MULTIPLE ZONE ☐

2. NAME OF OPERATOR  
Marbob Energy Corporation

3. ADDRESS OF OPERATOR  
P.O. Drawer 217, Artesia, NM 88210

4. LOCATION OF WELL (Report location clearly and in accordance with any State requirements.)  
At surface 990 FEL 330 FSL  
At proposed prod. zone Same

14. DISTANCE IN MILES AND DIRECTION FROM NEAREST TOWN OR POST OFFICE\*  
20 air miles east of Artesia, NM 88210

15. DISTANCE FROM PROPOSED\* LOCATION TO NEAREST PROPERTY OR LEASE LINE, FT. (Also to nearest drig. unit line, if any)  
330'

16. NO. OF ACRES IN LEASE  
600

17. NO. OF ACRES ASSIGNED TO THIS WELL  
40

18. DISTANCE FROM PROPOSED LOCATION\* TO NEAREST WELL, DRILLING, COMPLETED, OR APPLIED FOR, ON THIS LEASE, FT.  
467'

19. PROPOSED DEPTH  
4500'

20. ROTARY OR CABLE TOOLS  
Rotary

21. ELEVATIONS (Show whether DF, RT, GR, etc.)  
3568.6' GR

22. APPROX. DATE WORK WILL START\*  
12/16/85

5. LEASE DESIGNATION AND SERIAL NO.  
LC-028731(A)

6. IF INDIAN, ALLOTTEE OR TRIBE NAME

7. UNIT AGREEMENT NAME

8. FARM OR LEASE NAME  
M. Dodd "A"

9. WELL NO.  
#40

10. FIELD AND POOL, OR WILDCAT  
Grbg Jackson SR Q Gb SA

11. SEC., T., R., M., OR BLK. AND SURVEY OR AREA  
Sec. 22-T17S-R29E

12. COUNTY OR PARISH  
Eddy

13. STATE  
NM

23. PROPOSED CASING AND CEMENTING PROGRAM

SIZE OF HOLE	SIZE OF CASING	WEIGHT PER FOOT	SETTING DEPTH	QUANTITY OF CEMENT
12 1/4"	8 5/8"	24.0#	350' salt	Sufficient to circulate
7 7/8"	5 1/2"	15.5#	4500'	1500 sax, to base of salt

Pay zone will be selectively perforated and stimulated as needed for optimum production.

Attached are: 1. Location & acreage dedication plat  
2. Supplemental drilling data  
3. Surface use plan

Revised 12/16/85  
12/16/85

IN ABOVE SPACE DESCRIBE PROPOSED PROGRAM: If proposal is to deepen or plug back, give data on present productive zone and proposed new productive zone. If proposal is to drill or deepen directionally, give pertinent data on subsurface locations and measured and true vertical depths. Give blowout preventer program, if any.

24. SIGNED [Signature] TITLE Production Clerk DATE 12/3/85

(This space for Federal or State office use)

PERMIT NO. [Signature] APPROVAL DATE 12-16-85  
APPROVED BY [Signature] TITLE [Signature] DATE 12-16-85

CONDITIONS OF APPROVAL, IF ANY:

APPROVAL SUBJECT TO  
GENERAL REQUIREMENTS AND  
SPECIAL STIPULATIONS

\*See Instructions On Reverse Side

**TW MEXICO OIL CONSERVATION COMMISSION  
WELL LOCATION AND ACREAGE DEDICATION PLAT**

Form O-112  
Supersedes O-128  
Effective 1-1-65

All distances must be from the outer boundaries of the Section

Oil Field: <u>GRBG JACKSON</u>			Section: <u>14</u>		
County: <u>San Andres</u>	Township: <u>10N</u>	Range: <u>10E</u>	Section: <u>14</u>	Acres: <u>40</u>	
Well Name: <u>Grbg Jackson SR Q Gb SA</u>					
Estimated Acreage: <u>40</u>					

- 1 Outline the acreage dedicated to the subject well by colored pencil or hatchure marks on the plat below.
- 2 If more than one lease is dedicated to the well, outline each and identify the ownership thereof both as to working interest and royalty.
- 3 If more than one lease of different ownership is dedicated to the well, have the interests of all owners been consolidated by communitization, unitization, force-pooling, etc?

Yes ☐ No ☐ If answer is "yes" type of consolidation \_\_\_\_\_

If answer is "no" list the owners and tract descriptions which have actually been consolidated. Use reverse side of this form if necessary. \_\_\_\_\_

No allowable will be assigned to the well until all interests have been consolidated by communitization, unitization, force-pooling, or otherwise or until a non-standard unit, eliminating such interests, has been approved by the Commission.

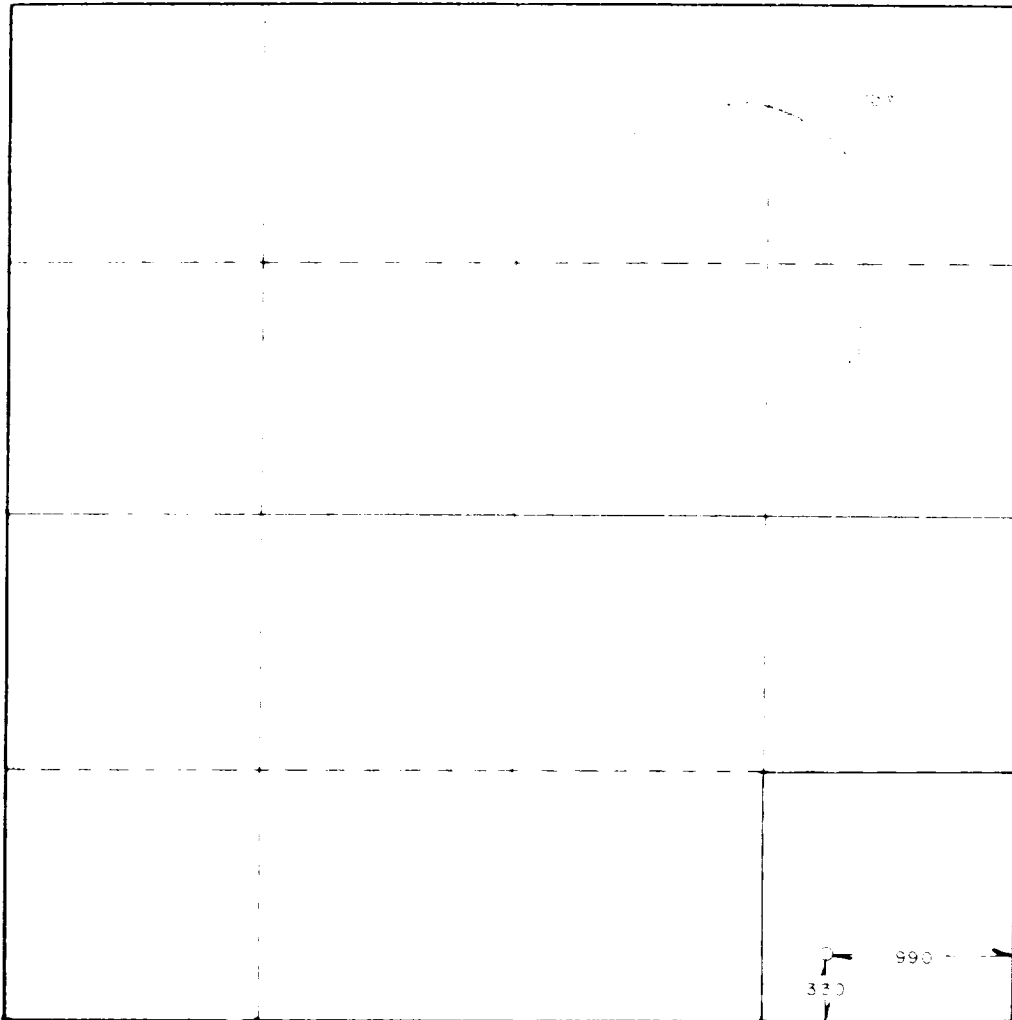

**CERTIFICATION**

I hereby certify that the information contained herein is true and complete to the best of my knowledge and belief.

DeNette Morriss

DeNette Morriss

Production Clerk

Marbob Energy Clerk

12/3/85

I hereby certify that the well location shown on this plat was plotted from field notes of actual surveys made by me or under my supervision and that the same is true and correct to the best of my knowledge and belief.

John W. West

Registered Professional Engineer  
and Land Surveyor

John W. West

Certificate No. JOHN W. WEST, 676  
RONALD J. EIDSON, 3239

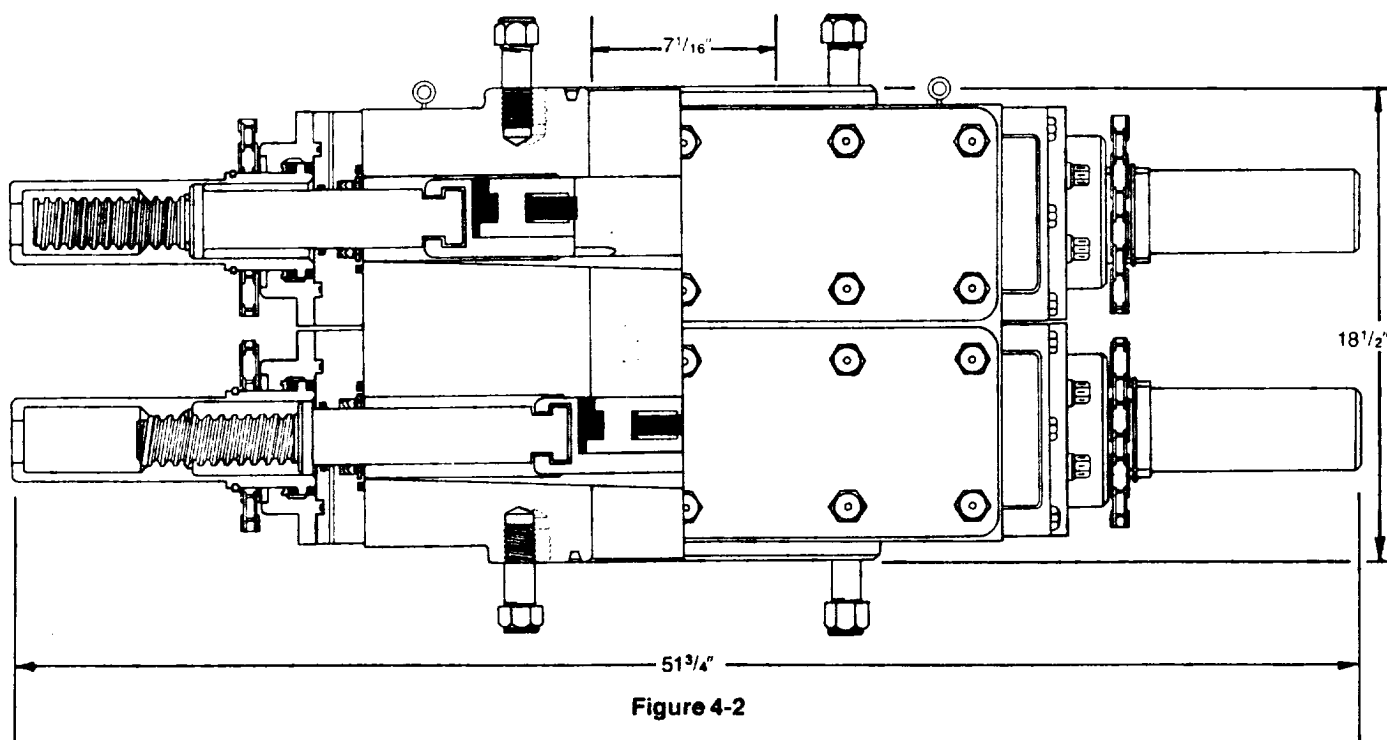

## DIMENSIONS AND WEIGHTS

		Manual
Weight	Single (pounds)	1,272
	Double (pounds)	2,335
Overall height, less studs	Single (inches)	10
	Double (inches)	18 1/2
Overall length (inches)		51 3/4
Overall width, less handwheel (inches)		20 1/4
Opening through preventer (inches)		7 1/16
Working pressure (psi)		3,000
Test pressure (psi)		6,000
Handwheel diameter (inches)		20
Ring joint gasket API number		R-45

SUP Exhibit "E"  
 Blowout Preventer  
 Marbob Energy Corporation  
 M. Dodd "A" Fed. #40  
 SE1/4SE1/4 Sec. 22-17S-29E

SUPPLEMENTAL DRILLING DATA

MARBOB ENERGY CORPORATION  
WELL #40 M. DODD "A" FEDERAL  
SE1/4SE1/4 SEC. 22-17S-29E  
EDDY COUNTY, NEW MEXICO  
(DEVELOPMENT WELL)

1. SURFACE FORMATION: Quaternary.

2. ESTIMATED TOPS OF GEOLOGIC MARKERS:

Salt	360'	Queen	1815'
Base Salt	780'	Grayburg	2140'
Yates	930'	San Andres	2510'
Seven Rivers	1145'	Glorietta	3900'

3. ANTICIPATED POROSITY ZONES:

Water	Above 180'
Oil	2350 - 4500'

4. CASING DESIGN:

SIZE	INTERVAL	WEIGHT	GRADE	JOINT	CONDITION
8 5/8"	0-350'	24.0#	K-55	STC	New
5 1/2"	0-4500'	15.5#	K-55	STC	New

5. SURFACE CONTROL EQUIPMENT: An annular BOP will be used. (See diagram attached as Exhibit "E")

6. CIRCULATING MEDIUM:

0 - 350' Fresh water mud with gel or lime as needed for viscosity control.

350'- 4500' Salt water mud, conditioned as necessary for control of viscosity and water loss or gain.

7. AUXILIARY EQUIPMENT: Drill string safety valve.

8. LOGGING PROGRAM: CNL-FDC W/GR Log will be run to TD.

9. ABNORMAL PRESSURES, TEMPERATURES OR GASES: A water flow may be encountered in the salt section.

10. ANTICIPATED STARTING DATE: It is planned that operations will commence about December 16, 1985. Duration of drilling, testing and completion operations should be one to four weeks.



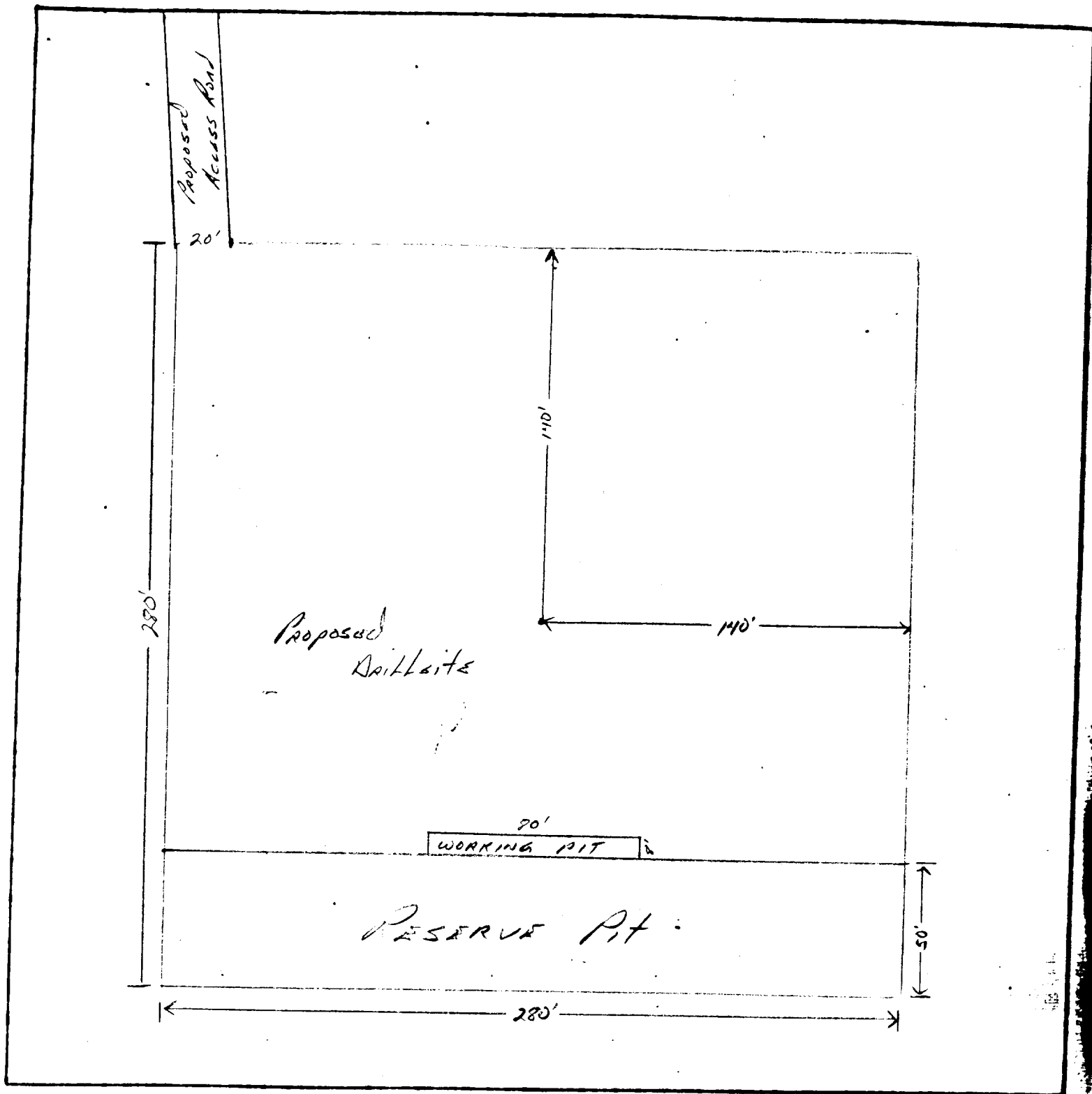

LEGEND

1cm = 20 ft.

**SUP Exhibit "D"**

**SKETCH OF PROPOSED WELL PAD**  
 Marbob Energy Corporation  
 M. Dodd "A" Fed. Well #40  
 SE1/4SE1/4, Sec. 22-17S-29E