

30-015-25679

UNITED STATES DEPARTMENT OF THE INTERIOR
GEOLOGICAL SURVEY

APPLICATION FOR PERMIT TO DRILL, DEEPEN, OR PLUG BACK

1a. TYPE OF WORK
DRILL ☒ DEEPEN ☐ PLUG BACK ☐

b. TYPE OF WELL
OIL WELL ☒ GAS WELL ☐ OTHER ☐

2. NAME OF OPERATOR
Marbob Energy Corporation

3. ADDRESS OF OPERATOR
P.O. Drawer 217, Artesia, NM 88210

4. LOCATION OF WELL (Report location clearly and in accordance with any State requirements.)
At surface 1650 FSL 2190 FEL
At proposed prod. zone
Same

14. DISTANCE IN MILES AND DIRECTION FROM NEAREST TOWN OR POST OFFICE*
20 air miles east of Artesia, N.M. 88210

15. DISTANCE FROM PROPOSED LOCATION*
LOCATION TO NEAREST PROPERTY OR LEASE LINE, FT. 1650'
(Also to nearest drilg. unit line, if any)

16. NO. OF ACRES IN LEASE
600

17. NO. OF ACRES ASSIGNED TO THIS WELL
40

18. DISTANCE FROM PROPOSED LOCATION*
TO NEAREST WELL, DRILLING, COMPLETED, OR APPLIED FOR, ON THIS LEASE, FT. 500'

19. PROPOSED DEPTH
5000'

20. ROTARY OR CABLE TOOLS
Rotary

21. ELEVATIONS (Show whether DF, RT, GR, etc.)
3548.0 GR

22. APPROX. DATE WORK WILL START*
11/3/86

5. LEASE DESIGNATION AND SERIAL NO.
LC-028731(A)

6. IF INDIAN, ALLOTTEE OR TRIBE NAME

7. UNIT AGREEMENT NAME

8. FARM OR LEASE NAME
M. Dodd "A"

9. WELL NO.
42

10. FIELD AND POOL, OR WILDCAT

11. SEC., T., R., M., OR BLK. AND SURVEY OR AREA
Grbg Jackson SR Q Gb SA

12. COUNTY OR PARISH
Eddy

13. STATE
NM

23. PROPOSED CASING AND CEMENTING PROGRAM				
SIZE OF HOLE	SIZE OF CASING	WEIGHT PER FOOT	SETTING DEPTH	QUANTITY OF CEMENT
12 1/4"	8 5/8"	24.0#	350'	Sufficient to circulate
7 7/8"	5 1/2"	15.5#	5000'	1500 sax, to base of salt

Pay zone will be selectively perforated and stimulated as needed for optimum production.

Attached are: 1. Location & acreage dedication plat
2. Supplemental drilling data
3. Surface use plan

IN ABOVE SPACE DESCRIBE PROPOSED PROGRAM: If proposal is to deepen or plug back, give data on present productive zone and proposed new productive zone. If proposal is to drill or deepen directionally, give pertinent data on subsurface locations and measured and true vertical depths. Give blowout preventer program, if any.

24. SIGNED [Signature] TITLE Production Clerk DATE 10/24/86

(This space for Federal or State office use)

PERMIT NO. _____ APPROVAL DATE _____

APPROVED BY _____ TITLE _____ DATE 11-17-86

CONDITIONS OF APPROVAL, IF ANY:

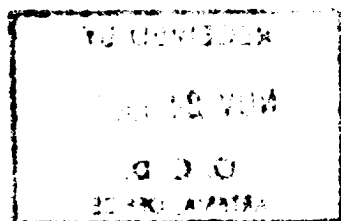

**N. MEXICO OIL CONSERVATION COMMISSION
WELL LOCATION AND ACREAGE DEDICATION PLAT**

Form C-102
Supersedes C-128
Effective 1-1-65

All distances must be from the outer boundaries of the Section

Operator Marbob Energy Corporation ✓			Lease M. Dodd "A"		Well No. 42
Unit Letter J	Section 22	Township 17 South	Range 29 East	County Eddy	
Actual Footage Location of Well: 2190 feet from the East line and 1650 feet from the South line					
Ground Level Elev. 3548.0	Producing Formation San Andres	Pool Grbg Jackson Sr On Grbg SA		Dedicated Acreage: 40 Acres	

1. Outline the acreage dedicated to the subject well by colored pencil or hachure marks on the plat below.
2. If more than one lease is dedicated to the well, outline each and identify the ownership thereof (both as to working interest and royalty).
3. If more than one lease of different ownership is dedicated to the well, have the interests of all owners been consolidated by communitization, unitization, force-pooling, etc?

☐ Yes ☐ No If answer is "yes," type of consolidation _____

If answer is "no," list the owners and tract descriptions which have actually been consolidated. (Use reverse side of this form if necessary.) _____

No allowable will be assigned to the well until all interests have been consolidated (by communitization, unitization, forced-pooling, or otherwise) or until a non-standard unit, eliminating such interests, has been approved by the Commission.

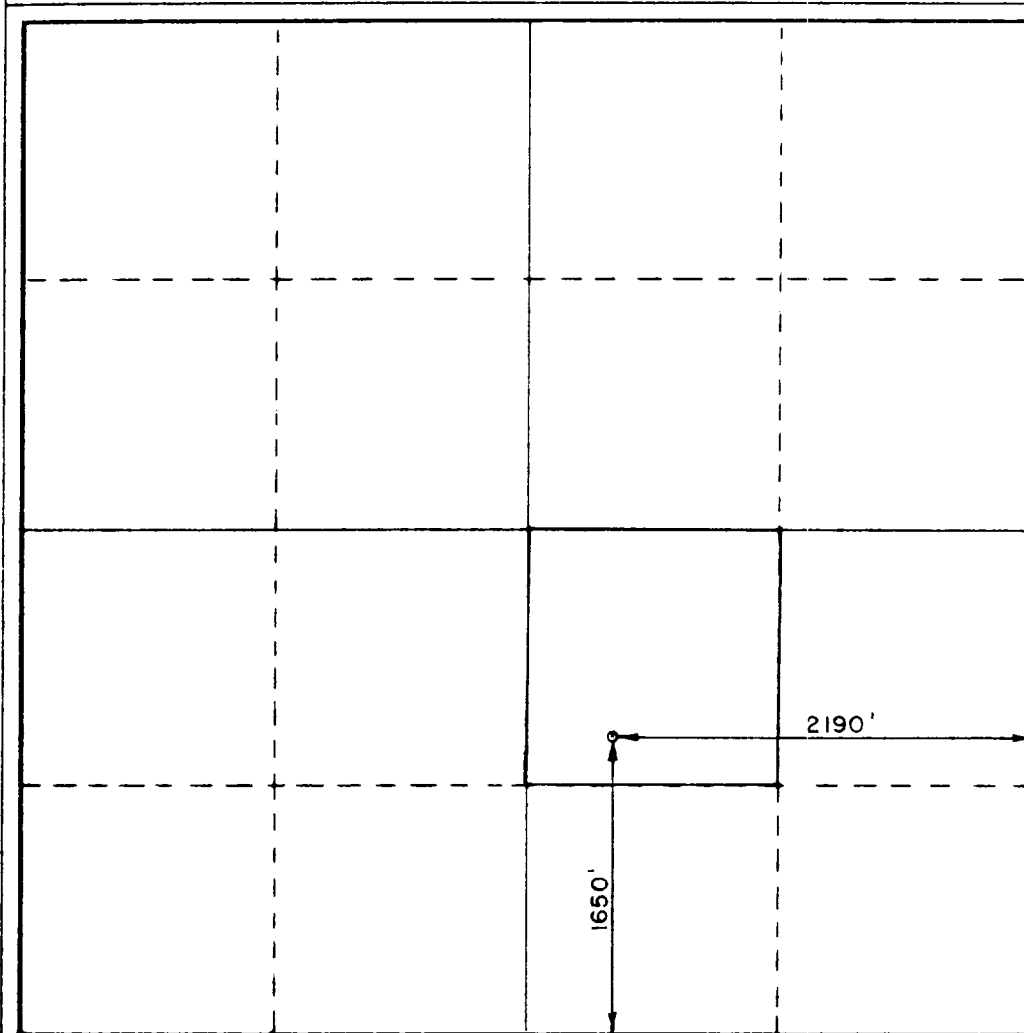

CERTIFICATION

I hereby certify that the information contained herein is true and complete to the best of my knowledge and belief.

DeNette Wallace

Name

DeNette Wallace

Position

Production Clerk

Company

Marbob Energy Corporation

Date

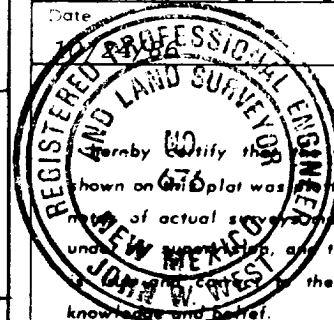

I hereby certify that the well location shown on this plat was determined from field notes of actual survey made by me or under my supervision, and that the same are true to the best of my knowledge and belief.

Date Surveyed

September 15, 1986

Registered Professional Engineer
and/or Land Surveyor

John W. West

Certificate No. **JOHN W. WEST,** 676

RONALD J. EIDSON, 3239

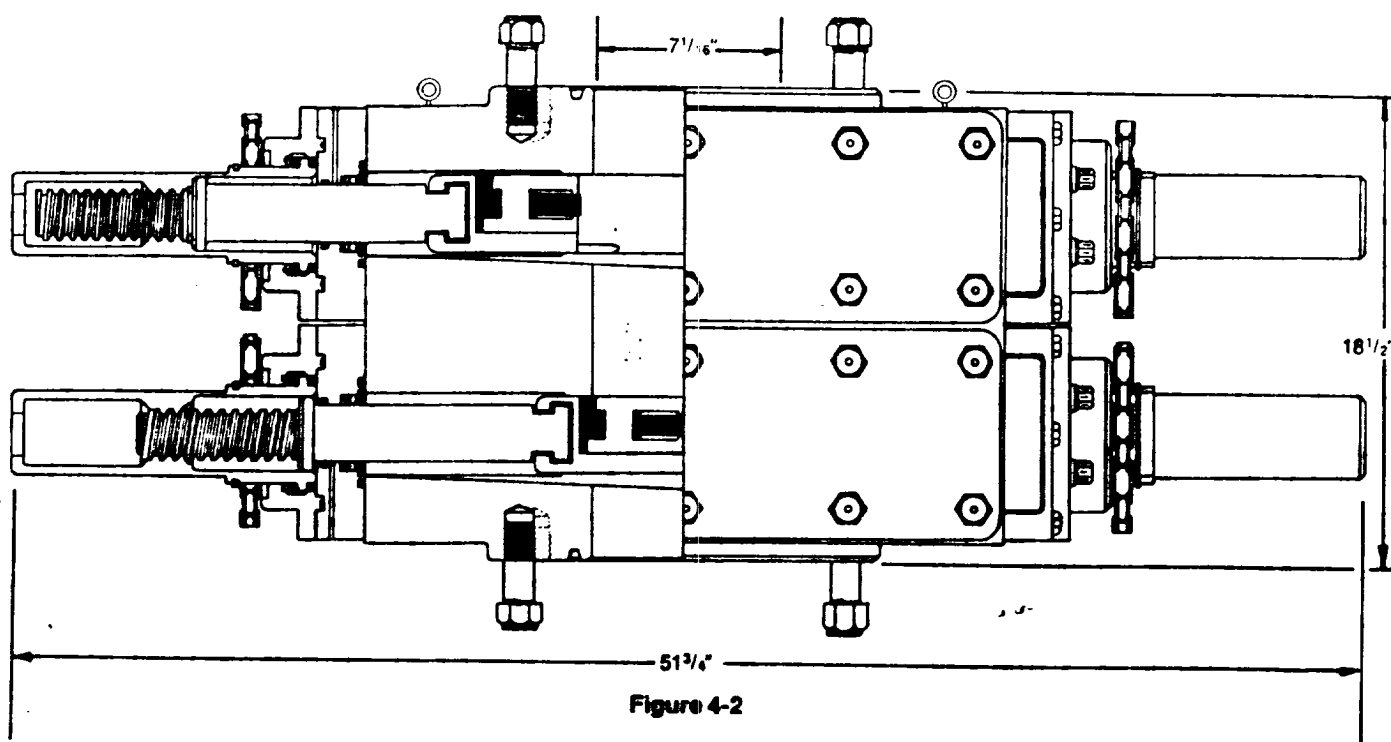

DIMENSIONS AND WEIGHTS

		Manual
Weight	Single (pounds)	1,272
	Double (pounds)	2,335
Overall height, less studs	Single (inches)	10
	Double (inches)	18 1/2
Overall length (inches)		51 3/4
Overall width, less handwheel (inches)		20 1/4
Opening through preventer (inches)		7 1/16
Working pressure (psi)		3,000
Test pressure (psi)		6,000
Handwheel diameter (inches)		20
Ring joint gasket API number		R-45

SUP Exhibit "E"
 Blowout Preventer
 Marbob Energy Corporation
 M. Dodd "A" Fed. Well #42
 NW1/4SE1/4 Sec. 22-17S-20E

SUPPLEMENTAL DRILLING DATA

MARBOB ENERGY CORPORATION
WELL #42 M. DODD "A" FEDERAL
NW1/4SE1/4 SEC. 22-17S-29E
EDDY COUNTY, NEW MEXICO
(DEVELOPMENT WELL)

1. SURFACE FORMATION: Quaternary.

2. ESTIMATED TOPS OF GEOLOGIC MARKERS:

Salt	360'	Queen	1815'
Base Salt	780'	Grayburg	2140'
Yates	930'	San Andres	2510'
Seven Rivers	1145'	Glorietta	3900'

3. ANTICIPATED POROSITY ZONES:

Water	Above 180'
Oil	2350 - 5,000'

4. CASING DESIGN:

SIZE	INTERVAL	WEIGHT	GRADE	JOINT	CONDITION
8 5/8"	0-350'	24.0#	K-55	STC	New
5 1/2"	0-5,000'	15.5#	K-55	STC	New

5. SURFACE CONTROL EQUIPMENT: A double ram-type or annular BOP will be used. (See diagram attached as Exhibit "E")

6. CIRCULATING MEDIUM:

0 - 350'	Fresh water mud with gel or lime as needed for viscosity control.
350'-5,000'	Salt water mud, conditioned as necessary for control of viscosity and water loss or gain.

7. AUXILIARY EQUIPMENT: Drill string safety valve.

8. LOGGING PROGRAM: CNL-FDC W/GR Log will be run to TD.

9. ABNORMAL PRESSURES, TEMPERATURES OR GASES: A water flow may be encountered in the salt section.

10. ANTICIPATED STARTING DATE: It is planned that operations will commence about November 3, 1986. Duration of drilling, testing and completion operations should be one to four weeks.

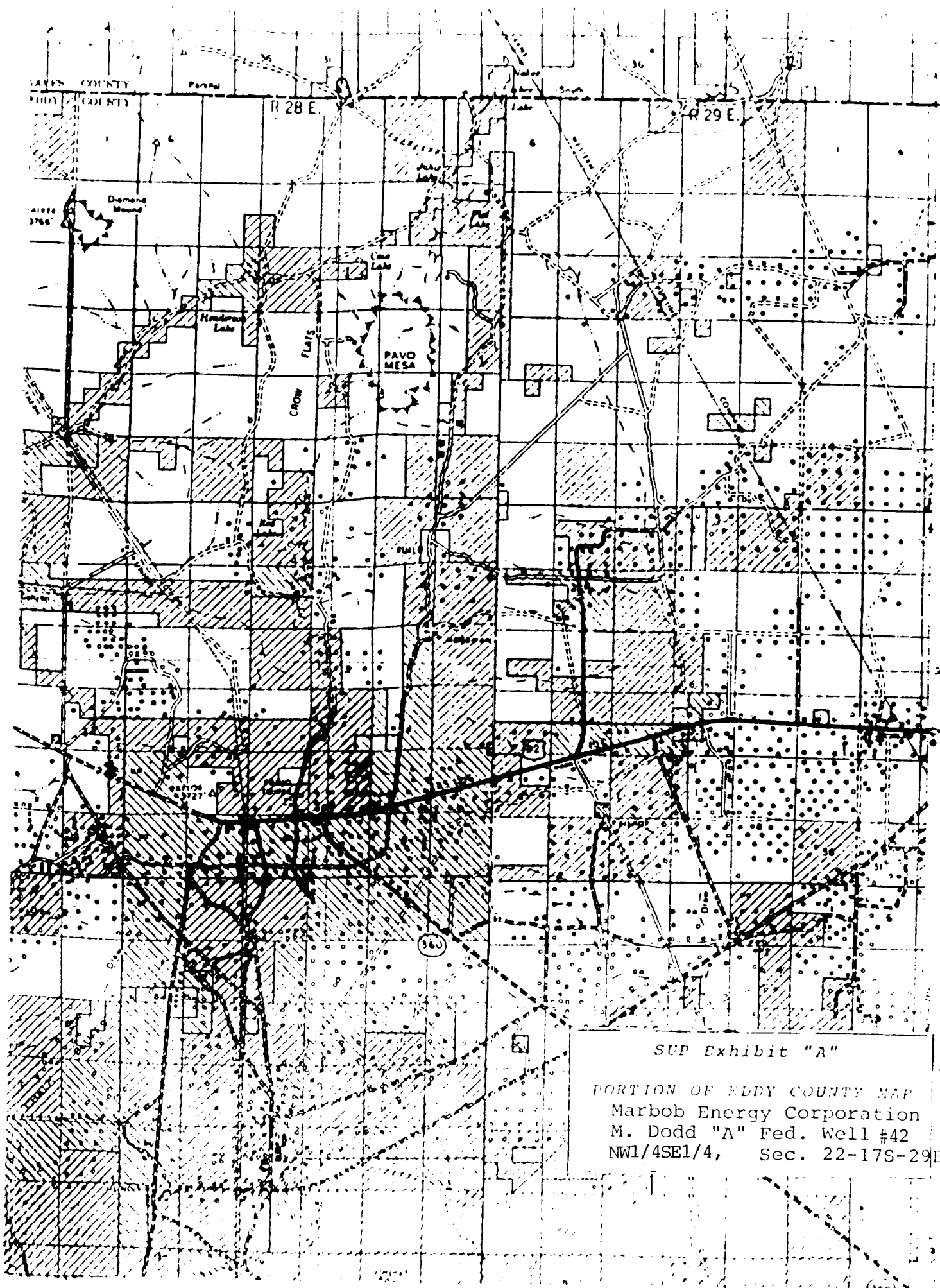

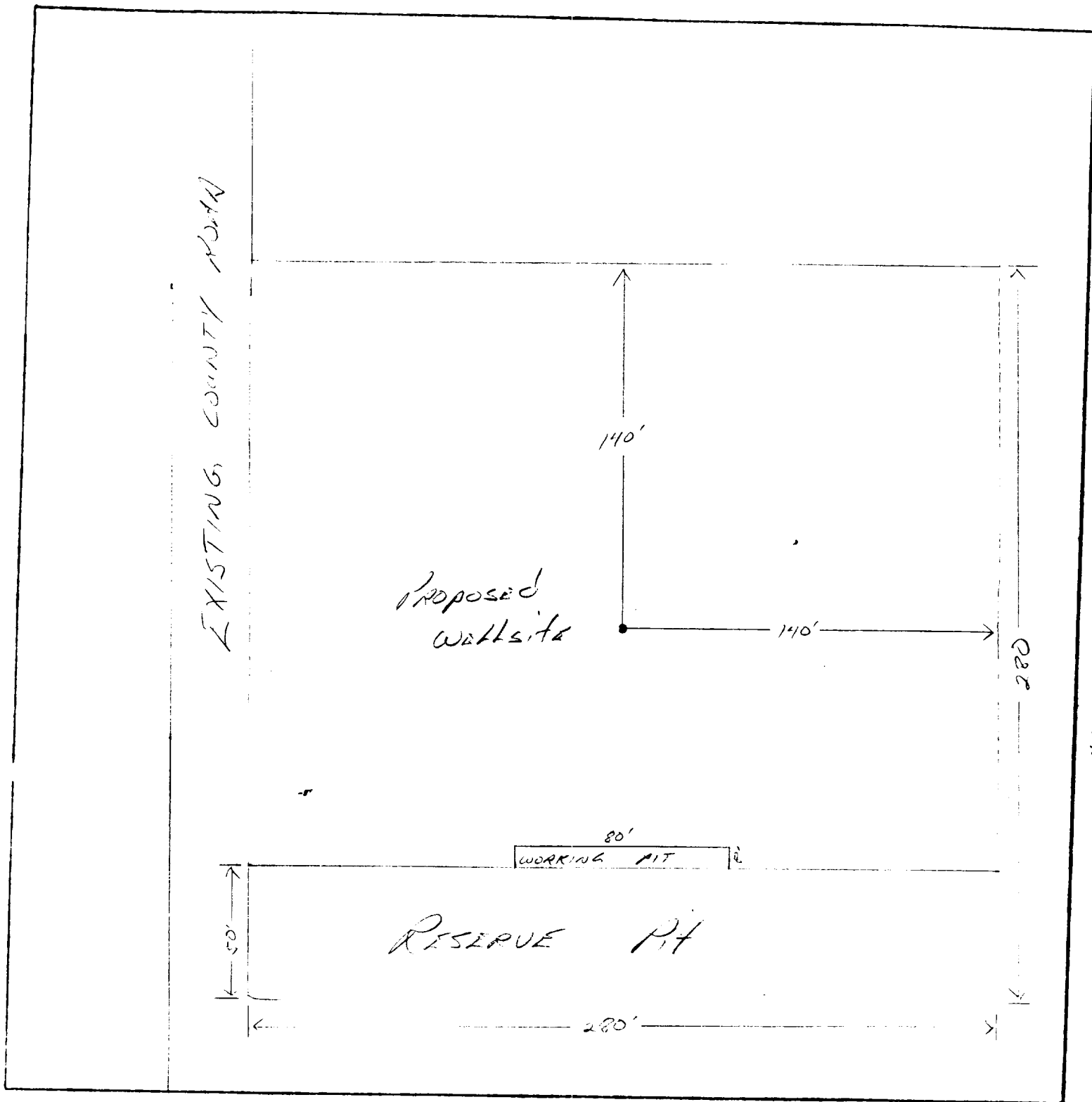

LEGEND

1" = 20 ft.

SUP Exhibit "D"

SKETCH OF PROPOSED WELL PAD
 Marbob Energy Corporation
 M. Dodd "A" Federal Well #42
 NW1/4SE1/4, Sec. 22-17S-29E