

Submit to Appropriate
District Office
State Lease - 6 copies
Fee Lease - 5 copies

State of New Mexico
Energy, Minerals and Natural Resources Department

Form C-101
Revised 1-1-89

OIL CONSERVATION DIVISION

P.O. Box 2088
Santa Fe, New Mexico 87504-2088

DISTRICT I
P.O. Box 1980, Hobbs, NM 88240

DISTRICT II
P.O. Drawer DD, Artesia, NM 88210

DISTRICT III
1000 Rio Brazos Rd., Aztec, NM 87410

O. C. D.
ARTESIA OFFICE

API NO. (assigned by OCD on New Wells)

30-015-26103

5. Indicate Type of Lease

STATE ☒

FEE ☐

6. State Oil & Gas Lease No.
B-10714

7. Lease Name or Unit Agreement Name

G-J West Coop Unit

8. Well No.
89

9. Pool name or Wildcat
Grbg Jackson SR Q Grbg SA

APPLICATION FOR PERMIT TO DRILL, DEEPEN, OR PLUG BACK

1a. Type of Work:

DRILL ☒

RE-ENTER ☐

DEEPEN ☐

PLUG BACK ☐

b. Type of Well:

OIL
WELL ☒

GAS
WELL ☐

OTHER ☐

SINGLE
ZONE ☒

MULTIPLE
ZONE ☐

2. Name of Operator

Marbob Energy Corporation

3. Address of Operator

P. O. Drawer 217, Artesia, NM 88210

4. Well Location

Unit Letter E : 1345 Feet From The North Line and 25 Feet From The West Line

Section 22

Township 17S

Range 29E

NMPM

Eddu

County

10. Proposed Depth
5000'

11. Formation
San Andres

12. Rotary or C.T.
Rotary

13. Elevations (Show whether DF, RT, GR, etc.)
3556.0 GR

14. Kind & Status Plug. Bond
Statewide Active

15. Drilling Contractor
LaRue Drilling Co.

16. Approx. Date Work will start
4/20/89

17. PROPOSED CASING AND CEMENT PROGRAM

SIZE OF HOLE	SIZE OF CASING	WEIGHT PER FOOT	SETTING DEPTH	SACKS OF CEMENT	EST. TOP
12 1/4"	8 5/8"	24#	200'	Sufficient to circulate	
7 7/8"	5 1/2"	17#	5000'	650 sx. to base of salt	

We propose to drill to 200'; run and cement 8 5/8" casing, drill on to 5000' to test the San Andres zone, run and cement 5 1/2" casing and put on production.

Post ID-1
4-21-89
New loc + API

APPROVAL VALID FOR 180 DAYS
10/17/89
UNLESS DRILLING UNDERWAY

IN ABOVE SPACE DESCRIBE PROPOSED PROGRAM: IF PROPOSAL IS TO DEEPEN OR PLUG BACK, GIVE DATA ON PRESENT PRODUCTIVE ZONE AND PROPOSED NEW PRODUCTIVE ZONE. GIVE BLOWOUT PREVENTER PROGRAM, IF ANY.

I hereby certify that the information above is true and complete to the best of my knowledge and belief.

SIGNATURE

TITLE Production Clerk

DATE 4/6/89

TYPE OR PRINT NAME

Rhonda Nelson

TELEPHONE NO. 748-3303

(This space for State Use)

Original Signed By
Mike Williams

APPROVED BY

TITLE

DATE

APR 17 1989

CONDITIONS OF APPROVAL, IF ANY:

NSL-2646
4-7-89

Submit to Appropriate
District Office
State Lease - 4 copies
Fee Lease - 3 copies

State of New Mexico
Energy, Minerals and Natural Resources Department

Form C-102
Revised 1-1-89

OIL CONSERVATION DIVISION

P.O. Box 2088
Santa Fe, New Mexico 87504-2088

DISTRICT I

P.O. Box 1980, Hobbs, NM 88240

DISTRICT II

P.O. Drawer DD, Artesia, NM 88210

DISTRICT III

1000 Rio Brazos Rd., Aztec, NM 87410

WELL LOCATION AND ACREAGE DEDICATION PLAT

All Distances must be from the outer boundaries of the section

Operator Marbob Energy Corp.			Lease G J West COOP UT.		Well No. 89
Unit Letter E	Section 22	Township 17 South	Range 28 East	County Elizabet	
Actual Footage Location of Well: 1345 feet from the north line and 25 feet from the west line					
Ground level Elev. 5760	Producing Formation San Andres		Pool Grbg Jackson SR Q Grbg SA	Dedicated Acreage: 40 Acres	

1. Outline the acreage dedicated to the subject well by colored pencil or hatchure marks on the plat below.
2. If more than one lease is dedicated to the well, outline each and identify the ownership thereof (both as to working interest and royalty).
3. If more than one lease of different ownership is dedicated to the well, have the interest of all owners been consolidated by communitization, unitization, force-pooling, etc.?
☐ Yes ☐ No If answer is "yes" type of consolidation _____
If answer is "no" list the owners and tract descriptions which have actually been consolidated. (Use reverse side of this form if necessary). _____
No allowable will be assigned to the well until all interests have been consolidated (by communitization, unitization, forced-pooling, or otherwise) or until a non-standard unit, eliminating such interest, has been approved by the Division.

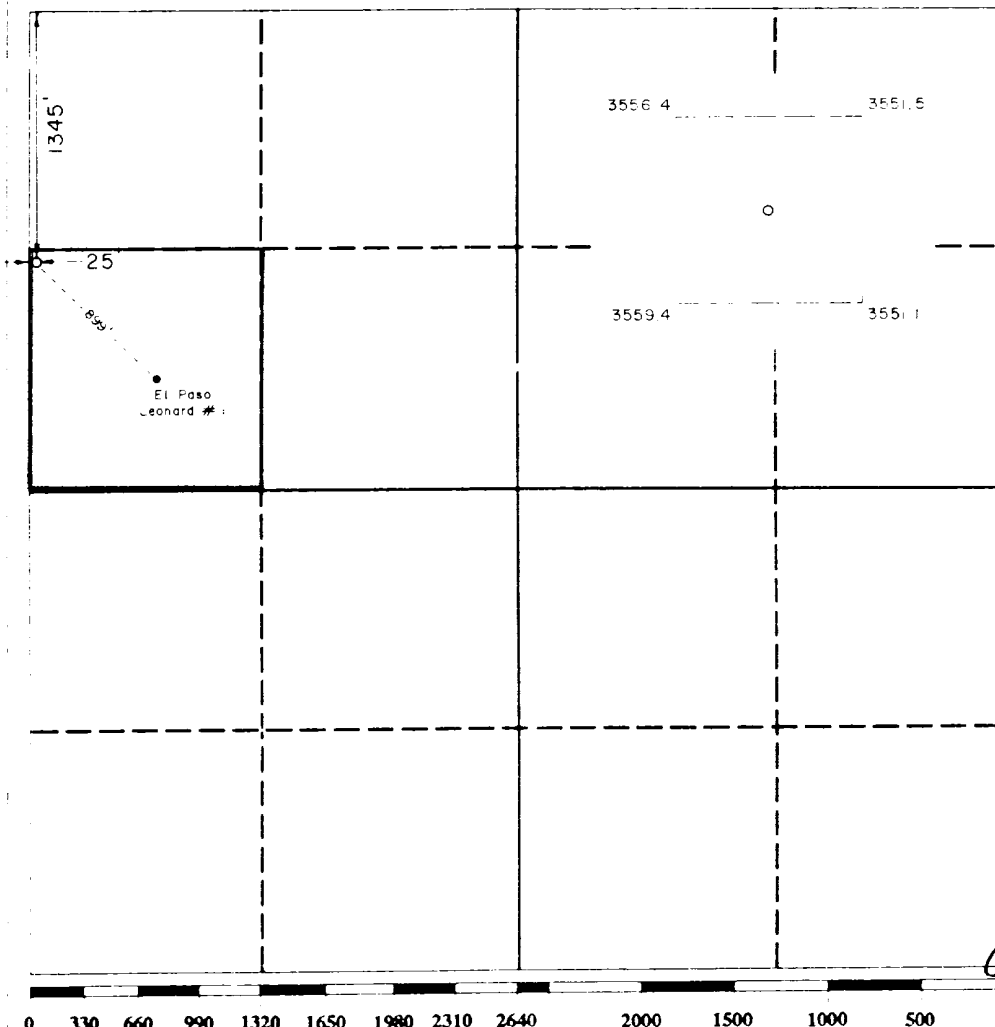

OPERATOR CERTIFICATION

I hereby certify that the information contained herein is true and complete to the best of my knowledge and belief.

Signature
Rhonda Nelson
Printed Name
Rhonda Nelson

Position
Production Clerk

Company
Marbob Energy Corporation

Date
March 30, 1989

SURVEYOR CERTIFICATION

I hereby certify that the well location shown on this plat was plotted from field notes of actual surveys made by me or under my supervision, and that the same is true and correct to the best of my knowledge and belief.

Date Surveyed
March 27, 1989

Signature & Seal of
Professional Surveyor

Professional Surveyor
Certificate No. 0766
JOHN W. WEST
NEW MEXICO
3239

30-015-26103

6-6-89
Lateralog microguard
2425-4427
Comp. spectral
Natural Gamma
3400-4427
Spectral density
dual spaced neutron
800-4427

NSA-2646
4-2-89