

Submit to Appropriate  
District Office  
Lease - 4 copies  
Lease - 3 copies

State of New Mexico  
Energy, Minerals and Natural Resources Department

Form C-102  
Revised 1-1-89

OIL CONSERVATION DIVISION

P.O. Box 2088  
Santa Fe, New Mexico 87504-2088

STRICT I  
J. Box 1980, Hobbs, NM 88240

STRICT II  
J. Drawer DD, Artesia, NM 88210

STRICT III  
J. Rio Brazos Rd., Aztec, NM 87410

WELL LOCATION AND ACREAGE DEDICATION PLAT

All Distances must be from the outer boundaries of the section

Operator Hondo Oil & Gas Company			Lease H.E. West "B"		Well No. 48
Well Letter J	Section 10	Township 17 South	Range 31 East	County NMNM	Eddy
Actual Footage Location of Well: 2130 feet from the South line and 1980 feet from the East line					
Ground level Elev. 3902	Producing Formation Grayburg		Pool Grayburg Jackson		Dedicated Acreage: 40 Acres

1. Outline the acreage dedicated to the subject well by colored pencil or hatchure marks on the plat below.

2. If more than one lease is dedicated to the well, outline each and identify the ownership thereof (both as to working interest and royalty).

3. If more than one lease of different ownership is dedicated to the well, have the interest of all owners been consolidated by communitization, unitization, force-pooling, etc.?

☐ Yes ☒ No If answer is "yes" type of consolidation \_\_\_\_\_

If answer is "no" list the owners and tract descriptions which have actually been consolidated. (Use reverse side of this form if necessary.)

No allowable will be assigned to the well until all interests have been consolidated (by communitization, unitization, forced-pooling, or otherwise) or until a non-standard unit, eliminating such interest, has been approved by the Division.

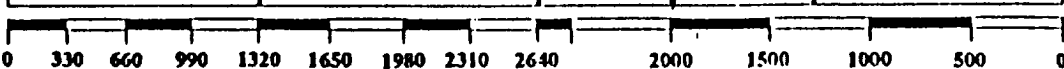
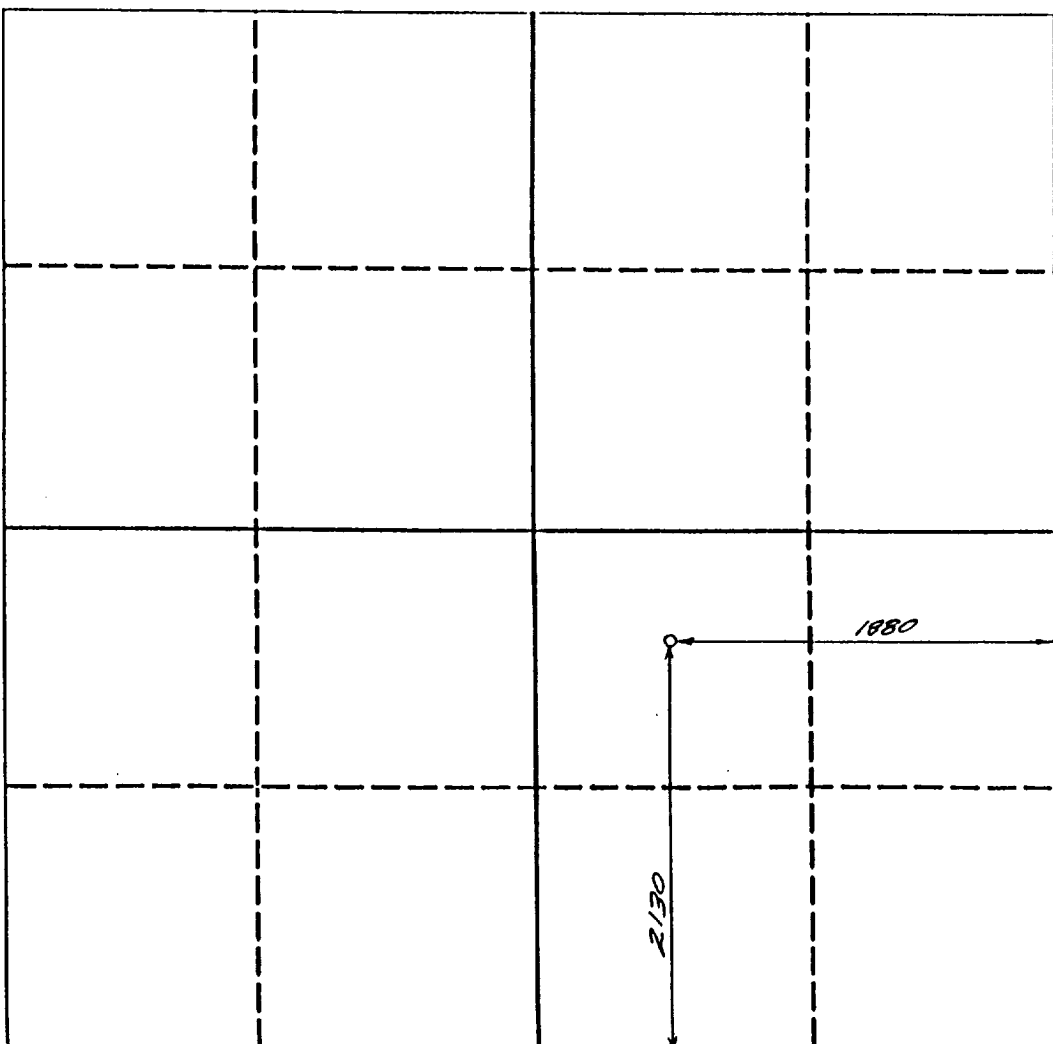

OPERATOR CERTIFICATION

I hereby certify that the information contained herein is true and complete to the best of my knowledge and belief.

Signature  
Ron Brown / RB

Printed Name  
Ron Brown

Position  
Petroleum Engineer

Company  
Hondo Oil & Gas Company

Date  
9/26/89

SURVEYOR CERTIFICATION

I hereby certify that the well location shown on this plat was plotted from field notes of actual surveys made by me or under my supervision, and that the same is true and correct to the best of my knowledge and belief.

Date Surveyed

August 2, 1989

Signature & Seal of  
Professional Surveyor

P.R. Patton

Certificate No.

8112

