

Submit to Appropriate
District Office
State Lease - 6 copies
Fee Lease - 5 copies

State of New Mexico
Energy, Minerals and Natural Resources Department

Form C-101
Revised 1-1-89

OIL CONSERVATION DIVISION

DISTRICT I
P.O. Box 1980, Hobbs, NM 88240

DISTRICT II
P.O. Drawer DD, Artesia, NM 88210

DISTRICT III
1000 Rio Brazos Rd., Aztec, NM 87410

P.O. Box 2088
Santa Fe, New Mexico 87504-2088

MAY 21 1991

O. C. D.

API NO. (assigned by OCD on New Wells)

30-015-26754

5. Indicate Type of Lease

STATE ☒

FEE ☐

6. State Oil & Gas Lease No.

B-10714

APPLICATION FOR PERMIT TO DRILL, DEEPEN, OR PLUG BACK

1a. Type of Work:

DRILL ☒

RE-ENTER ☐

DEEPEN ☐

PLUG BACK ☐

b. Type of Well:

OIL
WELL ☒

GAS
WELL ☐

OTHER ☐

SINGLE
ZONE ☒

MULTIPLE
ZONE ☐

2. Name of Operator

Marbob Energy Corporation ✓

3. Address of Operator

P. O. Drawer 217, Artesia, NM 88210

7. Lease Name or Unit Agreement Name

G-J West Coop Unit

8. Well No.

97

9. Pool name or Wildcat

Grbg Jackson SR Q Grbg SA

4. Well Location
Unit Letter

B

1650

Feet From The East

Line and

990

Feet From The North

Line

Section

22

Township

17S

Range

29E

NMPM

Eddy

County

10. Proposed Depth

4500'

11. Formation

San Andres

12. Rotary or C.T.

Rotary

13. Elevations (Show whether DF, RT, GR, etc.)

3567.7' GR

14. Kind & Status Plug Bond

Statewide active

15. Drilling Contractor

LaRue Drilling

16. Approx. Date Work will start

6/3/91

17. PROPOSED CASING AND CEMENT PROGRAM

SIZE OF HOLE	SIZE OF CASING	WEIGHT PER FOOT	SETTING DEPTH	SACKS OF CEMENT	EST. TOP
17 1/4"	13 3/8"	54.5#	125'	to circ	
12 1/4"	8 5/8"	24#	800'	to circ	
7 7/8"	5 1/2"	17#	4500'	Sufficiently attempt to circ	

We propose to drill to 125', run 13 3/8" casing and cement,
drill to 800' & run 8 5/8" casing and cement, drill on
to test the San Andres zone, run 5 1/2" casing & cement,
put on production.

Post ID-1
5-31-91

New Loc & API

NOTE: On production string, a fluid caliber will be run, will
figure cement w/25% excess, attempt to circulate

APPROVAL VALID FOR 180 DAYS
PERMIT EXPIRES 11/24/91
UNLESS DRILLING UNDERWAY

IN ABOVE SPACE DESCRIBE PROPOSED PROGRAM: IF PROPOSAL IS TO DEEPEN OR PLUG BACK, GIVE DATA ON PRESENT PRODUCTIVE ZONE AND PROPOSED NEW PRODUCTIVE ZONE. GIVE BLOWOUT PREVENTER PROGRAM, IF ANY.

I hereby certify that the information above is true and complete to the best of my knowledge and belief.

SIGNATURE

Rhonda Nelson

TITLE Production Clerk

DATE 5/21/91

TYPE OR PRINT NAME

Rhonda Nelson

TELEPHONE NO. 748-3303

(This space for State Use)

ORIGINAL SIGNED BY

MIKE WILLIAMS

APPROVED BY

SUPERVISOR, DISTRICT II

TITLE

DATE

MAY 24 1991

CONDITIONS OF APPROVAL, IF ANY:

Submit to Appropriate
District Office
State Leases - 4 copies
Fee Leases - 3 copies

State of New Mexico
Energy, Minerals and Natural Resources Department

Form C-102
Revised 1-1-89

OIL CONSERVATION DIVISION

P.O. Box 2088
Santa Fe, New Mexico 87504-2088

DISTRICT I
P.O. Box 1980, Hobbs, NM 88240

DISTRICT II
P.O. Drawer DD, Artesia, NM 88210

DISTRICT III
1000 Rio Brazos Rd., Aztec, NM 87410

WELL LOCATION AND ACREAGE DEDICATION PLAT

All Distances must be from the outer boundaries of the section

Operator MARBOB ENERGY CORP.			Lease G. J. WEST		Well No. 97
Unit Letter B	Section 22	Township 17 SOUTH	Range 29 EAST	County EDDY	
Actual Footage Location of Well: 1650 feet from the EAST line and 990 feet from the NORTH line					
Ground level Elev. 3567.7	Producing Formation San Andres		Pool Grbg Jackson Sr Q Grbg SA		Dedicated Acreage: 40 Acres

1. Outline the acreage dedicated to the subject well by colored pencil or hatchure marks on the plat below.
2. If more than one lease is dedicated to the well, outline each and identify the ownership thereof (both as to working interest and royalty).
3. If more than one lease of different ownership is dedicated to the well, have the interest of all owners been consolidated by communitization, unitization, force-pooling, etc.?
☐ Yes ☐ No If answer is "yes" type of consolidation _____

If answer is "no" list the owners and tract descriptions which have actually been consolidated. (Use reverse side of this form if necessary.)

No allowable will be assigned to the well until all interests have been consolidated (by communitization, unitization, forced-pooling, or otherwise) or until a non-standard unit, eliminating such interest, has been approved by the Division.

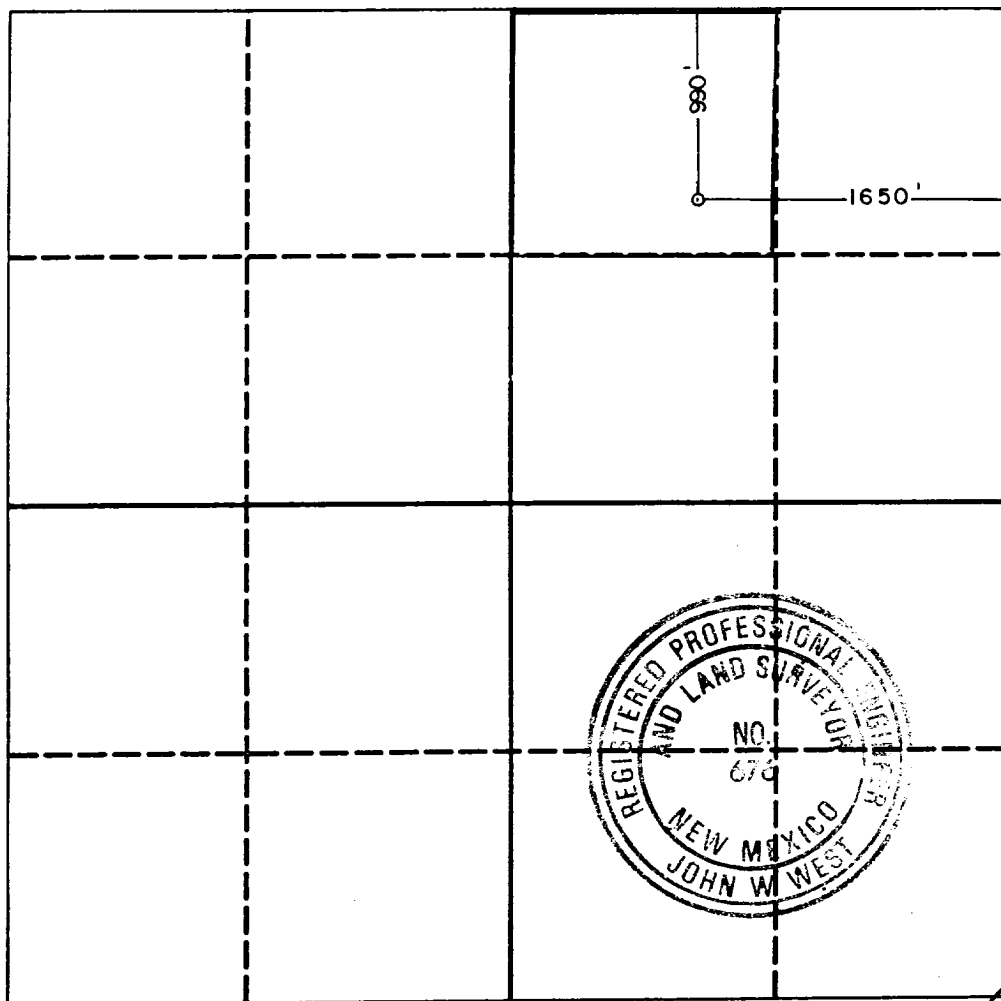

OPERATOR CERTIFICATION

I hereby certify that the information contained herein is true and complete to the best of my knowledge and belief.

Signature

Printed Name

Rhonda Nelson

Position

Production Clerk

Company

Marbob Energy Corporation

Date

May 21, 1991

SURVEYOR CERTIFICATION

I hereby certify that the well location shown on this plat was plotted from field notes of actual surveys made by me or under my supervision, and that the same is true and correct to the best of my knowledge and belief.

Date Surveyed

5-13-91

Signature & Seal of
Professional Surveyor

Certificate No.

JOHN W. WEST, 676

RONALD J. EIDSON,

3239