

Submit to Appropriate  
District Office  
State Lease - 6 copies  
Fee Lease - 5 copies

State of New Mexico  
Energy, Minerals and Natural Resources Department

Form C-101  
Revised 1-1-89

OIL CONSERVATION DIVISION

DISTRICT I  
P.O. Box 1980, Hobbs, NM 88240

DISTRICT II  
P.O. Drawer DD, Artesia, NM 88210

DISTRICT III  
1000 Rio Brazos Rd., Aztec, NM 87410

P.O. Box 2088  
Santa Fe, New Mexico 87504-2088

SEP 13 1991

O. C. D.

API NO. (assigned by OCD on New Wells)

30-015-26840

5. Indicate Type of Lease

STATE ☒

FEE ☐

6. State Oil & Gas Lease No.

B-1266

7. Lease Name or Unit Agreement Name

G-J West Coop Unit

8. Well No.

100

9. Pool name or Wildcat

Grbg Jackson SR Q Grbg SA

1a. Type of Work:

DRILL ☒

RE-ENTER ☐

DEEPEN ☐

PLUG BACK ☐

b. Type of Well:

OIL

WELL ☒

GAS

WELL ☐

OTHER ☐

SINGLE  
ZONE ☒

MULTIPLE  
ZONE ☐

2. Name of Operator

Marbob Energy Corporation

3. Address of Operator

P. O. Drawer 217, Artesia, NM 88210

4. Well Location

Unit Letter

K

:

1345

Feet From The

South

Line and

1345

Feet From The

West

Line

Section

21

Township

17S

Range

29E

NMPM

Eddy

County

10. Proposed Depth

4500'

11. Formation

San Andres

12. Rotary or C.T.

Rotary

13. Elevations (Show whether DF, RT, GR, etc.)

3608.1' GR

14. Kind & Status Plug. Bond

Statewide active

15. Drilling Contractor

LaRue Drilling

16. Approx. Date Work will start

9/30/91

17. PROPOSED CASING AND CEMENT PROGRAM

SIZE OF HOLE	SIZE OF CASING	WEIGHT PER FOOT	SETTING DEPTH	SACKS OF CEMENT	EST. TOP
17 1/4"	13 3/8"	54.5#	170'	to circulate	
12 1/4"	8 5/8"	24#	800'	to circulate	
7 7/8"	5 1/2"	17#	4500'	Sufficiently attempt to circ.	

We propose to drill to 170', run 13 3/8" casing and cement, drill to 800' & run 8 5/8" casing and cement, drill on to test the San Andres zone, run 5 1/2" casing, put on production.

APPROVAL VALID FOR 180 DAYS  
PERMIT EXPIRES 3/25/92  
UNLESS DRILLING UNDERWAY

NOTE: On production string, a fluid caliber will be run, will figure cement w/25% excess, attempt to circulate.

IN ABOVE SPACE DESCRIBE PROPOSED PROGRAM: IF PROPOSAL IS TO DEEPEN OR PLUG BACK, GIVE DATA ON PRESENT PRODUCTIVE ZONE AND PROPOSED NEW PRODUCTIVE ZONE. GIVE BLOWOUT PREVENTER PROGRAM, IF ANY.

I hereby certify that the information above is true and complete to the best of my knowledge and belief.

SIGNATURE

Rhonda Nelson

TITLE Production Clerk

DATE 9/12/91

TYPE OR PRINT NAME

ORIGINAL SIGNED BY

TELEPHONE NO. 748-3303

(This space for State Use)

MIKE WILLIAMS  
SUPERVISOR, DISTRICT II

SEP 25 1991

APPROVED BY

TITLE

DATE

CONDITIONS OF APPROVAL, IF ANY: Pending NSL Approval

20

2000

2000

2000

Submit to Appropriate  
District Office  
State Lease - 4 copies  
Fee Lease - 3 copies

State of New Mexico  
Energy, Minerals and Natural Resources Department

Form C-102  
Revised 1-1-89

OIL CONSERVATION DIVISION

P.O. Box 2088  
Santa Fe, New Mexico 87504-2088

DISTRICT I  
P.O. Box 1980, Hobbs, NM 88240

DISTRICT II  
P.O. Drawer DD, Artesia, NM 88210

DISTRICT III  
1000 Rio Brazos Rd., Aztec, NM 87410

WELL LOCATION AND ACREAGE DEDICATION PLAT

All Distances must be from the outer boundaries of the section

Operator Marbob Energy Corp.			Lease G. J. West		Well No. 100
Unit Letter K	Section 21	Township 17 South	Range 29 East	County Eddy	
Actual Footage Location of Well: 1345 feet from the South line and 1345 feet from the West line					
Ground level Elev. 3608.1	Producing Formation San Andres	Pool Grbg Jackson SR Q Grbg SA		Dedicated Acreage: 40 Acres	

1. Outline the acreage dedicated to the subject well by colored pencil or hatchure marks on the plat below.
2. If more than one lease is dedicated to the well, outline each and identify the ownership thereof (both as to working interest and royalty).
3. If more than one lease of different ownership is dedicated to the well, have the interest of all owners been consolidated by communitization, unitization, force-pooling, etc.?  
☐ Yes ☐ No If answer is "yes" type of consolidation \_\_\_\_\_  
If answer is "no" list the owners and tract descriptions which have actually been consolidated. (Use reverse side of this form if necessary). \_\_\_\_\_  
No allowable will be assigned to the well until all interests have been consolidated (by communitization, unitization, forced-pooling, or otherwise) or until a non-standard unit, eliminating such interest, has been approved by the Division.

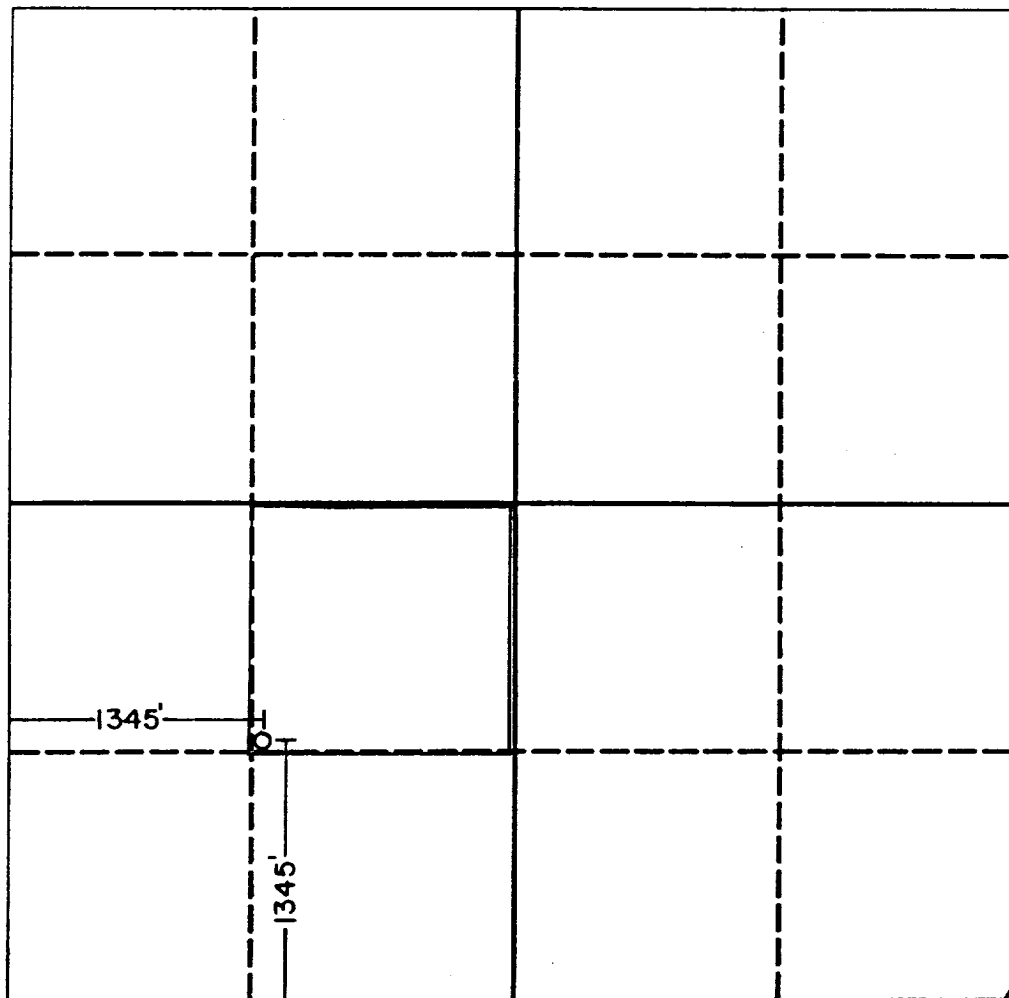

OPERATOR CERTIFICATION

I hereby certify that the information contained herein is true and complete to the best of my knowledge and belief.

Signature  
*Rhonda Nelson*  
Printed Name  
Rhonda Nelson  
Position  
Production Clerk  
Company  
Marbob Energy Corporation  
Date  
September 12, 1991

SURVEYOR CERTIFICATION

I hereby certify that the well location shown on this plat was plotted from field notes of actual surveys made by me or under my supervision, and that the same is true and correct to the best of my knowledge and belief.

Date Surveyed  
September 9, 1991  
Signature & Seal of Professional Surveyor  
*John W. West*  
Professional Surveyor  
676  
JOHN W. WEST  
RONALD J. EIDSON, 3239

