

Submit to Appropriate  
District Office  
State Lease - 6 copies  
Fee Lease - 5 copies

State of New Mexico  
Energy, Minerals and Natural Resources Department

Form C-101  
Revised 1-1-89

OIL CONSERVATION DIVISION

P.O. Box 2088  
Santa Fe, New Mexico 87504-2088

DISTRICT I  
P.O. Box 1980, Hobbs, NM 88240

DISTRICT II  
P.O. Drawer DD, Artesia, NM 88210

DISTRICT III  
1000 Rio Brazos Rd., Aztec, NM 87410

MAR 10 1993

O.C.D.

API NO. (assigned by OCD on New Wells)

30-815-27345

5. Indicate Type of Lease

STATE ☒

FEE ☐

6. State Oil & Gas Lease No.

APPLICATION FOR PERMIT TO DRILL, DEEPEN OR PLUG BACK

1a. Type of Work:

DRILL ☒

RE-ENTER ☐

DEEPEN ☐

PLUG BACK ☐

b. Type of Well:

OIL  
WELL ☒

GAS  
WELL ☐

OTHER ☐

SINGLE  
ZONE ☒

MULTIPLE  
ZONE ☐

7. Lease Name or Unit Agreement Name

G-J West Coop Unit

2. Name of Operator

Mack Energy Corporation ✓

3. Address of Operator

P.O. Box 1359, Artesia, NM 88211-1359

8. Well No.

#112

9. Pool name or Wildcat

Grayburg Jackson SR QN GB SA

4. Well Location

Unit Letter L : 1650 Feet From The South Line and 990 Feet From The West Line

Section 16

Township 17S

Range 29E

NMPM

Eddy

County

10. Proposed Depth

4300'

11. Formation

San Andres

12. Rotary or C.T.

Rotary

13. Elevations (Show whether DF, RT, GR, etc.)

3582.6 GR

14. Kind & Status Plug. Bond

Statewide Bond

15. Drilling Contractor

LaRue Drilling

16. Approx. Date Work will start

3/15/93

17.

PROPOSED CASING AND CEMENT PROGRAM

SIZE OF HOLE	SIZE OF CASING	WEIGHT PER FOOT	SETTING DEPTH	SACKS OF CEMENT	EST. TOP
17 1/2"	13 3/8"	54.5#	125'	Circulate	
12 1/4"	8 5/8"	24#	800'	Circulate	
7 7/8"	5 1/2"	17#	4300'	Sufficiently attempt to circ.	

Mack Energy proposes to drill to 125', run 13 3/8" casing and cement.  
Drill to 800', run 8 5/8" casing and cement. Drill to 4300' and test  
San Andres Zone, run 5 1/2" casing and cement, put on production.

Note: On Production string, a fluid caliber will be run, will figure  
cement, with 25% excess, attempt to circulate.

POST 10-1  
3-19-93  
NEWLOG 9-11

IN ABOVE SPACE DESCRIBE PROPOSED PROGRAM: IF PROPOSAL IS TO DEEPEN OR PLUG BACK, GIVE DATA ON PRESENT PRODUCTIVE ZONE AND PROPOSED NEW PRODUCTIVE ZONE. GIVE BLOWOUT PREVENTER PROGRAM, IF ANY.

I hereby certify that the information above is true and complete to the best of my knowledge and belief.

SIGNATURE Crisa D. Carter TITLE Production Clerk DATE 3/10/93

TYPE OR PRINT NAME

TELEPHONE NO.

(This space for State Use)

APPROVED BY [Signature] TITLE Geologist DATE 3-15-93

CONDITIONS OF APPROVAL, IF ANY:

APPROVAL VALID FOR 180 DAYS  
PERMIT EXPIRES 9-15-93  
UNLESS DRILLING UNDERWAY

# OIL CONSERVATION DIVISION

P.O. Box 2088  
Santa Fe, New Mexico 87504-2088

DISTRICT I  
P.O. Box 1980, Hobbs, NM 88240

DISTRICT II  
P.O. Drawer DD, Artesia, NM 88210

DISTRICT III  
1000 Rio Brazos Rd., Aztec, NM 87410

## WELL LOCATION AND ACREAGE DEDICATION PLAT

All Distances must be from the outer boundaries of the section

Operator MACK ENERGY CORP.			Lease G.J. WEST		Well No. 112
Unit Letter L	Section 16	Township 17 SOUTH	Range 29 EAST	NMPM	County EDDY
Actual Footage Location of Well: 1650 feet from the SOUTH line and 990 feet from the WEST line					
Ground Level Elev. 3582.6	Producing Formation San Andres	Pool Grayburg Jackson SR QN GB SA			Dedicated Acreage: 40 Acres

- Outline the acreage dedicated to the subject well by colored pencil or hachure marks on the plat below.
- If more than one lease is dedicated to the well, outline each and identify the ownership thereof (both as to working interest and royalty).
- If more than one lease of different ownership is dedicated to the well, have the interest of all owners been consolidated by communitization, unitization, force-pooling, etc.?  
☐ Yes ☐ No If answer is "yes" type of consolidation \_\_\_\_\_

If answer is "no" list of owners and tract descriptions which have actually been consolidated. (Use reverse side of this form necessary.)

No allowable will be assigned to the well unit all interests have been consolidated (by communitization, unitization, forced-pooling, otherwise) or until a non-standard unit, eliminating such interest, has been approved by the Division.

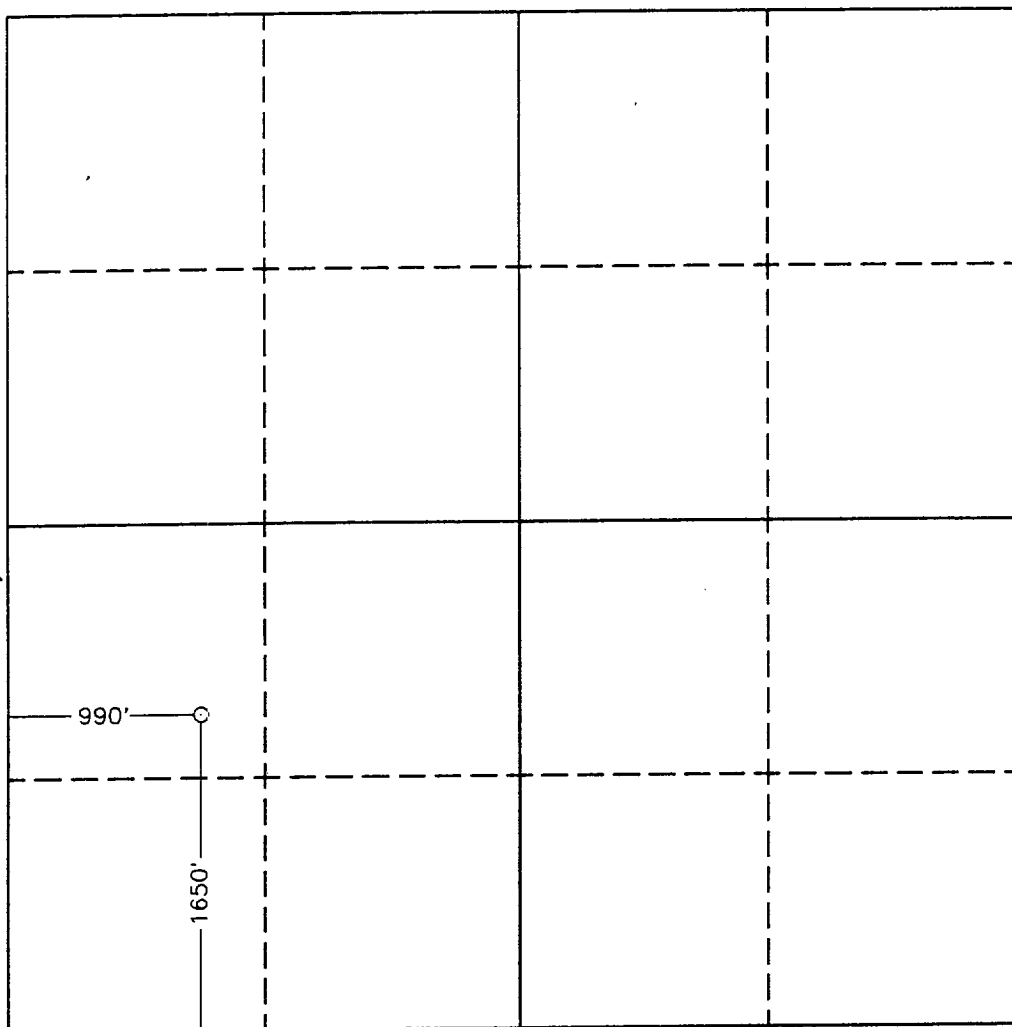

### OPERATOR CERTIFICATION

I hereby certify the the information contained herein is true and complete to the best of my knowledge and belief.

Signature  
*Crissa D. Carter*

Printed Name  
Crissa D. Carter

Position  
Production Clerk

Company  
Mack Energy Corporation

Date  
3/10/93

### SURVEYOR CERTIFICATION

I hereby certify that the well location shown on this plat was plotted from field notes of actual surveys made by me or under my supervision, and that the same is true and correct to the best of my knowledge and belief.

Date Surveyed  
MARCH 5, 1993

Signature & Seal of  
Professional Surveyor

Certification No. JOHN W. WEST, 878  
RONALD J. EDSON, 3238  
GARY L. JONES, 7977  
93-11-0391