

Submit to Appropriate
District Office
State Lease - 4 copies
Fee Lease - 3 copies

State of New Mexico
Energy, Minerals and Natural Resources Department

Form C-102
Revised 1-1-89

OIL CONSERVATION DIVISION

P.O. Box 2088
Santa Fe, New Mexico 87504-2088

DISTRICT I
P.O. Box 1980, Hobbs, NM 88240

DISTRICT II
P.O. Drawer DD, Artesia, NM 88210

DISTRICT III
1000 Rio Brazos Rd., Aztec, NM 87410

WELL LOCATION AND ACREAGE DEDICATION PLAT

All Distances must be from the outer boundaries of the section

| | | | | | |
|---|--------------------------------------|-----------------------------|-----------------------------------|----------------------------|--|
| Operator ANADARKO PETROLEUM CORPORATION | | | Lease POWER FEDERAL COM | | Well No. 2 |
| Unit Letter I | Section 26 | Township 17 SOUTH | Range 30 EAST | County NMPM EDDY | |
| Actual Footage Location of Well: 660 feet from the EAST line and 1400 feet from the SOUTH line | | | | | |
| Ground level Elev. 3544 | Producing Formation MORROW | | Pool CEDAR LAKE MORROW | | Dedicated Acreage: 320 Acres |

1. Outline the acreage dedicated to the subject well by colored pencil or hatchure marks on the plat below.

2. If more than one lease is dedicated to the well, outline each and identify the ownership thereof (both as to working interest and royalty). See reverse side plus additional page.

3. If more than one lease of different ownership is dedicated to the well, have the interest of all owners been consolidated by communitization, unitization, force-pooling, etc.?

☒ Yes ☐ No If answer is "yes" type of consolidation Communitization

If answer is "no" list the owners and tract descriptions which have actually been consolidated. (Use reverse side of this form if necessary.)

No allowable will be assigned to the well until all interests have been consolidated (by communitization, unitization, forced-pooling, or otherwise) or until a non-standard unit, eliminating such interest, has been approved by the Division.

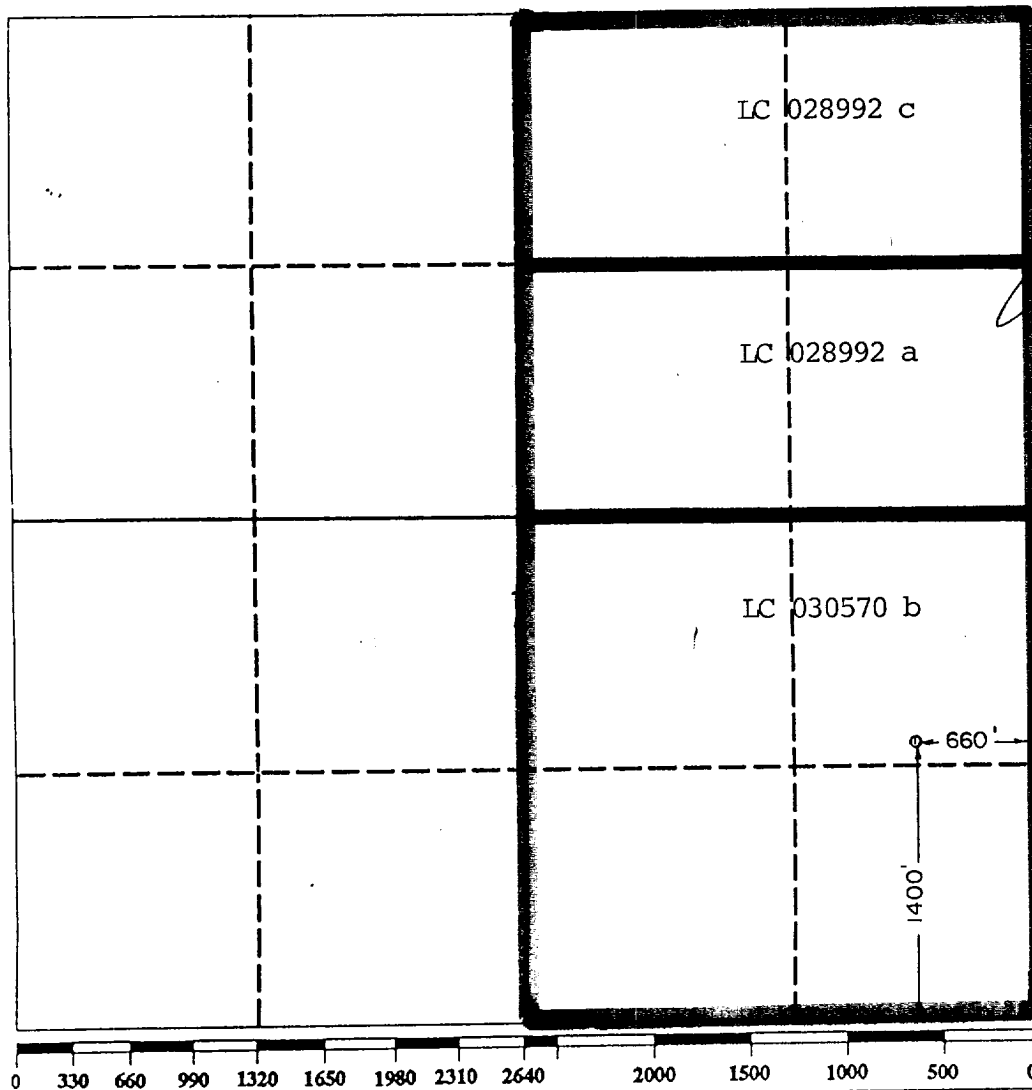

OPERATOR CERTIFICATION

I hereby certify that the information contained herein is true and complete to the best of my knowledge and belief.

Signature
Jerry E. Buckles
Printed Name
JERRY BUCKLES
Position
AREA SUPERVISOR
Company
ANADARKO PETROLEUM CORP.
Date
5-1-93

SURVEYOR CERTIFICATION

I hereby certify that the well location shown on this plat was plotted from field notes of actual surveys made by me or under my supervision, and that the same is true and correct to the best of my knowledge and belief.

Date Surveyed

3/26/93

Signature & Seal of
Professional Surveyor

Herschel L. Jones
Certificate No.
3640

LEASEHOLD INTEREST

- (1) S/2 NE/4 - - - - - 81.25% Anadarko Petroleum Corporation
18.75% Weller Energy, Inc.
- (2) N/2 NE/4 - - - - - 100% Phillips Petroleum Co.
- (3) SE/4 - - - - - 16.67% Fair Oil LTD
25.00% Anadarko Petroleum Corporation
25.00% Phillips Petroleum Corporation
25.00% Read & Stevens, Inc.
8.33% Richard L. Ray

OIL & GAS LEASES AND OIL & GAS RIGHTS SUBJECT TO THIS AGREEMENT

| <u>Lease #</u> | <u>Ownership</u> | <u>Mineral Interest</u> |
|--|------------------|-------------------------|
| LC 028992 a - - - - - S/2 NE/4, Sec. 26 | USA - - - | 100% |
| LC 028992 c - - - - - N/2 NE/4, Sec. 26 | USA - - - | 100% |
| LC 030570 b - - - - - SE/4 | USA - - - | 100% |

Date of Operational Agreement - - - April 30, 1993

Depth & Formation Restrictions - - - the limited horizons between 4000'
and the base of the Morrow formation.