

SURFACE USE PLAN

**Burch Keely Unit #249
1650' FNL & 1150' FWL
Section 23-17S-29E
Eddy County, New Mexico**

Please refer to Marbob Energy Corporation's Master Surface Use and Operating Plan for the Burch-Keely Unit. All points of the master plan are applicable to this well with the following additional information to be included:

1. (C) Directions to location: Proceed east on U.S. 82 from Artesia for approximately 21.0 miles. Turn north on lease road and cross brown rusty cattleguard proceed north .2 miles. Turn east and proceed .2 miles. The proposed location will be on the west side of the road.

4. (A) If productive this well will use Satellite D.

DRILLING PROGRAM

**Burch Keely Unit #249
1650' FNL & 1150' FWL
Section 23-17S-29E
Eddy County, New Mexico**

Please refer to Marbob Energy Corporation's Master Drilling Program for the Burch-Keely Unit. All points of the program are applicable to this well.

The anticipated spud date will commence approximately November 1, 1995.

This A.P.D. was previously approved. The A.P.D. expired July 21, 1995. Please refer to the "expired" file for additional information.

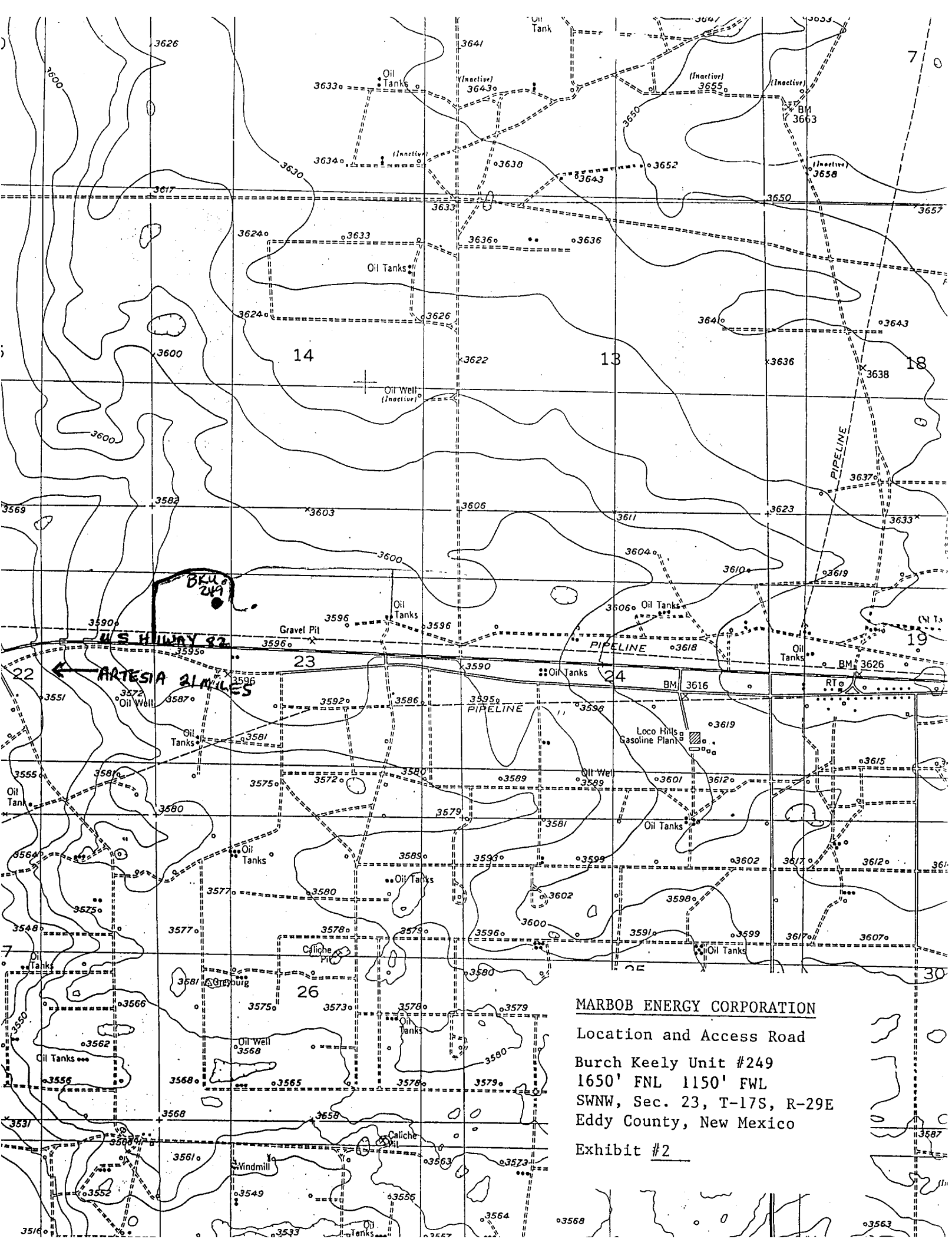

MARBOB ENERGY CORPORATION

Location and Access Road

Burch Keely Unit #249
1650' FNL 1150' FWL
SWNW, Sec. 23, T-17S, R-29E
Eddy County, New Mexico

Exhibit #2