

UNITED STATES
DEPARTMENT OF THE INTERIOR
BUREAU OF LAND MANAGEMENT

FORM APPROVED
Budget Bureau No. 1004-0135
Expires March 31, 1993

SUNDRY NOTICES AND REPORTS ON WELLS

Do not use this form for proposals to drill or to deepen or reentry to a different reservoir.
Use "APPLICATION FOR PERMIT—" for such proposals

SUBMIT IN TRIPLICATE

1. Type of Well
☒ Oil Well ☐ Gas Well ☐ Other

2. Name of Operator
DEVON ENERGY OPERATING CORPORATION

3. Address and Telephone No.
20 NORTH BROADWAY, SUITE 1600, OKLAHOMA CITY, OKLAHOMA 73102 (406)562-4630

4. Location of Well (Footage, Sec., T., R., M., or Survey Description)
1310' FNL & 1310 FEL, SEC 7-T17S-R31E

RECEIVED
OCT 13 '94
ARTESIA OFFICE
Unit A

5. Lease Designation and Serial No.
LC 029435-A

6. If Indian, Allottee or Tribe Name
NA

7. If Unit or CA, Agreement Designation
NA

8. Well Name and No.
KEEL "A" #21

9. API Well No.

10. Field and Pool, or Exploratory Area
GRAYBURG-JACKSON

11. County or Parish, State
EDDY COUNTY, NM

CHECK APPROPRIATE BOX(S) TO INDICATE NATURE OF NOTICE, REPORT, OR OTHER DATA

TYPE OF SUBMISSION	TYPE OF ACTION
<input type="checkbox"/> Notice of Intent	<input type="checkbox"/> Abandonment
<input checked="" type="checkbox"/> Subsequent Report	<input type="checkbox"/> Recompletion
<input type="checkbox"/> Final Abandonment Notice	<input type="checkbox"/> Plugging Back
	<input type="checkbox"/> Casing Repair
	<input type="checkbox"/> Altering Casing
	<input checked="" type="checkbox"/> Other LOCATION MOVE
	<input type="checkbox"/> Change of Plans
	<input type="checkbox"/> New Construction
	<input type="checkbox"/> Non-Routine Fracturing
	<input type="checkbox"/> Water Shut-Off
	<input type="checkbox"/> Conversion to Injection
	<input type="checkbox"/> Dispose Water

(Note: Report results of multiple completion on well Completion or Recompletion Report and Log form.)

13. Describe Proposed or Completed Operations (Clearly state all pertinent details, and give pertinent dates, including estimated date of starting any proposed work. If well is directionally drilled, give subsurface locations and measured and true vertical depths for all markers and zones pertinent to this work.)*

NOTIFICATION OF LOCATION CHANGE.

Originally proposed location: 1320' FNL & 1320' FWL, Sec 7-T17S-R31E

New location: 1310' FNL & 1310' FEL, Sec 7-T17S-R31E

The above move is required to comply with the New Mexico Oil Conservation Division Rule which requires all well locations be a minimum of 10' from all quarter-quarter section lines. Because this move is only 10' from quarter-quarter section lines, the surface utilized for the Drilling Pad and Reserve Pit will remain unchanged. All excavation work will remain within the confines approved in the original APD.

A drilling rig is currently working in this area. As per telephone conversation with the BLM's Shannon Shaw, this move has been tentatively approved.

14. I hereby certify that the foregoing is true and correct

Signed Jo Ann Hooks

Title JO ANN HOOKS
ENGINEERING TECHNICIAN

Date October 3, 1994

(This space for Federal or State office use)

Approved by Shannon J. Shaw

Title Development Engineer

Date 10/11/94

Conditions of approval, if any:

DISTRICT I
P. O. Box 1980
Hobbs, NM 88241-1980

DISTRICT II
P. O. Drawer DD
Artesia, NM 88211-0719

DISTRICT III
1000 Rio Brazos Rd.
Aztec, NM 87410

DISTRICT IV
P. O. Box 2088
Santa Fe, NM 87507-2088

State of New Mexico
Energy, Minerals, and Natural Resources Department

Form C-102
Revised 02-10-94

Instructions on back

Submit to the Appropriate
District Office
State Lease - 4 copies
Fee Lease - 3 copies

OIL CONSERVATION DIVISION

P. O. Box 2088
Santa Fe, New Mexico 87504-2088

RECEIVED

11 45 AM '94

AREA

AMENDED REPORT

WELL LOCATION AND ACREAGE DEDICATION PLAT

1 API Number		2 Pool Code		3 Pool Name					
4 Property Code A		5 Property Name KEEL 'A' FEDERAL				6 Well Number 21			
7 OGRID No.		8 Operator Name DEVON ENERGY OPERATING CORPORATION				9 Elevation 3736'			
10 SURFACE LOCATION									
UL or lot no.	Section	Township	Range	Lot Ida	Feet from the	North/South line	Feet from the	East/West line	County
	7	17 SOUTH	31 EAST, N.M.P.M.		1310'	NORTH	1310'	EAST	EDDY
11 BOTTOM HOLE LOCATION IF DIFFERENT FROM SURFACE									
UL or lot no.	Section	Township	Range	Lot Ida	Feet from the	North/South line	Feet from the	East/West line	County
12 Dedicated Acres		13 Joint or Infill		14 Consolidation Code		15 Order No.			
NO ALLOWABLE WELL BE ASSIGNED TO THIS COMPLETION UNTIL ALL INTERESTS HAVE BEEN CONSOLIDATED OR A NON-STANDARD UNIT HAS BEEN APPROVED BY THE DIVISION									

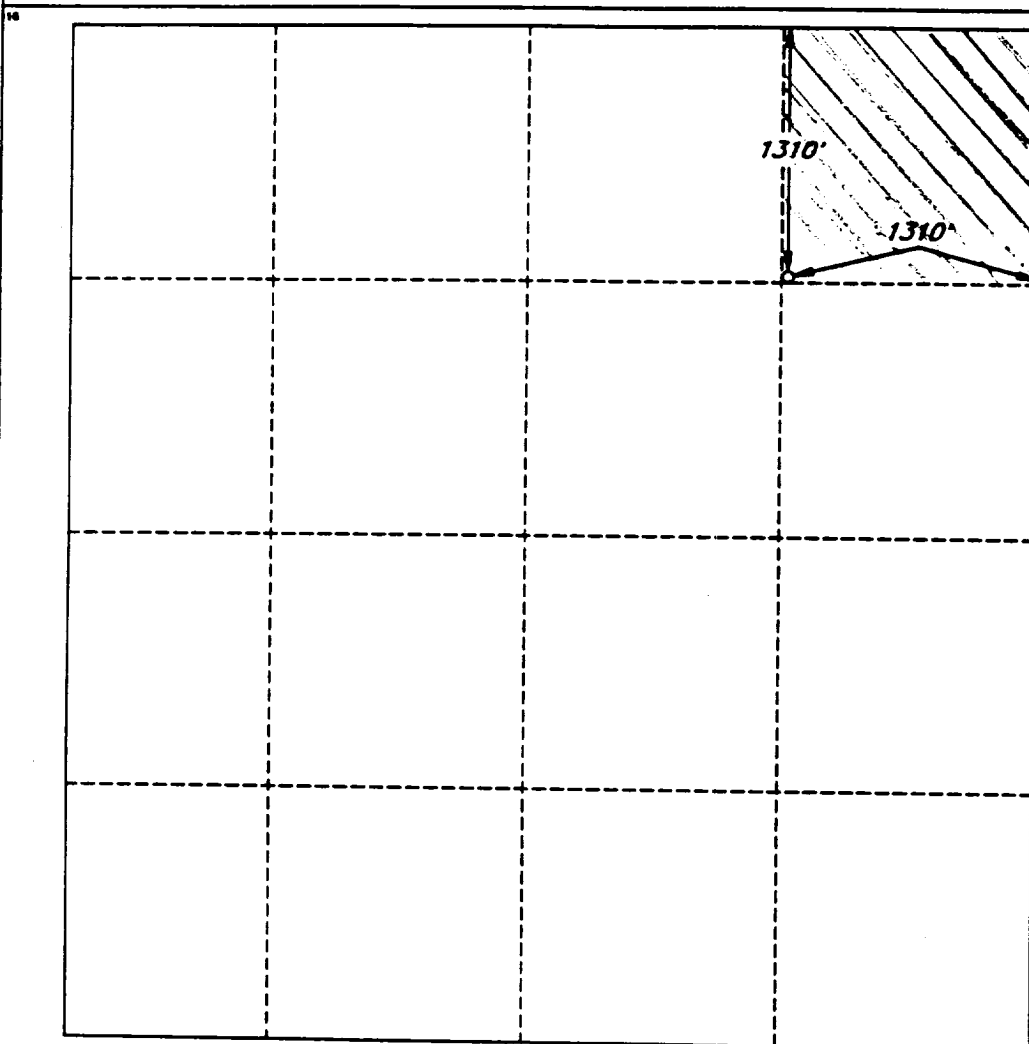

OPERATOR CERTIFICATION

I hereby certify that the information contained herein is true and complete to the best of my knowledge and belief.

Signature

Randy Jackson

Printed Name

RANDY JACKSON

Title

DISTRICT ENGINEER

Date

October 4, 1994

SURVEYOR CERTIFICATION

I hereby certify that the well location shown on this plat was plotted from field notes of actual surveys made by me or under my supervision, and that the same is true and correct to the best of my belief.

Date of Survey

SEPTEMBER 28, 1994

Signature and Seal of Professional Surveyor

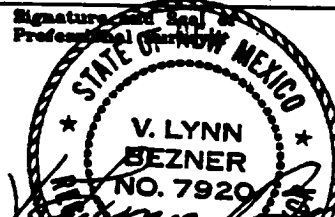

Certified by
V. LYNN BEZNER
Professional Surveyor, No. 7920

JOB #35105-4-1-18 SF / c/c