

UNITED STATES DEPARTMENT OF THE INTERIOR
BUREAU OF LAND MANAGEMENT
MEXICO, NM 88230

APPLICATION FOR PERMIT TO DRILL OR DEEPEN

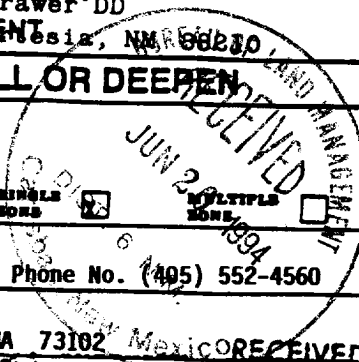

1a. TYPE OF WORK
DRILL **DEEPEN**

b. TYPE OF WELL
 OIL WELL GAS WELL OTHER
 SINGLE ZONE MULTIPLE ZONE

2. NAME OF OPERATOR
 Socorro Petroleum Company Attn: Jo Ann Hooks, Phone No. (405) 552-4560

3. ADDRESS AND TELEPHONE NO.
 20 NORTH BROADWAY, SUITE 1500, OKLAHOMA CITY, OKLAHOMA 73102 Mexico

4. LOCATION OF WELL (Report location clearly and in accordance with any State requirements.)
 At surface: 10' FNL & 110' FNL
 At proposed prod. zone: SAME
 U.T.D. NON-STANDARD LOCATION... SUBJECT TO THE APPROVAL BY STATE AUG 30 '94

14. DISTANCE IN MILES AND DIRECTION FROM NEAREST TOWN OR POST OFFICE
 4-MILES EAST AND 4 MILES NORTH OF LOCO HILLS, N.H. O. C. D.

10. DISTANCE FROM PROPOSED LOCATION TO NEAREST PROPERTY OR LEASE LINE, FT. (Also to nearest drig. salt line, if any)
 110'

16. NO. OF ACRES IN LEASE
 1885.0

18. DISTANCE FROM PROPOSED LOCATION TO NEAREST WELL, DRILLING, COMPLETED, OR APPLIED FOR, ON THIS LEASE, FT.
 900'

19. PROPOSED DEPTH
 4000'

21. ELEVATIONS (Show whether DF, RT, GR, etc.)
 3765'

22. APPROX. DATE WORK WILL START
 July 15, 1994

5. LEASE DESIGNATION AND SERIAL NO.
 LC-029435-B

6. IF INDIAN, ALLOTTED OR TRIBE NAME
 NA

7. DEED AGREEMENT NAME
 NA

8. FARM OR LEASE NAME WELL NO.
 Keel "B" # 54

9. API WELL NO.
 30-015-28092

10. FIELD AND POOL, OR WILDCAT
 Grayburg-Jackson, 7R-Q-6B-5A

11. SEC., T., R., M., OR BLE. AND SURVEY OR AREA
 Section 8 -T17S-R31E 28509

12. COUNTY OR PARISH
 Eddy NM

13. STATE
 NM

17. NO. OF ACRES ASSIGNED TO THIS WELL
 20 → 40 (555)

20. ROTARY OR CABLE TOOLS
 Rotary

22. APPROX. DATE WORK WILL START
 July 15, 1994

PROPOSED CASING AND CEMENTING PROGRAM

SIZE OF HOLE	GRADE AND WEIGHT	WEIGHT PER FOOT	SETTING DEPTH	QUANTITY OF CEMENT
17 1/2"	14"		60'	Cemented with redimix to surface.
12 1/2"	8 5/8" J-55 ERW,	24 ppf	550'	125 sks lite + 220 sks Class 'C'
7 7/8"	FBN ST&C R-8 5 1/2", J-55, ST&C seamless	15 1/2 ppf	0-TD	cellophane flakes. Cemented to surface with 475 sks 35.65

* We plan to circulate cement to surface on all casing strings. Socorro Petroleum Company proposes to drill to 4000' to test the Grayburg-Jackson formation for commercial quantities of oil. If the Grayburg-Jackson is deemed non-commercial, the wellbore will be plugged and abandoned per Federal regulations. Programs to adhere to onshore oil and gas regulations are outlined in the following exhibits and attachments.

- Drilling Program**
- Surface Use and Operating Plan
 - Exhibits #1/1-A = Blowout Prevention Equipment
 - Exhibit #2 = Location and Elevation Plat
 - Exhibit #3/3-A = Road Map and Topo Map
 - Exhibit #4 = Wells Within 1 Mile Radius
 - Exhibit #5 = Production Facilities Plat
 - Exhibit #6 = Rotary Rig Layout
 - Exhibit #7 = Casing Design
- OS Operating Plan**

The undersigned accepts all applicable terms, condition, stipulations and restrictions concerning operations conducted on the leased land or portions thereof, as described below:
 Lease #: LC-029435-B
 Legal Description: Section 8 -T17S-31E
 Formation: Grayburg-Jackson
 Bond Coverage: Nationwide
 BLM Bond #: PENDING

Post ID-1
9-9-94
New Loc & API

IN ABOVE SPACE DESCRIBE PROPOSED PROGRAM: If proposal is to deepen, give data on present productive zone and proposed new productive zone. If proposal is to drill or deepen directionally, give pertinent data on subsurface locations and measured and true vertical depths. Give blowout prevention program, if any.

SIGNED Randy Jackson TITLE District Engineer DATE May 27, 1994

PERMIT NO. _____ APPROVAL DATE _____
 APPROVAL SUBJECT TO GENERAL REQUIREMENTS AND SPECIAL STIPULATIONS ATTACHED

APPROVED BY [Signature] TITLE (Acting) AREA MANAGER DATE 8-25-94

*See Instructions On Reverse Side

INSTRUCTIONS

GENERAL: This form is designed for submitting proposals to perform certain well operations, as indicated, on all types of lands and leases for appropriate action by either a Federal or a State agency, or both, pursuant to applicable Federal and/or State laws and regulations. Any necessary special instructions concerning the use of this form and the number of copies to be submitted, particularly with regard to local, area, or regional procedures and practices, either are shown below or will be issued by, or may be obtained from, the local Federal and/or State office.

- ITEM 1:** If the proposal is to redrill to the same reservoir at a different subsurface location or to a new reservoir, use this form with appropriate notations. Consult applicable State or Federal regulations concerning subsequent work proposals or reports on the well.
- ITEM 4:** If there are no applicable State requirements, locations on Federal or Indian land should be described in accordance with Federal requirements. Consult local State or Federal office for specific instructions.
- ITEM 14:** Needed only when location of well cannot readily be found by road from the land or lease description. A plat, or plat, separate or on this reverse side, showing the roads to, and the surveyed location of, the well, and any other required information, should be furnished when required by Federal or State agency offices.
- ITEMS 15 AND 18:** If well is to be, or has been directionally drilled, give distances for subsurface location of hole in any present or objective production zone.
- ITEM 22:** Consult applicable Federal or State regulations, or appropriate officials, concerning approval of the proposal before operations are started.

NOTICE

The Privacy Act of 1974 and the regulation in 43 CFR 2.48(d) provide that you be furnished the following information in connection with information required by this application.

AUTHORITY: 30 U.S.C. 181 et seq., 25 U.S.C. 396; 43 CFR Part 3160.

PRINCIPAL PURPOSE: The information is to be used to process and evaluate your application for permit to drill or deeper an oil or gas well.

ROUTINE USES: (1) The analysis of the applicant's proposal to discover and extract the Federal or Indian resources encountered. (2) The review of procedures and equipment and the projected impact on the land involved. (3) The evaluation of the effects of proposed operation on surface and subsurface water and other environmental impacts. (4)(5) Information from the record and/or the record will be transferred to appropriate Federal, State, local or foreign agencies, when relevant to civil, criminal or regulatory investigations or prosecutions, as well as routine regulatory responsibility.

EFFECT OF NOT PROVIDING INFORMATION: Filing of this application and disclosure of the information is mandatory only if the operator elects to initiate drilling operations on an oil and gas lease.

BURDEN HOURS STATEMENT

Public reporting burden for this form is estimated to average 30 minutes per response, including the time for reviewing instructions, gathering and maintaining data, and completing and reviewing the form. Direct comments regarding the burden estimate or any other aspect of this form to U.S. Department of the Interior, Bureau of Land Management, (Alternate) Bureau Clearance Officer, (WO-771), 1849 C Street, N.W., Washington, D.C. 20240, and the Office of Management and Budget, Paperwork Reduction Project (1004-0136), Washington, D.C. 20503.

The Paperwork Reduction Act of 1980 (44 U.S.C. 3501 et seq) requires us to inform you that:

This information is being collected to allow evaluation of the technical, safety, and environmental factors involved with drilling for oil and/or gas on Federal and Indian oil and gas leases.

This information will be used to analyze and approve applications.

Response to this request is mandatory only if the operator elects to initiate drilling operations on an oil and gas lease.

DISTRICT I
P. O. Box 1980
Hobbs, NM 88241-1980

State of New Mexico
Energy, Minerals, and Natural Resources Department

Form C-102
Revised 02-10-94

Instructions on back

DISTRICT II
P. O. Drawer DD
Artesia, NM 88211-0719

OIL CONSERVATION DIVISION
P. O. Box 2088
Santa Fe, New Mexico 87504-2088

Submit to the Appropriate
District Office
State Lease - 4 copies
Fee Lease - 3 copies

DISTRICT III
1000 Rio Brazos Rd.
Aztec, NM 87410

AMENDED REPORT

DISTRICT IV
P. O. Box 2088
Santa Fe, NM 87507-2088

WELL LOCATION AND ACREAGE DEDICATION PLAT

¹ API Number 30-015-28092		² Pool Code 28509		³ Pool Name GRAYBURG JACKSON; JR-Q-68-SA	
⁴ Property Code D		⁵ Property Name KEEL 'B' FEDERAL			⁶ Well Number 54
⁷ OGRID No.		⁸ Operator Name SOCORRO PETROLEUM COMPANY			⁹ Elevation 3765'

" SURFACE LOCATION

UL or lot no.	Section	Township	Range	Lot Ida	Feet from the	North/South line	Feet from the	East/West line	County
	8	17 SOUTH	31 EAST, N.M.P.M.		10'	NORTH	110'	WEST	EDDY

" BOTTOM HOLE LOCATION IF DIFFERENT FROM SURFACE

UL or lot no.	Section	Township	Range	Lot Ida	Feet from the	North/South line	Feet from the	East/West line	County

¹² Dedicated Acres 40	¹³ Joint or Infill	¹⁴ Consolidation Code	¹⁵ Order No.
-------------------------------------	-------------------------------	----------------------------------	-------------------------

NO ALLOWABLE WELL BE ASSIGNED TO THIS COMPLETION UNTIL ALL INTERESTS HAVE BEEN CONSOLIDATED OR A NON-STANDARD UNIT HAS BEEN APPROVED BY THE DIVISION

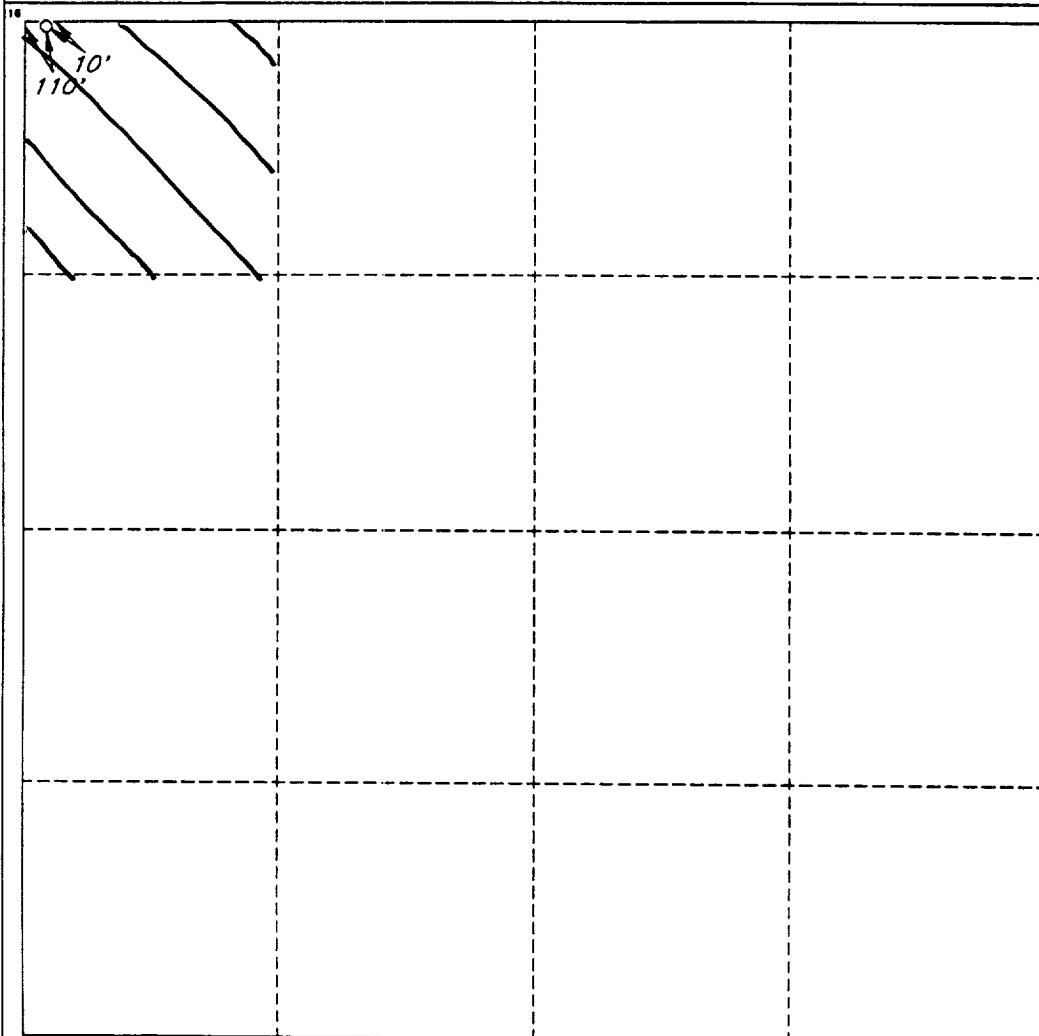

OPERATOR CERTIFICATION

I hereby certify that the information contained herein is true and complete to the best of my knowledge and belief.

Signature

Randy Jackson
Printed Name

RANDY JACKSON

Title

DISTRICT ENGINEER

Date

6/15/94

SURVEYOR CERTIFICATION

I hereby certify that the well location shown on this plat was plotted from field notes of actual surveys made by me or under my supervision, and that the same is true and correct to the best of my belief.

Date of Survey

Signature and Seal of Professional Surveyor

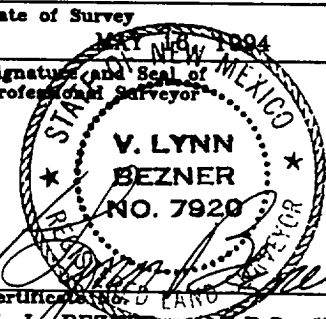

Certified to be a true and correct copy

V. L. BEZNER R.P.S. #7920

MINIMUM BLOWOUT PREVENTER REQUIREMENTS

3,000 psi Working Pressure

3 MWP

Eddy County, New Mexico
Exhibit #1

STACK REQUIREMENTS

No.	Item	Min. I.D.	Min. Nominal
1	Flowline		
2	Fill up line		2"
3	Drilling nipple		
4	Annular preventer		
5	Two single or one dual hydraulically operated rams		
6a	Drilling spool with 2" min. kill line and 3" min choke line outlets		
6b	2" min. kill line and 3" min. choke line outlets in ram. (Alternate to 6a above.)		
7	Valve Gate <input type="checkbox"/> Plug <input type="checkbox"/>	3-1/8"	
8	Gate valve—power operated	3-1/8"	
9	Line to choke manifold		3"
10	Valves Gate <input type="checkbox"/> Plug <input type="checkbox"/>	2-1/16"	
11	Check valve	2-1/16"	
12	Casing head		
13	Valve Gate <input type="checkbox"/> Plug <input type="checkbox"/>	1-13/16"	
14	Pressure gauge with needle valve		
15	Kill line to rig mud pump manifold		2"

OPTIONAL			
16	Flanged valve	1-13/16"	

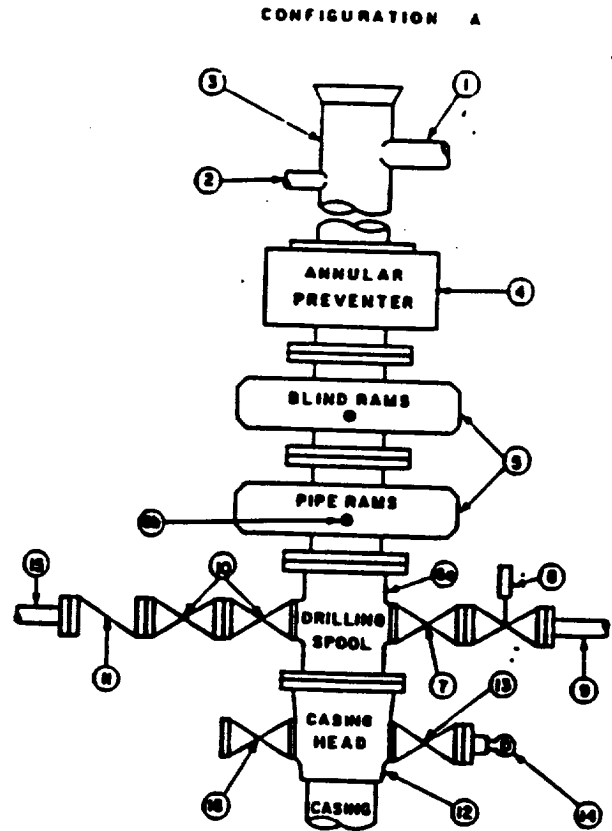

CONTRACTOR'S OPTION TO FURNISH:

- All equipment and connections above bradenhead or casinghead. Working pressure of preventers to be 3,000 psi, minimum.
- Automatic accumulator (80 gallon, minimum) capable of closing BOP in 30 seconds or less and, holding them closed against full rated working pressure.
- BOP controls, to be located near drillers position.
- Kelly equipped with Kelly cock.
- Inside blowout preventer or its equivalent on derrick floor at all times with proper threads to fit pipe being used.
- Kelly saver-sub equipped with rubber casing protector at all times.
- Plug type blowout preventer lester.
- Extra set pipe rams to fit drill pipe in use on location at all times.
- Type FX ring gaskets in place of Type R.

MEC TO FURNISH:

- Bradenhead or casinghead and side valves.
- Wear bushing, if required.

GENERAL NOTES:

- Deviations from this drawing may be made only with the express permission of MEC's Drilling Manager.
- All connections, valves, fittings, piping, etc., subject to well or pump pressure must be flanged (suitable clamp connections acceptable) and have minimum working pressure equal to rated working pressure of preventers up through choke. Valves must be full opening and suitable for high pressure mud service.
- Controls to be of standard design and each marked, showing opening and closing position.
- Chokes will be positioned so as not to hamper or delay changing of choke beans. Replaceable parts for adjustable choke, other bean sizes, retainers, and choke wrenches to be conveniently located for immediate use.
- All valves to be equipped with handwheels or handles ready for immediate use.
- Choke lines must be suitably anchored.

- Handwheels and extensions to be connected and ready for use.
- Valves adjacent to drilling spool to be kept open. Use outside valves except for emergency.
- All seamless steel control piping (3000 psi working pressure) to have flexible joints to avoid stress. Hoses will be permitted.
- Casinghead connections shall not be used except in case of emergency.
- Do not use kill line for routine fill-up operations.

Attachment to Exhibit #1
NOTES REGARDING BLOWOUT PREVENTORS
Grayburg-Jackson Field
Eddy County, New Mexico

1. Drilling nipple will be constructed so it can be removed mechanically without the aid of a welder. The minimum internal diameter will equal BOPE bore.
2. Wear ring will be properly installed in head.
3. Blowout preventor and all associated fittings will be in operable condition to withstand a minimum 3000 psi working pressure.
4. All fittings will be flanged.
5. A full bore safety valve tested to a minimum 3000 psi W.P. with proper thread connections will be available on the rotary rig floor at all times.
6. All choke lines will be anchored to prevent movement.
7. All BOP equipment will be equal to or larger in bore than the internal diameter of the last casing string.
8. Will maintain a kelly cock attached to the kelly.
9. Hand wheels and wrenches will be properly installed and tested for safe operation.
10. Hydraulic floor control for blowout preventor will be located as near in proximity to driller's controls as possible.
11. All BOP equipment will meet API standards and include a minimum 40 gallon accumulator having two independent means of power to initiate closing operation.

MINIMUM CHOKE MANIFOLD
3,000, 5,000 and 10,000 PSI Working Pressure

3 MWP - 5 MWP - 10 MWP

Eddy County, New Mexico
Exhibit #1-A

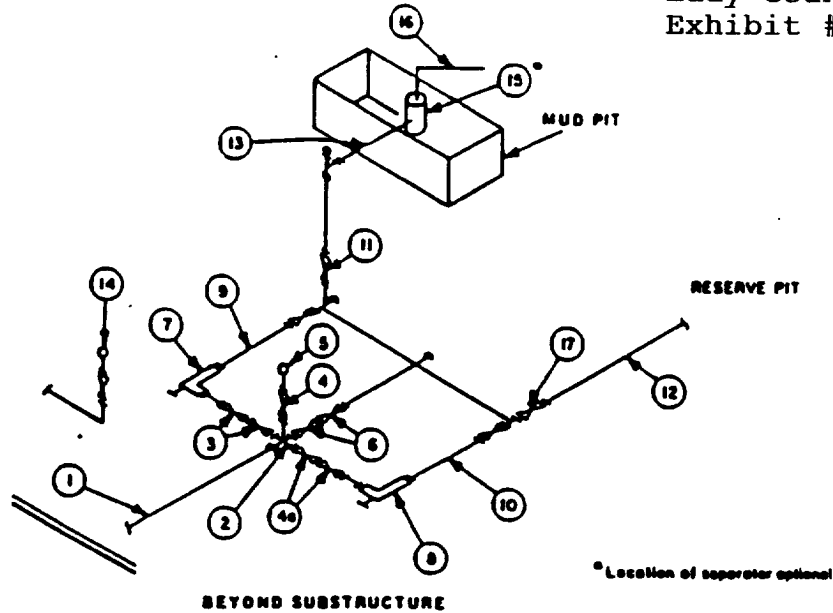

MINIMUM REQUIREMENTS										
No.		3,000 MWP			5,000 MWP			10,000 MWP		
		I.D.	NOMINAL	RATING	I.D.	NOMINAL	RATING	I.D.	NOMINAL	RATING
1	Line from drilling spool		3"	3,000		3"	5,000		3"	10,000
2	Cross 3"x3"x3"x2"			3,000			5,000			10,000
	Cross 3"x3"x3"x3"									10,000
3	Valves(1) Gate <input type="checkbox"/> Plug <input type="checkbox"/> (2)	3-1/8"		3,000	3-1/8"		5,000	3-1/8"		10,000
4	Valve Gate <input type="checkbox"/> Plug <input type="checkbox"/> (2)	1-13/16"		3,000	1-13/16"		5,000	1-13/16"		10,000
4a	Valves(1)	2-1/16"		3,000	2-1/16"		5,000	3-1/8"		10,000
5	Pressure Gauge			3,000			5,000			10,000
6	Valves Gate <input type="checkbox"/> Plug <input type="checkbox"/> (2)	3-1/8"		3,000	3-1/8"		5,000	3-1/8"		10,000
7	Adjustable Choke(3)	2"		3,000	2"		5,000	2"		10,000
8	Adjustable Choke	1"		3,000	1"		5,000	2"		10,000
9	Line		3"	3,000		3"	5,000		3"	10,000
10	Line		2"	3,000		2"	5,000		3"	10,000
11	Valves Gate <input type="checkbox"/> Plug <input type="checkbox"/> (2)	3-1/8"		3,000	3-1/8"		5,000	3-1/8"		10,000
12	Lines		3"	1,000		3"	1,000		3"	2,000
13	Lines		3"	1,000		3"	1,000		3"	2,000
14	Remote reading compound standpipe pressure gauge			3,000			5,000			10,000
15	Gas Separator		2'x5'			2'x5'			2'x5'	
16	Line		4"	1,000		4"	1,000		4"	2,000
17	Valves Gate <input type="checkbox"/> Plug <input type="checkbox"/> (2)	3-1/8"		3,000	3-1/8"		5,000	3-1/8"		10,000

(1) Only one required in Class 3M.

(2) Gate valves only shall be used for Class 10M.

(3) Remote operated hydraulic choke required on 5,000 psi and 10,000 psi for drilling.

EQUIPMENT SPECIFICATIONS AND INSTALLATION INSTRUCTIONS

- All connections in choke manifold shall be welded, studded, flanged or Cameron clamp of comparable rating.
- All flanges shall be API 6B or 6BX and ring gaskets shall be API RX or BX. Use only BX for 10 MWP.
- All lines shall be securely anchored.
- Chokes shall be equipped with tungsten carbide seats and needles, and replacements shall be available.
- Choke manifold pressure and standpipe pressure gauges shall be available at the choke manifold to assist in regulating chokes. As an alternate with automatic chokes, a choke manifold pressure gauge shall be located on the rig floor in conjunction with the standpipe pressure gauge.
- Line from drilling spool to choke manifold should be as straight as possible. Lines downstream from chokes shall make turns by large bends or 90° bends using butt plugged tees.
- Discharge lines from chokes, choke bypass and from top of gas separator should vent as far as practical from the well.