

UNITED STATES
DEPARTMENT OF THE INTERIOR
BUREAU OF LAND MANAGEMENT

SUBMIT IN TRIPLICATE *
OIL CONSERVATION DIV
815 S. 1ST ST
ARTESIA, NM 88210-2834

FORM APPROVED
OMB NO. 1004-0136
Expires: February 28, 1995

APPLICATION FOR PERMIT TO DRILL OR DEEPEN

LEASE DESIGNATION AND SERIAL NO.

LC-029418-A

6. IF INDIAN, ALLOTTEE OR TRIBE NAME

N/A

7. UNIT AGREEMENT NAME

Skelly Unit 17540

8. FARM OR LEASE NAME, WELL NO.

#201

9. API WELL NO.

30-015- 28947

10. FIELD AND POOL OR WILDCAT
Grayburg Jackson 7-Rivers ON-GB-SA

11. SEC., T., R., M., OR BLK.
AND SURVEY OR AREA

14, 17S-31E, N.M.P.M.

12. COUNTY FOR PARISH

Eddy

13. STATE

NM

17. NO. OF ACRES ASSIGNED
TO THIS WELL

40

20. ROTARY OR CABLE TOOLS

Rotary

22. APPROX. DATE WORK WILL START *

6-1-96

1a. TYPE OF WORK

DRILL

DEEPEN

b. TYPE OF WELL

OIL WELL

GAS WELL

OTHER

SINGLE ZONE

MULTIPLE ZONE

2. NAME OF OPERATOR

The Wiser Oil Company

3. ADDRESS AND TELEPHONE NO.

c/o J. O. Easley, Inc., P. O. Box 1796, Roswell, NM 88201-1796 (505) 623-3758

4. LOCATION OF WELL (Report location clearly and in accordance with any State requirements)

At Surface 1272' FSL & 45' FWL, Unit M

At proposed prod. Zone 1272' FSL & 45' FWL, Unit M

14. DISTANCE IN MILES AND DIRECTION FROM NEAREST TOWN OR POST OFFICE*

± 5 1/4 miles southwest of Maljamar, NM

15. DISTANCE FROM PROPOSED * LOCATION TO NEAREST

PROPERTY OR LEASE LINE, FT.

45'

(Also to nearest drlg. unit line, if any)

18. DISTANCE FROM PROPOSED LOCATION * TO NEAREST WELL, DRILLING, COMPLETED OR APPLIED FOR, ON THIS LEASE, FT.

860'

16. NO. OF ACRES IN LEASE

DIST. 2
640.00

19. PROPOSED DEPTH

4800'

21. ELEVATIONS (Show whether DF, RT, GR, etc.)

3882'

23. PROPOSED CASING AND CEMENTING PROGRAM

SIZE OF HOLE	GRADE, SIZE OF CASING	WEIGHT PER FOOT	SETTING DEPTH	QUANTITY OF CEMENT
12 1/4"	8 5/8" 8RD ST&C J-55	24#	550'	Circulate
7 7/8"	5 1/2" J-55	17#	4800'	Sufficient to bring cmt 100' above 8 5/8" casing shoe.

Duration of Program: Drilling - Nine (9) days
Completion - Thirty (30) days
See attached for complete Drilling Program

Non-Standard Location...

**... SUBJECT TO
LIKE APPROVAL
BY STATE**

EXHIBITS

- Exhibit "A": Drilling Program
- Exhibit "B": H₂S Plan
- Exhibit "C": Surface Use Plan
- Exhibit "D": Land Survey Plat
- Exhibit "E": Elevation & Location Plat
- Exhibit "F": Vicinity Plat
- Exhibit "G": Existing Well Plat
- Exhibit "H": Rig Layout
- Exhibit "I": BOP Layout

IN ABOVE SPACE DESCRIBE PROPOSED PROGRAM: If proposal is to deepen, give data on present productive zone and proposed new productive zone. If proposal is to drill or deepen directionally, give pertinent data on subsurface locations and measured and true vertical depths. Give blowout preventer program, if any.

24.

SIGNED

Michael R. Burch

TITLE Agent for The Wiser Oil Company

DATE 3-19-96

Michael R. Burch, CPL

(This space for Federal or State office use)

PERMIT NO.

APPROVAL DATE

*Post ID-1
5-3-96
New Loc & API*

Application approval does not warrant or certify that the applicant holds legal or equitable title to those rights in the subject lease which would entitle the applicant to conduct operations thereon.

CONDITIONS OF APPROVAL, IF ANY:

APPROVED (ORIG. SGD.) RICHARD L. MANUSILE

AREA MANAGER

DATE

APR 26 1996 *RE*

*See Instructions On Reverse Side

Title 18 U.S.C. Section 1001, makes it a crime for any person knowingly and willfully to make to any department or agency of the United States any false, fictitious or fraudulent statements or representations as to any matter within its jurisdiction.

**APPROVAL SUBJECT TO
GENERAL REQUIREMENTS AND
SPECIAL STIPULATIONS
ATTACHED**

DISTRICT I
 P. O. Box 1980
 Hobbs, NM 88241-1980

State of New Mexico
 Energy, Minerals, and Natural Resources Department

Form C-102
 Revised 02-10-94

Instructions on back

DISTRICT II
 P. O. Drawer DD
 Artesia, NM 88211-0719

EXHIBIT "D"

OIL CONSERVATION DIVISION
 P. O. Box 2088
 Santa Fe, New Mexico 87504-2088

Submit to the Appropriate
 District Office
 State Lease - 4 copies
 Fee Lease - 3 copies

DISTRICT III
 1000 Rio Brazos Rd.
 Aztec, NM 87410

DISTRICT IV
 P. O. Box 2088
 Santa Fe, NM 87507-2088

AMENDED REPORT

WELL LOCATION AND ACREAGE DEDICATION PLAT

1 API Number 30-015-28947		2 Pool Code Z8509		3 Pool Name Grayburg-Jackson (TRURS-QU-6B-SA)					
4 Property Code		5 Property Name SKELLY UNIT 'M'						6 Well Number 201	
7 OGRID No.		8 Operator Name THE WISER OIL COMPANY						9 Elevation 3882'	
10 SURFACE LOCATION									
UL or lot no. M	Section 14	Township 17 SOUTH	Range 31 EAST, N.M.P.M.	Lot Ida	Feet from the 1272'	North/South line SOUTH	Feet from the 45'	East/West line WEST	County EDDY
"BOTTOM HOLE LOCATION IF DIFFERENT FROM SURFACE"									
UL or lot no.	Section	Township	Range	Lot Ida	Feet from the	North/South line	Feet from the	East/West line	County
12 Dedicated Acres 40		13 Joint or Infill		14 Consolidation Code		15 Order No.			

NO ALLOWABLE WELL BE ASSIGNED TO THIS COMPLETION UNTIL ALL INTERESTS HAVE BEEN CONSOLIDATED OR A NON-STANDARD UNIT HAS BEEN APPROVED BY THE DIVISION

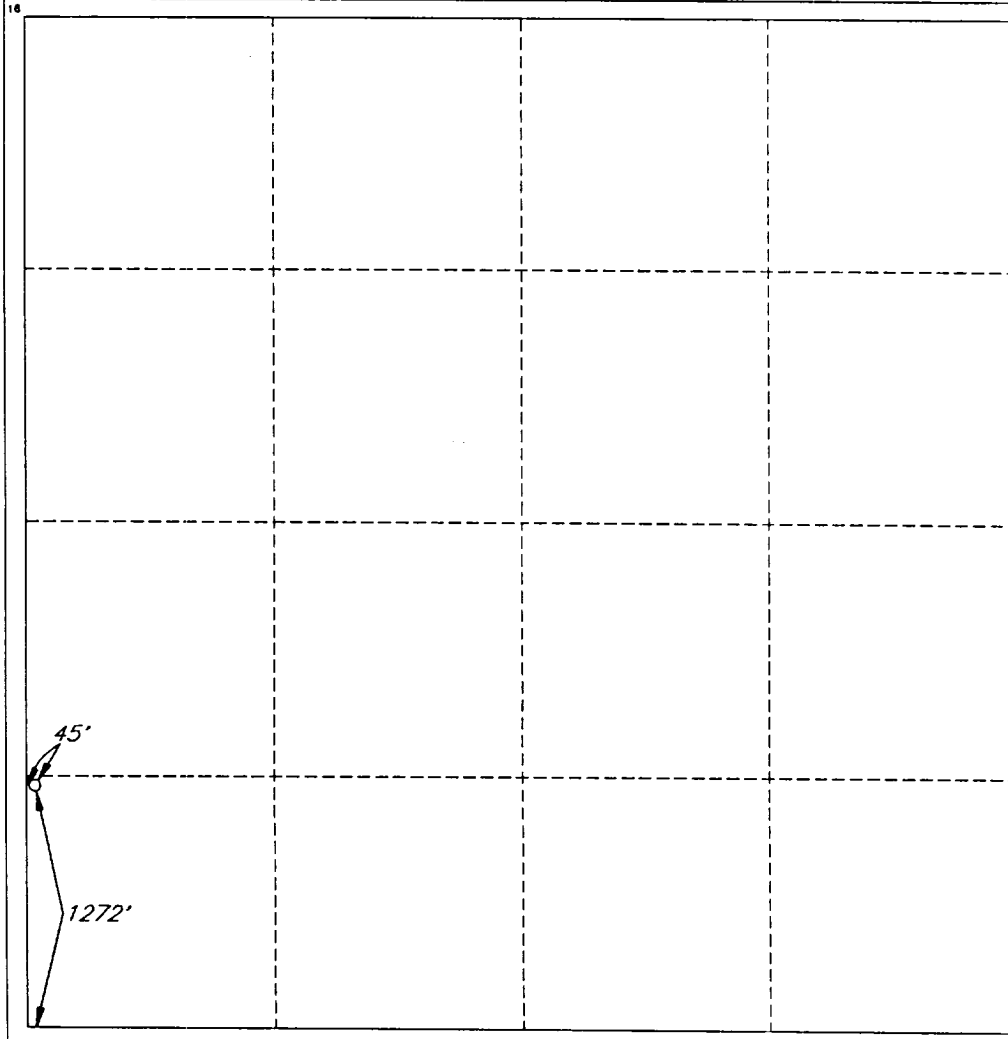

OPERATOR CERTIFICATION

I hereby certify that the information contained herein is true and complete to the best of my knowledge and belief.

Signature

Printed Name
 Michael R. Burch

Title Agent for
 The Wisier Oil Company

Date
 3-19-96

SURVEYOR CERTIFICATION

I hereby certify that the well location shown on this plat was plotted from field notes of actual surveys made by me or under my supervision, and that the same is true and correct to the best of my belief.

Date of Survey
 JANUARY 17, 1996

Signature and Seal of Professional Surveyor

Certification No.
 V. L. BEZNER, R.P.S. #7920
 JOB # 18382-12-96 SE / JSJ

The Wiser Oil Company
Skelly Unit #201

BOP & CHOKE MANIFOLD

12" / 9000 Cameron SS Space Saver
3000# Working Pressure
3000# Working Pressure Choke Manifold

