

UNITED STATES
DEPARTMENT OF THE INTERIOR
BUREAU OF LAND MANAGEMENT

SUBMIT IN TRIPLICATE *
OIL CONSERVATION DIV
811 S. 1ST ST.
ARTESIA, NM 88210-2834

FORM APPROVED
OMB NO. 1004-0136
Expires: February 28, 1995

4/5

APPLICATION FOR PERMIT TO DRILL OR DEEPEN

1a. TYPE OF WORK

DRILL ☒

DEEPEN ☐

b. TYPE OF WELL

OIL WELL ☒

GAS WELL ☐

OTHER ☐

SINGLE ZONE ☐

MULTIPLE ZONE ☐

2. NAME OF OPERATOR

The Wiser Oil Company

3. ADDRESS AND TELEPHONE NO.

c/o J. O. Easley, Inc., P. O. Box 1796, Roswell, NM 88201-1796 (505) 623-3758

4. LOCATION OF WELL (Report location clearly and in accordance with any State requirements. *)

At Surface 1310' FSL & 2546' FWL, Unit N

At proposed prod. Zone 1310' FSL & 2546' FWL, Unit N

14. DISTANCE IN MILES AND DIRECTION FROM NEAREST TOWN OR POST OFFICE *

± 5.8 miles southwest of Maljamar, NM

15. DISTANCE FROM PROPOSED * LOCATION TO NEAREST

PROPERTY OR LEASE LINE, FT. 1310'
(Also to nearest drlg. unit line, if any)

16. NO. OF ACRES IN LEASE

640.00

17. NO. OF ACRES ASSIGNED TO THIS WELL

40

18. DISTANCE FROM PROPOSED LOCATION * TO NEAREST WELL, DRILLING, COMPLETED OR APPLIED FOR, ON THIS LEASE, FT.

808'

19. PROPOSED DEPTH

4800'

20. ROTARY OR CABLE TOOLS

Rotary

21. ELEVATIONS (Show whether DF, RT, GR, etc.)

3862'

Roswell Controlled Water Basin

22. APPROX. DATE WORK WILL START *

6-1-96

23.

PROPOSED CASING AND CEMENTING PROGRAM

SIZE OF HOLE	GRADE, SIZE OF CASING	WEIGHT PER FOOT	SETTING DEPTH	QUANTITY OF CEMENT
12 1/4"	8 5/8" 8RD ST&C J-55	24#	550'	Circulate
7 7/8"	5 1/2" J-55	17#	4800'	Sufficient to bring cmt 100' above 8 5/8" casing shoe.

Duration of Program: Drilling - Nine (9) days

Completion - Thirty (30) days

See attached for complete Drilling Program

EXHIBITS

Exhibit "A": Drilling Program

Exhibit "D": Land Survey Plat

Exhibit "G": Rig Layout

Exhibit "B": H₂S Plan

Exhibit "E": Vicinity Plat

Exhibit "H": BOP Layout

Exhibit "C": Surface Use Plan

Exhibit "F": Existing Well Plat

IN ABOVE SPACE DESCRIBE PROPOSED PROGRAM: If proposal is to deepen, give data on present productive zone and proposed new productive zone. If proposal is to drill or deepen directionally, give pertinent data on subsurface locations and measured and true vertical depths. Give blowout preventer program, if any.

24.

SIGNED

Michael R. Burch

TITLE

Agent for The Wiser Oil Company

DATE

4-5-96

Michael R. Burch, CPL

(This space for Federal or State office use)

PERMIT NO.

APPROVAL DATE

Application approval does not warrant or certify that the applicant holds legal or equitable title to those rights in the subject lease which would entitle the applicant to conduct operations thereon.

CONDITIONS OF APPROVAL, IF ANY:

APPROVED BY

Timothy P. O'Brien

TITLE

ACTING AREA MANAGER

DATE

5-9-96

*See Instructions On Reverse Side

Title 18 U.S.C. Section 1001, makes it a crime for any person knowingly and willfully to make to any department or agency of the United States any false, fictitious or fraudulent statements or representations as to any matter within its jurisdiction.



.

EXHIBIT "D"

District I
PO Box 1980, Hobbs, NM 88241-1980
District II
PO Drawer DD, Artesia, NM 88211-0719
District III
1000 Rio Brazos Rd., Aztec, NM 87410
District IV
PO Box 2088, Santa Fe, NM 87504-2088

State of New Mexico
Energy, Minerals & Natural Resources Department

OIL CONSERVATION DIVISION
PO Box 2088
Santa Fe, NM 87504-2088

Form C-102

Revised February 10, 1994

Instructions on back

Submit to Appropriate District Office

State Lease - 4 Copies

Fee Lease - 3 Copies

☐ AMENDED REPORT

WELL LOCATION AND ACREAGE DEDICATION PLAT

API Number 30-015- 28972		Pool Code 28509	Pool Name Grayburg Jackson 7-Rivers QN GB SA
Property Code 017540	Property Name Skelly Unit		Well Number 199
OGRID No. 022922	Operator Name The Wiser Oil Company		Elevation 3862

¹⁰ Surface Location

UL or lot no.	Section	Township	Range	Lot Ida	Feet from the	North/South line	Feet from the	East/West line	County
N	15	17 S	31 E		1310	South	2546	West	Eddy

¹¹ Bottom Hole Location If Different From Surface

UL or lot no.	Section	Township	Range	Lot Ida	Feet from the	North/South line	Feet from the	East/West line	County

¹² Dedicated Acres 40	¹³ Joint or Infill	¹⁴ Consolidation Code	¹⁵ Order No.
-------------------------------------	-------------------------------	----------------------------------	-------------------------

NO ALLOWABLE WILL BE ASSIGNED TO THIS COMPLETION UNTIL ALL INTERESTS HAVE BEEN CONSOLIDATED
OR A NON-STANDARD UNIT HAS BEEN APPROVED BY THE DIVISION

16				¹⁷ OPERATOR CERTIFICATION I hereby certify that the information contained herein is true and complete to the best of my knowledge and belief.  Signature Michael R. Burch, CPL Printed Name Agent for The Wiser Oil Company Title 4-5-96 Date
				¹⁸ SURVEYOR CERTIFICATION I hereby certify that the well location shown on this plat was plotted from field notes of actual surveys made by me or under my supervision, and that the same is true and correct to the best of my belief. March 27, 1996 Date of Survey W. Patton Signature and Seal of Professional Surveyor:  Certificate 8112

Diagram showing well location and acreage: A well is located at the intersection of a 2546' line and a 1310' line. The well is 3862.5' from the top-left corner, 3862.6' from the top-right corner, 3857.9' from the bottom-left corner, and 3852.4' from the bottom-right corner.

BOP & CHOKE MANIFOLD

12" / 900 Cameron SS Space Saver
3000# Working Pressure
3000# Working Pressure Choke Manifold

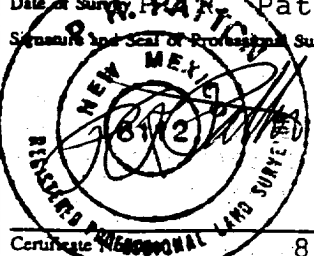
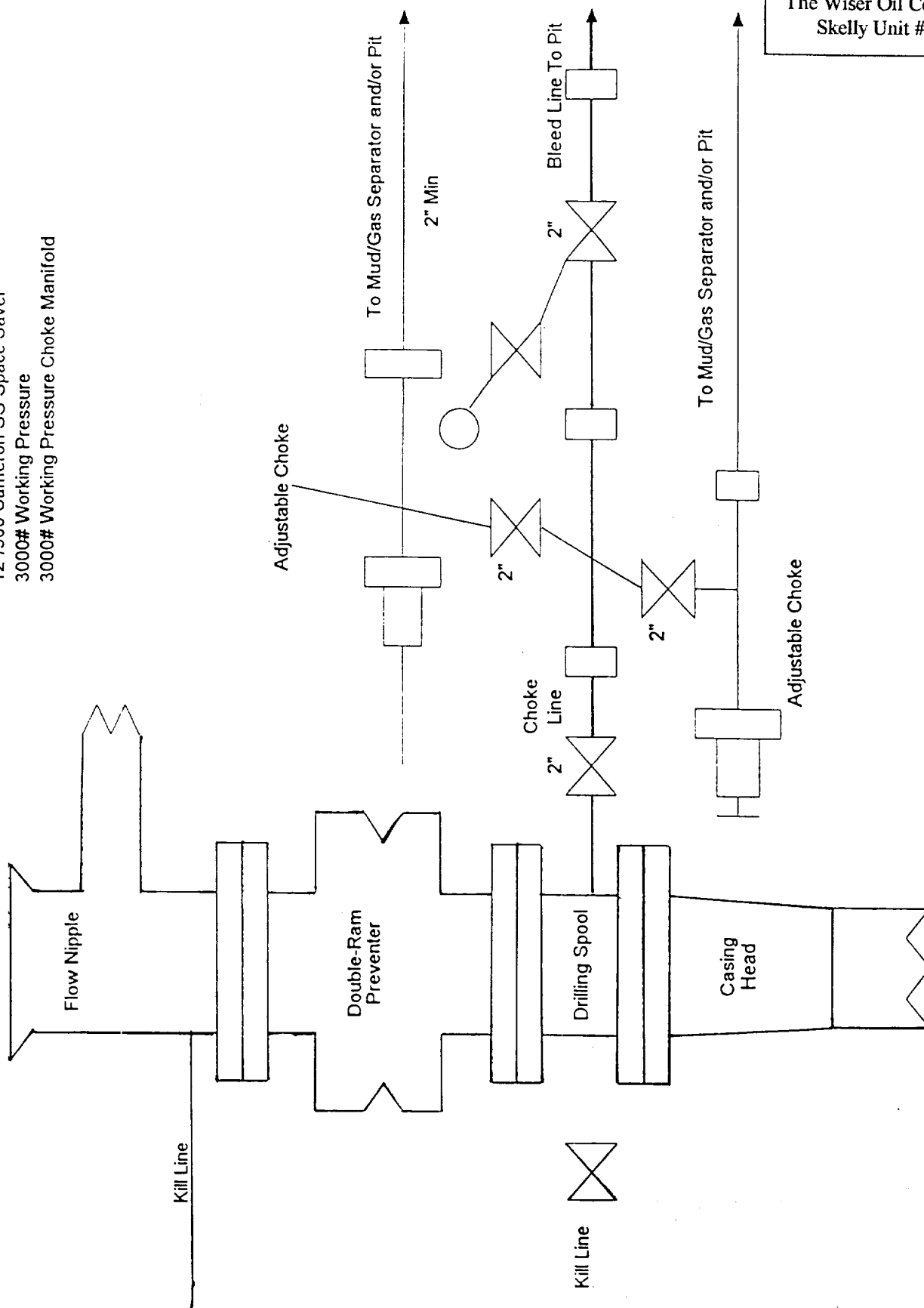

EXHIBIT "H"

BOP LAYOUT

The Wiser Oil Company
Skelly Unit #199

