

UNITED STATES
DEPARTMENT OF THE INTERIOR
BUREAU OF LAND MANAGEMENT

SUBMIT IN TRIPPLICATE *
ON CONSERVATION DIV
811'S-1st
ARTESIA, NM 88210-2834

FORM APPROVED
OMB NO. 1004-0136
Expires: February 28, 1995

APPLICATION FOR PERMIT TO DRILL OR DEEPEN

1a. TYPE OF WORK

DRILL ☒

DEEPEN ☐

b. TYPE OF WELL

OIL
WELL ☒

GAS
WELL ☐

OTHER ☐

SINGLE
ZONE ☐

MULTIPLE
ZONE ☐

2. NAME OF OPERATOR

The Wiser Oil Company

3. ADDRESS AND TELEPHONE NO.

c/o J. O. Easley, Inc., P. O. Box 1796, Roswell, NM 88201-1796 (505) 623-3758

4. LOCATION OF WELL (Report location clearly and in accordance with any State requirements.)

At Surface 1357' FNL & 2580' FEL, Unit G

At proposed prod. Zone 1357' FNL & 2580' FEL, Unit G

14. DISTANCE IN MILES AND DIRECTION FROM NEAREST TOWN OR POST OFFICE*

± 6 miles southwest of Maljamar, NM

15. DISTANCE FROM PROPOSED *

LOCATION TO NEAREST

PROPERTY OR LEASE LINE, FT.

1357'

(Also to nearest drlg. unit line, if any)

18. DISTANCE FROM PROPOSED LOCATION *

TO NEAREST WELL, DRILLING, COMPLETED

864'

OR APPLIED FOR, ON THIS LEASE, FT.

21. ELEVATIONS (Show whether DF, RT, GR, etc.)

3849'

23.

PROPOSED CASING AND CEMENTING PROGRAM

SIZE OF HOLE	GRADE, SIZE OF CASING	WEIGHT PER FOOT	SETTING DEPTH	QUANTITY OF CEMENT
12 1/4"	8 5/8" 8RD ST&C J-55	24#	550'	Circulate
7 7/8"	5 1/2" J-55	17#	4800'	Sufficient to bring cmt 100'
				above 8 5/8" casing shoe.

Duration of Program: Drilling - Nine (9) days

Completion - Thirty (30) days

See attached for complete Drilling Program

EXHIBITS

Exhibit "A": Drilling Program

Exhibit "D": Land Survey Plat

Exhibit "G": Rig Layout

Exhibit "B": H₂S Plan

Exhibit "E": Vicinity Plat

Exhibit "H": BOP Layout

Exhibit "C": Surface Use Plan

Exhibit "F": Existing Well Plat

IN ABOVE SPACE DESCRIBE PROPOSED PROGRAM: If proposal is to deepen, give data on present productive zone and proposed new productive zone. If proposal is to drill or deepen directionally, give pertinent data on subsurface locations and measured and true vertical depths. Give blowout preventer program, if any.

24.

SIGNED

Michael R. Burch

TITLE Agent for The Wiser Oil Company

DATE

4-8-96

Michael R. Burch, CPL

(This space for Federal or State office use)

PERMIT NO.

APPROVAL DATE

5-17-96
New Loc 4 API

Application approval does not warrant or certify that the applicant holds legal or equitable title to those rights in the subject lease which would entitle the applicant to conduct operations thereon.

CONDITIONS OF APPROVAL, IF ANY:

APPROVED BY

Timothy P. O'Brien

TITLE

ACTING AREA MANAGER

DATE

5-9-96

*See Instructions On Reverse Side

Title 18 U.S.C. Section 1001, makes it a crime for any person knowingly and willfully to make to any department or agency of the United States any false, fictitious or fraudulent statements or representations as to any matter within its jurisdiction.

APPROVAL SUBJECT TO
GENERAL REQUIREMENTS AND
SPECIAL STIPULATIONS
ATTACHED

EXHIBIT "D"

District I
PO Box 1980, Hobbs, NM 88241-1980
District II
PO Drawer DD, Artesia, NM 88211-0719
District III
1000 Rio Brazos Rd., Aztec, NM 87410
District IV
PO Box 2088, Santa Fe, NM 87504-2088

State of New Mexico
Energy, Minerals & Natural Resources Department

OIL CONSERVATION DIVISION PO Box 2088 Santa Fe, NM 87504-2088

Form C-102
Revised February 10, 1994
Instructions on back
Submit to Appropriate District Office
State Lease - 4 Copies
Fee Lease - 3 Copies

☐ AMENDED REPORT

WELL LOCATION AND ACREAGE DEDICATION PLAT

1 AFI Number 30-015- 28973		2 Pool Code 28509		3 Pool Name Grayburg Jackson 7-Rivers QN GB SA	
4 Property Code 017540		5 Property Name Skelly Unit			6 Well Number 225
7 OGRID No. 022922		8 Operator Name The Wiser Oil Company			9 Elevation 3849

10 Surface Location

UL or lot no.	Section	Township	Range	Lot Idn	Feet from the	North/South line	Feet from the	East/West line	County
G	22	17 S	31 E		1357	North	2580	East	Eddy

11 Bottom Hole Location If Different From Surface

UL or lot no.	Section	Township	Range	Lot Idn	Feet from the	North/South line	Feet from the	East/West line	County

12 Dedicated Acres 40	13 Joint or Infill	14 Consolidation Code	15 Order No.
--------------------------	--------------------	-----------------------	--------------

NO ALLOWABLE WILL BE ASSIGNED TO THIS COMPLETION UNTIL ALL INTERESTS HAVE BEEN CONSOLIDATED
OR A NON-STANDARD UNIT HAS BEEN APPROVED BY THE DIVISION

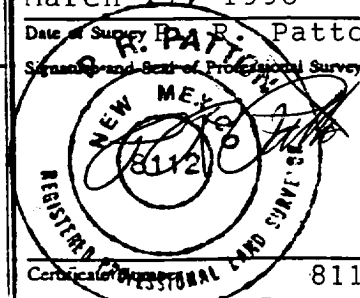
<div style="position: relative; height: 400px;"> <div style="position: absolute; left: 100px; top: 100px;">16</div> <div style="position: absolute; left: 250px; top: 150px;">3848.0</div> <div style="position: absolute; left: 400px; top: 150px;">3853.8</div> <div style="position: absolute; left: 250px; top: 250px;">3847.4</div> <div style="position: absolute; left: 400px; top: 250px;">3852.9</div> <div style="position: absolute; left: 550px; top: 200px;">2580</div> <div style="position: absolute; left: 350px; top: 100px; transform: rotate(-90deg);">1357</div> <div style="position: absolute; left: 350px; top: 200px;"> <div style="border: 1px solid black; width: 20px; height: 20px; display: flex; align-items: center; justify-content: center;"> <div style="width: 5px; height: 5px; border-radius: 50%; background-color: black;"></div> </div> </div> </div>	<h4>17 OPERATOR CERTIFICATION</h4> <p>I hereby certify that the information contained herein is true and complete to the best of my knowledge and belief.</p> <div style="border: 1px solid black; padding: 5px; margin-top: 10px;"> <p style="font-family: cursive; font-size: 1.2em;">Michael R. Burch</p> <p>Signature Michael R. Burch, CPL</p> <p>Printed Name Agent for The Wiser Oil Company</p> <p>Title</p> <p style="text-align: center;">4-8-96</p> <p>Date</p> </div>	
	<h4>18 SURVEYOR CERTIFICATION</h4> <p>I hereby certify that the well location shown on this plat was plotted from field notes of actual surveys made by me or under my supervision, and that the same is true and correct to the best of my belief.</p> <p style="text-align: center;">March 27, 1996</p> <p>Date of Survey R. Patton</p> <p>Signature and Seal of Professional Surveyor.</p> <div style="text-align: center;">  </div> <p style="text-align: right;">8112</p>	

BOP & CHOKE MANIFOLD

12" / 900 Cameron SS Space Saver
 3000# Working Pressure
 3000# Working Pressure Choke Manifold

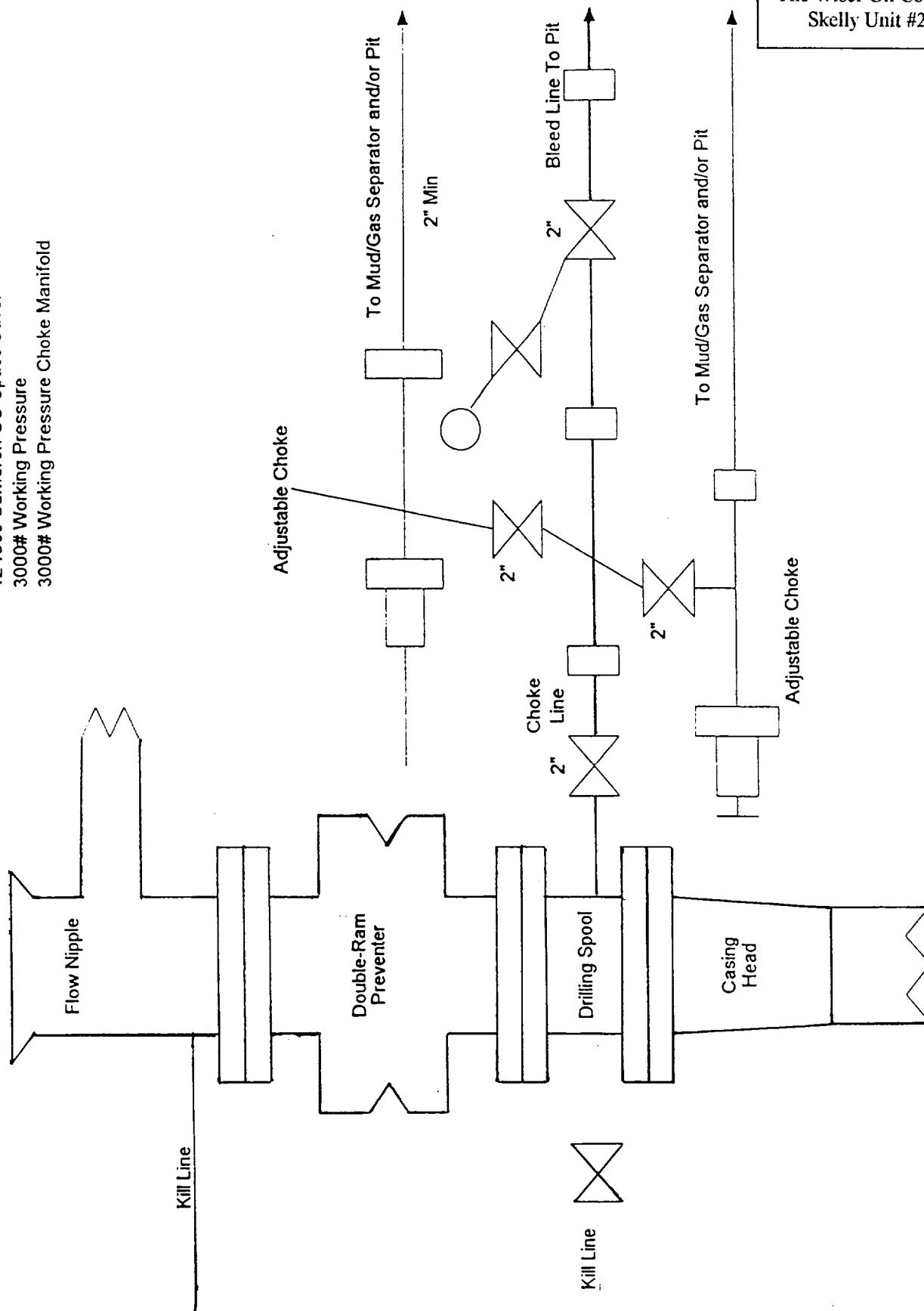

EXHIBIT "H"

BOP LAYOUT

The Wiser Oil Company
 Skelly Unit #225