

UNITED STATES
DEPARTMENT OF THE INTERIOR
BUREAU OF LAND MANAGEMENT

SUBMIT IN TRIPLICATE*
OIL CONSERVATION DIV
817 S. 1ST ST.
ARTESIA, NM 88210

Form approved.

1/5/96

APPLICATION FOR PERMIT TO DRILL OR DEEPEN

1a TYPE OF WORK: DRILL ☒ DEEPEN ☐

b TYPE OF WELL:

OIL WELL ☒ GAS WELL ☐ Other ☐ SINGLE ZONE ☐ MULTIPLE ZONE ☐

2 NAME OF OPERATOR

DEVON ENERGY OPERATING CORPORATION

136025

3 ADDRESS AND TELEPHONE NO.

20 N. BROADWAY, SUITE 1500, OKC, OK 73102 (405) 552-4560

4 LOCATION OF WELL (Report location clearly and in accordance with any State requirements)*

At surface 660' FSL & 1880' FEL

560'

At top proposed prod. zone (SAME)

14. DISTANCE IN MILES AND DIRECTION FROM NEAREST TOWN OR POST OFFICE*

5 miles East & 1 mile North of Loco Hills, N.M.

15. DISTANCE FROM PROPOSED LOCATION TO NEAREST

PROPERTY OR LEASE LINE, FT. 1880'

(Also to nearest drlg. unit line if any)

18. DISTANCE FROM PROPOSED LOCATION*

TO NEAREST WELL, DRILLING, COMPLETED,

OR APPLIED FOR, ON THIS LEASE, FT. 500'

21. ELEVATIONS (Show whether DF, RT, GR, etc.)

3689

16. NO. OF ACRES IN LEASE

609.43

17. NO. OF ACRES ASSIGNED TO THIS WELL

40

19. PROPOSED DEPTH

4200'

20. ROTARY OR CABLE TOOLS*

Rotary

22. APPROX. DATE WORK WILL START*

May 15, 1996

23. PROPOSED CASING AND CEMENTING PROGRAM

SIZE OF HOLE	GRADE, SIZE OF CASING	WEIGHT PER FOOT	SETTING DEPTH	QUANTITY OF CEMENT
12 1/4"	8 5/8" J-55	24.0#	450'	125 sk Lite cmt + 200 sk Class "C"
7 7/8"	5 1/2" J-55	15.5#	4200'	550 sk Lite cmt + 425 sk Class "H"

We plan to circulate cement to surface on all casing strings. Devon Energy Operating Corporation proposes to drill to 4200' to test the Grayburg-Jackson formation for commercial quantities of oil. If the Grayburg-Jackson is deemed non-commercial, the wellbore will be plugged and abandoned per Federal Regulations. Programs to adhere to onshore oil and gas regulations are outlined in the following exhibits and attachments.

Drilling Program

Exhibits #1/1-A = Blowout Prevention Equipment

Exhibit #2 = Location and Elevation Plat

Exhibit #3/3-A = Road Map and Topo Map

Exhibit #4 = Wells Within 1 Mile Radius

Exhibit #5 = Production Facilities Plat

Exhibit #6 = Rotary Rig Layout

Exhibit #7 = Casing Design

H2S Operating Plan

Approval Subject to
General Requirements and
Special Stipulations
Attached

The undersigned accepts all applicable terms, condition, stipulations and restrictions concerning operations conducted on the leased land or portions thereof, as described below:

Lease No. LC029395-A

Legal Description: Section 18-T17S-R31E

Bond Coverage: Statewide in CO, NM, UT, & WY

BLM Bond No.: CO1151

Post ID-1
6-14-96
New Loc & ART

IN ABOVE SPACE DESCRIBE PROPOSED PROGRAM: If proposal is to deepen, give data on present productive zone and proposed new productive zone. If proposal is to drill or deepen directionally, give pertinent data on subsurface locations and measured and true vertical depths. Give blowout preventer program, if any.

24.

SIGNED

Randy Jackson

RANDY JACKSON
TITLE DISTRICT ENGINEER

DATE

4/14/96

*(This space for Federal or State office use)

PERMIT NO.

APPROVAL DATE

Application approval does not warrant or certify that the applicant holds legal or equitable title to those rights in the subject lease which would entitle the applicant to conduct operations thereon. CONDITIONS OF APPROVAL, IF ANY:

APPROVED BY

Timothy P. O'Brien

TITLE

Acting Area Manager

DATE

5-16-96

See Instructions On Reverse Side

DISTRICT I
P. O. Box 1980
Hobbs, NM 88241-1980

State of New Mexico
Energy Minerals, and Natural Resources Department

Form C-102
Revised 02-10-94
Instructions on back

DISTRICT II
P. O. Drawer DD
Artesia, NM 88211-0719

OIL CONSERVATION DIVISION

P. O. Box 2088
Santa Fe, New Mexico 87504-2088

Submit to the Appropriate
District Office
State Lease - 4 copies
Fee Lease - 3 copies

DISTRICT III
1000 Rio Brazos Rd.
Aztec, NM 87410

☐ AMENDED REPORT

DISTRICT IV
P. O. Box 2088
Santa Fe, NM 87507-2088

WELL LOCATION AND ACREAGE DEDICATION PLAT

1 API Number 30-015-29001		2 Pool Code 28509		3 Pool Name Grayburg Jackson (SR, Q, GB, SA)		
4 Property Code 16001		5 Property Name TURNER A			6 Well Number 58	
7 OGRID No. 136025		8 Operator Name DEVON ENERGY OPERATING CORP.			9 Elevation 3687'	

" SURFACE LOCATION

UL or lot no.	Section	Township	Range	Lot Ida	Feet from the	North/South line	Feet from the	East/West line	County
0	18	17 SOUTH	31 EAST, N.M.P.M.		560'	SOUTH	1880'	EAST	EDDY

" BOTTOM HOLE LOCATION IF DIFFERENT FROM SURFACE

UL or lot no.	Section	Township	Range	Lot Ida	Feet from the	North/South line	Feet from the	East/West line	County

12 Dedicated Acres 40	13 Joint or Infill	14 Consolidation Code	15 Order No.
--------------------------	--------------------	-----------------------	--------------

NO ALLOWABLE WELL BE ASSIGNED TO THIS COMPLETION UNTIL ALL INTERESTS HAVE BEEN
CONSOLIDATED OR A NON-STANDARD UNIT HAS BEEN APPROVED BY THE DIVISION

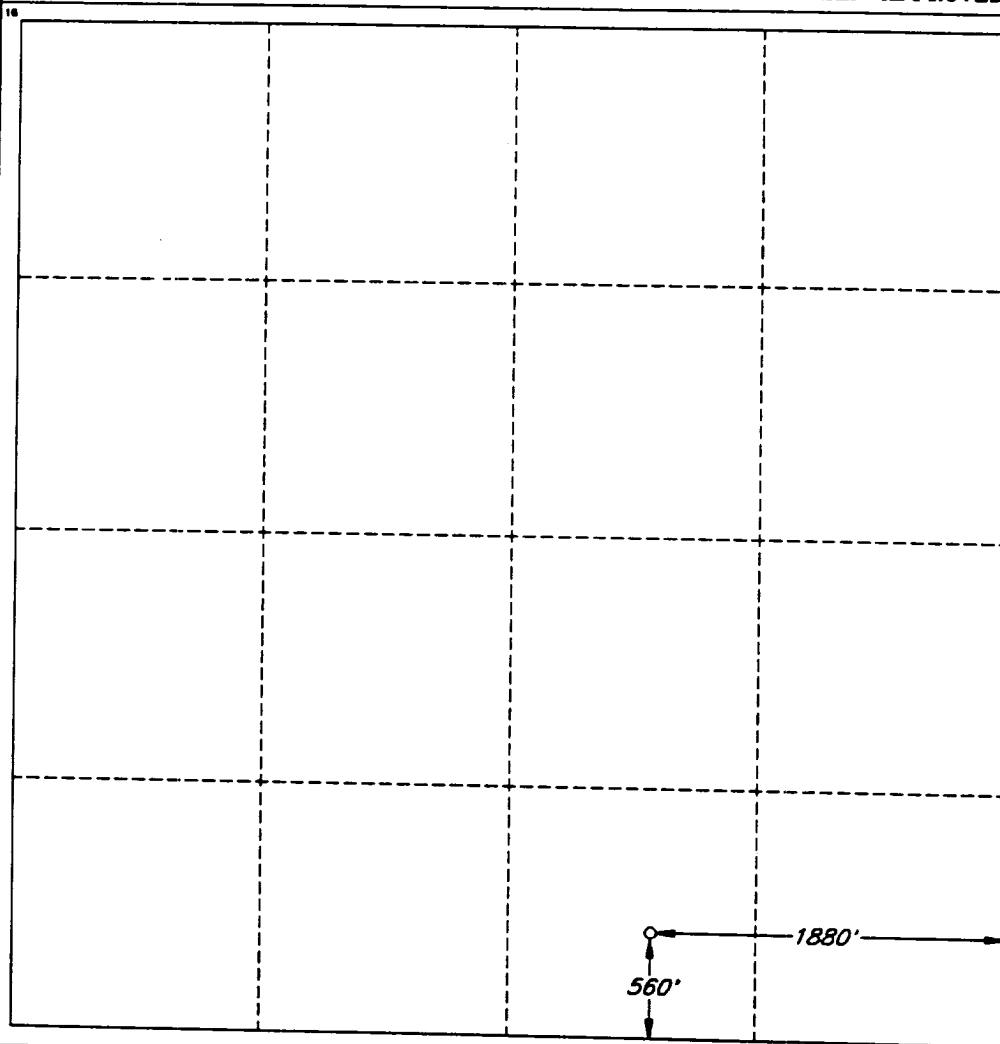

OPERATOR CERTIFICATION

I hereby certify that the information
contained herein is true and complete
to the best of my knowledge and belief.

Signature <i>Randy Jackson</i>
Printed Name Randy Jackson
Title District Engineer
Date May 3, 1996

SURVEYOR CERTIFICATION

I hereby certify that the well
location shown on this plat was
plotted from field notes of actual
surveys made by me or under
my supervision, and that the
same is true and correct to the
best of my belief.

Date of Survey APRIL 15, 1996
Signature of State Professional Surveyor <i>V. Lynn Bezner</i>
State of New Mexico V. LYNN BEZNER NO. 7920 V. L. BEZNER LAND SURVEYOR #7920
JOB #45004-30 SW / JSJ

UNITED STATES
DEPARTMENT OF THE INTERIOR
BUREAU OF LAND MANAGEMENT

FORM APPROVED
Budget Bureau No. 1004-0135
Expires March 31, 1993

SUNDRY NOTICES AND REPORTS ON WELLS

Do not use this form for proposals to drill or to deepen or reentry to a different reservoir.
Use "APPLICATION FOR PERMIT—" for such proposals

SUBMIT IN TRIPLICATE

1. Type of Well <input checked="" type="checkbox"/> Oil Well <input type="checkbox"/> Gas Well <input type="checkbox"/> Other
2. Name of Operator DEVON ENERGY OPERATING CORPORATION
3. Address and Telephone No. 20 NORTH BROADWAY, SUITE 1500, OKLAHOMA CITY, OKLAHOMA 73102 (405)552-4527
4. Location of Well (Footage, Sec., T., R., M., or Survey Description) 560' FSL & 1880' FEL, Unit O, Sec. 18-17S-31E

5. Lease Designation and Serial No. LC-029395-A
6. If Indian, Allottee or Tribe Name N/A
7. If Unit or CA, Agreement Designation N/A
8. Well Name and No. Turner A #58
9. API Well No. 30-015-
10. Field and Pool, or Exploratory Area Grayburg Jackson
11. County or Parish, State Eddy County, NM

CHECK APPROPRIATE BOX(S) TO INDICATE NATURE OF NOTICE, REPORT, OR OTHER DATA

TYPE OF SUBMISSION	TYPE OF ACTION
<input type="checkbox"/> Notice of Intent	<input type="checkbox"/> Abandonment
<input checked="" type="checkbox"/> Subsequent Report	<input type="checkbox"/> Recompletion
<input type="checkbox"/> Final Abandonment Notice	<input type="checkbox"/> Plugging Back
	<input type="checkbox"/> Casing Repair
	<input type="checkbox"/> Altering Casing
	<input checked="" type="checkbox"/> Other <u>Change location</u>
	<input type="checkbox"/> Change of Plans
	<input type="checkbox"/> New Construction
	<input type="checkbox"/> Non-Routine Fracturing
	<input type="checkbox"/> Water Shut-Off
	<input type="checkbox"/> Conversion to Injection
	<input type="checkbox"/> Dispose Water

(Note: Report results of multiple completion on Well Completion or Recompletion Report and Log form.)

13. Describe Proposed or Completed Operations (Clearly state all pertinent details, and give pertinent dates, including estimated date of starting any proposed work. If well is directionally drilled, give subsurface locations and measured and true vertical depths for all markers and zones pertinent to this work.)*

The proposed well location has been moved 100' South

from: 660' FSL & 1880' FEL

to: 560' FSL & 1880' FEL

Attached is a plat reflecting the move.

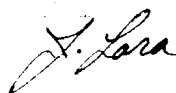

14. I hereby certify that the foregoing is true and correct

Signed Karen Byers
(This space for Federal or State office use)

Title KAREN BYERS
ENGINEERING TECHNICIAN

Date 5/3/96

Approved by _____
Conditions of approval, if any: _____

Title _____

Date _____

UNITED STATES
DEPARTMENT OF THE INTERIOR
BUREAU OF LAND MANAGEMENT

OIL CONSERVATION DIV
11 S. 1st ST.
ARTESIA, NM 88210-2834

FORM APPROVED
Budget Bureau No. 1004-0135
Expires March 31, 1993

SUNDRY NOTICES AND REPORTS ON WELLS

Do not use this form for proposals to drill or to deepen or reentry to a different reservoir.
Use "APPLICATION FOR PERMIT—" for such proposals

SUBMIT IN TRIPLICATE

1. Type of Well <input checked="" type="checkbox"/> Oil Well <input type="checkbox"/> Gas Well <input type="checkbox"/> Other
2. Name of Operator DEVON ENERGY OPERATING CORPORATION
3. Address and Telephone No. 20 NORTH BROADWAY, SUITE 1500, OKLAHOMA CITY, OKLAHOMA 73102 (405)552-4527
4. Location of Well (Footage, Sec., T., R., M., or Survey Description) 660' FSL & 1880' FEL, Sec. 18-17S-31E <i>560'</i>

5. Lease Designation and Serial No. LC-029395-A
6. If Indian, Allottee or Tribe Name N/A
7. If Unit or C.A. Agreement Designation N/A
8. Well Name and No. Turner A #8Y
9. API Well No. 30-015-
10. Field and Pool, or Exploratory Area Grayburg Jackson
11. County or Parish, State Eddy County, NM

CHECK APPROPRIATE BOX(S) TO INDICATE NATURE OF NOTICE, REPORT, OR OTHER DATA

TYPE OF SUBMISSION	TYPE OF ACTION
<input type="checkbox"/> Notice of Intent	<input type="checkbox"/> Abandonment
<input checked="" type="checkbox"/> Subsequent Report	<input type="checkbox"/> Recompletion
<input type="checkbox"/> Final Abandonment Notice	<input type="checkbox"/> Plugging Back
	<input type="checkbox"/> Casing Repair
	<input type="checkbox"/> Altering Casing
	<input checked="" type="checkbox"/> Other <u>Change name</u>
	<input type="checkbox"/> Change of Plans
	<input type="checkbox"/> New Construction
	<input type="checkbox"/> Non-Routine Fracturing
	<input type="checkbox"/> Water Shut-Off
	<input type="checkbox"/> Conversion to Injection
	<input type="checkbox"/> Dispose Water

(Note: Report results of multiple completion on Well Completion or Recompletion Report and Log form.)

13. Describe Proposed or Completed Operations (Clearly state all pertinent details, and give pertinent dates, including estimated date of starting any proposed work. If well is directionally drilled, give subsurface locations and measured and true vertical depths for all markers and zones pertinent to this work.)*

The proposed well name has been changed

from: Turner A #8Y

to: Turner A #58

J. Lara

14. I hereby certify that the foregoing is true and correct

Signed Karen Byers
(This space for Federal or State office use)

KAREN BYERS
ENGINEERING TECHNICIAN
Title

Date 5/1/96

Approved by _____
Conditions of approval, if any:

Title _____

Date _____

UNITED STATES
DEPARTMENT OF THE INTERIOR
BUREAU OF LAND MANAGEMENT

CONSERVATION DIV
811 S. 1st ST.
ARTESIA, NM 88210-2834
FORM APPROVED
Budget Bureau No. 1004-0135
Expires March 31, 1993

SUNDRY NOTICES AND REPORTS ON WELLS

Do not use this form for proposals to drill or to deepen or reentry to a different reservoir.
Use "APPLICATION FOR PERMIT—" for such proposals

SUBMIT IN TRIPLICATE

1. Type of Well
☐ Oil Well ☐ Gas Well ☒ Other WIW

2. Name of Operator
DEVON ENERGY CORPORATION (NEVADA)

3. Address and Telephone No.
20 NORTH BROADWAY, SUITE 1500, OKLAHOMA CITY, OKLAHOMA 73102 (405) 235-3611

4. Location of Well (Footage, Sec., T., R., M., or Survey Description)
560' FSL & 1880' FEL of Section 18-T17S-R31E

5. Lease Designation and Serial No.

LC-029395A

6. If Indian, Allottee or Tribe Name

7. If Unit or CA. Agreement Designation

8. Well Name and No.

Turner "A" #58

9. API Well No.

10. Field and Pool, or Exploratory Area

Grayburg-Jackson Field

11. County or Parish, State

Eddy County, NM

CHECK APPROPRIATE BOX(s) TO INDICATE NATURE OF NOTICE, REPORT, OR OTHER DATA

TYPE OF SUBMISSION

TYPE OF ACTION

☒ Notice of Intent

☐ Subsequent Report

☐ Final Abandonment Notice

☐ Abandonment

☐ Recompletion

☐ Plugging Back

☐ Casing Repair

☐ Altering Casing

☒ Other Drill & Complete WIW

☐ Change of Plans

☐ New Construction

☐ Non-Routine Fracturing

☐ Water Shut-Off

☐ Conversion to Injection

☐ Dispose Water

(Note: Report results of multiple completion on Well Completion or Recompletion Report and Log form.)

13. Describe Proposed or Completed Operations (Clearly state all pertinent details, and give pertinent dates, including estimated date of starting any proposed work. If well is directionally drilled, give subsurface locations and measured and true vertical depths for all markers and zones pertinent to this work.)*

Drill and complete a water injection well as follows:

1. Set 8 5/8" 24# J-55 LT&C surface casing at 420'. Cement to surface.
2. Set 5 1/2" 15.5# J-55 LT&C production casing at 3800'. Cement to surface.
3. Selectively perforate the interval 2650' - 3600'(OA).
4. RIH with Baker AD-1 packer on 2 3/8"(IPC) tubing and set at +2600'.
5. Inject through perforations 2650' - 3600'(OA).

14. I hereby certify that the foregoing is true and correct

Signed Randy Jackson

Randy Jackson

Title District Engineer

Date 5/7/96

(This space for Federal or State office use)

Approved by _____
Conditions of approval, if any:

Title _____

Date _____