

UNITED STATES
DEPARTMENT OF THE INTERIOR
BUREAU OF LAND MANAGEMENT

APPLICATION FOR PERMIT TO DRILL OR DEEPEN

1a. TYPE OF WORK DRILL <input checked="" type="checkbox"/> DEEPEN <input type="checkbox"/>		5. LEASE DESIGNATION AND SERIAL NO. LC-029418-B	
b. TYPE OF WELL OIL WELL <input checked="" type="checkbox"/> GAS WELL <input type="checkbox"/> OTHER <input type="checkbox"/> SINGLE ZONE <input type="checkbox"/> MULTIPLE ZONE <input type="checkbox"/>		6. IF INDIAN, ALLOTTEE OR TRIBE NAME N/A	
2. NAME OF OPERATOR The Wiser Oil Company (22922)		7. UNIT AGREEMENT NAME Skelly Unit (17540)	
3. ADDRESS AND TELEPHONE NO. c/o J. O. Easley, Inc., P. O. Box 1796, Roswell, NM 88201-1796 (505) 623-3758		8. FARM OR LEASE NAME, WELL NO. #267	
4. LOCATION OF WELL (Report location clearly and in accordance with any State requirements.)* At Surface 35' FSL & 1285' FWL, Unit M UNORTH. LOC. At proposed prod. Zone 35' FSL & 1285' FWL, Unit M		9. API WELL NO. 30-015- 29224	
11. SEC., T., R., M., OR BLK. AND SURVEY OR AREA 23, 17S-31E, N.M.P.M.		10. FIELD AND POOL OR WILDCAT Grayburg Jackson 7-Rivers-QN-GB-SA (28509)	
14. DISTANCE IN MILES AND DIRECTION FROM NEAREST TOWN OR POST OFFICE* ± 5.8 miles southwest of Maljamar, NM		12. COUNTY FOR PARISH Eddy	
15. DISTANCE FROM PROPOSED * LOCATION TO NEAREST PROPERTY OR LEASE LINE, FT. (Also to nearest drlg. Unit Mine, if any) 1285'		13. STATE NM	
16. NO. OF ACRES IN LEASE 720.00		17. NO. OF ACRES ASSIGNED TO THIS WELL 40	
18. DISTANCE FROM PROPOSED LOCATION * TO NEAREST WELL, DRILLING, COMPLETED OR APPLIED FOR, ON THIS LEASE, FT. 883'		19. PROPOSED DEPTH 4800'	
20. ROTARY OR CABLE TOOLS Rotary		21. ELEVATIONS (Show whether DF, RT, GR, etc.) 3838'	
22. APPROX. DATE WORK WILL START * 10-1-96		23. PROPOSED CASING AND CEMENTING PROGRAM	

SIZE OF HOLE	GRADE, SIZE OF CASING	WEIGHT PER FOOT	SETTING DEPTH	QUANTITY OF CEMENT
12 1/4"	8 5/8" 8RD ST&C J-55	20#	400'	Circulate WITNESS
7 7/8"	5 1/2" J-55	17#	4800'	Sufficient to bring cmt 100' above 8 5/8" casing shoe.

Duration of Program: Drilling - Nine (9) days
Completion - Thirty (30) days
See attached for complete Drilling Program

EXHIBITS

Exhibit "A": Drilling Program Exhibit "D": Land Survey Plat Exhibit "G": Rig Layout
Exhibit "B": H₂S Plan Exhibit "E": Vicinity Plat Exhibit "H": BOP Layout
Exhibit "C": Surface Use Plan Exhibit "F": Existing Well Plat

IN ABOVE SPACE DESCRIBE PROPOSED PROGRAM: If proposal is to deepen, give data on present productive zone and proposed new productive zone. If proposal is to drill or deepen directionally, give pertinent data on subsurface locations and measured and true vertical depths. Give blowout preventer program, if any.

24. SIGNED Michael R. Burch TITLE Agent for The Wiser Oil Company DATE 9-12-96
Michael R. Burch, CPL

(This space for Federal or State office use)

PERMIT NO. _____ APPROVAL DATE _____

Application approval does not warrant or certify that the applicant holds legal or equitable title to those rights in the subject lease which would entitle the applicant to conduct operations thereon.

CONDITIONS OF APPROVAL, IF ANY:

APPROVED BY /s/ Gary Bowers TITLE Adm. Asst. DATE 10-1-96

*See Instructions On Reverse Side

Title 18 U.S.C. Section 1001, makes it a crime for any person knowingly and willfully to make to any department or agency of the United States any false, fictitious or fraudulent statements or representations as to any matter within its jurisdiction.

DISTRICT I
P. O. Box 1980
Hobbs, NM 88241-1980

State of New Mexico
Geology, Minerals, and Natural Resources - Department

EXHIBIT "D"

Form C-102
Revised 02-10-94

Instructions on back

DISTRICT II
P. O. Drawer DD
Artesia, NM 88211-0719

OIL CONSERVATION DIVISION
P. O. Box 2088
Santa Fe, New Mexico 87504-2088

Submit to the Appropriate
District Office
State Lease - 4 copies
Fee Lease - 3 copies

☐ AMENDED REPORT

DISTRICT III
1000 Rio Brazos Rd.
Aztec, NM 87410

DISTRICT IV
P. O. Box 2088
Santa Fe, NM 87507-2088

WELL LOCATION AND ACREAGE DEDICATION PLAT

1 API Number 30-015- 29224		2 Pool Code 28509		3 Pool Name Grayburg Jackson 7RVS QN GB SA					
4 Property Code 017540		5 Property Name SKELLY UNIT 'M'					6 Well Number 267		
7 OGRID No. 022922		8 Operator Name THE WISER OIL COMPANY					9 Elevation 3838'		
10 SURFACE LOCATION									
UL or lot no. M	Section 23	Township 17 SOUTH	Range 31 EAST, N.M.P.M.	Lot Ida	Feet from the 35'	North/South line SOUTH	Feet from the 1285'	East/West line WEST	County EDDY
"BOTTOM HOLE LOCATION IF DIFFERENT FROM SURFACE"									
UL or lot no.	Section	Township	Range	Lot Ida	Feet from the	North/South line	Feet from the	East/West line	County
12 Dedicated Acres 40		13 Joint or Infill		14 Consolidation Code		15 Order No.			

NO ALLOWABLE WELL BE ASSIGNED TO THIS COMPLETION UNTIL ALL INTERESTS HAVE BEEN
CONSOLIDATED OR A NON-STANDARD UNIT HAS BEEN APPROVED BY THE DIVISION

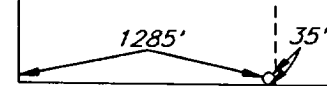
OPERATOR CERTIFICATION

I hereby certify that the information
contained herein is true and complete
to the best of my knowledge and belief.

Signature
Michael R. Burch

Printed Name
Michael R. Burch

Title
Agent for the Wiser Oil

Date
Company

9-12-96

SURVEYOR CERTIFICATION

I hereby certify that the well
location shown on this plat was
plotted from field notes of actual
surveys made by me or under
my supervision, and that the
same is true and correct to the
best of my belief.

Date of Survey
JANUARY 17, 1996

Signature and Seal of
Professional Surveyor

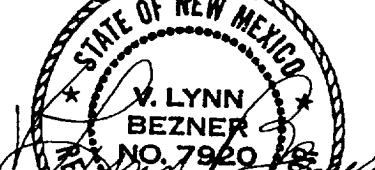
V. LYNN
BEZNER
NO. 7920

Certificate No.
V. L. BEZNER #7920

JOB #43092-180 SE / JSJ

BOP & CHOKE MANIFOLD

12"/900 Cameron SS Space Saver
 3000# Working Pressure
 3000# Working Pressure Choke Manifold

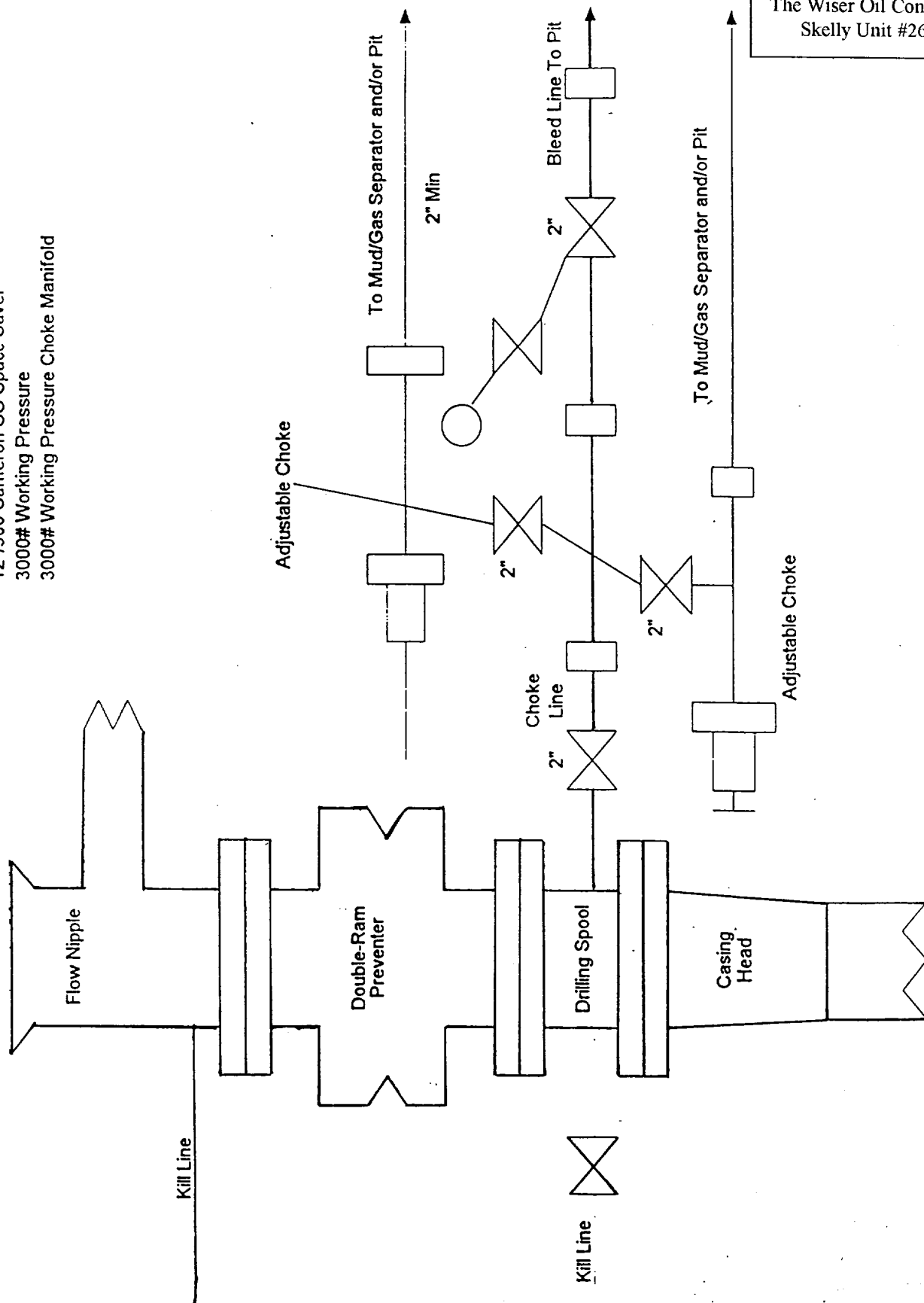

EXHIBIT "H"

BOP LAYOUT

The Wiser Oil Company
 Skelly Unit #267