

UNITED STATES
DEPARTMENT OF THE INTERIOR
BUREAU OF LAND MANAGEMENT

AMENDED Conc.

FORM APPROVED
Bureau No. 1004-0135
Expires: March 31, 1993

SUNDRY NOTICES AND REPORTS ON WELLS

Do not use this form for proposals to drill or to deepen or reentry to a different reservoir.
Use "APPLICATION FOR PERMIT—" for such proposals

SUBMIT IN TRIPLICATE

5. Lease Designation and Serial No.

LC-028784C

6. If Indian, Allottee or Tribe Name

7. If Unit or CA, Agreement Designation

BURCH KEELY UNIT

8. Well Name and No.

BURCH KEELY UNIT #268

9. API Well No.

10. Field and Pool, or Exploratory Area

GRBG JACKSON SR Q GRBG SA

11. County or Parish, State

Eddy County, NM

1. Type of Well

☒ Oil Well ☐ Gas Well ☐ Other

2. Name of Operator

Marbob Energy Corporation

3. Address and Telephone No.

P. O. Drawer 227, Artesia, NM 88210

505-748-3303

4. Location of Well (Footage, Sec., T., R., M., or Survey Description)

955 FNL 365 FWL SEC. 26-T17S-R29E UNIT D

2. CHECK APPROPRIATE BOX(s) TO INDICATE NATURE OF NOTICE, REPORT, OR OTHER DATA

TYPE OF SUBMISSION

- ☐ Notice of Intent
☒ Subsequent Report
☐ Final Abandonment Notice

TYPE OF ACTION

- ☐ Abandonment
☐ Recompletion
☐ Plugging Back
☐ Casing Repair
☐ Altering Casing
☐ Other CHANGE LOCATION PAD
☐ Change of Plans
☐ New Construction
☐ Non-Routine Fracturing
☐ Water Shut-Off
☐ Conversion to Injection
☐ Dispose Water

(Note: Report results of multiple completion on Well Completion or Recompletion Report and Log form.)

3. Describe Proposed or Completed Operations (Clearly state all pertinent details, and give pertinent dates, including estimated date of starting any proposed work. If well is directionally drilled, give subsurface locations and measured and true vertical depths for all markers and zones pertinent to this work.)*

MARBOB ENERGY IS AMENDING THE LOCATION PAD (EXHIBIT #5)
SUBMITTED WITH THE SURFACE USE PLAN FILED FOR THIS WELL.

I hereby certify that the foregoing is true and correct

Signed Rhonda Nelson

Title PRODUCTION CLERK

Date 3/12/97

(This space for Federal or State office use)

TORIG. SEC. JOE C. LARA

Approved by
Conditions of approval, if any:

Title Petroleum Engineer

Date 4/17/97

EXHIBIT #5

N
1

BKU 125 WILL BE PLUGGED
AND THE POWER POLES WILL
BE MOVED.

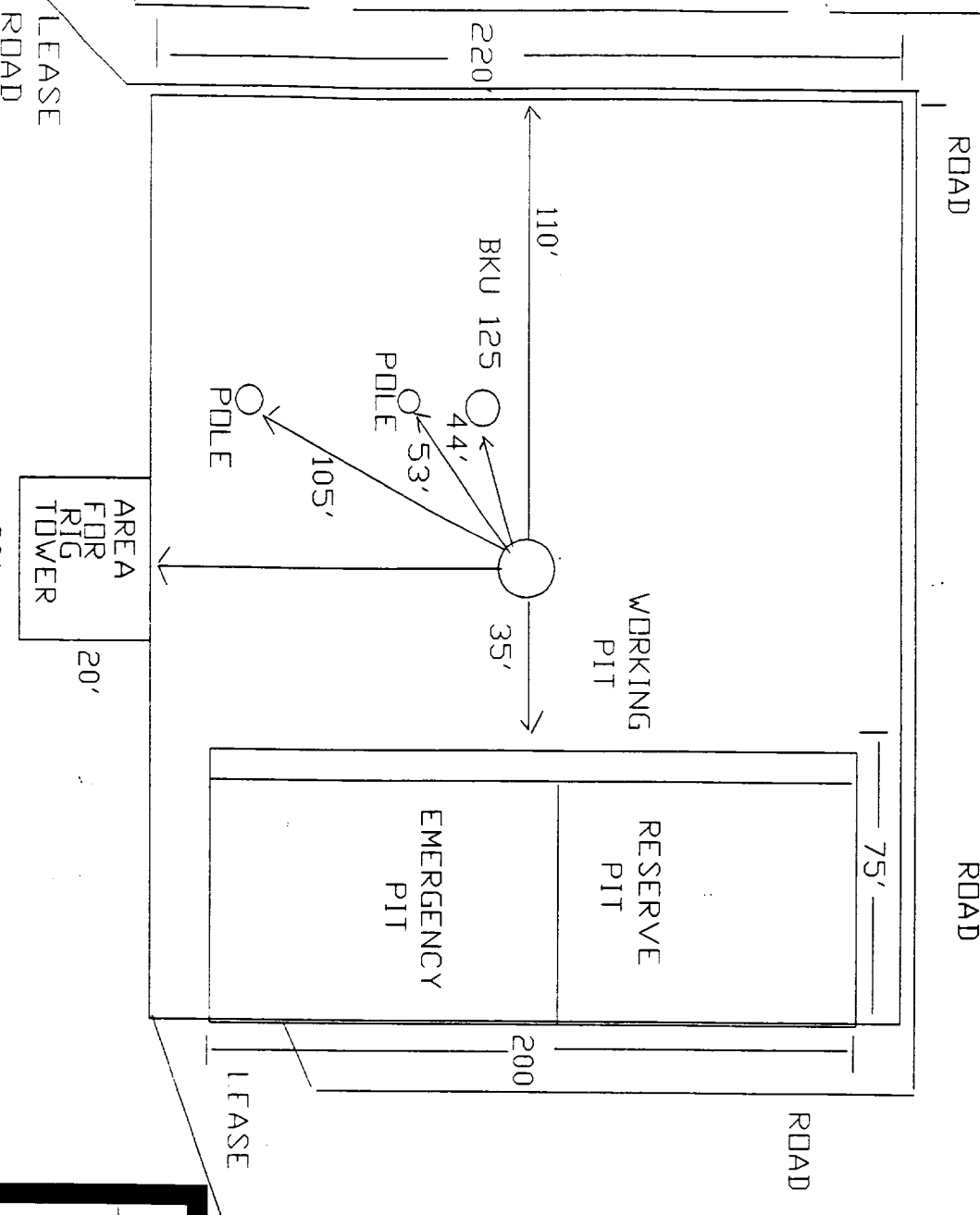

MARBOD ENERGY

BURCH-KEELY UNIT #268

,955' FNL & 365' FWL

SEC. 26-T17S-R29E

EDDY COUNTY, NEW MEXICO