

UNITED STATES
DEPARTMENT OF THE INTERIOR
BUREAU OF LAND MANAGEMENT

APPLICATION FOR PERMIT TO DRILL OR DEEPEN

1a. TYPE OF WORK

DRILL ☒DEEPEN ☐

b. TYPE OF WELL

OIL WELL ☒Gas Well ☐

OTHER

SINGLE ZONE ☐MULTIPLE ZONE ☐

2. NAME OF OPERATOR

Mack Energy Corporation

3. ADDRESS AND TELEPHONE NO.

P.O. Box 960, Artesia, NM 88211-0960 (505) 748-1288

4. LOCATION OF WELL (Report location clearly and in accordance with any state requirement.)

At surface

UNORTHODOX LOCATION 230 FNL & 1650 FWL

At proposed prod. zone

Unit C 230 FNL & 1650 FWL

14. DISTANCE IN MILES AND DIRECTION FROM NEAREST TOWN OR POST OFFICE*

1.2, 11/12 6.25 miles West of Loco Hills

15. DISTANCE FROM PROPOSED*

LOCATION TO NEAREST
PROPERTY OR LEASE LINE, FT.

230

16. NO. OF ACRES IN LEASE

280

17. NO OF ACRES IN LEASE
TO THIS WELL

40

18. DISTANCE FROM PROPOSED LOCATION*

TO NEAREST WELL, DRILLING, COMPLETED
OR APPLIED FOR, ON THIS LEASE, FT.

1150

19. PROPOSED DEPTH

5800

20. ROTARY OR CABLE TOOLS

Rotary

21. ELEVATIONS (Show whether DF, RT, GR, etc.)

3620

ROSWELL CONTROLLED WATER BASIN

22. APPROX. DATE WORK WILL START*

01/23/2000

23. **NSL-4300A** PROPOSED CASING AND CEMENTING PROGRAM

SIZE OF HOLE	GRADE, SIZE OF CASING	WEIGHT PER FOOT	SETTING DEPTH	QUANTITY OF CEMENT
17 1/2	K-55, 13 3/8	48	325	Circ
12 1/4	K-55, 8 5/8	24	850	Circ
7 7/8	J-55, 5 1/2	17	5800	Suff to Circ

Mack Energy proposes to drill to a depth sufficient to test the Paddock and San Andres formation for oil. If productive, 5 1/2" casing will be cemented. If non-productive, the well will be plugged and abandoned in a manner consistent with federal regulation. Specific programs as per Onshore Oil and Gas Order #1 are outlined in the following attachments:

1. Surveys
Exhibit #1- Well Location Plat
Exhibit #2- Vicinity Map
Exhibit #3- Location Verification Map
2. Drilling Program
3. Surface Use & Operating Plan
Exhibit #4- One Mile Radius Map
Exhibit #5- Production Facilities Layout
Exhibit #6- Location Layout
4. Certification
5. Hydrogen Sulfide Drilling Operation Plan
Exhibit #7- H2S Warning Sign
Exhibit #8- H2S Safety Equipment
6. Blowout Preventers
Exhibit #9- BOPE Schematic
Exhibit #10- Blowout Preventer Requirements
Exhibit #11- Choke Manifold
7. Responsibility Statement

APPROVAL SUBJECT TO
GENERAL REQUIREMENTS AND
SPECIAL STIPULATIONS
ATTACHED

IN ABOVE SPACE DESCRIBE PROPOSED PROGRAM: If proposal is to deepen, give data on present productive zone and proposed new productive zone. If proposal is to drill or deepen directionally, give pertinent data on subsurface locations and measured and true vertical depths. Give blowout preventer program, if any.

24. SIGNED Cross D. Cant TITLE Production Analyst DATE 12/16/99

(This space for Federal or State office use)

PERMIT NO. _____ APPROVAL DATE _____

Application approval does not warrant or certify that the applicant holds legal or equitable title to those rights in the subject lease which would entitle the applicant to conduct operations thereon.
CONDITIONS OF APPROVAL, IF ANY:

APPROVED BY _____ TITLE Acting Assistant Field Office Manager
Lands and Minerals

DATE 12/16/99

*See Instructions On Reverse Side

N25-

RECEIVED
JAN 10 1962

PM 10 22 A 8 32

RECEIVED

OIL CONSERVATION DIVISION
P.O. Box 2088
Santa Fe, New Mexico 87504-2088

☐ AMENDED REPORT

WELL LOCATION AND ACREAGE DEDICATION PLAT

API Number		Pool Code 96610	Pool Name East Empire Yeso
Property Code 022546	Property Name WHITE STAR FEDERAL		Well Number 12
OGRID No. 013837	Operator Name MACK ENERGY CORPORATION		Elevation 3620

Surface Location

UL or lot No. C	Section 29	Township 17 S	Range 29 E	Lot Idn	Feet from the 230	North/South line NORTH	Feet from the 1650	East/West line WEST	County EDDY
--------------------	---------------	------------------	---------------	---------	----------------------	---------------------------	-----------------------	------------------------	----------------

Bottom Hole Location If Different From Surface

UL or lot No.	Section	Township	Range	Lot Idn	Feet from the	North/South line	Feet from the	East/West line	County
---------------	---------	----------	-------	---------	---------------	------------------	---------------	----------------	--------

Dedicated Acres 40	Joint or Infill	Consolidation Code	Order No.
-----------------------	-----------------	--------------------	-----------

NO ALLOWABLE WILL BE ASSIGNED TO THIS COMPLETION UNTIL ALL INTERESTS HAVE BEEN CONSOLIDATED
OR A NON-STANDARD UNIT HAS BEEN APPROVED BY THE DIVISION

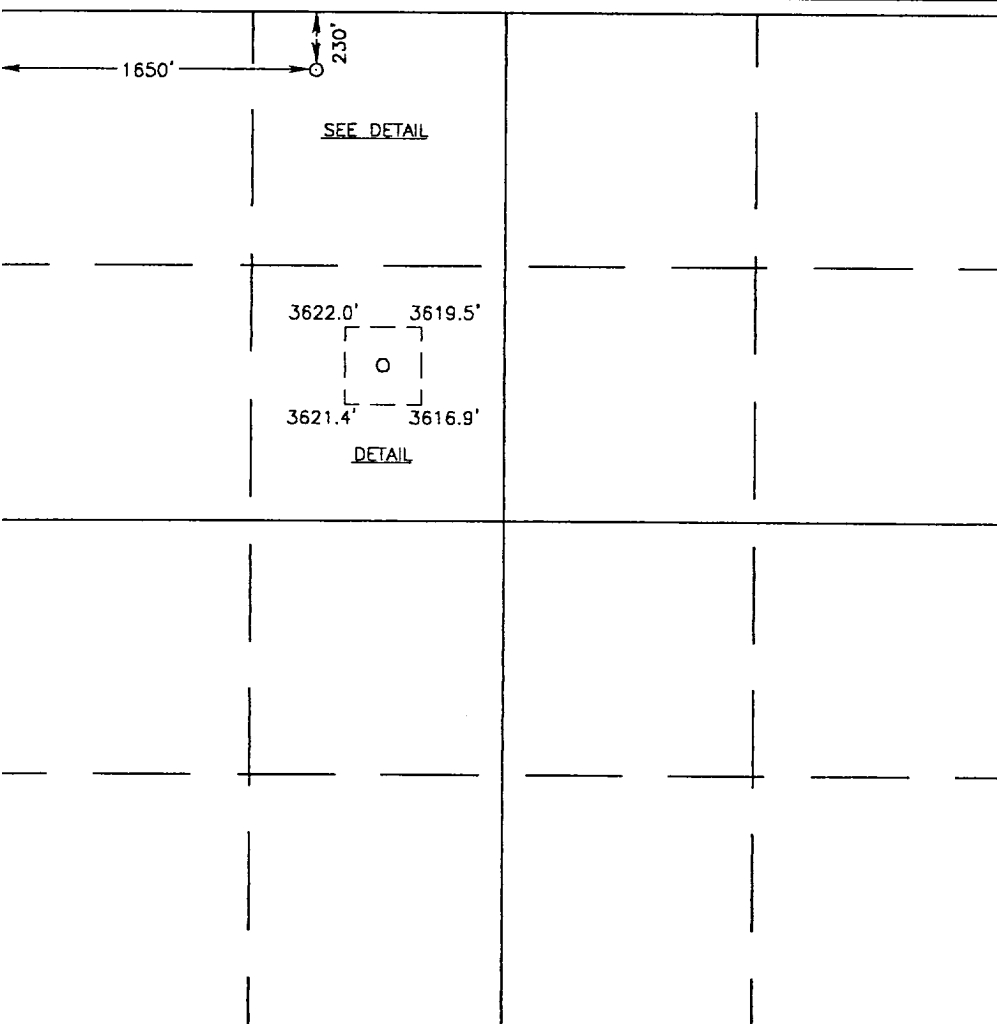

OPERATOR CERTIFICATION

I hereby certify the the information
contained herein is true and complete to the
best of my knowledge and belief.

Crissa D. Carter

Signature

Crissa D. Carter

Printed Name

Production Analyst

Title

12-20-99

Date

SURVEYOR CERTIFICATION

I hereby certify that the well location shown
on this plat was plotted from field notes of
actual surveys made by me or under my
supervision and that the same is true and
correct to the best of my belief.

DECEMBER 1, 1999

Date Surveyed

LMP

Signature & Seal of
Professional Surveyor

Ronald E. Edson

RONALD E. EDSON

12-07-99

99-11-1096

Certificate No. RONALD E. EDSON 3239
GARY EDSON 12641
WACON MEDONALD 12185

Mack Energy Corporation

Exhibit #9 BOPE Schematic

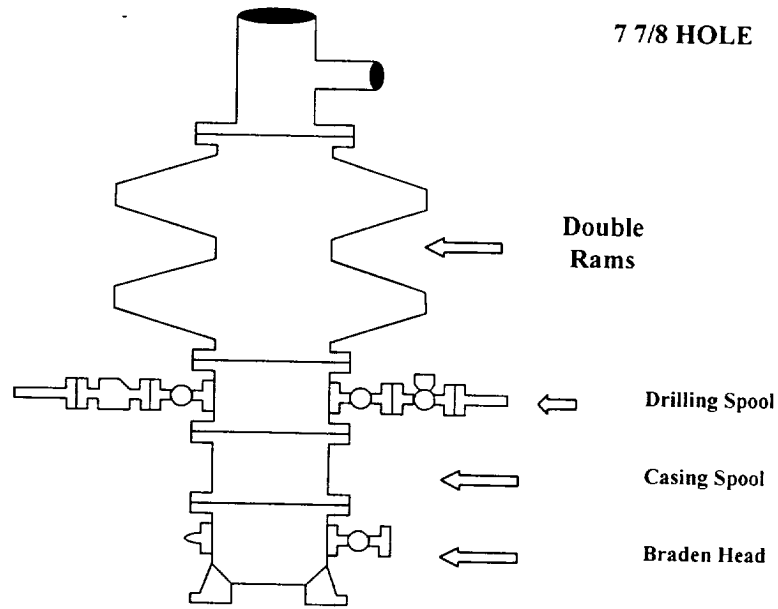

Choke Manifold Requirement (2000 psi WP) No Annular Required

