

District I
1625 N. French Dr., Hobbs, NM 88240
District II
811 South First, Artesia, NM 88210
District III
1000 Rio Brazos Road, Aztec, NM 87410
District IV
2040 South Pacheco, Santa Fe, NM 87505

State of New Mexico
Energy Minerals and Natural Resources

Oil Conservation Division
2040 South Pacheco
Santa Fe, NM 87505

Form C-101
Revised March 17, 1999
Submit to appropriate District Office
State Lease - 6 Copies
Fee Lease - 5 Copies

☐ AMENDED REPORT

APPLICATION FOR PERMIT TO DRILL, RE-ENTER, DEEPEN, PLUGBACK, OR ADD A ZONE

¹ Operator Name and Address Clayton Williams Energy, Inc. Six Desta Drive, Suite 3000 Midland, TX 79705		² OGRID Number 25706
³ Property Code 25339		³ API Number 30 - 015-31051
Property Name STATE '20E'		⁶ Well No. 2

⁷ Surface Location

UL or lot no.	Section	Township	Range	Lot Idn	Feet from the	North/South line	Feet from the	East/West line	County
C	20	17 S	29 E		330	north	1650	west	Eddy

⁸ Proposed Bottom Hole Location If Different From Surface

UL or lot no.	Section	Township	Range	Lot Idn	Feet from the	North/South line	Feet from the	East/West line	County

⁹ Proposed Pool 1 Grayburg Jackson -7R's,QN,GB,SA (28509)	¹⁰ Proposed Pool 2
--	-------------------------------

¹¹ Work Type Code P	¹² Well Type Code O	¹³ Cable/Rotary R	¹⁴ Lease Type Code S	¹⁵ Ground Level Elevation 3627'
¹⁶ Multiple N	¹⁷ Proposed Depth 3750'	¹⁸ Formation Grayburg	¹⁹ Contractor Key Energy Drilling	²⁰ Spud Date upon approval

²¹ Proposed Casing and Cement Program

Hole Size	Casing Size	Casing weight/foot	Setting Depth	Sacks of Cement	Estimated TOC

²² Describe the proposed program. If this application is to DEEPEN or PLUG BACK, give the data on the present productive zone and proposed new productive zone.
Describe the blowout prevention program, if any. Use additional sheets if necessary.

It is proposed to set a Retrievable Bridge Plug @ $\pm 3750'$ and Temporarily Abandon the Yeso formation (existing perfs @ 3812'-4144', 35 holes).

Perforate and stimulate Grayburg-San Andres formation: Lower San Andres 3494' - 3691' (OA), 20 holes, and Upper San Andres 2440' - 3100' (OA), 24 holes, and Grayburg 1918' - 2355' (OA), 24 holes.

²³ I hereby certify that the information given above is true and complete to the best of my knowledge and belief.		OIL CONSERVATION DIVISION	
Signature: <i>Betsy Luna</i>		Approved by: ORIGINAL SIGNED BY TIM W. GUM	
Printed name: Betsy Luna		DISTRICT II SUPERVISOR	
Title: Engineering Technician		Title:	
Date: 7/21/2000		Approval Date: JUL 25 2000 Expiration Date: JUL 25 2001	
Phone: (915) 682-6324		Conditions of Approval:	
		Attached <input type="checkbox"/>	

DISTRICT I
P.O. Box 1980, Hobbs, NM 88241-1980

State of New Mexico
Energy, Minerals and Natural Resources Department

Form C-102
Revised February 10, 1994
Submit to Appropriate District Office
State Lease - 4 Copies
Fee Lease - 3 Copies

DISTRICT II
P.O. Drawer DD, Artesia, NM 88211-0719

DISTRICT III
1000 Rio Brazos Rd., Aztec, NM 87410

DISTRICT IV
P.O. BOX 2088, SANTA FE, N.M. 87504-2088

OIL CONSERVATION DIVISION

P.O. Box 2088
Santa Fe, New Mexico 87504-2088

☐ AMENDED REPORT

WELL LOCATION AND ACREAGE DEDICATION PLAT

API Number 30-015-31051	Pool Code 28509	Pool Name Grayburg Jackson-7R's,QN,CB,SA
Property Code 25339	Property Name STATE 20 "E"	Well Number 2
OGRID No. 257063	Operator Name CLAYTON WILLIAMS ENERGY, INC.	Elevation 3627

Surface Location

UL or lot No. C	Section 20	Township 17 S	Range 29 E	Lot Idn	Feet from the 330	North/South line NORTH	Feet from the 1650	East/West line WEST	County EDDY
--------------------	---------------	------------------	---------------	---------	----------------------	---------------------------	-----------------------	------------------------	----------------

Bottom Hole Location If Different From Surface

UL or lot No.	Section	Township	Range	Lot Idn	Feet from the	North/South line	Feet from the	East/West line	County
Dedicated Acres 40	Joint or Infill	Consolidation Code	Order No.						

NO ALLOWABLE WILL BE ASSIGNED TO THIS COMPLETION UNTIL ALL INTERESTS HAVE BEEN CONSOLIDATED
OR A NON-STANDARD UNIT HAS BEEN APPROVED BY THE DIVISION

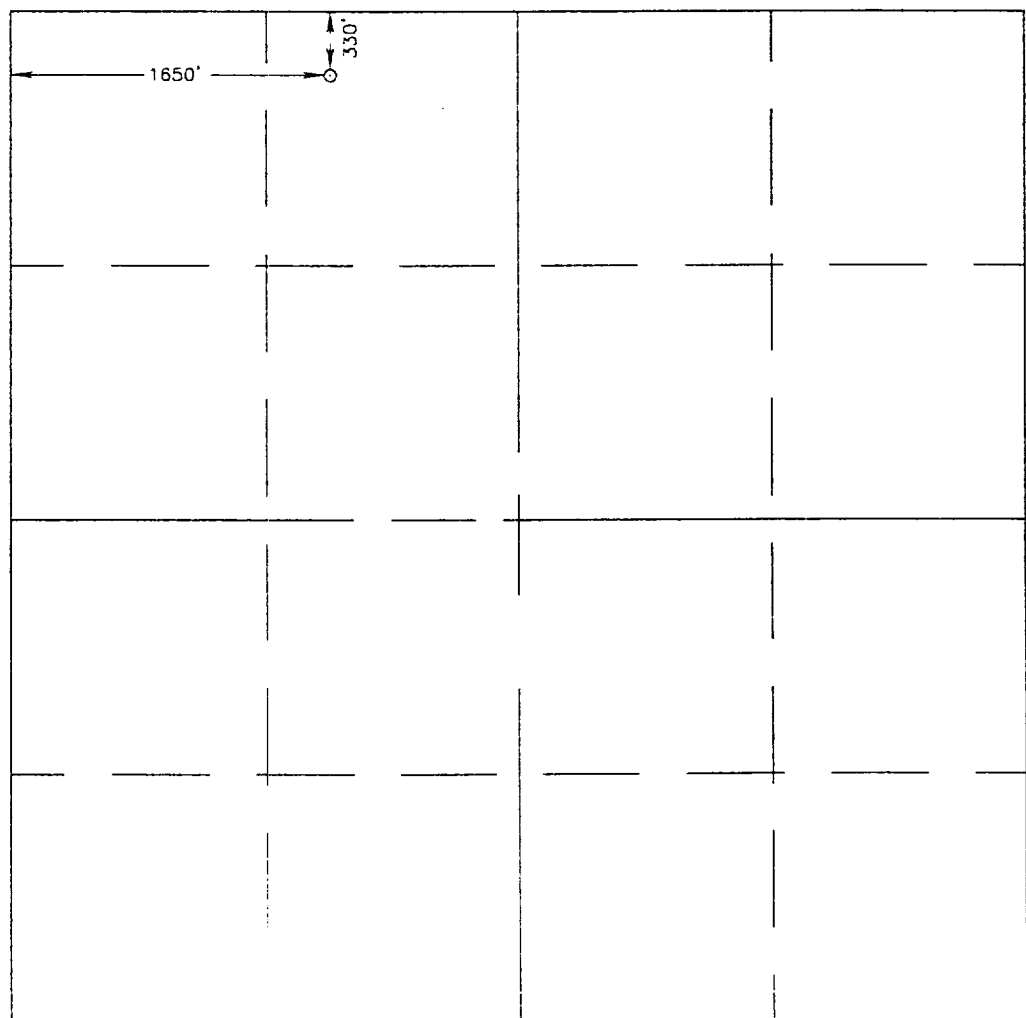
	<p>OPERATOR CERTIFICATION</p> <p>I hereby certify the the information contained herein is true and complete to the best of my knowledge and belief.</p> <p><i>Betsy Luna</i> Signature</p> <p>Betsy Luna Printed Name</p> <p>Engineering Technician Title</p> <p>7-20-2000 Date</p> <p>SURVEYOR CERTIFICATION</p> <p>I hereby certify that the well location shown on this plat was plotted from field notes of actual surveys made by me or under my supervision, and that the same is true and correct to the best of my belief.</p> <p>MARCH 14, 2000 Date Surveyed</p> <p>Signature & Seal of Professional Surveyor <i>Ronald J. Ebdson</i> 3/15/2000</p> <p>Certificate No. RONALD J. EBDSON 3239 GARY EBDSON 12841 WACON McDONALD 12185</p>
--	---

VICINITY MAP

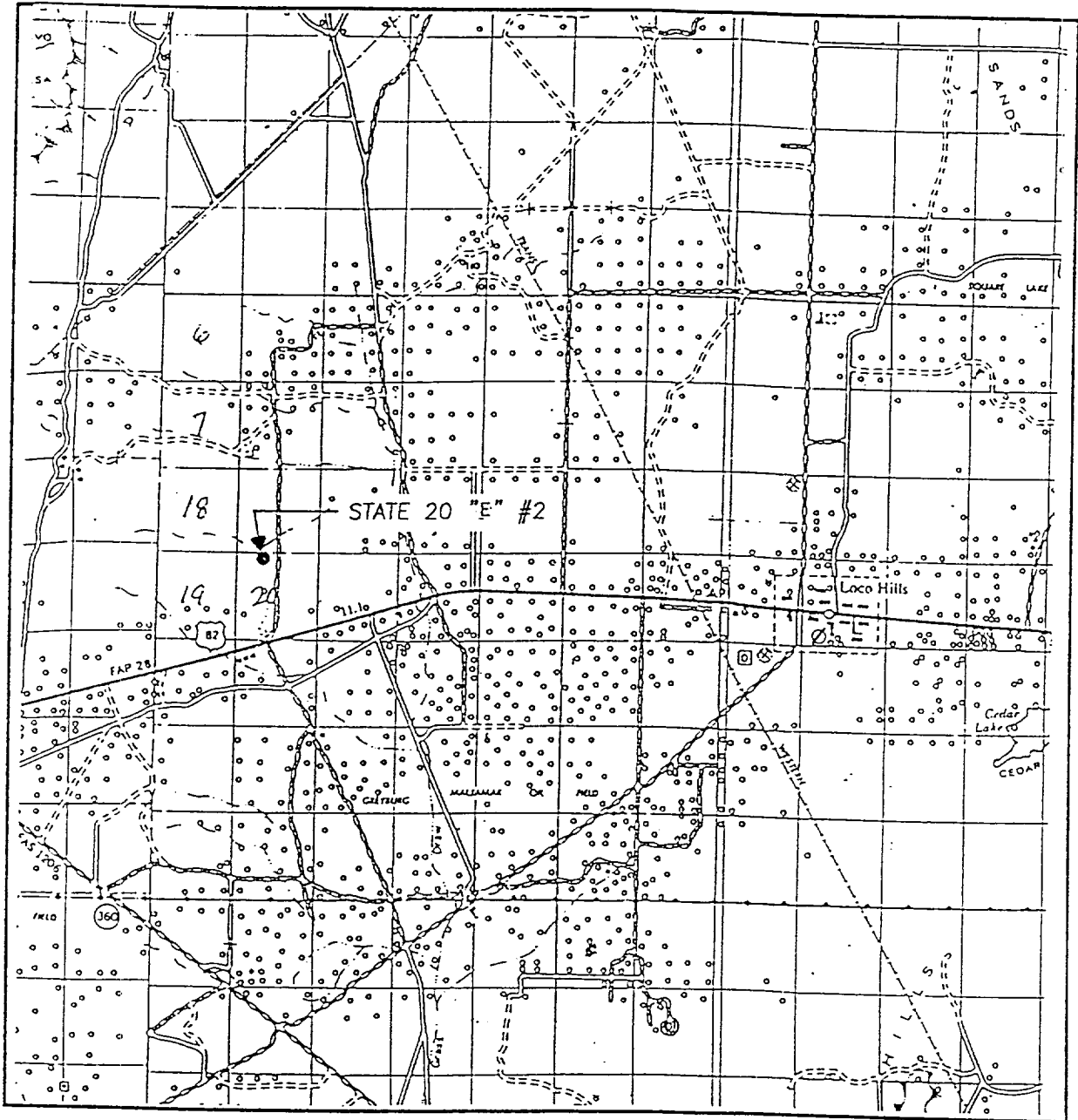

SCALE: 1" = 2 MILES

SEC. 20 TWP. 17-S RGE. 29-E

SURVEY N.M.P.M.

COUNTY EDDY

DESCRIPTION 330' FNL & 1650' FWL

ELEVATION 3627

OPERATOR CLAYTON WILLIAMS
ENERGY, INC.

LEASE STATE 20 "E"

JOHN WEST SURVEYING
HOBBS, NEW MEXICO
4 (505 393-3117)

RECEIVED
OCD - ARTESIA

CONTOUR INTERVAL:
RED LAKE SE - 10'

RED LAKE SE. N.M.

JOHN WEST SURVEYING
HOBBS, NEW MEXICO
(505 393-3117

RECEIVED
OCD - ARTESIA

MANUAL BOP
7-1/16" x 3,000#

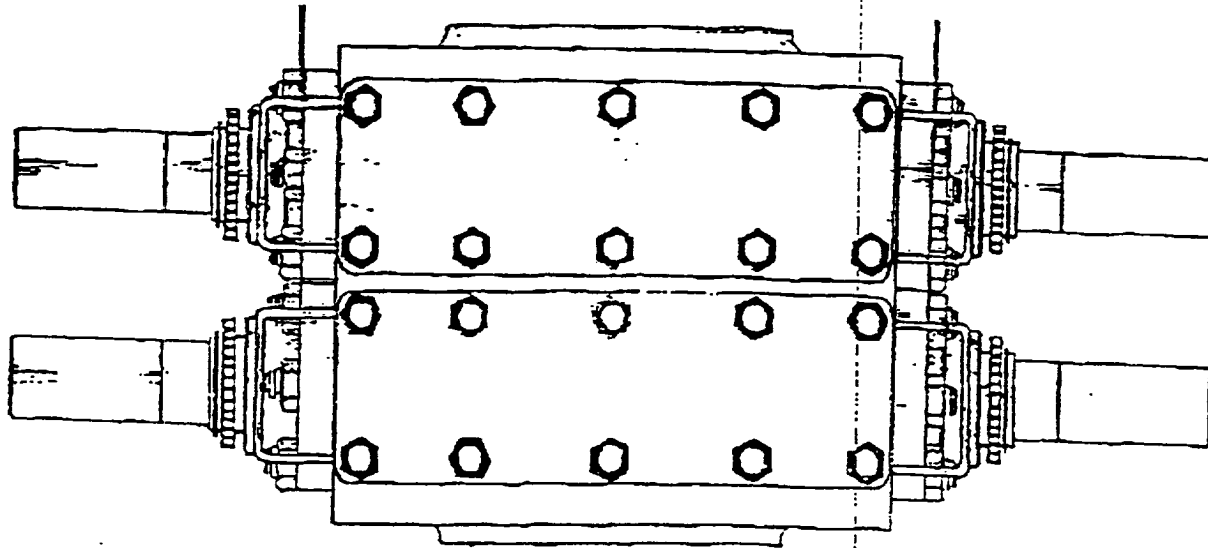

DIMENSIONS AND WEIGHTS

MECHANICAL		
Weight	Single (pounds)	2,225#
	Double (pounds)	2,200#
Overall height, less studs	Single (inches)	13"
	Double (inches)	22"
Overall length (inches)		63"
Overall width, less handwheel (inches)		22"
Opening through preventer (inches)		7-1/16"
Working pressure (psi)		3,000#
Test pressure (psi)		6,000#

RECEIVED
OCD - ARTESIA