

District I  
1625 N. French Dr., Hobbs, NM 88240  
District II  
811 South First, Artesia, NM 88210  
District III  
1000 Rio Brazos Road, Aztec, NM 87410  
District IV  
2040 South Pacheco, Santa Fe, NM 87505

State of New Mexico  
Energy Minerals and Natural Resources

Oil Conservation Division  
2040 South Pacheco  
Santa Fe, NM 87505

Form C-101  
Revised March 17, 1999

Submit to appropriate District Office  
State Lease - 6 Copies  
Fee Lease - 5 Copies

☐ AMENDED REPORT

APPLICATION FOR PERMIT TO DRILL, RE-ENTER, DEEPEN, PLUGBACK, OR ADD A ZONE

<sup>1</sup> Operator Name and Address <b>Clayton Williams Energy, Inc. Six Desta Drive, Suite 3000 Midland, TX 79705</b>		<sup>2</sup> OGRID Number <b>25706</b>
<sup>3</sup> Property Code <b>25235</b>		<sup>4</sup> API Number <b>30 - 015 - 31054</b>
Property Name <b>STATE '20B'</b>		<sup>5</sup> Well No. <b>10</b>

<sup>7</sup> Surface Location

UL or lot no.	Section	Township	Range	Lot Idn	Feet from the	North/South line	Feet from the	East/West line	County
<b>O</b>	<b>20</b>	<b>17 S</b>	<b>29 E</b>		<b>990</b>	<b>south</b>	<b>1650</b>	<b>east</b>	<b>Eddy</b>

<sup>8</sup> Proposed Bottom Hole Location If Different From Surface

UL or lot no.	Section	Township	Range	Lot Idn	Feet from the	North/South line	Feet from the	East/West line	County

<sup>9</sup> Proposed Pool 1 <b>Empire, East (Yeso) (96610)</b>	<sup>10</sup> Proposed Pool 2 <b>Grayburg Jackson -7R's,QN,GB,SA (28509)</b>
--	---

<sup>11</sup> Work Type Code <b>N</b>	<sup>12</sup> Well Type Code <b>O</b>	<sup>13</sup> Cable/Rotary <b>R</b>	<sup>14</sup> Lease Type Code <b>S</b>	<sup>15</sup> Ground Level Elevation <b>3609'</b>
<sup>16</sup> Multiple <b>N</b>	<sup>17</sup> Proposed Depth <b>5000'</b>	<sup>18</sup> Formation <b>Yeso Sands</b>	<sup>19</sup> Contractor <b>Key Energy Drilling</b>	<sup>20</sup> Spud Date <b>upon approval</b>

Minimum WOC time **18hrs.**

<sup>21</sup> Proposed Casing and Cement Program

Hole Size	Casing Size	Casing weight/foot	Setting Depth	Sacks of Cement	Estimated TOC
<b>12-1/4"</b>	<b>8-5/8"</b>	<b>24#</b>	<b>450'</b>	<b>300</b>	<b>surface</b>
<b>7-7/8"</b>	<b>5-1/2"</b>	<b>17#</b>	<b>5000'</b>	<b>880</b>	<b>surface</b>

<sup>22</sup> Describe the proposed program. If this application is to DEEPEN or PLUG BACK, give the data on the present productive zone and proposed new productive zone.

Describe the blowout prevention program, if any. Use additional sheets if necessary.

1. Drill 12-1/4" hole to 450'. Run and set 450' of 8-5/8" 24# J-55 ST&C casing. Cement with 300 sx. of Cl. "C" + 2% S1 (CaCl2) + 1/4#/sx. celloflake. Circulate cement to surface.
2. Drill 7-7/8" hole to 5000'. Run and set 5000' of 5-1/2" 17# J-55 ST&C casing. Cement with 360 sx. Cl. "C" 50/50 Poz + 2%D-20 + 1% B28 + 0.2% D112 FLAC + 0.2% D65 TIC + 3#/sx. D42 + 1/4#/sx. celloflake, tail with 520 sx. Cl. "C" 50/50 Poz + 2% D20 + 1% B28 + 0.2% D112FLAC + 0.2% D65TIC + 5# D42/Sx. + 1/4#/sx. celloflake. Circulate cement to surface.

<sup>23</sup> I hereby certify that the information given above is true and complete to the best of my knowledge and belief.

Signature:

*Betsy Luna*

Printed name: Betsy Luna

Title: Regulatory Analyst

Date: 3/24/2000

Phone: (915) 682-6324

OIL CONSERVATION DIVISION

Approved by **ORIGINAL SIGNED BY TIM W. GUM**  
**DISTRICT II SUPERVISOR**

*B6X*

Title:

Approval Date: **APR 03 2000**

Expiration Date: **APR 03 2001**

Conditions of Approval:

Attached ☐



DISTRICT I  
P.O. Box 1980, Hobbs, NM 88241-1980

State of New Mexico  
Energy, Minerals and Natural Resources Department

Form C-102  
Revised February 10, 1994  
Submit to Appropriate District Office  
State Lease - 4 Copies  
Fee Lease - 3 Copies

DISTRICT II  
P.O. Drawer DD, Artesia, NM 88211-0719

DISTRICT III  
1000 Rio Brazos Rd., Aztec, NM 87410

DISTRICT IV  
P.O. BOX 2088, SANTA FE, N.M. 87504-2088

# OIL CONSERVATION DIVISION

P.O. Box 2088  
Santa Fe, New Mexico 87504-2088

☐ AMENDED REPORT

## WELL LOCATION AND ACREAGE DEDICATION PLAT

API Number	Pool Code 96610	Pool Name Empire, East (Yeso)
Property Code 25235	Property Name STATE 20 "B"	Well Number 10
OGRID No. 25706	Operator Name CLAYTON WILLIAMS ENERGY, INC.	Elevation 3609

### Surface Location

UL or lot No.	Section	Township	Range	Lot Idn	Feet from the	North/South line	Feet from the	East/West line	County
0	20	17 S	29 E		990	SOUTH	1650	EAST	EDDY

### Bottom Hole Location If Different From Surface

UL or lot No.	Section	Township	Range	Lot Idn	Feet from the	North/South line	Feet from the	East/West line	County
Dedicated Acres 40	Joint or Infill	Consolidation Code	Order No.						

NO ALLOWABLE WILL BE ASSIGNED TO THIS COMPLETION UNTIL ALL INTERESTS HAVE BEEN CONSOLIDATED  
OR A NON-STANDARD UNIT HAS BEEN APPROVED BY THE DIVISION

	<b>OPERATOR CERTIFICATION</b>  I hereby certify the the information contained herein is true and complete to the best of my knowledge and belief.   Signature Betsy Luna Printed Name Regulatory Analyst Title 03-24-2000 Date
	<b>SURVEYOR CERTIFICATION</b>  I hereby certify that the well location shown on this plat was plotted from field notes of actual surveys made by me or under my supervision, and that the same is true and correct to the best of my belief.  MARCH 14, 2000 Date Surveyed Signature & Seal of Professional Surveyor  Ronald F. Eidson Certificate No. 3239 GARY EIDSON 12641 MACON-McDONALD 12155

# VICINITY MAP

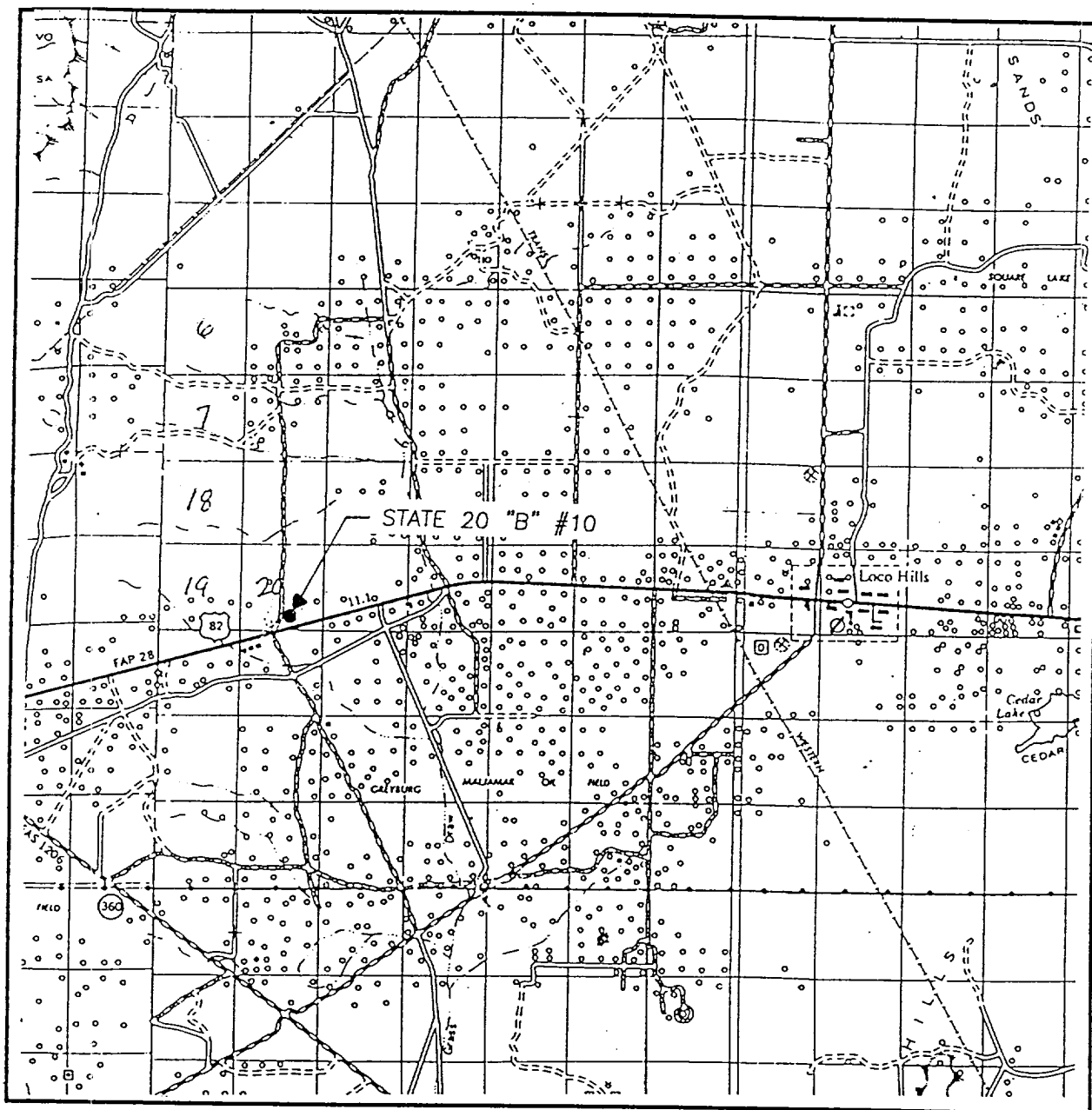

SCALE: 1" = 2 MILES

SEC. 20 TWP. 17-S RGE. 29-E  
 SURVEY N.M.P.M.  
 COUNTY EDDY  
 DESCRIPTION 990' FSL & 1650' FEL  
 ELEVATION 3609  
 OPERATOR CLAYTON WILLIAMS  
ENERGY, INC.  
 LEASE STATE 20 "B"

JOHN WEST SURVEYING  
 HOBBS, NEW MEXICO  
 (505 393-3117)

WORTH



CONTOUR INTERVAL:  
RED LAKE SE - 10'

RED LAKE SE, N.M.

JOHN WEST SURVEYING  
HOBBS, NEW MEXICO  
(505 393-3117

# BLOWOUT PREVENTER SYSTEM

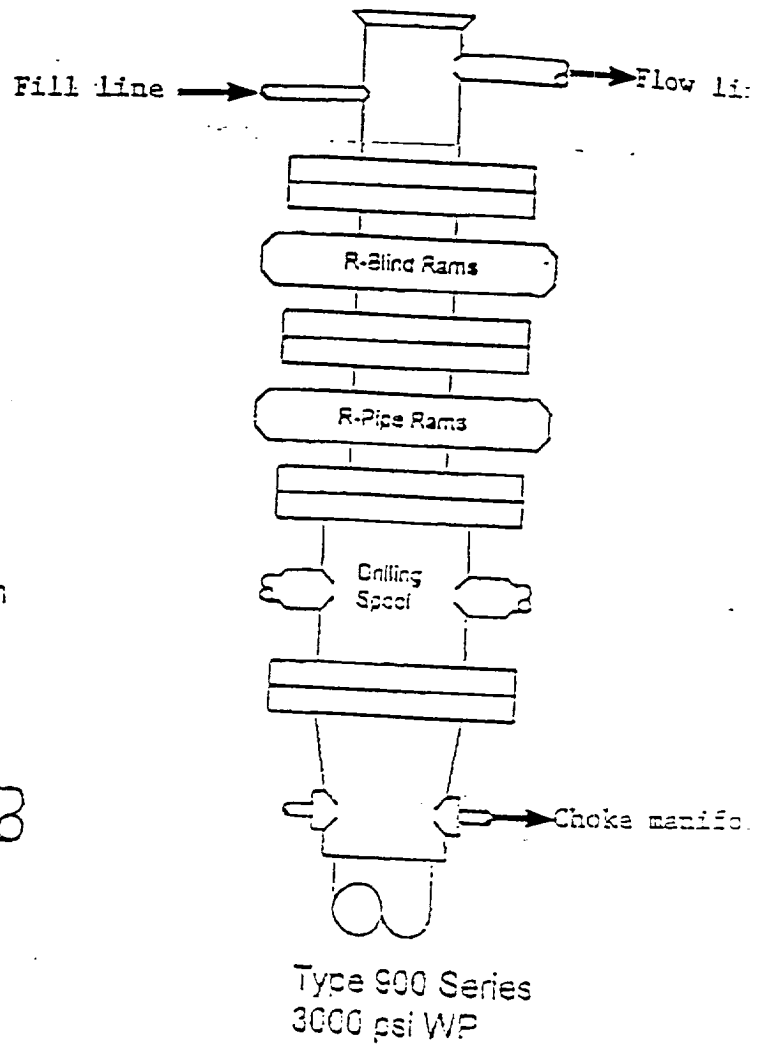

Choke Manifold Assembly for 3M WP System

