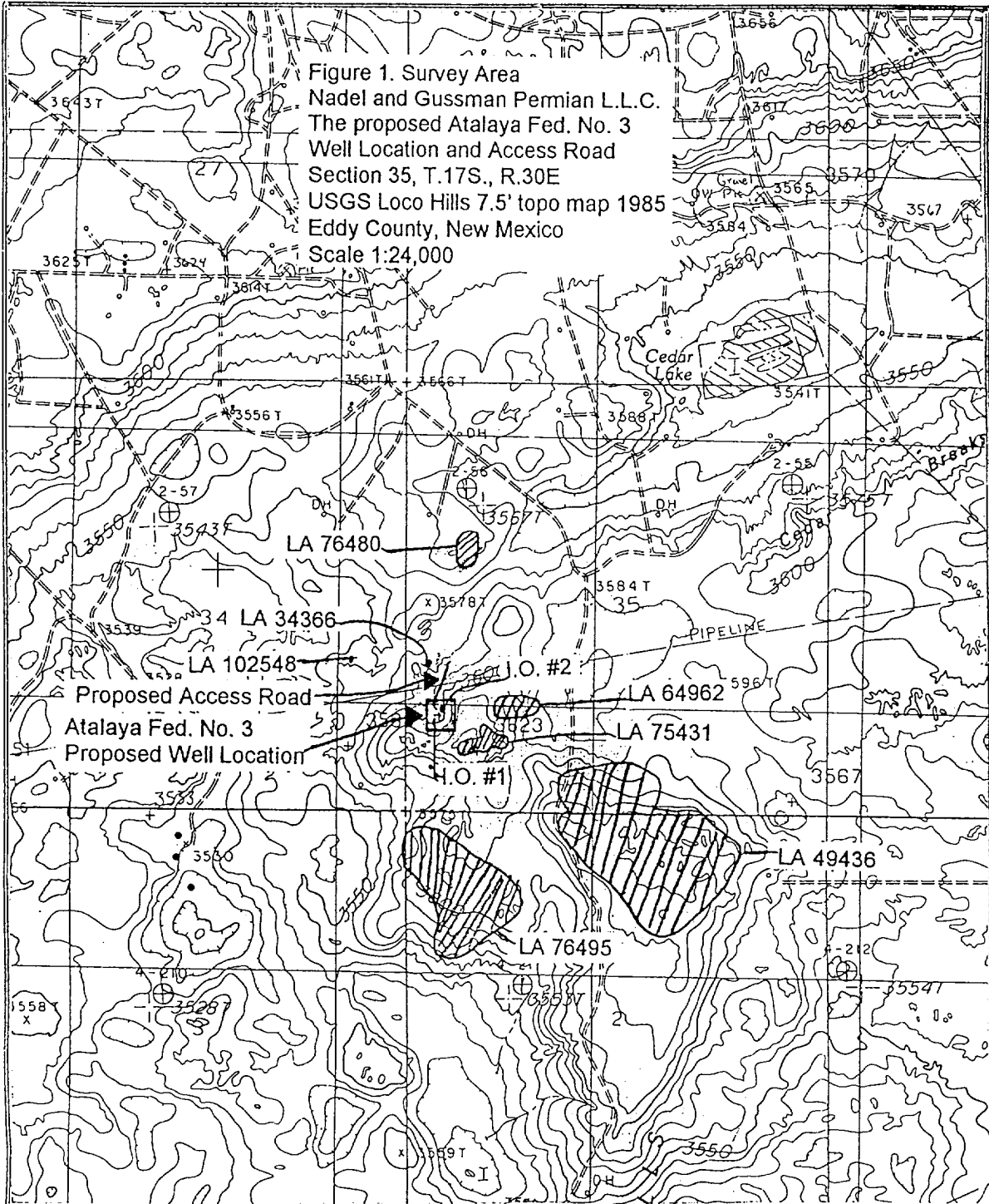
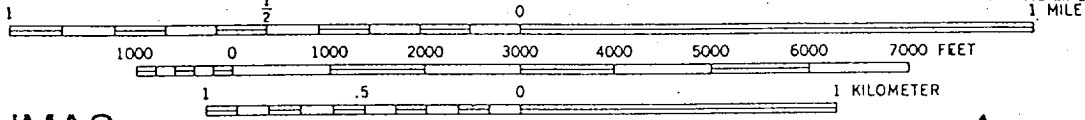

Figure 1. Survey Area
Nadel and Gussman Permian L.L.C.
The proposed Atalaya Fed. No. 3
Well Location and Access Road
Section 35, T.17S., R.30E
USGS Loco Hills 7.5' topo map 1985
Eddy County, New Mexico
Scale 1:24,000



SCALE 1:24 000



SNMAS
INC

