

DISTRICT I
P.O. Box 1880, Hobbs, NM 88241-1880

DISTRICT II
P.O. Drawer 22, Artesia, NM 88211-0719

DISTRICT III
1000 Rio Brancos Rd., Aztec, NM 87410

DISTRICT IV
P.O. Box 2088, Santa Fe, N.M. 87504-2088

State of New Mexico

Energy, Minerals and Natural Resources Department

Form C-102
Revised February 10, 1994
Submit to Appropriate District Office
State Lease - 4 Copies
Fee Lease - 3 Copies

OIL CONSERVATION DIVISION

P.O. Box 2088
Santa Fe, New Mexico 87504-2088

WELL LOCATION AND ACREAGE DEDICATION PLAT

☐ AMENDED REPORT

API Number 30-015-31953		Pool Code	Pool Name LOCO HILLS PADDOCK
Property Code	Property Name MUSTANG "28" FEDERAL		Well Number 1
OGRID No. 000817	Operator Name ANADARKO PETROLEUM CORP.		Elevation 3627'

Surface Location

UL or lot No. C	Section 28	Township 17-S	Range 30-E	Lot Idn	Feet from the 330	North/South line NORTH	Feet from the 1809	East/West line WEST	County EDDY
--------------------	---------------	------------------	---------------	---------	----------------------	---------------------------	-----------------------	------------------------	----------------

Bottom Hole Location If Different From Surface

UL or lot No.	Section	Township	Range	Lot Idn	Feet from the	North/South line	Feet from the	East/West line	County
---------------	---------	----------	-------	---------	---------------	------------------	---------------	----------------	--------

Dedicated Acres	Joint or Infill	Consolidation Code	Order No.
-----------------	-----------------	--------------------	-----------

NO ALLOWABLE WILL BE ASSIGNED TO THIS COMPLETION UNTIL ALL INTERESTS HAVE BEEN CONSOLIDATED
OR A NON-STANDARD UNIT HAS BEEN APPROVED BY THE DIVISION

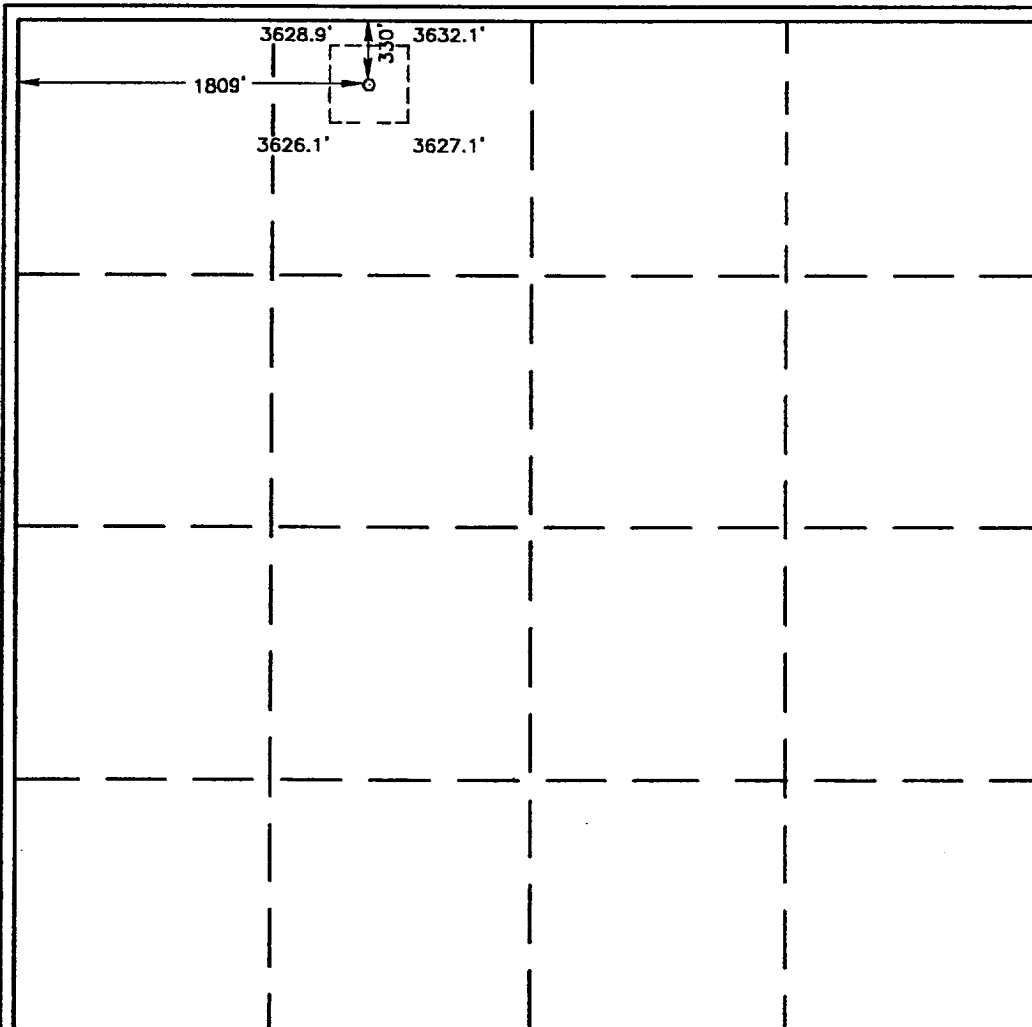

OPERATOR CERTIFICATION

I hereby certify that the information contained herein is true and complete to the best of my knowledge and belief.

George R.S. Buehler
Signature

George R.S. Buehler

Printed Name

Sr. Staff Drilling Engineer

Title

June 8, 2001

Date

SURVEYOR CERTIFICATION

I hereby certify that the well location shown on this plat was plotted from field notes of actual surveys made by me or under my supervision and that the same is true and correct to the best of my belief.

MAY 29, 2001

Date Surveyed

AWB

Signature & Seal of
Professional Surveyor

Ronald J. Edson
01-11-0693

Certificate No. RONALD J. EDSON 3239
GARY EDSON 12641