

NEW MEXICO
OIL CONSERVATION COMMISSION

Form C-128

Well Location and/or Gas Proration Plat

Date February 12, 1957

Operator Magnolia Petroleum Company Lease D. E. Fanning

Well No. Five (5) Section 12 Township 18S Range 26E NMPM

Located 330 Feet From West Line, 1650 Feet From South Line,

Eddy County, New Mexico. G. L. Elevation _____

Name of Producing Formation San Andres Pool Undesignated Dedicated Acreage _____

(Note: All distances must be from outer boundaries of Section)

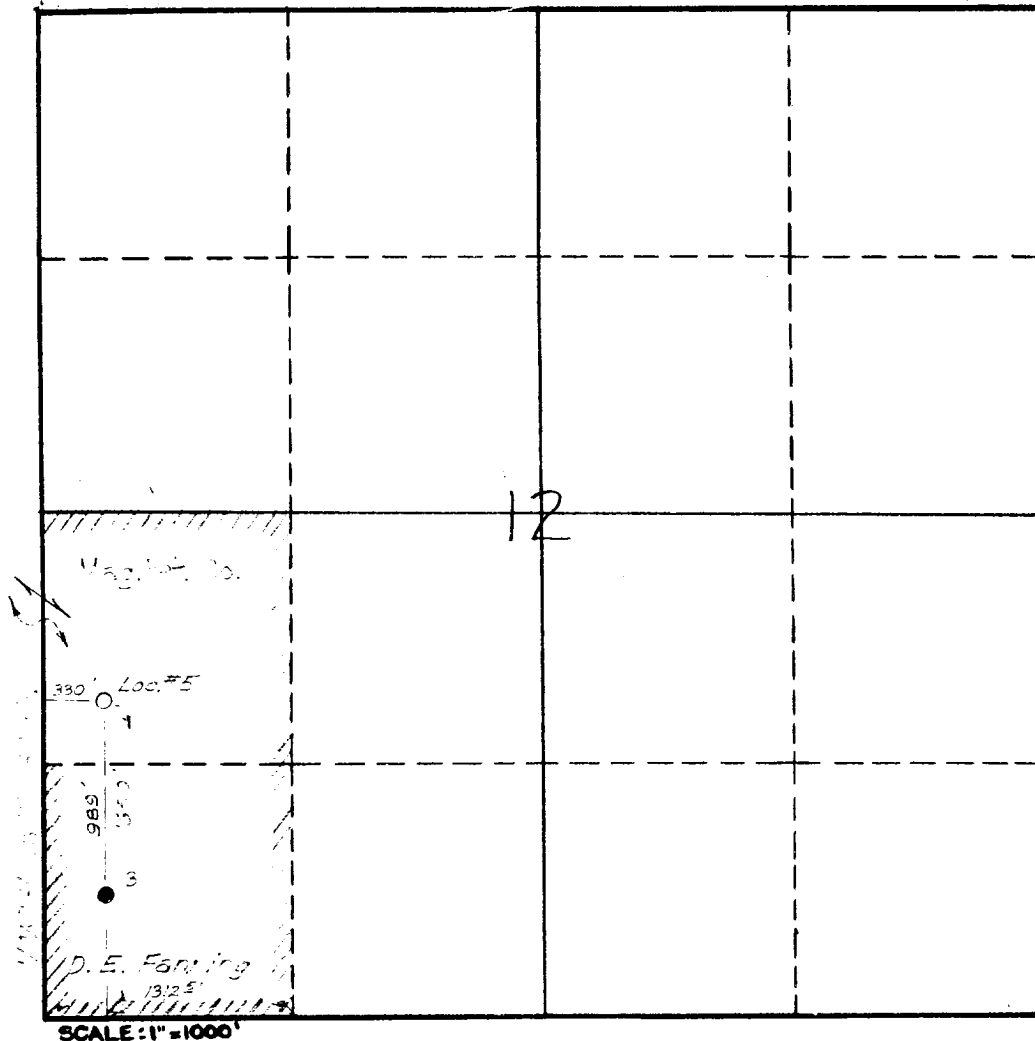

1. Is this Well a Dual Comp. ? Yes ___ No ___.

2. If the answer to Question 1 is yes, are there any other dually completed wells within the dedicated acreage? Yes ___ No ___.

Name W. C. Dougherty
Position District Superintendent
Representing Magnolia Petroleum Company
Address P. O. Box 2406, Hobbs, New Mexico.

This is to certify that the above plat was prepared from field notes of actual surveys made by me or under my supervision and that the same are true and correct to the best of my knowledge and belief.

Date Surveyed 2-11-57
W. C. Dougherty
Registered Professional Engineer and/or
Land Surveyor #1415

NEW MEXICO
OIL CONSERVATION COMMISSION

Form C-128

Well Location and/or Gas Proration Plat

Date February 12, 1957Operator Magnolia Petroleum Company Lease D. E. FanningWell No. Five (5) Section 12 Township 18S Range 26E NMPMLocated 330 Feet From West Line, 1650 Feet From South Line,Eddy County, New Mexico. G. L. Elevation _____Name of Producing Formation San Andres Pool Undesignated Dedicated Acreage _____

(Note: All distances must be from outer boundaries of Section)

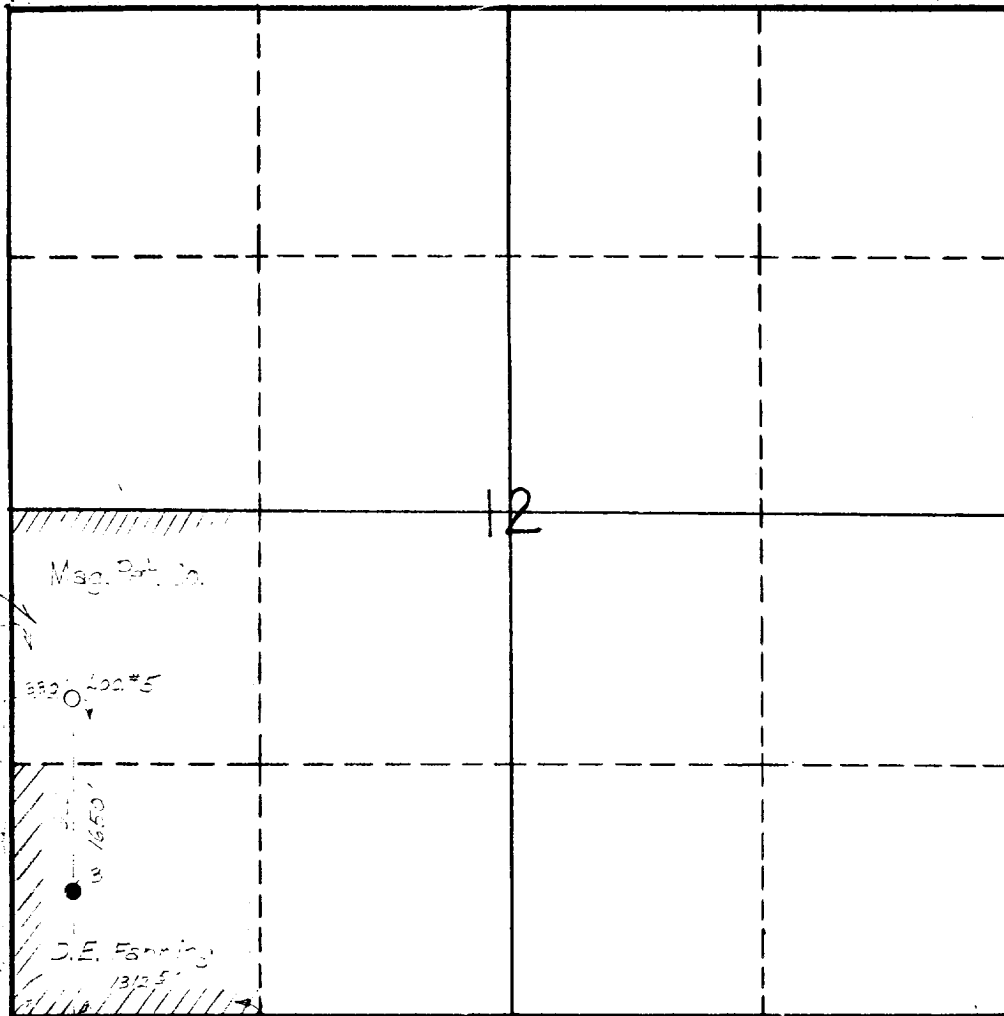

1. Is this Well a Dual Comp. ? Yes ___ No ___.
2. If the answer to Question 1 is yes, are there any other dually completed wells within the dedicated acreage? Yes ___ No ___.

This is to certify that the above plat was prepared from field notes of actual surveys made by me or under my supervision and that the same are true and correct to the best of my knowledge and belief.

Name W. C. Longherty
Position District Superintendent
Representing Magnolia Petroleum Company
Address P. O. Box 216, Hobbs, New Mexico.

Date Surveyed, 2-11-57
W. C. Longherty
Registered Professional Engineer and/or
Land Surveyor 71115