

NEW MEXICO OIL CONSERVATION COMMISSION  
Santa Fe, New Mexico

Form G-101  
Revised 12/1/57

RECEIVED

NOTICE OF INTENTION TO DRILL

SEP 16 1957

Notice must be given to the District Office of the Oil Conservation Commission and approval obtained before drilling or recompletion begins. If changes in the proposed plan are considered advisable, a copy of this notice showing such changes will be returned to the sender. Submit this notice in **QUINTUPLICATE**. One copy will be returned following approval. See additional regulations of the Commission. If State Land submit 6 Copies Attach Form G-128 in triplicate to first section of Form G-101

Artesia, New Mexico  
(Place)

September 16, 1957  
(Date)

OIL CONSERVATION COMMISSION  
SANTA FE, NEW MEXICO

Gentlemen:

You are hereby notified that it is our intention to commence the Drilling of a well to be known as

ILLANEX OIL, INC.

(Company or Operator)

Everest

(Lease)

Well No. 2

in

K

(Unit)

The well is

located 2310 feet from the South line and 2310 feet from the

West

line of Section 14

T. 18S

R. 26E

NMPM.

(GIVE LOCATION FROM SECTION LINE)

Atoka

Pool,

Eddy

County

If State Land the Oil and Gas Lease is No.

If patented land the owner is Everest Estate

Address Oklahoma, City

We propose to drill well with drilling equipment as follows: Rotary Rig

The status of plugging bond is \$10,000.00 Blanket

Drilling Contractor Waters Drilling Company, Inc.

We intend to complete this well in the San Andres  
formation at an approximate depth of approx. 1750 feet.

CASING PROGRAM

We propose to use the following strings of Casing and to cement them as indicated:

Size of Hole	Size of Casing	Weight per Foot	New or Second Hand	Depth	Sacks Cement
15 1/2	13 3/8	54	used	200	mudded
10	8 5/8	24	new	1135	450- or circulate
6 5/8	5 1/2	14	new	1750	450- or circulate to surface.

If changes in the above plans become advisable we will notify you immediately.

ADDITIONAL INFORMATION (If recompletion give full details of proposed plan of work.)

Will run approximately 200' of 13 3/8 casing at surface to shut off water, pull when run 8 5/8". Will run 8 5/8" through all artesian aquifer formations, cement and circulate to top. Then run 5 1/2" oil string, cement & circulate to surface.

SEP 17 1957

Approved \_\_\_\_\_, 19\_\_\_\_\_  
Except as follows:

OIL CONSERVATION COMMISSION

By W. A. Gressett

Sincerely yours,

Illanex Oil, Inc.

(Company or Operator)

By Eleanor H. H. H.

Secretary

Position

Send Communications regarding well to

Illanex Oil, Inc.

Name

P.O. Box 702, Artesia, New Mexico

Address

## NEW MEXICO OIL CONSERVATION COMMISSION

Form 0428

Revised 5/1/57

SEP 16 1957

## Well Location and Acreage Dedication Plat

30-015-00205

Oil Cons. Comm.

Section A.

Date September 14, 1957

Operator Illman Oil, Inc. Lease Everest  
 Well No. 2 Unit Letter  Section 14 Township 18 South Range 26 East NMPM  
 Located 2310 Feet From South Line, 2310 Feet From West Line  
 County Hddy G. L. Elevation 3315 Dedicated Acreage 40 Acres  
 Name of Producing Formation San Andres Pool Atoka

1. Is the Operator the only owner\* in the dedicated acreage outlined on the plat below?  
 Yes ☒ No ☐.
2. If the answer to question one is "no," have the interests of all the owners been consolidated by communitization agreement or otherwise? Yes ☐ No ☐. If answer is "yes," Type of Consolidation
3. If the answer to question two is "no," list all the owners and their respective interests below:

OwnerLand Description

## Section B

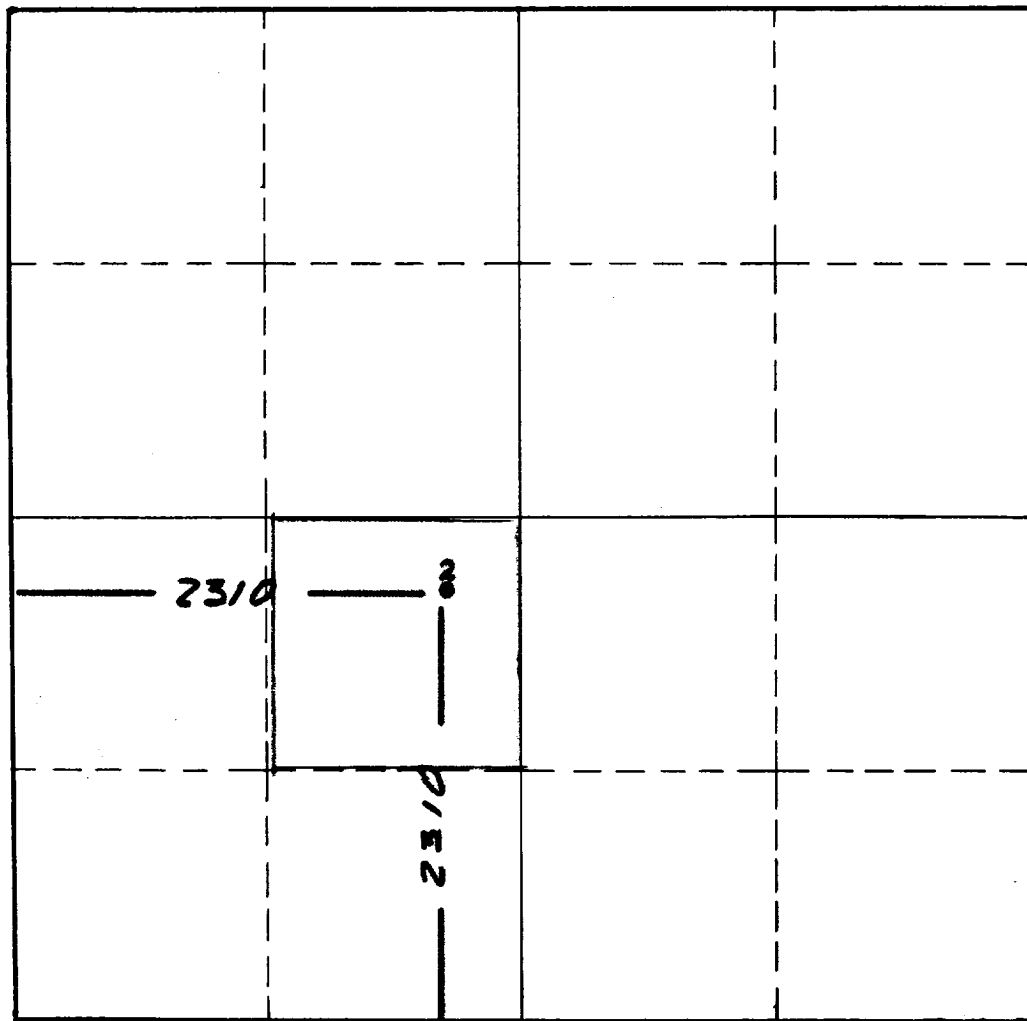

This is to certify that the information in Section A above is true and complete to the best of my knowledge and belief.

Illman Oil Inc  
 (Operator)

Chas. W. Visher  
 (Representative)

P.O. Box 702, Artesia, NM  
 Address

This is to certify that the well location shown on the plat in Section B was plotted from field notes of actual surveys made by me or under my supervision and that the same is true and correct to the best of my knowledge and belief.

Date Surveyed 9/14/57

John A. Mathis Jr.  
 Registered Professional  
 Engineer and/or Land Surveyor.

Certificate No. 1502

(See instructions for completing this form on the reverse side)

INSTRUCTIONS FOR COMPLETION:

1. Operator shall furnish and certify to the information called for in Section A.
2. Operator shall outline the dedicated acreage for both oil and gas wells on the plat in Section B.
3. A registered professional engineer or land surveyor registered in the State of New Mexico or approved by the Commission shall show on the plat the location of the well and certify this information in the space provided.
4. All distances shown on the plat must be from the outer boundaries of Section.
5. If additional space is needed for listing owners and their respective interests as required in question 3, Section A, please use space below

OIL CONSERVATION COMMISSION	
ARTESIA DISTRICT OFFICE	
No. Copies Received	
DISTRIBUTION	
San Diego	
San Jose	
Promotion Office	
State Land Office	
U.S. Dept.	
U.S. Forest Service	
U.S. Geological Survey	
U.S. Navy	
U.S. Army	
U.S. Marine Corps	
U.S. Coast Guard	
U.S. Air Force	
U.S. Navy	
U.S. Army	
U.S. Marine Corps	
U.S. Coast Guard	
U.S. Air Force	

\* "Owner" means the person who has the right to drill into and to produce from any pool and to appropriate the production either for himself or for himself and another. (65-3-29 (e) NMSA 1953 Comp.)