

RECEIVED

NEW MEXICO OIL CONSERVATION COMMISSION
WELL LOCATION AND ACREAGE DEDICATION PLAT

FORM C-128
5/1/57

AUG 3 1960

HIDES OFFICE OCC

SEE INSTRUCTIONS FOR COMPLETING THIS FORM ON THE REVERSE SIDE

O. C. C.

SECTION A

ARTEZIA, OFFICE

Operator **Ohio Oil Co.** Lease **Ethel V. Noel** 1960 AUG 2 Well No. **43**
Unit Letter **P** Section **20** Township **18 S** Range **26 E** County **Eddy**
Actual Footage Location of Well: **990** feet from the **South** line and **990** feet from the **East** line
Ground Level Elev. **3417.09** Producing Formation **Bend Sand** Pool **Atoka-Pennsylvanian** Dedicated Acreage: **320** Acres

1. Is the Operator the only owner in the dedicated acreage outlined on the plat below? YES _____ NO X. ("Owner" means the person who has the right to drill into and to produce from any pool and to appropriate the production either for himself or for himself and another. (65-3-29 (e) NMSA 1935 Comp.)
2. If the answer to question one is "no," have the interests of all the owners been consolidated by communitization agreement or otherwise? YES X NO _____. If answer is "yes," Type of Consolidation Operating Agreement
3. If the answer to question two is "no," list all the owners and their respective interests below:

Owner	Land Description

SECTION B

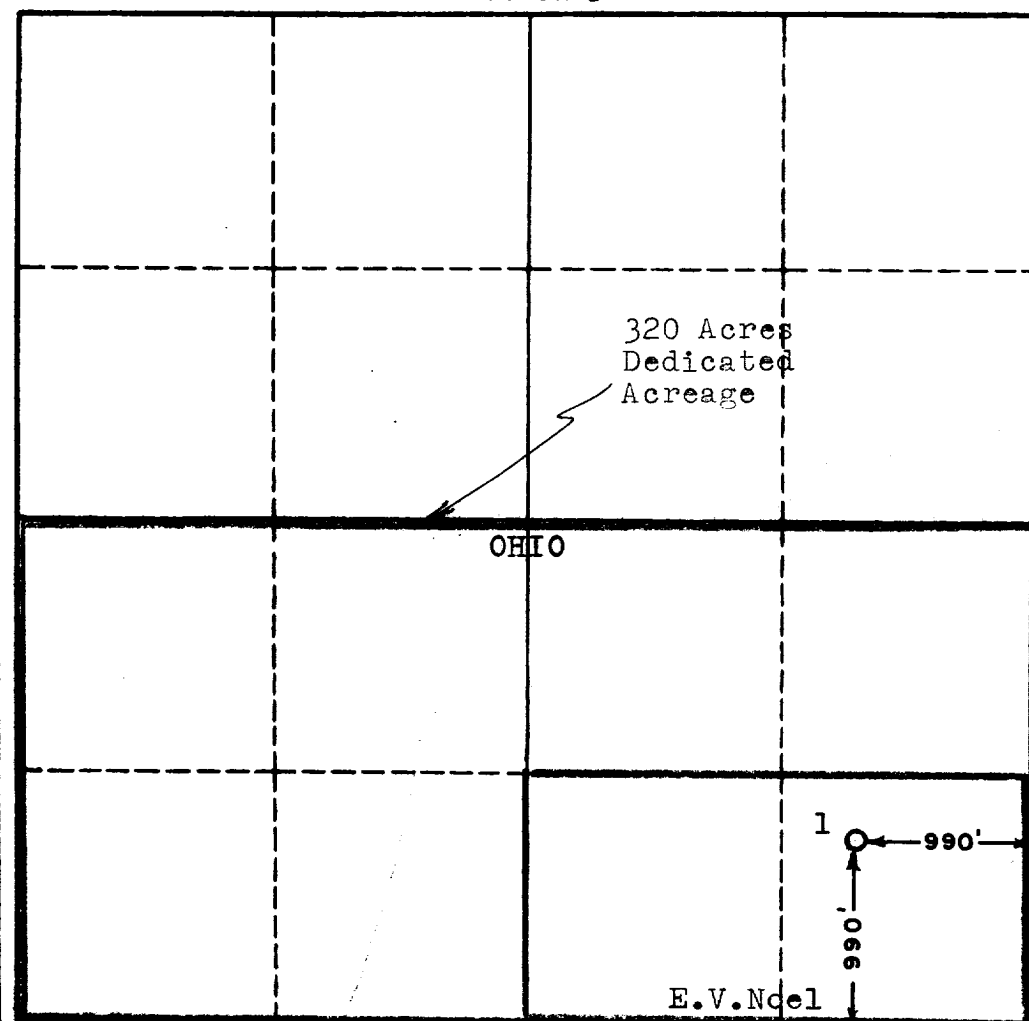

CERTIFICATION

I hereby certify that the information in SECTION A above is true and complete to the best of my knowledge and belief.

Name T. O. Webb
Position Area Petroleum Engineer
Company The Ohio Oil Company
Date July 29, 1960

I hereby certify that the well location shown on the plat in SECTION B was plotted from field notes of actual surveys made by me or under my supervision, and that the same is true and correct to the best of my knowledge and belief.

Date Surveyed July 26, 1960
Registered Professional Engineer and/or Land Surveyor, JOHN W. WEST
Certificate No. W.M. - P.E. & L.S. NO. 676

OIL CONSERVATION COMMISSION

ARTESIA DISTRICT OFFICE

No. Copies Received 11

DISTRIBUTION

	NO. FURNISHED	
OPERATOR	7	
SANTA FE	1	
REGISTRATION OFFICE		
STATE LAND OFFICE		
U. S. G. S.	2	
TRANSPORTER		
FILE	1	✓
BUREAU OF MINES		