

NEW MEXICO OIL CONSERVATION COMMISSION
Well Location and Acreage Dedication Plat

Section A.

Date October 24, 1958

Operator Pan American Petroleum Corp. lease W. E. Flint
Well No. No 1 Unit Letter J Section 22 Township 18 South Range 26 East NMPM
located 1980 Feet From East Line, 1980 Feet From South Line
County Eddy G. L. Elevation furnish later Dedicate Acreage 40 Acres
Name of Producing Formation Abo Pool Wildcat Reserve Abo

1. Is the Operator the only owner* in the dedicated acreage outlined on the plat below?
Yes X No .
2. If the answer to question one is "no," have the interests of all the owners been consolidated by communitization agreement or otherwise? Yes No . If answer is "yes," Type of Consolidation
3. If the answer to question two is "no," list all the owners and their respective interests below:

Owner

Land Description

Section B

This is to certify that the information in Section A above is true and complete to the best of my knowledge and belief.

Pan American Petroleum Corporation

(Operator)

Robert Henderson
(Representative) Field Supt.

Box 68, Hobbs, New Mexico
Address

This is to certify that the well location shown on the plat in Section B was plotted from field notes of actual surveys made by me or under my supervision and that the same is true and correct to the best of my knowledge and belief.

Date Surveyed 10-24-58

John W. West
Registered Professional
Engineer and/or Land Surveyor.

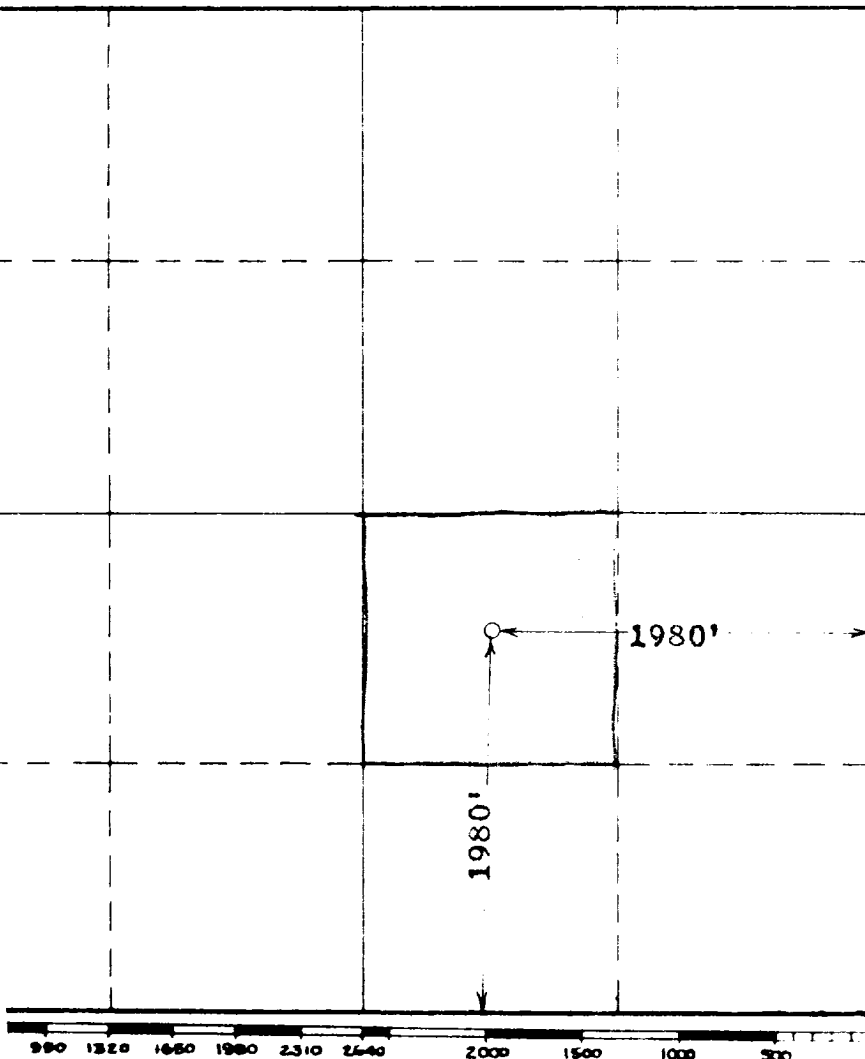

(See instructions for completing this form on the reverse side)

Certificate No. 676