

NO. OF COPIES RECEIVED	5
DISTRIBUTION	
SANTA FE	1
FILE	1
U.S.G.S.	2
LAND OFFICE	
OPERATOR	1

NEW MEXICO OIL CONSERVATION COMMISSION

RECEIVED

APR 28 1976

Form C-101
Revised 1-4-65

APPLICATION FOR PERMIT TO DRILL, DEEPEN OR PLUG BACK		5A. Indicate Type of Lease STATE <input type="checkbox"/> FEE <input checked="" type="checkbox"/>
1a. Type of Work a. Type of Well OIL WELL <input checked="" type="checkbox"/> GAS WELL <input type="checkbox"/> OTHER <input type="checkbox"/> b. Type of Well DRILL <input type="checkbox"/> DEEPEN <input checked="" type="checkbox"/> PLUG BACK <input type="checkbox"/> SINGLE ZONE <input type="checkbox"/> MULTIPLE ZONE <input type="checkbox"/>		5. State Oil & Gas Lease No.
2. Name of Operator Featherstone Development Corporation		7. Unit Agreement Name
3. Address of Operator 1717 West Second Street, Roswell, NM 88201		8. Farm or Lease Name Platt
4. Location of Well UNIT LETTER K LOCATED 2310 FEET FROM THE South LINE AND 2310 FEET FROM THE West LINE OF SEC. 26 TWP. 18S RGE. 26E NMPM		9. Well No. 2
		10. Field and Pool, or Wildcat unb. Taylor San Andres
		12. County Eddy
		19. Proposed Depth 2100'
		19A. Formation San Andres
		20. Rotary or C.T. Rotary
21. Elevations (Show whether DF, RT, etc.) 3310' GR		21A. Kind & Status Plug. Bond State Wide
		21B. Drilling Contractor W.E.K.
		22. Approx. Date Work will start May 5, 1976

23. PROPOSED CASING AND CEMENT PROGRAM					
SIZE OF HOLE	SIZE OF CASING	WEIGHT PER FOOT	SETTING DEPTH	SACKS OF CEMENT	EST. TOP
Existing	10"		677'	50	
Existing	8 1/4"		891'	100	
7 7/8"	5 1/2"	14#	2100'	320 (est)	Circulate

Intend to re-enter existing well and deepen from its present depth of 1210' to approximately 2100' to test the Slaughter Zone of the San Andres Formation.

If samples and logs warrant a completion attempt, we will run 5 1/2" 14# casing to T.D. and circulate cement.

APPROVAL VALID
FOR 90 DAYS UNLESS
DRILLING COMMENCED,

EXPIRES 8-3-76

IN ABOVE SPACE DESCRIBE PROPOSED PROGRAM: IF PROPOSAL IS TO DEEPEN OR PLUG BACK, GIVE DATA ON PRESENT PRODUCTIVE ZONE AND PROPOSED NEW PRODUCTIVE ZONE. GIVE BLOWOUT PREVENTER PROGRAM, IF ANY.

I hereby certify that the information above is true and complete to the best of my knowledge and belief.

Signed Charles W. Hicks Title Vice President Date April 26, 1976

(This space for State Use)

APPROVED BY W. A. Gussert TITLE SUPERVISOR, DISTRICT II DATE MAY 3 1976

CONDITIONS OF APPROVAL, IF ANY:

Notify N.M.O.C.C. in sufficient
time to witness cementing
the 5 1/2" casing

NEW MEXICO OIL CONSERVATION COMMISSION
WELL LOCATION AND ACREAGE DEDICATION PLAT

Form O-102
Supersedes O-128
Effective 1-1-81

All distances must be from the outer boundaries of the Section.

Operator Featherstone Development Corporation			Lease Platt Fee		Well No. 2
Unit Letter K	Section 26	Township 18S	Range 26E	County Eddy	
Actual Footage Location of Well:					
2310 feet from the South line and		2310 feet from the West line			
Ground Level Elev: 3310'	Producing Formation San Andres	Pool Payto Archa San Andres	Dedicated Acreage: 40 Acres		

1. Outline the acreage dedicated to the subject well by colored pencil or hachure marks on the plat below.
2. If more than one lease is dedicated to the well, outline each and identify the ownership thereof (both as to working interest and royalty).
3. If more than one lease of different ownership is dedicated to the well, have the interests of all owners been consolidated by communitization, unitization, force-pooling, etc?

☐ Yes ☐ No If answer is "yes," type of consolidation _____

If answer is "no," list the owners and tract descriptions which have actually been consolidated. (Use reverse side of this form if necessary.) _____

No allowable will be assigned to the well until all interests have been consolidated (by communitization, unitization, forced-pooling, or otherwise) or until a non-standard unit, eliminating such interests, has been approved by the Commission.

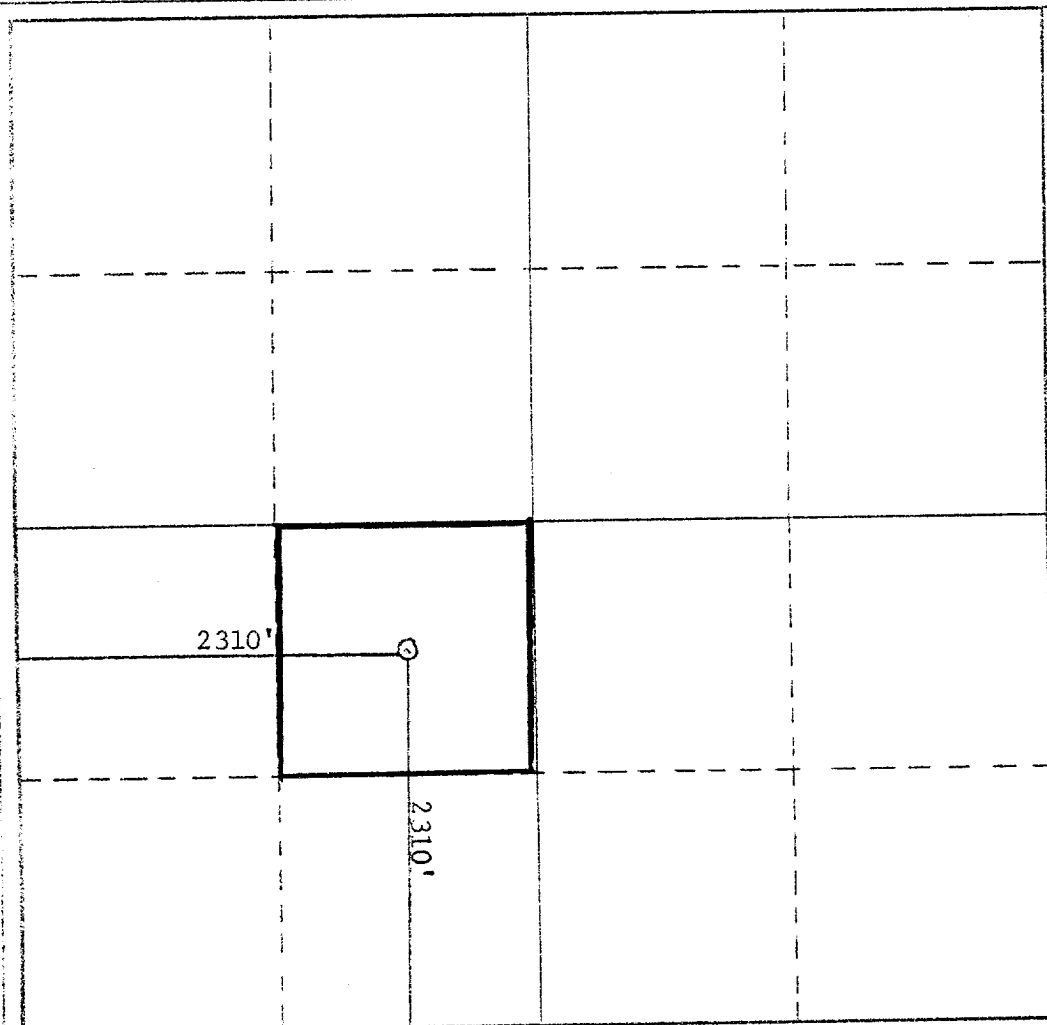

CERTIFICATION

I hereby certify that the information contained herein is true and complete to the best of my knowledge and belief.

Charles W. Hicks
Name

Charles W. Hicks

Position

Vice President

Company

Featherstone Development Corp.

Date

April 26, 1976

I hereby certify that the well location shown on this plat was plotted from field notes of actual surveys made by me or under my supervision, and that the same is true and correct to the best of my knowledge and belief.

Date Surveyed

Registered Professional Engineer
and/or Land Surveyor

Certificate No.

530 660 190 1920 1680 1980 2310 2640 2000 1500 1000 500 0