

NO. OF COPIES RECEIVED	
DISTRIBUTION	
SANTA FE	1
FILE	1
U.S.G.S.	2
LAND OFFICE	
OPERATOR	1

NEW MEXICO OIL CONSERVATION COMMISSION

Form C-101
Revised 1-1-65

FEB 10 1981

O. C. D.
ARTESIA OFFICE

5A. Indicate Type of Lease	
STATE <input type="checkbox"/>	FEE <input checked="" type="checkbox"/>
5. State Oil & Gas Lease No.	
7. Unit Agreement Name	
8. Farm or Lease Name Platt "PA"	
9. Well No. 3	
10. Field and Pool, or Wildcat P. 1105' - Yeso	
12. County Eddy	
19. Proposed Depth Approx. 3200'	19A. Formation Yeso
20. Rotary or C.T. Rotary	
1. Elevations (Show whether DF, RT, etc.) 3317 GL	21A. Kind & Status Plug. Bond Blanket
21B. Drilling Contractor Stewart Bros.	
22. Approx. Date Work will start ASAP	

APPLICATION FOR PERMIT TO DRILL, DEEPEN, OR PLUG BACK

a. Type of Work	
DRILL <input type="checkbox"/>	DEEPEN <input checked="" type="checkbox"/>
b. Type of Well	
OIL WELL <input checked="" type="checkbox"/>	GAS WELL <input type="checkbox"/>
c. Name of Operator Yates Petroleum Corporation	
d. Address of Operator 207 S. 4th Street, Artesia, NM 88210	
e. Location of Well	
UNIT LETTER L	LOCATED 1650 FEET FROM THE South LINE
f. Location of Well	
990 FEET FROM THE West	LINE OF SEC. 26 TWP. 18S RGE. 26E NMPM
1. Elevations (Show whether DF, RT, etc.) 3317 GL	
21A. Kind & Status Plug. Bond Blanket	
21B. Drilling Contractor Stewart Bros.	
22. Approx. Date Work will start ASAP	

3. PROPOSED CASING AND CEMENT PROGRAM

SIZE OF HOLE	SIZE OF CASING	WEIGHT PER FOOT	SETTING DEPTH	SACKS OF CEMENT	EST. TOP
	7"	in place	1078'	50	SA
6 1/8"	4 1/2"	9.5#	TD	125	

We propose to clean out hole to its original TD of 1105', squeeze the two sets of perforations with 75 sx. class C cement, then deepen to approximately 3200' and test the Yeso and other formations. If commercial, production casing will be run and cemented, perforated, and stimulated as needed. ~~This well was P & A the last time on 12-9-57 by Jones & McArthur.~~

MUD PROGRAM: Native mud to 1100', fresh water to TD.

BOP PROGRAM: BOP will be installed on the 7" casing and tested.

APPROVAL VALID FOR 180 DAYS
PERMIT EXPIRES 8-11-81
UNLESS DRILLING UNDERWAY

ABOVE SPACE DESCRIBE PROPOSED PROGRAM; IF PROPOSAL IS TO DEEPEN OR PLUG BACK, GIVE DATA ON PRESENT PRODUCTIVE ZONE AND PROPOSED NEW PRODUCTIVE ZONE. GIVE BLOWOUT PREVENTER PROGRAM, IF ANY.

I hereby certify that the information above is true and complete to the best of my knowledge and belief.

Signed [Signature] Title Geographer Date 2-9-81

(This space for State Use)

APPROVED BY [Signature] TITLE SUPERVISOR DISTRICT II DATE FEB 11 1981

CONDITIONS OF APPROVAL, IF ANY:

Cement must be circulated to
surface behind 4 1/2" casing

NEW MEXICO OIL CONSERVATION COMMISSION
WELL LOCATION AND ACREAGE DEDICATION PLAT

All distances must be from the outer boundaries of the Section.

Operator YATES PETROLEUM CORPORATION	Lease PLATT "PA"	County EDDY	Well No. 3
Unit Letter	Section 26	Township 18 SOUTH	Range 26 EAST
Actual Footage Location of Well: 1650	line and 990	line WEST	Dedicated Acreage: 40 Acres
Ground Level Elev. 3317	Producing Formation YESO	Pool DAYTON	

1. Outline the acreage dedicated to the subject well by colored pencil or hachure marks on the plat below.
2. If more than one lease is dedicated to the well, outline each and identify the ownership thereof (both as to working interest and royalty).
3. If more than one lease of different ownership is dedicated to the well, have the interests of all owners been consolidated by communitization, unitization, force-pooling, etc?

☐ Yes ☐ No If answer is "yes," type of consolidation _____

If answer is "no," list the owners and tract descriptions which have actually been consolidated. (Use reverse side of this form if necessary.)

No allowable will be assigned to the well until all interests have been consolidated (by communitization, unitization, forced-pooling, or otherwise) or until a non-standard unit, eliminating such interests, has been approved by the Commission.

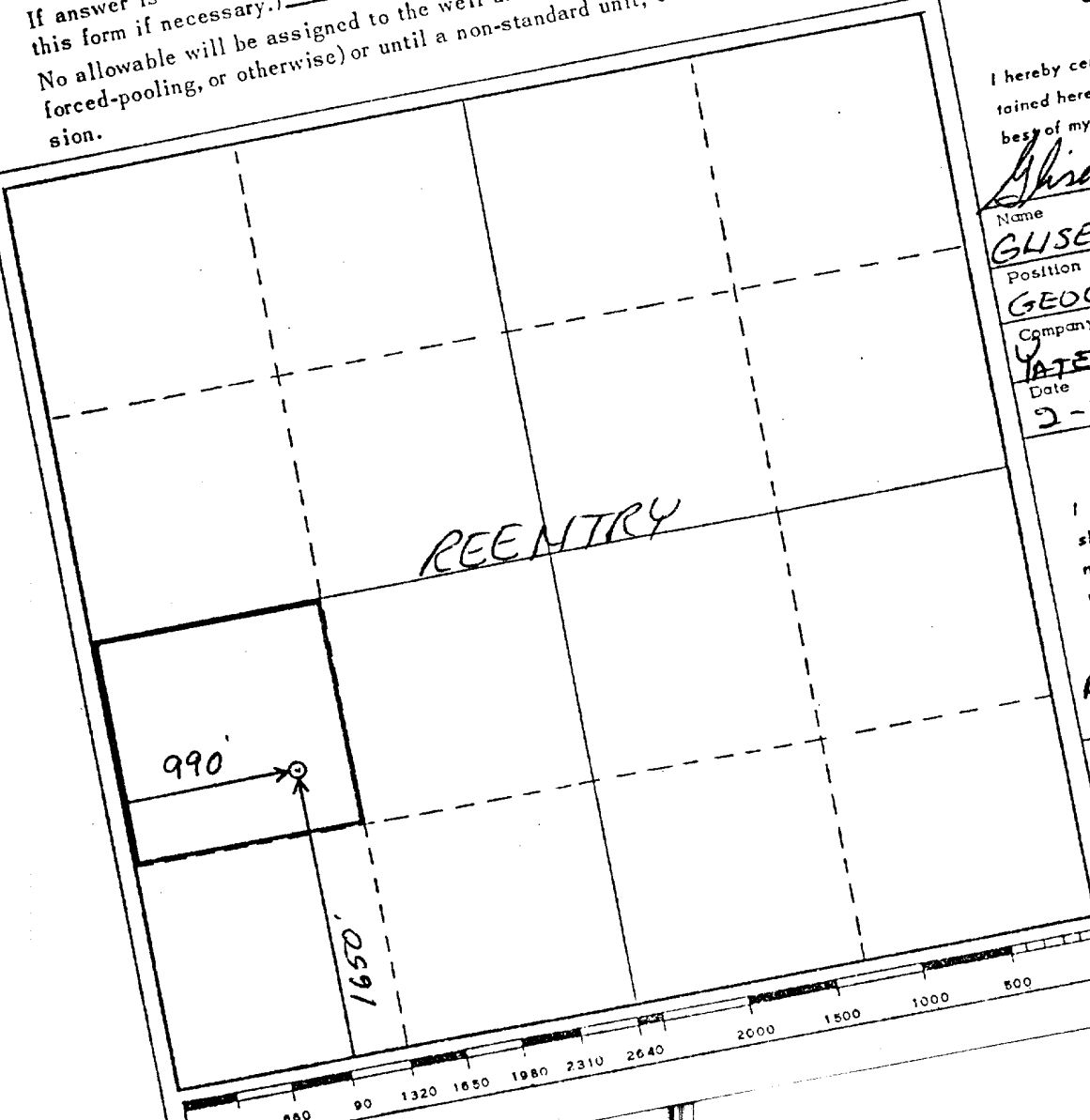

CERTIFICATION

I hereby certify that the information contained herein is true and complete to best of my knowledge and belief.

Name
GLISERIO RODRIGUEZ
Position
GEOGRAPHER
Company
YATES PETROLEUM
Date
2-9-81

I hereby certify that the shown on this plat was plotted from notes of actual surveys made under my supervision, and is true and correct to knowledge and belief;
Refer to Original Plat

Date Surveyed

Registered Professional and/or Land Surveyor

Certificate No.