

NEW MEXICO OIL CONSERVATION COMMISSION

Well Location and Acreage Dedication Plat

NOV 2 1959

Date October 29, 1959

Section A.

Operator Nearburg & Ingram Lease Hawkins
 Well No. 2 Unit Letter C Section 27 Township 18 South Range 26 East NMPM
 Located 990 Feet From North Line, 1650 Feet From West Line
 County Eddy G. L. Elevation 3327 Dedicated Acreage 320 Acres
 Name of Producing Formation Pennsylvanian Pool Undesignated WC

1. Is the Operator the only owner* in the dedicated acreage outlined on the plat below?
 Yes _____ No X.
2. If the answer to question one is "no," have the interests of all the owners been consolidated by communitization agreement or otherwise? Yes X No _____. If answer is "yes," Type of Consolidation Operating Agreement
3. If the answer to question two is "no," list all the owners and their respective interests below:

OwnerLand Description

Section B

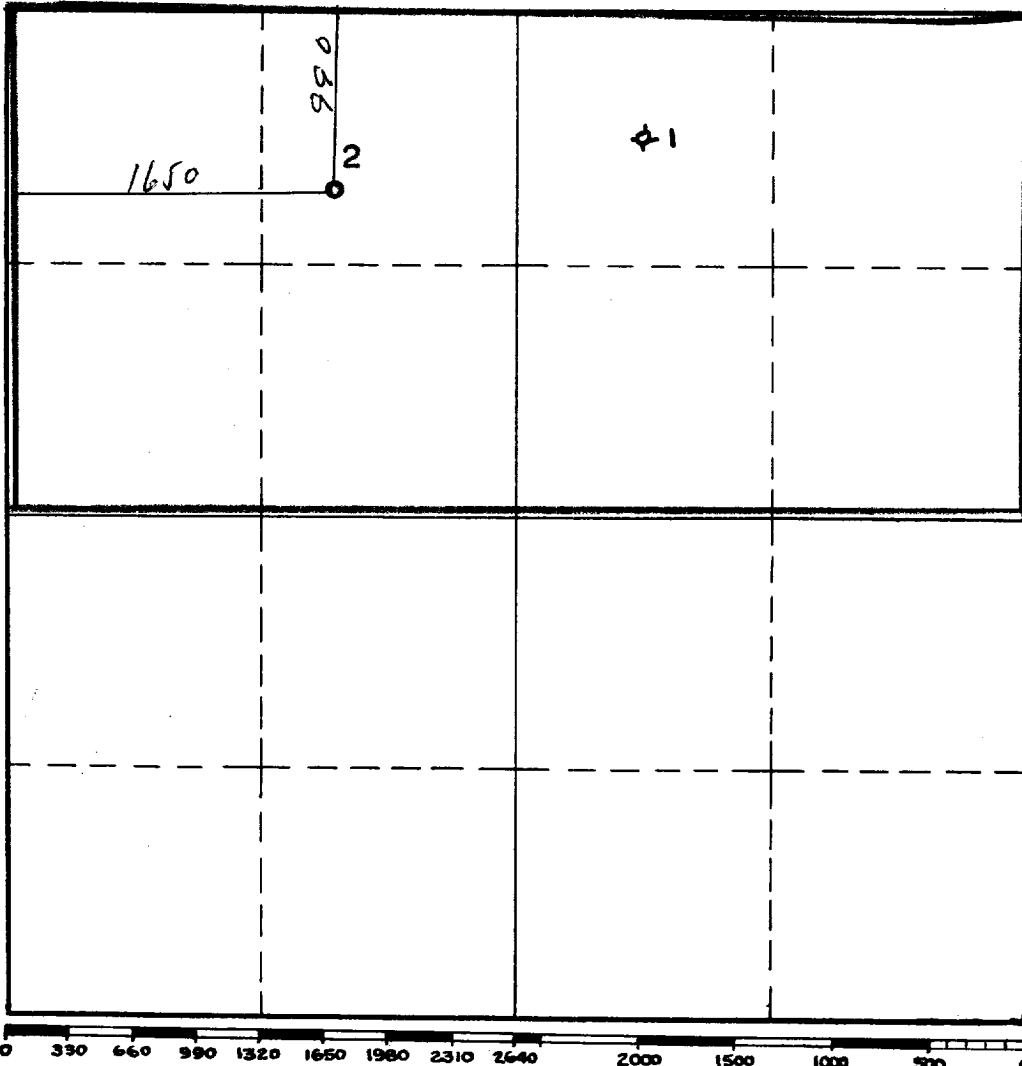

This is to certify that the information in Section A above is true and complete to the best of my knowledge and belief.

Nearburg & Ingram

(Operator)

John L. Ingram

(Representative)

Box 847, Roswell, N. Mex.

Address

This is to certify that the well location shown on the plat in Section B was plotted from field notes of actual surveys made by me or under my supervision and that the same is true and correct to the best of my knowledge and belief.

Date Surveyed 10/29/59

John A. Mathis Jr.
 Registered Professional
 Engineer and/or Land Surveyor.

Certificate No. 1502

(See instructions for completing this form on the reverse side)

INSTRUCTIONS FOR COMPLETION

1. Operator shall furnish and certify to the information called for in Section A.
2. Operator shall outline the dedicated acreage for both oil and gas wells on the plat in Section B.
3. A registered professional engineer or land surveyor registered in the State of New Mexico or approved by the Commission shall show on the plat the location of the well and certify this information in the space provided.
4. All distances shown on the plat must be from the outer boundaries of Section.
5. If additional space is needed for listing owners and their respective interests as required in question 3, Section A, please use space below

OIL CONSERVATION COMMISSION	
ARTIFICIAL DISTRICT OFFICE	
No. 1	5
1	1
2	1
3	2
4	2
5	2
6	2
7	2
8	2
9	2
10	2
11	2
12	2
13	2
14	2
15	2
16	2
17	2
18	2
19	2
20	2
21	2
22	2
23	2
24	2
25	2
26	2
27	2
28	2
29	2
30	2
31	2
32	2
33	2
34	2
35	2
36	2
37	2
38	2
39	2
40	2
41	2
42	2
43	2
44	2
45	2
46	2
47	2
48	2
49	2
50	2
51	2
52	2
53	2
54	2
55	2
56	2
57	2
58	2
59	2
60	2
61	2
62	2
63	2
64	2
65	2
66	2
67	2
68	2
69	2
70	2
71	2
72	2
73	2
74	2
75	2
76	2
77	2
78	2
79	2
80	2
81	2
82	2
83	2
84	2
85	2
86	2
87	2
88	2
89	2
90	2
91	2
92	2
93	2
94	2
95	2
96	2
97	2
98	2
99	2
100	2

* "Owner" means the person who has the right to drill into and to produce from any pool and to appropriate the production either for himself or for himself and another. (65-3-29 (e) NMSA 1953 Comp.)