

NEW MEXICO  
OIL CONSERVATION COMMISSION

Form C-128

Well Location and/or Gas Proration Plat

Date 10/11/56

Operator MAGNOLIA PETROLEUM COMPANY Lease G. F. WRIGHT  
Well No. 1 Section 34 Township 18S Range 26E NMPM  
Located 660 Feet From West Line, 1980 Feet From North Line,  
Eddy County, New Mexico. G. L. Elevation \_\_\_\_\_  
Name of Producing Formation \_\_\_\_\_ Pool Wildcat Dedicated Acreage \_\_\_\_\_

(Note: All distances must be from outer boundaries of Section)

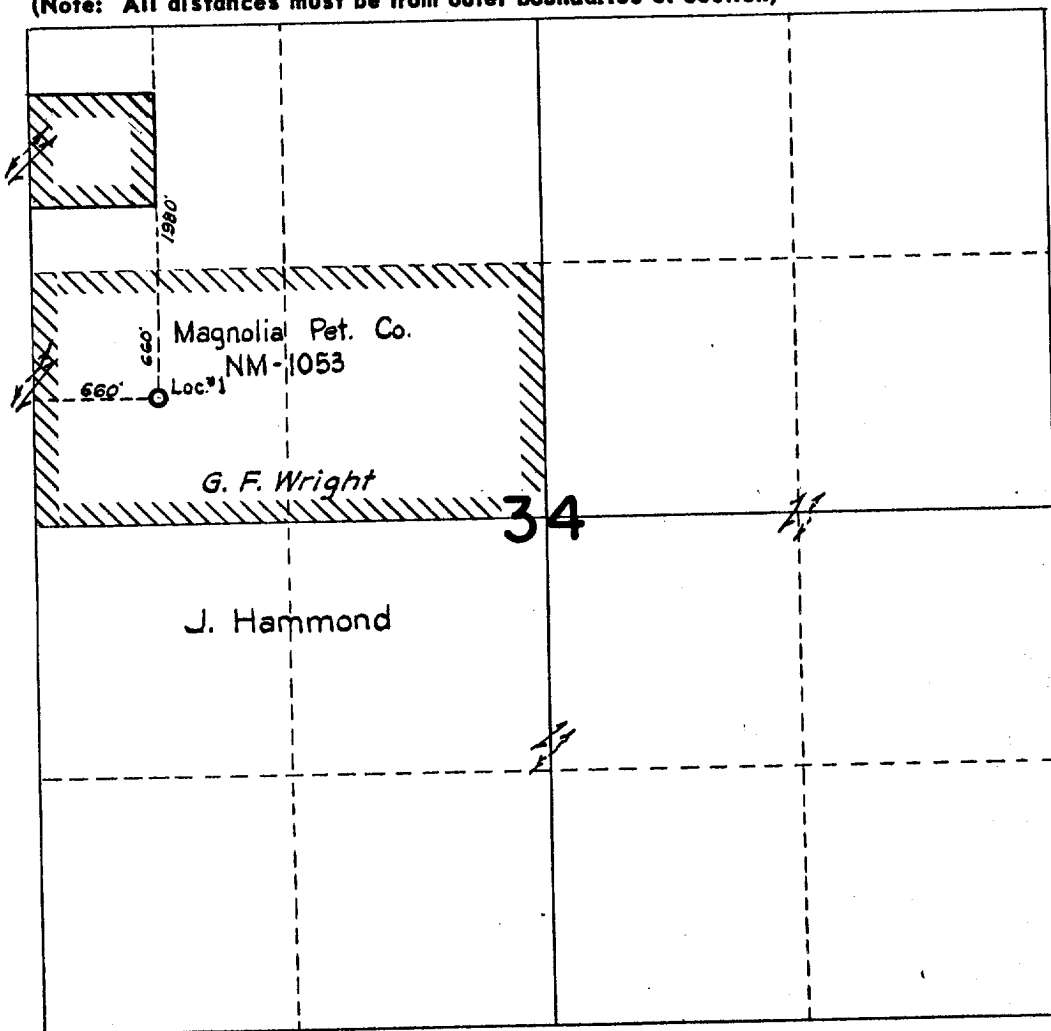

Scale: 1" = 1000'

LEGEND

Lease  
Boundary

1. Is this Well a Dual Comp.? Yes \_\_\_\_\_ No. X .  
2. If the answer to Question 1 is yes, are there any other  
dually completed wells within the dedicated acreage?  
Yes \_\_\_\_\_ No \_\_\_\_\_ .

This is to certify that the above plat was prepared from  
field notes of actual surveys made by me or under my  
supervision and that the same are true and correct to the  
best of my knowledge and belief.

Name C. G. Miller  
Position Assistant District Superintendent  
Representing Magnolia Petroleum Company  
Address Box 727, Kermit, Texas

Date Surveyed 10/12/56  
W. B. Rice  
Registered Professional Engineer and/or Land Surveyor  
No. 1415