

NO. OF COPIES RECEIVED	3
DISTRIBUTION	
SANTA FE	1
FILE	1 ✓
U.S.G.S.	2
LAND OFFICE	
OPERATOR	1

RECEIVED
 NEW MEXICO OIL CONSERVATION COMMISSION
JAN 11 1978
O. C. C.
ARTESIA, OFFICE

Form C-101
 Revised 1-1-65

5A. Indicate Type of Lease	
STATE <input type="checkbox"/>	FEE <input checked="" type="checkbox"/>
5. State Oil & Gas Lease No.	

APPLICATION FOR PERMIT TO DRILL, DEEPEN, OR PLUG BACK			
1a. Type of Work		7. Unit Agreement Name	
b. Type of Well DRILL <input type="checkbox"/> <i>Re-Entry</i> DEEPEN <input type="checkbox"/> PLUG BACK <input checked="" type="checkbox"/> OIL WELL <input checked="" type="checkbox"/> GAS WELL <input type="checkbox"/> OTHER <input type="checkbox"/> SINGLE ZONE <input checked="" type="checkbox"/> MULTIPLE ZONE <input type="checkbox"/>		8. Farm or Lease Name Wright JA	
2. Name of Operator Yates Petroleum Corporation		9. Well No. 1	
3. Address of Operator 207 South 4th Street, Artesia, New Mexico		10. Field and Pool, or Wildcat Undesignated <i>Atoka - 4c30</i>	
4. Location of Well UNIT LETTER <u>E</u> LOCATED <u>1980</u> FEET FROM THE <u>North</u> LINE AND <u>660</u> FEET FROM THE <u>West</u> LINE OF SEC. <u>34</u> TWP. <u>18S</u> RGE. <u>26E</u> NADP.		12. County Eddy	
19. Proposed Depth 3100		19A. Formation Yeso	
20. Rotary or C.T. Rotary		21. Elevation (Show whether D.P., R.T., etc.) 3360 (GL)	
21A. Kind & Status Plug, Bond Blanket		21B. Drilling Contractor Mack Chase	
22. Approx. Date Work will start 1-15-78			

23. PROPOSED CASING AND CEMENT PROGRAM

SIZE OF HOLE	SIZE OF CASING	WEIGHT PER FOOT	SETTING DEPTH	SACKS OF CEMENT	EST. TOP
12 1/4"	9 5/8"	36#	1295'	1025	Surface
8 3/4"	7"	20#	4199'	825	Surface

This is an old hole drilled to 4199' by Magnolia Petroleum Company and formerly designated as G.F. Wright No. 1, P & A 1-22-57. We propose to re-enter the subject well, clean out to \pm 3100' test the 7" casing, perforate the Yeso formation, fracture treat the pay interval before placing on production. Yates will hereafter designate the well as Wright JA No. 1

APPROVAL VALID
 FOR 90 DAYS UNLESS
 DRILLING COMMENCED,
 EXPIRES 4-12-78

IN ABOVE SPACE DESCRIBE PROPOSED PROGRAM IF PROPOSAL IS TO DEEPEN OR PLUG BACK, GIVE DATA ON PRESENT PRODUCTIVE ZONE AND PROPOSED NEW PRODUCTIVE ZONE, GIVE BLOWOUT PREVENTER PROGRAM, IF ANY.

I hereby certify that the information above is true and complete to the best of my knowledge and belief.

Signed *J. Morgan* Title Production Superintendent Date 1-9-78

(This space for State Use)

APPROVED BY *W.A. Gussert* TITLE SUPERVISOR, DISTRICT 1 DATE JAN 12 1978

CONDITIONS OF APPROVAL, IF ANY:

NEW MEXICO OIL CONSERVATION COMMISSION
WELL LOCATION AND ACREAGE DEDICATION PLAT

Form C-102
Supersedes C-128
Effective 1-1-65

All distances must be from the outer boundaries of the Section.

Operator <i>Yates Petroleum Corp</i>		Lease <i>Wright JA</i>		Well No. <i>1</i>
Unit Letter <i>E</i>	Section <i>34</i>	Township <i>18-S</i>	Range <i>26-E</i>	County <i>Eddy</i>
Actual Footage Location of Well: <i>1980</i> feet from the <i>North</i> line and <i>660</i> feet from the <i>West</i> line				
Ground Level Elev. <i>3367</i>	Producing Formation <i>Yeso</i>	Pool <i>Undesignated</i>	Dedicated Acreage: <i>40</i> Acres	

- Outline the acreage dedicated to the subject well by colored pencil or hachure marks on the plat below.
- If more than one lease is dedicated to the well, outline each and identify the ownership thereof (both as to working interest and royalty).
- If more than one lease of different ownership is dedicated to the well, have the interests of all owners been consolidated by communitization, unitization, force-pooling, etc?

☐ Yes ☐ No If answer is "yes," type of consolidation _____

If answer is "no," list the owners and tract descriptions which have actually been consolidated. (Use reverse side of this form if necessary.) _____

No allowable will be assigned to the well until all interests have been consolidated (by communitization, unitization, forced-pooling, or otherwise) or until a non-standard unit, eliminating such interests, has been approved by the Commission.

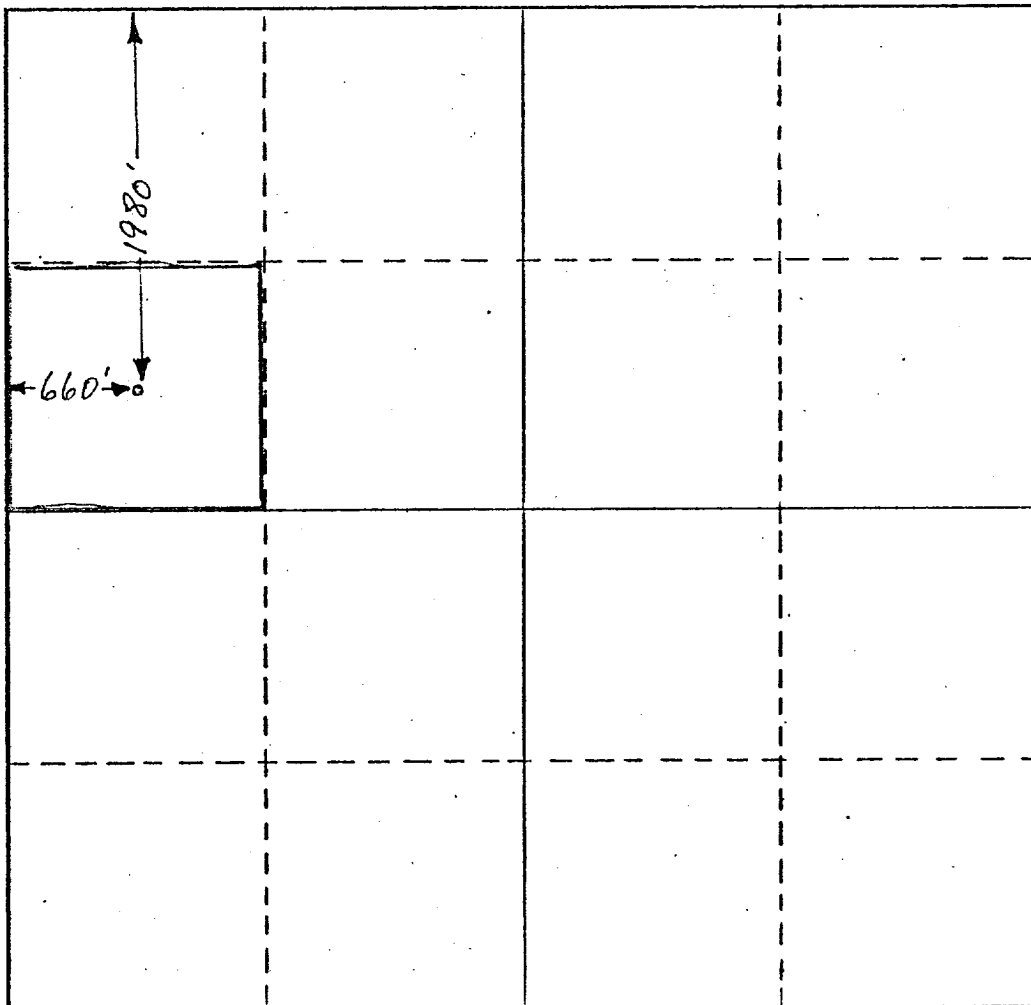

CERTIFICATION

I hereby certify that the information contained herein is true and complete to the best of my knowledge and belief.

Eddie M. Mahfood
Name
EDDIE M. MAHFOOD
Position
Engineer
Company
YATES PETROLEUM CORP
Date
1-9-78

I hereby certify that the well location shown on this plat was plotted from field notes of actual surveys made by me or under my supervision, and that the same is true and correct to the best of my knowledge and belief.

Refer to Original Plat.
Old well re-entry - formerly
Magnolia Petroleum Company
C. F. WRIGHT No. 1

Registered Professional Engineer
and/or Land Surveyor

Certificate No.

