

Operator Kimbell Oil Co. of Texas
Well B & B Federal #1
Unit C Section 36 Township 18 Range 26
API # 30-015-00273

TOPS

F. Salt _____
B. Salt _____
Yates _____
Glorieta 2830
Delaware _____
Bone Sp. 4390
Abo _____
Wolfcamp 6350'
Morrow _____
Devonian _____
Fusselman _____
Other _____

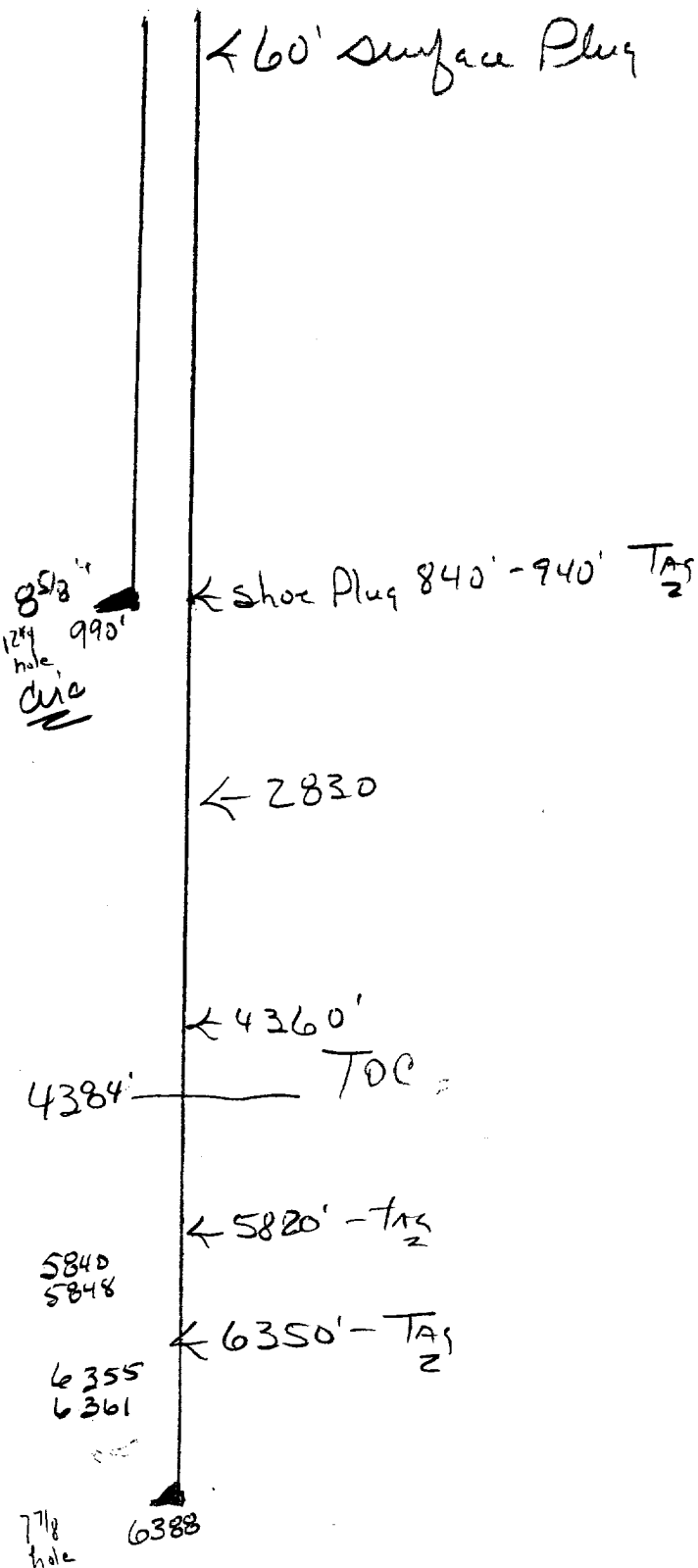

- Contact OCD 24 hrs. prior to any work done.
- Salt gel mud consisting of 10# brine with 25# of gel per barrel must be placed between each plug
- Install dry hole marker as per rule 202.B.2
- Plugs are to be set from point indicated up. Plugs must not be less than 100' or 25 Sacks of cement, whichever is greater, unless specifically indicated.
- Shoe and stub plugs will be 50' above and below shoe or stub and tagged.
- Surface plug will be from 0' - 60'
- Where plugs are required cement must be placed inside and outside of all casing string(s), in the correct footage or sacks required, if no cement exists.
- Plugs to be tagged will be indicated.